

EPA VISIBLE EMISSION OBSERVATION FORM 1

| | |
|------------------------------|------|
| Form Number | Page |
| Continued on VEO Form Number | Of |

Method Used (Circle One)
 Method 9 203A 203B Other: _____

Company Name: **County Cremation Services**
 Facility Name: **1110140**
 Street Address: **8549 S. US Highway I**
 City: **Port St. Luke** State: **FL** Zip: **34954**

Process: **cremation** Unit #: **1** Operating Mode: **normal**
 Control Equipment: **secondary chamber** Operating Mode: **normal**

Describe Emission Point:
stack

Height of Emis. Pt. Start: **20** End: **same** Height of Emis. Pt. Rel. to Observer Start: **20** End: **same**
 Distance to Emis. Pt. Start: **40** End: **same** Direction to Emis. Pt. (Degrees) Start: **310°** End: **same**

Vertical Angle to Obs. Pt. Start: **9°** End: **9°** Direction to Obs. Pt. (Degrees) Start: **137** End: **same**
 Distance and Direction to Observation Point from Emission Point Start: **100' NW** End: **100'**

Describe Emissions
 Start: **smoke / heatwave** End: _____
 Emission Color: **black** Water Droplet Plume: _____
 Attached Detached None

Describe Plume Background
 Start: **sky** End: _____
 Background Color: **blue** Sky Conditions: **scattered**
 Wind Speed: Start: **0-5** End: **5-10** Wind Direction: Start: **NE** End: **E**
 Ambient Temp.: Start: **82** End: _____ Wet Bulb Temp.: _____ RH Percent: **68%**

| Sec Min | Time Zone: est | | | | Comments |
|------------|-----------------------|----|----|----|----------|
| | 0 | 15 | 30 | 45 | |
| 1 | 0 | 15 | 0 | 0 | |
| 2 | 0 | 0 | 0 | 0 | |
| 3 | 0 | 0 | 0 | 0 | |
| 4 | 0 | 0 | 0 | 0 | |
| 5 | 0 | 0 | 0 | 0 | |
| 6 | 0 | 0 | 0 | 5 | |
| 7 | 0 | 0 | 0 | 0 | |
| 8 | 0 | 0 | 0 | 0 | |
| 9 | 0 | 0 | 0 | 0 | |
| 10 | 0 | 0 | 0 | 0 | |
| 11 | 0 | 0 | 0 | 0 | |
| 12 | 0 | 0 | 0 | 0 | |
| 13 | 0 | 0 | 0 | 0 | |
| 14 | 0 | 0 | 0 | 0 | |
| 15 | 0 | 0 | 0 | 0 | |
| 16 | 0 | 0 | 0 | 0 | |
| 17 | 0 | 0 | 0 | 0 | |
| 18 | 0 | 0 | 0 | 0 | |
| 19 | 0 | 0 | 0 | 0 | |
| 20 | 0 | 0 | 5 | 0 | |
| 21 | 0 | 0 | 0 | 0 | |
| 22 | 0 | 5 | 0 | 0 | |
| 23 | 0 | 0 | 0 | 0 | |
| 24 | 0 | 0 | 0 | 0 | |
| 25 | 0 | 0 | 0 | 10 | |
| 26 | 5 | 5 | 0 | 0 | |
| 27 | 5 | 5 | 5 | 0 | |
| 28 | 0 | 0 | 0 | 0 | |
| 29 | 0 | 0 | 0 | 0 | |
| 30 | 0 | 0 | 0 | 5 | |

Observer's Name (Print): **Tameca Tampus** Date: **5/17/2013**
 Observer's Signature: *Tampus*
 Organization: **FDEP**
 Certified By: **ETA** Date: **1/7/2013**

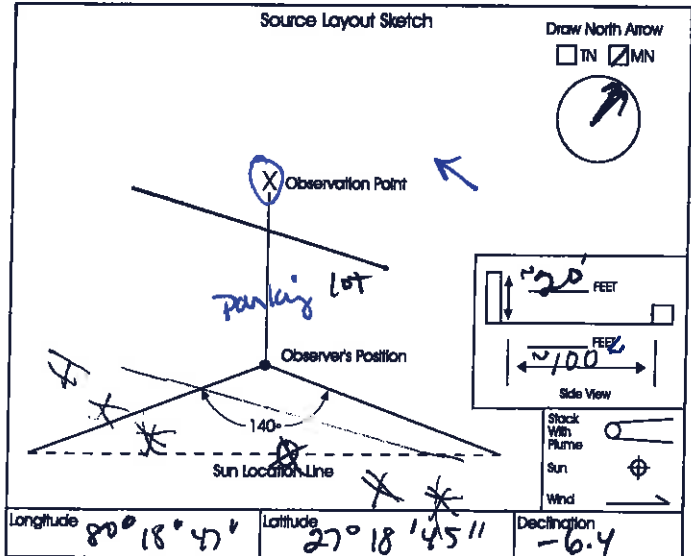

Additional Information:
110 lbs in 92 lbs
10.19