

# Department of Environmental Protection

Lawton Chiles  
Governor

Central District  
3319 Maguire Boulevard, Suite 232  
Orlando, Florida 32803-3767

Virginia B. Wetherell  
Secretary

**Permittee:**

Walt Disney World Company  
Post Office Box 10,000  
Lake Buena Vista, Florida 32830-1000

Attention: Bob Penn, Director,  
Environmental Affairs

**I.D. Number:**

Permit Number: AO49-254323  
Date of Issue:  
Expiration Date: August 30, 1999  
County: Osceola  
Latitude/Longitude:  
28°21'00"N/81°34'00"W  
Project: All Star Resort Paint Booth

This permit is issued under the provisions of Chapter(s) 403, Florida Statutes, and Florida Administrative Code Rule(s) 62-2. The above named permittee is hereby authorized to perform the work or operate the facility shown on the application and approved drawing(s), plans, and other documents attached hereto or on file with the department and made a part hereof and specifically described as follows:

The permittee may operate a paint spray booth to spray miscellaneous parts for building maintenance at the Walt Disney World All Star Resort. The paint booth is a Binks Model PFF-12-8-T-LH equipped with paint arrestors capable of removing more than 95 percent of the particulates of less than 1 micron size.

This source is located at 3499 West Buena Vista Drive, Kissimmee, Osceola County, Florida.

General Conditions are attached to be distributed to the permittee only.

PERMITTEE:

Walt Disney World Company

Attention: Bob Penn, Director,  
Environmental Affairs

I.D. Number:

Permit Number: AO49-254323

Expiration Date: August 30, 1999

County: Osceola

**SPECIFIC CONDITIONS**

OPERATING LIMITS

1. The maximum permitted usage rate is 2 gallons per hour of paint or primer, per the application.
2. This source is permitted to operate 16 hrs/day, 5 days/week, every week, per the application.
3. Each dry filter must be properly operated and maintained (Rule 62-210.300, F.A.C.). No person shall circumvent any pollution control device or allow the emissions of air pollutants without the applicable air pollution control device operating properly (Rule 62-210.650, F.A.C.).
4. The velocity at the paint booth filter face shall not exceed 250 ft/min.
5. Rule 62-296.320(1)(a) F.A.C. states that no person shall store, pump, handle, process, load, unload or use in any process or installation volatile organic compounds or organic solvents without applying known and existing vapor emission control devices or systems deemed necessary and ordered by the department. To comply, procedures to minimize pollutant emissions should include but shall not be limited to the following:
  - a) tightly cover or close all VOC containers when they are not in use,
  - b) tightly cover, where possible, all open troughs, basins, baths, tanks, etc. when they are not in use,
  - c) maintain all piping, valves, fittings, etc. in good operating condition,
  - d) prevent excessive air turbulence across exposed VOC's,
  - e) immediately confine and clean up VOC spills and make sure certain wastes are placed in closed containers for reuse, recycling or proper disposal, and
  - f) maintain a monthly accounting of each VOC based on beginning and ending inventories, deliveries, shipments, etc.

EMISSION LIMITS

6. The visible emissions from the source must comply with Rule 62-296.310, F.A.C. (20% opacity limit).

PERMITTEE:  
Walt Disney World Company  
  
Attention: Bob Penn, Director,  
Environmental Affairs

I.D. Number:  
Permit Number: AO49-254323  
Expiration Date: August 30, 1999  
County: Osceola

**SPECIFIC CONDITIONS:**  
(Continued)

COMPLIANCE TESTING

7. The source must be tested for visible emissions in accordance with DEP Method 9 for a time period of thirty minutes or the length of the batch/cycle at least 90 days prior to permit expiration date.
8. The Air Resources Compliance Section of this office shall be notified in writing at least fifteen (15) days in advance of the compliance tests (Rule 62-297.340(1)(i), F.A.C.).
9. This plant is required to operate within 90 to 100 percent of permitted capacity during the compliance tests.
10. The required test report shall be filed with this office no later than 45 days after the last sampling run of each test is completed (Rule 62-297.570(2), F.A.C.).
11. Each calendar year on or before March 1, submit for each source, an Annual Operations Report DEP Form 62-210.900(4) for the preceding calendar year.

EXPIRATION DATE

12. An operation permit renewal must be submitted at least 60 days prior to the expiration date of this permit (Rule 62-4.090, F.A.C.).

STATE OF FLORIDA DEPARTMENT  
OF ENVIRONMENTAL PROTECTION

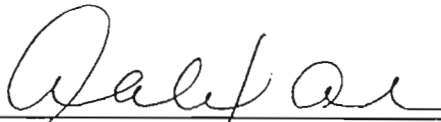
  
A. Alexander, P.E.  
District Director

ISSUED 9-2-94

Permittee:

Walt Disney World Company

I.D. Number:

Permit Number: 0950111-003-AC

Atten: Robert H. Penn, Director,  
Environmental Affairs

Expiration Date: August 30, 2001

County: Orange

Specific Emission Limiting and Performance Standards

1. The maximum VOC emissions from the Magic Kingdom Paint Booth # 2 are limited to less than 2.3 tons per consecutive twelve months and the Boardwalk Resort Paint Booth #1 is limited to less than 3.1 tons per consecutive twelve months.
2. The maximum permitted utilization rate is 730 gallons of coating materials at each booth per consecutive twelve months, updated monthly. The applicant may use different hazardous air pollutant (HAP) materials than those stated in the application. However no-less than fourteen days before using different materials which produce HAP emissions, the applicant shall provide MSD sheets of the new materials and reasonable assurance from a Professional Engineer Registered in Florida that the Florida Ambient Reference Concentration will be not be exceeded because of the change of materials or because of an increase in the use of HAP containing materials. The written notification will become part of the permit.
3. The permittee shall not cause, suffer, allow nor permit the discharge of air pollutants which cause or contribute to an objectionable odor [Rule 62-296.320(2), F.A.C.].
4. Rule 62-296.320(1)(a), F.A.C. states that no person shall store, pump, handle, process, load, unload or use in any process or installation volatile organic compounds or organic solvents without applying known and existing vapor emission control devices or systems deemed necessary and ordered by the department. To comply, procedures to minimize pollutant emissions should include but shall not be limited to the following:
  - a) tightly cover or close all VOC containers when they are not in use,
  - b) tightly cover, where possible, all open troughs, basins, baths, tanks, etc. when they are not in use,
  - c) maintain all piping, valves, fittings, etc. in good operating condition,
  - d) prevent excessive air turbulence across exposed VOC's, and
  - e) immediately confine and clean up VOC spills and make sure certain wastes are placed in closed containers for reuse, recycling or proper disposal,
5. Toluene emissions from the source shall not cause the twenty-four hour average ground level ambient air concentrations to exceed 448 micrograms/M3. The applicant has shown that at the maximum usage rates, this limit will not be violated. Proof of compliance with this condition shall be demonstrated by the professional engineer's calculations if any of the conditions used in the calculations in the construction application have changed.

Permittee:  
Walt Disney World Company

Atten: Robert H. Penn, Director,  
Environmental Affairs

I.D. Number:  
Permit Number: 0950111-003-AC  
Expiration Date: August 30, 2001  
County: Orange

#### Recordkeeping

6. Pursuant to Rule 62-4.070(3), F.A.C., a monthly log shall be kept for this facility to document compliance with the limitations of specific conditions no. 1 and 2. The log shall be completed by the end of the following month and retained on file at the facility for at least 3 years. As a minimum, the monthly log shall:

a) Quantify the consecutive twelve month period total of emissions from VOCs.

Documentation of each chemical reclaimed will use a mass balance method to determine usage/emissions (amount used minus amount collected for disposal or recycle). Supporting documentation (Chemical usage tracking logs, MSDS sheets, purchase orders, EPA "As Supplied" data sheets, EPA Method 24, etc.) shall be kept for each chemical and associated products which includes sufficient information to determine usage rates and emissions. These records shall be made available to the Department upon request.

7. A DEP Form No. 62-210.900(5), "Annual Operating Report for Air Pollutant Emitting Facility" including the Emissions Report, shall be completed for each calendar year on or before March 1 of the following year and submitted to the Orange County Environmental Protection Department [Rule 62-210.370(3)(a), F.A.C.].

#### Permit Application

8. The construction shall reasonably conform to the plans and schedule submitted in the application. If the permittee is unable to complete construction on schedule, he must notify the Department in writing 60 days prior to the expiration of the construction permit and submit a new request for an extension of the construction permit or six months after being placed in operation, whichever date occurs first.

The permittee must notify the Department in writing of the startup date for any source covered by this permit. This notification must be addressed to the Permitting Section and received no later than 15 days after startup.

An operating permit is required for operation of this source. To obtain an operating permit, the permittee must demonstrate compliance with the conditions of the construction permit and submit the application fee, along with compliance test results and Application for Air Permit to the Department's Central Florida District office six months after being placed in operation.

Permittee:  
Walt Disney World Company

Atten: Robert H. Penn, Director,  
Environmental Affairs

I.D. Number:  
Permit Number: 0950111-003-AC  
Expiration Date: August 30, 2001  
County: Orange

STATE OF FLORIDA DEPARTMENT  
OF ENVIRONMENTAL PROTECTION

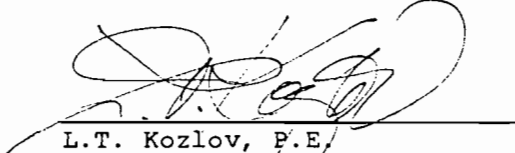

L.T. Kozlov, P.E.  
Program Administrator  
Air Resources Management

Issued: 8-21-96

# TELECOPIER COVER SHEET (827-2774)

TO: <u>Bruce Mitchell</u>	FAX #: <u>850-922-6979</u>
FROM: <u>Rich Bumar</u>	DATE: <u>10/13/97</u>
TOTAL # PAGES: <u>5</u> (INCLUDING THIS PAGE)	

- |   |  |
|---|--|
| <input type="checkbox"/> THIS IS A RUSH!!           | <input checked="" type="checkbox"/> REGARDING THE ATTACHED |
| <input type="checkbox"/> PER OUR DISCUSSION         | <input type="checkbox"/> PLEASE COPY ALL LISTED            |
| <input type="checkbox"/> PLEASE CALL ME TO DISCUSS  | <input type="checkbox"/> PLEASE ACKNOWLEDGE RECEIPT        |
| <input type="checkbox"/> I WILL CALL YOU TO DISCUSS | <input type="checkbox"/> FOR YOUR REVIEW AND COMMENT       |

COMMENTS:

Bruce,  
Attached is the AC for the ALL STAR  
paint spray booth. Unfortunately, we do  
not have the AC for the NSA Sand  
Blast chamber.

Rich

IF YOU DO NOT RECEIVE ALL OF THESE PAGES, CALL <sup>(407)</sup> 827-4524



Lawton Chiles  
Governor

# Florida Department of Environmental Protection

Central District  
3319 Maguire Boulevard, Suite 232  
Orlando, Florida 32803-3767

Virginia B. Wetherell  
Secretary

**Permittee:**

Walt Disney World Company  
Post Office Box 10,000  
Lake Buena Vista, Florida 32830-1000

Attention: Bob Penn, Director,  
Environmental Affairs

Permit Number: AC49-232381  
Date of Issue:  
Expiration Date: October 30, 1998  
County: Osceola  
Latitude/Longitude:  
28°21'00"N/81°34'00"W  
Project: All Star Resort Paint Booth

This permit is issued under the provisions of Chapter(s) 403, Florida Statutes, and Florida Administrative Code Rule(s) 17-2. The above named permittee is hereby authorized to perform the work or operate the facility shown on the application and approved drawing(s), plans, and other documents attached hereto or on file with the department and made a part hereof and specifically described as follows:

The permittee may construct a paint spray booth to spray miscellaneous parts for building maintenance at the Walt Disney World All Star Resort. The paint booth is a Binks Model PFF-12-8-T-LH equipped with paint arrestors capable of removing more than 95 percent of the particulates at less than 1 micron size.

This source is located at 3499 West Buena Vista Drive, Kissimmee, Osceola County, Florida.

General Conditions are attached to be distributed to the permittee only.



**PERMITTEE:**

Walt Disney World Company

Permit Number: AC49-232381

Expiration Date: October 30, 1998

Attention: Bob Penn, Director  
Environmental Affairs**GENERAL CONDITIONS:**

16. No objectionable odors will be allowed, as per Rule 17-296.320(2), F.A.C.
17. This permit does not preclude compliance with any applicable local permitting requirements and regulations.

**SPECIFIC CONDITIONS**OPERATING LIMITS

1. The maximum permitted usage rate is 2 gallons per hour of paint or primer, per the application.
2. This source is permitted to operate 16 hrs/day, 5 days/week, every week.
3. Each dry filter must be properly operated and maintained (Rule 17-210.300, F.A.C.). No person shall circumvent any pollution control device or allow the emissions of air pollutants without the applicable air pollution control device operating properly (Rule 17-210.650, F.A.C.).
4. The velocity at the paint booth filter face shall not exceed 250 ft/min.
5. Rule 17-296.320(1)(a) F.A.C. states that no person shall store, pump, handle, process, load, unload or use in any process or installation volatile organic compounds or organic solvents without applying known and existing vapor emission control devices or systems deemed necessary and ordered by the department. To comply, procedures to minimize pollutant emissions should include but shall not be limited to the following:
  - a) tightly cover or close all VOC containers when they are not in use,
  - b) tightly cover, where possible, all open troughs, basins, baths, tanks, etc. when they are not in use,
  - c) maintain all piping, valves, fittings, etc. in good operating condition,
  - d) prevent excessive air turbulence across exposed VOC's,
  - e) immediately confine and clean up VOC spills and make sure certain wastes are placed in closed containers for reuse, recycling or proper disposal, and
  - f) maintain a monthly accounting of each VOC based on beginning and ending inventories, deliveries, shipments, etc.

PERMITTEE:  
Walt Disney World Company

Permit Number: AC49-232381  
Expiration Date: October 30, 1998

Attention: Bob Penn, Director  
Environmental Affairs

**SPECIFIC CONDITIONS:**  
(Continued)

EMISSION LIMITS

6. The visible emissions from each stack must comply with Rule 17-296.310, F.A.C. (20% opacity limit) and the compliance test must be conducted in accordance with Rule 17-297.401(9), (DEP Method 9), F.A.C.
7. Methyl ethyl ketone emissions from the source shall not cause the twenty-four hour average ground level ambient air concentrations to exceed the No Threat Level (NTL) of 560 micrograms/M<sup>3</sup>. The application shows that at a usage rate of two gallons per hour of paint, this limit will not be violated. Proof of compliance with this condition shall be demonstrated by the professional engineer's calculations based on actual conditions.

COMPLIANCE TESTING

8. The source must be tested in accordance with DEP Method 9 for a time period of thirty minutes within thirty days after being placed in operation.
9. The Air Resources Compliance Section of this office shall be notified in writing at least fifteen (15) days in advance of the compliance tests (Rule 17-297.340(1)(1), F.A.C.).
10. This source shall be tested at the intended maximum rate the permittee wishes to be placed in the operation permit, not to exceed two gallon/hour of paint.
11. The required test report shall be filed with this office no later than 45 days after the last sampling run of each test is completed (Rule 17-297.570(2), F.A.C.).
12. Each calendar year on or before March 1, submit for each source, an Annual Operations Report DEP Form 17-210.900(4) for the preceding calendar year.

EXPIRATION DATE

13. The construction shall reasonably conform to the plans and schedule submitted in the application. If the permittee is unable to complete construction on schedule, he must notify the Department in writing 60 days prior to the expiration of the construction permit and submit a new request for an extension of the construction permit. (Rule 17-4.09 Florida Administrative Code).

The permittee must notify the Department in writing of the startup date for any source covered by this permit. This notification must be addressed to the Permitting Section and received no later than 15 days after startup.

PERMITTEE:  
Walt Disney World Company

Permit Number: AC49-232381  
Expiration Date: October 30, 1998

Attention: Bob Penn, Director  
Environmental Affairs

SPECIFIC CONDITIONS  
(Continued)

An operating permit is required for operation of this source. To obtain an operating permit, the permittee must demonstrate compliance with the conditions of the construction permit and submit the application fee, along with compliance test results and Certification of Completion of Construction to the Department's Central Florida District office 60 days prior to the expiration date of the construction permit.

This permit will expire October 30, 1998 or six months after the source is placed in operation, whichever occurs first.

ISSUED 9/13/93

STATE OF FLORIDA DEPARTMENT  
OF ENVIRONMENTAL PROTECTION

*cmc* *Carl Riverdale for*

A. Alexander, P.E.  
District Director  
3319 Maguire Boulevard  
Suite 232  
Orlando, Florida 32803

**APPLICATION FOR A TITLE V AIR  
OPERATION PERMIT MODIFICATION**

**WALT DISNEY WORLD CO.**

**DISNEY'S BOARDWALK RESORT SPRAY  
BOOTH #1 AND  
MAGIC KINGDOM SPRAY BOOTH #2**

**ELECTRONIC SUBMISSION  
SUPPLEMENTAL INFORMATION PACKET**

TABLE OF CONTENTS

**ELECTRONIC SUBMISSION SUPPLEMENTAL INFORMATION PACKET**

**I. APPLICATION INFORMATION**

- AUTHORIZED REPRESENTATIVE ..... I. PART 2
- PROFESSIONAL ENGINEER CERTIFICATION ..... I. PART 5-6

**SUPPLEMENTAL INFORMATION**

- AREA MAP SHOWING FACILITY LOCATION ..... ATTACHMENT A
- FACILITY PLOT PLANS ..... ATTACHMENT B
- PROCESS FLOW DIAGRAM ..... ATTACHMENT C
- MAGIC KINGDOM SPRAY BOOTH #2 SPECIFICATIONS ... ATTACHMENT D
- BOARDWALK SPRAY BOOTH #1 SPECIFICATIONS ..... ATTACHMENT E

**Department of  
Environmental Protection**

**DIVISION OF AIR RESOURCES MANAGEMENT  
APPLICATION FOR AIR PERMIT - SHORT FORM**

**I. APPLICATION INFORMATION**

**Identification of Facility Addressed in This Application**

1. Facility Owner/Company Name : Walt Disney World Co.	
2. Site Name : Walt Disney World Resort	
3. Facility Identification Number :    0950111	<input type="checkbox"/> Unknown
4. Facility Location : Walt Disney World Resort Complex Lake Buena Vista, FL  Street Address or Other Locator :    P.O. Box 10,000 City : Lake Buena Vista                      County : Orange                      Zip Code : 32830-1000	
5. Relocatable Facility? <input type="checkbox"/> Yes <input checked="" type="checkbox"/> No	6. Existing Permitted Facility? <input checked="" type="checkbox"/> Yes <input type="checkbox"/> No

I. Part 1 - 1

Signature Pages

**Owner/Authorized Representative or Responsible Official**

1. Name and Title of Owner/Authorized Representative or Responsible Official :

Name : William A. O'Toole  
Title : Senior Vice President

2. Owner or Authorized Representative or Responsible Official Mailing Address :

Organization/Firm : Walt Disney World Co.  
Street Address : P.O. Box 10,000  
City : Lake Buena Vista  
State : FL Zip Code : 32830-1000

3. Owner/Authorized Representative or Responsible Official Telephone Numbers :

Telephone : (407)828-3701 Fax : (407)828-3239

4. Owner/Authorized Representative or Responsible Official Statement :

*I, the undersigned, am the owner or authorized representative\* of the facility addressed in this Application for Air Permit. I hereby certify, based on information and belief formed after reasonable inquiry, that the statements made in this application are true, accurate and complete and that, to the best of my knowledge, any estimates of emissions reported in this application are based upon reasonable techniques for calculating emissions. Further, I agree to operate and maintain the air pollutant emissions units and air pollution control equipment described in this application so as to comply with all applicable standards for control of air pollutant emissions found in the statutes of the State of Florida and rules of the Department of Environmental Protection and revisions thereof. I understand that a permit, if granted by the Department, cannot be transferred without authorization from the Department, and I will promptly notify the Department upon sale or legal transfer of any permitted emissions unit.*

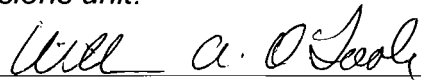
  
Signature

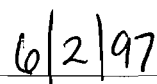
  
Date

\* Attach letter of authorization if not currently on file.

**Professional Engineer Certification**

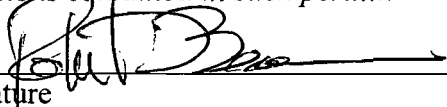
1. Professional Engineer Name : Robert Beaver Registration Number : 32528
2. Professional Engineer Mailing Address : Organization/Firm : Walt Disney World Co. Street Address : P.O. Box 10,000 City : Lake Buena Vista State : FL Zip Code : 32830-1000
3. Professional Engineer Telephone Numbers : Telephone : (407)828-1584 Fax : (407)934-7297
4. Professional Engineer Statement :  <i>I, the undersigned, hereby certified, except as particularly noted herein*, that :</i>  <i>(1) To the best of my knowledge, there is reasonable assurance that the air pollutant emissions unit(s) and the air pollutant control equipment described in this Application for Air Permit, when properly operated and maintained, will comply with all applicable standards for control of air pollutant emissions in the Florida Statutes and rules of the Department of Environmental Protection; and</i>  <i>(2) To the best of my knowledge, any emission estimates reported or relied on in this application are true, accurate, and complete and are either based upon reasonable techniques available for calculating emissions or, for emission estimates of hazardous air pollutants not regulated for an emissions unit addressed in this application, based solely upon the materials, information and calculations submitted with this application.</i>  <i>If the purpose of this application is to obtain an initial air operation permit or operation permit revision for one or more newly constructed or modified emissions units (check here [✓] if so), I further certify that, with the exception of any changes detailed as part of this application, each such emissions unit has been constructed or modified in substantial accordance with the information given in the corresponding application for air construction permit and with all provisions contained in such permit.</i>  _____ Signature  Date <u>6/2/97</u>

\* Attach any exception to certification statement

I. Part 6

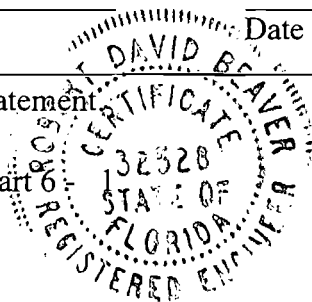



**ATTACHMENT A**

**AREA MAP SHOWING FACILITY LOCATION**

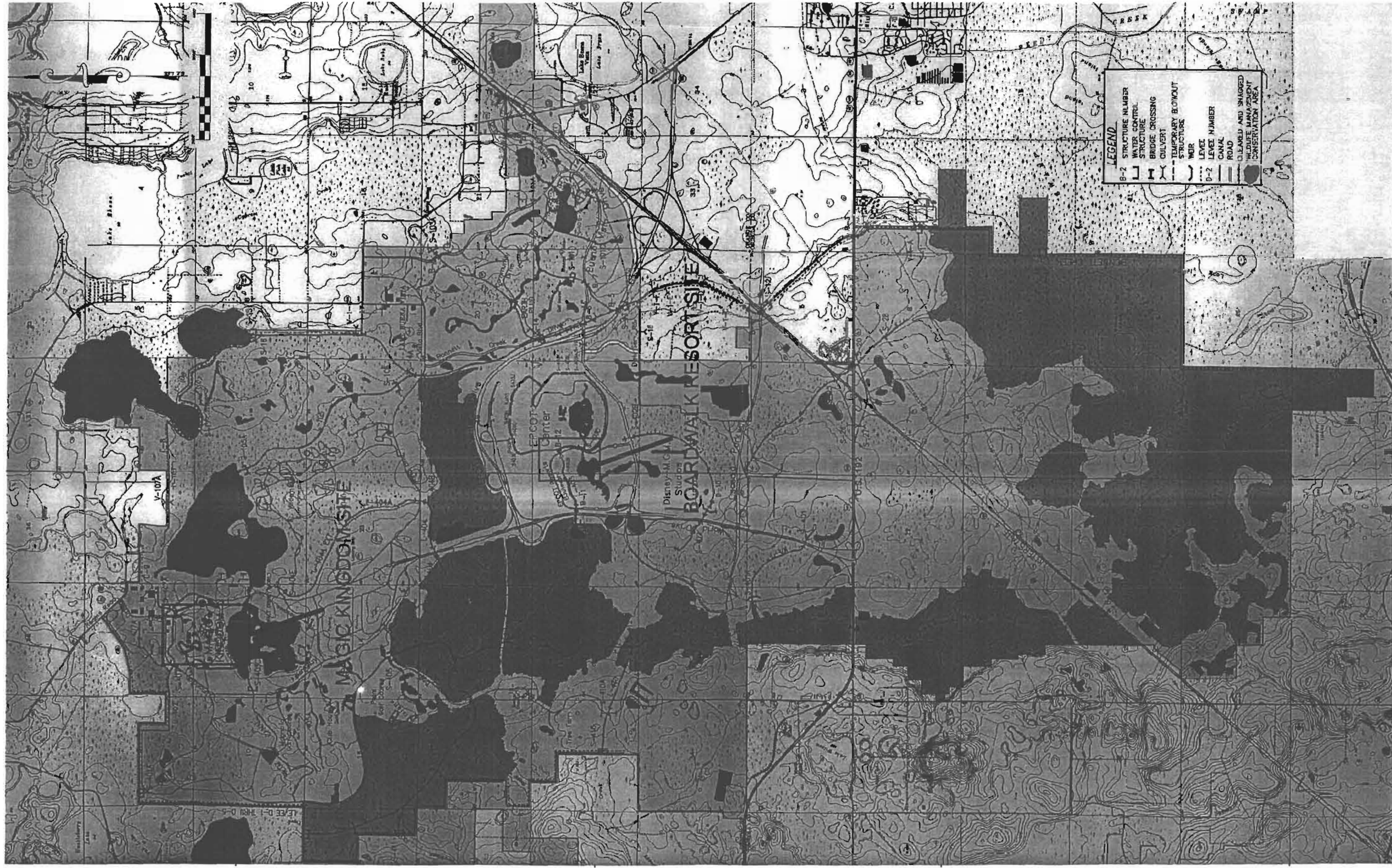

ATTACHMENT A  
 WALT DISNEY WORLD RESORT AREA MAP  
 DISNEY'S BOARDWALK RESORT AND MAGIC KINGDOM

**ATTACHMENT B**  
**FACILITY PLOT PLANS**

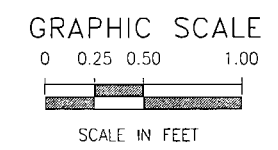
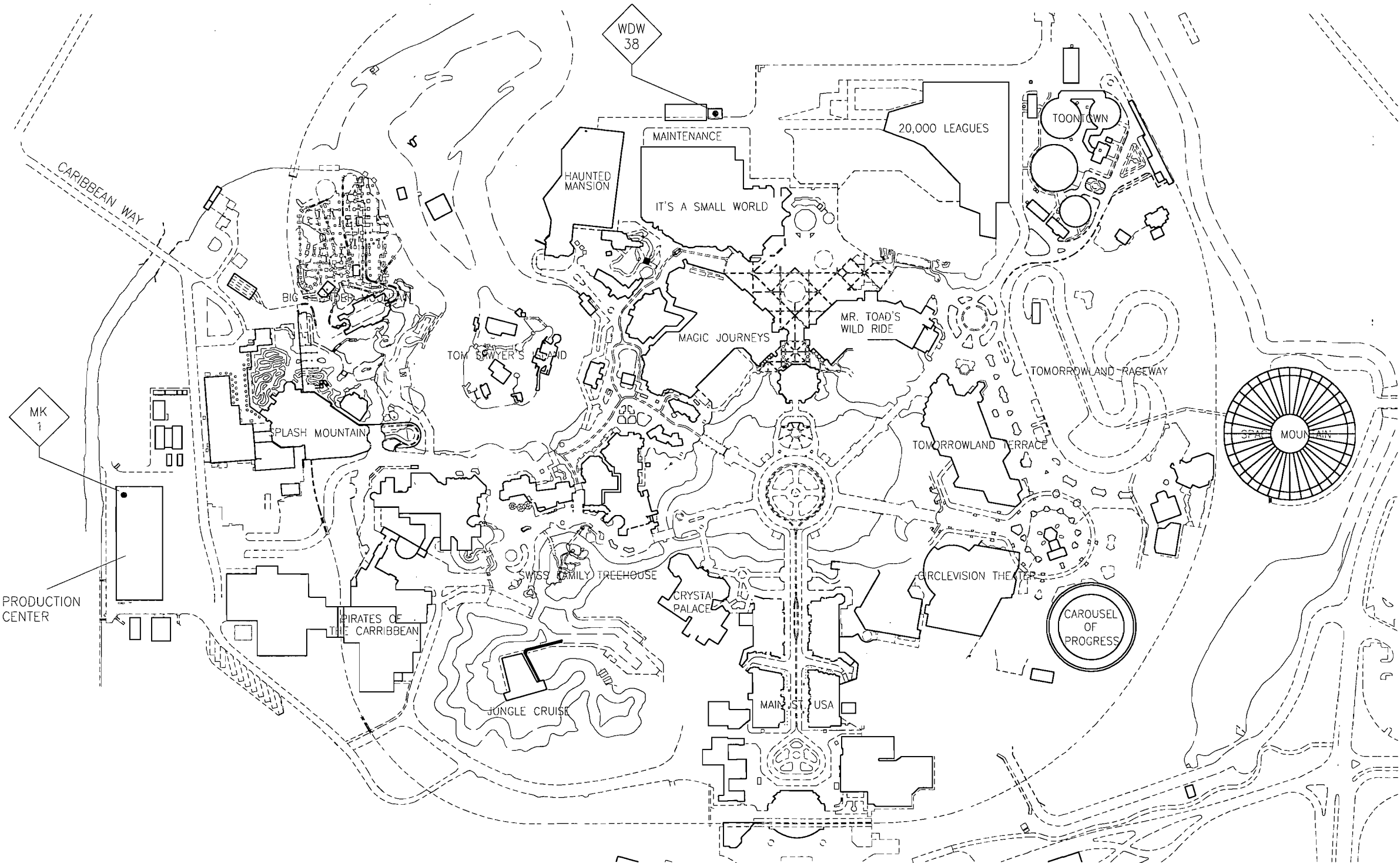

LEGEND



WALT DISNEY WORLD RESORT COMPLEX EMISSION SOURCE LOCATION  
 MAGIC KINGDOM



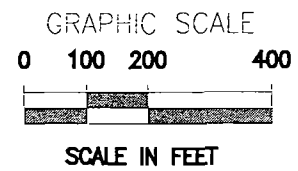
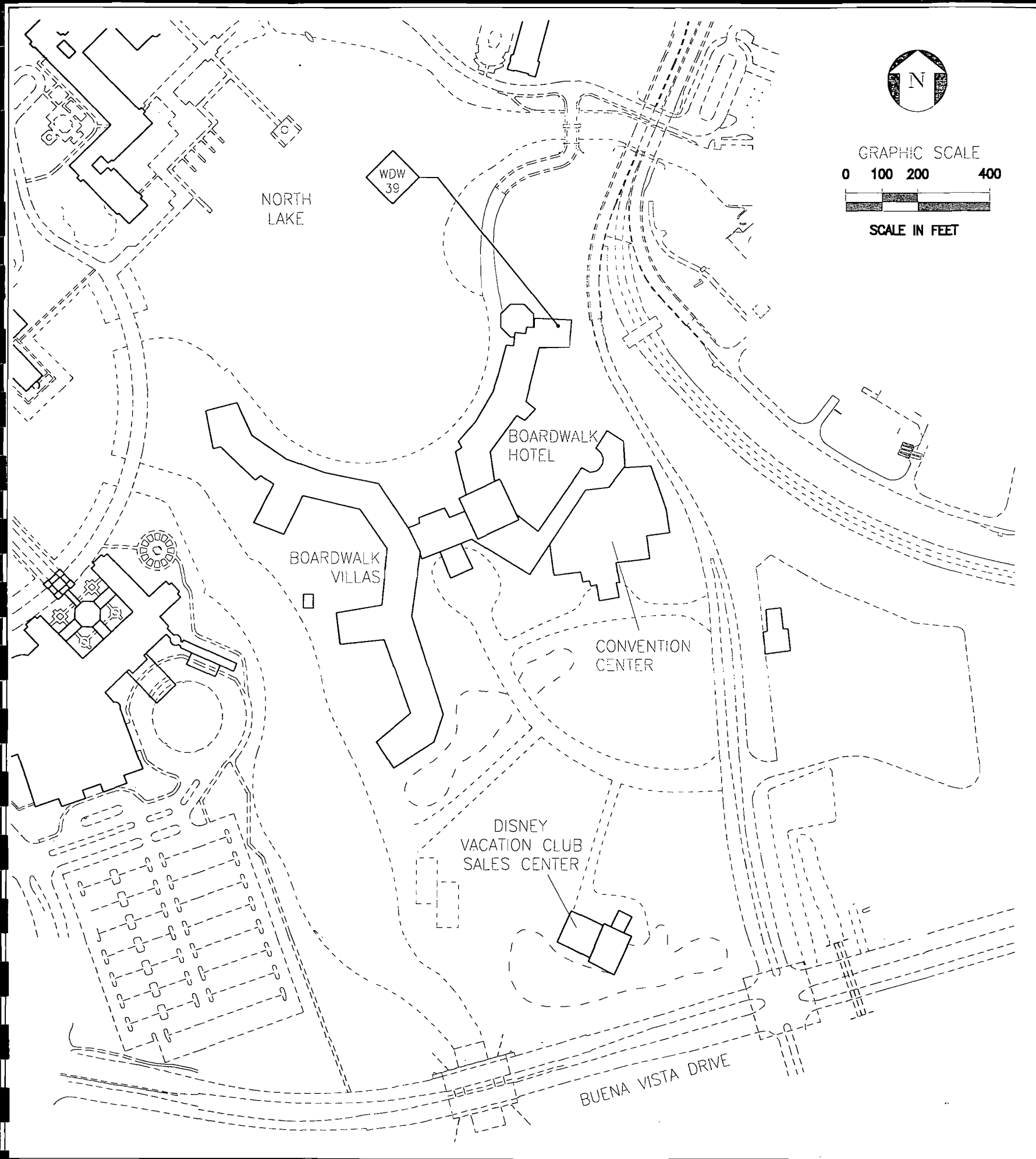

### Key To Symbols

Code	Description
WDW-39	Boardwalk Spray Booth #1

### LEGEND

 EMISSION POINT



WALT DISNEY WORLD  
EMISSION SOURCE LOCATION  
DISNEY'S BOARDWALK RESORT

**ATTACHMENT C**  
**PROCESS FLOW DIAGRAM**

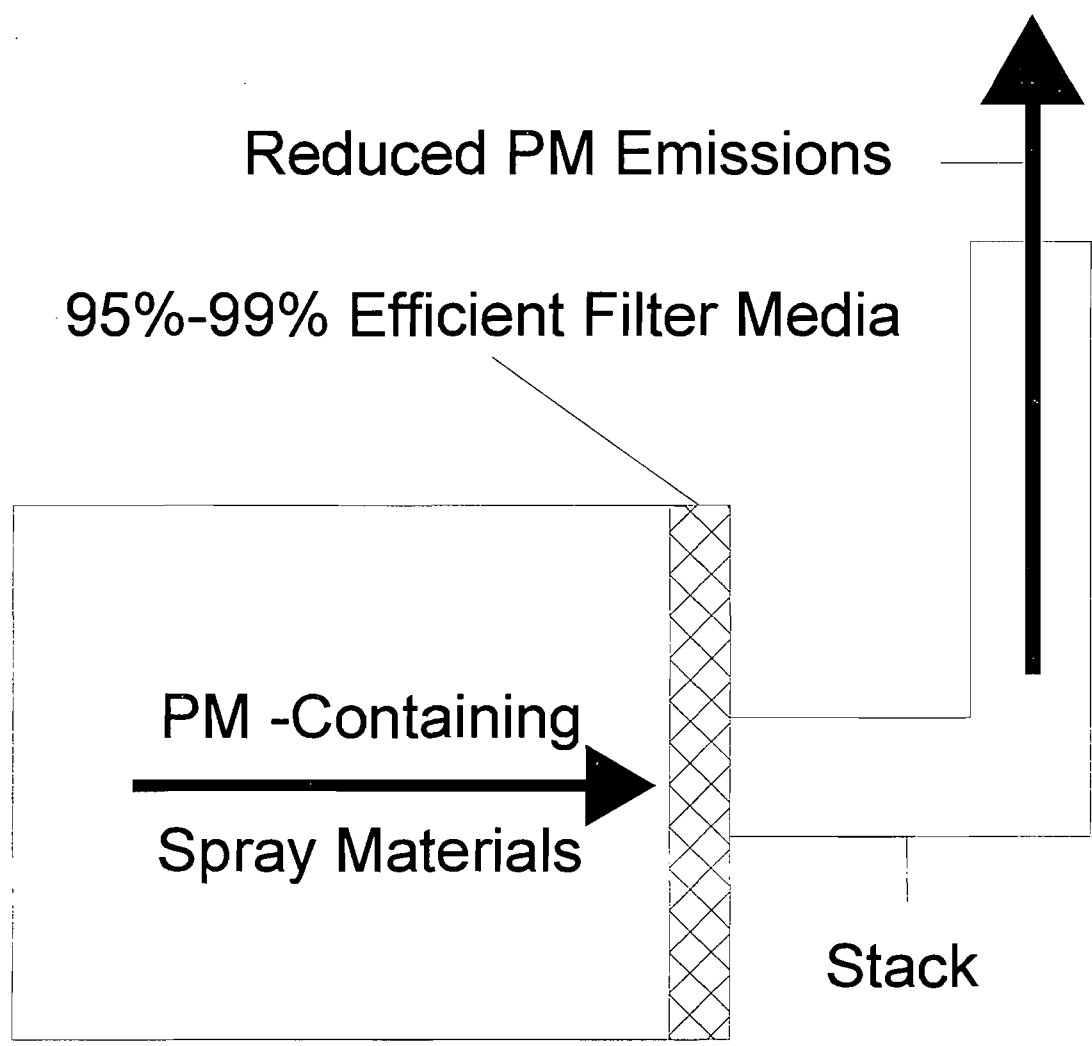

ATTACHMENT C  
PROCESS FLOW DIAGRAM  
MAGIC KINGDOM AND DISNEY'S BOARDWALK  
RESORT SPRAY BOOTHS

Walt  Disney World Co.

**ATTACHMENT D**

**MAGIC KINGDOM SPRAY BOOTH #2 SPECIFICATIONS**



**Lee Patterson Co.**

1022 W. ROBINSON ST.

ORLANDO, FL 32805

PHONE: (305) 422-4567

**PRICE QUOTATION**

QUOTATION NO. ORL 95-301

**TO: WALT DISNEY WORLD CO.  
P.O. BOX 10,000  
LK. BUENA VISTA, FL 32830  
  
ATTN: PAUL BATT, PROJ. MGR.**

**DATE: 7 DECEMBER 1995  
PROPOSED  
SHIPPING DATE: 1-2 WEEKS ARO  
TERMS: SEE ATTACHED  
TERR. NO. 99  
F.O.B. OSSEO, WI  
TO BE SHIPPED VIA MOTOR FREIGHT COLL.**

**HERE IS OUR QUOTATION ON THE GOODS NAMED, SUBJECT TO CONDITIONS NOTED:**

*CONDITIONS: The prices and terms on this quotation are not subject to verbal changes or other agreements unless approved in writing by our office. All quotations and agreements are contingent upon strikes, accidents, fires, availability of materials and all other causes beyond our control. Prices are based on costs and conditions existing on date of quotation and are subject to change by the Seller before final acceptance. Typographic and stenographic errors subject to correction. Purchaser assumes liability for patent and copyright infringement when goods are made to Purchaser's specifications. Terms inconsistent with those stated herein which may appear on Purchaser's formal order will not be binding on the Seller.*

QUANTITY	DESCRIPTION	PRICE	AMOUNT
----------	-------------	-------	--------

WE ARE PLEASED TO SUBMIT THE FOLLOWING QUOTATION FOR ONE J.B.I. PAINT SPRAY BOOTH

- 1 J.B.I. MODEL #DB-148-S, FOB OSSEO, WI
- INSIDE DIMENSIONS - 14' W X 8' H X 12' DEEP
- OVERALL DIMENSIONS - 14'4" W X 8'2" H X 16'2" OVERALL DEPTH
- CONSTRUCTION: 18 GAUGE GALVANIZED SHEET STEEL PANELS. PRE-PUNCHED & BOLTED ON 6" CENTERS.
- INCLUDES:
- 1 EA. 34" EXHAUST UNIT (14,000 CFM @ 3/8" S.P.) RATED AT 125 CFM
- 1 EA. 3 H.P. 208/230/460 VOLT, 3 PHASE MOTOR
- 4 EA. 48" 4-TUBE FLUORESCENT FIXTURES (LESS TUBES) 110 VOLTS
- 1 EA. 390046 CODE REQUIRED MANOMETER
- 1 SET FILTERED SWING TYPE PRODUCT ENTRY DOORS (13' W X 7'6" H)
- 1 EA. INDUSTRIAL STYLE EXHAUST FILTER CHAMBER
- 1 SET INTAKE & EXHAUST FILTER
- 1 LOT NECESSARY ASSEMBLY HARDWARE & DRAWINGS

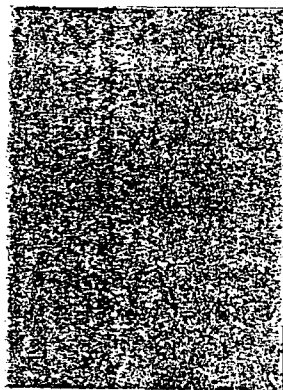
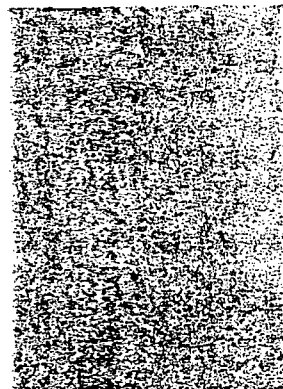

OUR PRICE TO ERECT THIS BOOTH

THIS QUOTE DOES NOT INCLUDE FIRE SUPPRESSION, ELECTRICAL CONNECTIONS, PERMITS, OR EXHAUST STACK

QUOTE VALID FOR 30 DAYS

BY:

Michael D. Shipley  
MICHAEL D. SHIPLEY

BEST AVAILABLE COPY

141

UNITS  
 1. BOOTH IS FABRICATED FROM 18GA UNPAINTED GALVANIZED SHEET STEEL, PHC-PUNCHED WITH COMPANION FLANGES.  
 2. BOOTH REINFORCED USING 14GA UNPAINTED GALVANIZED CHANNEL STIFFENERS IN ROOF.  
 3. BOOTH TO BE ASSEMBLED USING #1/2"x3/16" LONG BOLTS WITH NUTS.

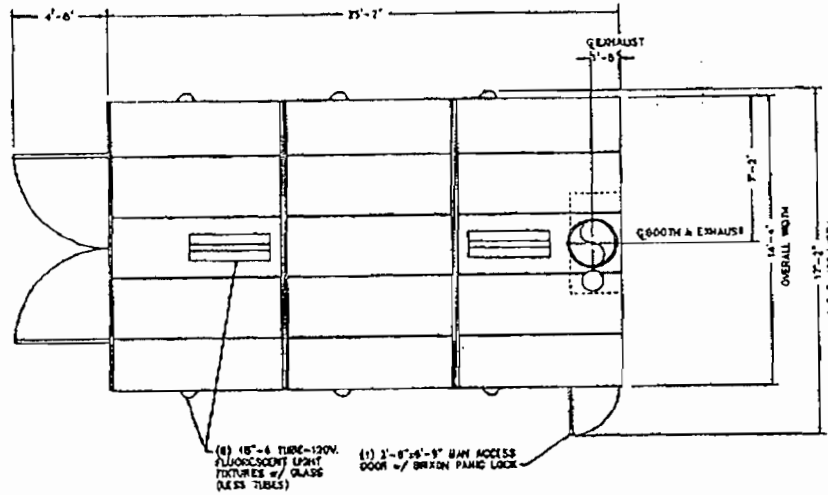

PLAN VIEW

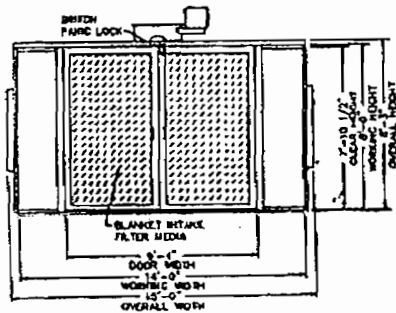

FRONT ELEVATION

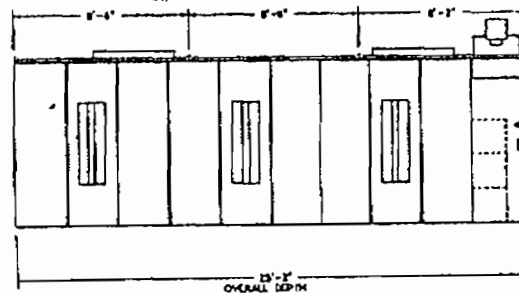

SIDE ELEVATION

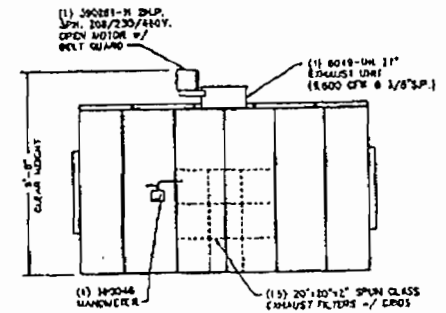

BACK ELEVATION

**JEI** SPRAY BOOTHS & SYSTEMS  
 COMPANY HEAD OFFICE - 1000 W. 10TH ST. - ST. LOUIS, MO. 63104  
 TEL. (314) 241-1200 FAX (314) 241-1201

EA-24-SB 1 4

UNIT CO-20 WELD 14:00  
 FINISH FLANNED WORK  
 JPA WQ 401-334-1200  
 1.00

## PRODUCT DESCRIPTIONS

<p><b>3000 SERIES RP STANDARD PAINT ARRESTOR</b></p> <p>The standard, original design is available in roll form and modular pads. This series provides good all-around performance for general applications and can be used for most coatings applied by the various spray coating methods. A degradable, economical solution to your overspray needs, its recommended usage consists of two pads in tandem.</p>	<table border="1"> <thead> <tr> <th>VELOCITY (fpm)</th> <th>RESISTANCE (in. w.c.)</th> </tr> </thead> <tbody> <tr> <td>100</td> <td>0.020</td> </tr> <tr> <td>200</td> <td>0.060</td> </tr> <tr> <td>300</td> <td>0.120</td> </tr> </tbody> </table>	VELOCITY (fpm)	RESISTANCE (in. w.c.)	100	0.020	200	0.060	300	0.120	<p><b>AVERAGE EFFICIENCY RANGE</b></p> <p>96.5 TO 97.5% HIGH SOLIDS BAKE ENAMEL 93.0 TO 94.0% WATERBORNE BAKE ENAMEL</p> <p>TESTED USING TWO PADS IN TANDEM</p>
VELOCITY (fpm)	RESISTANCE (in. w.c.)									
100	0.020									
200	0.060									
300	0.120									
<p><b>3100 SERIES RP STANDARD HIGH CAPACITY PAINT ARRESTORS</b></p> <p>This series has all the characteristics of the 3000 Series Paint Arrestor but is designed to hold up to two times the overspray before changing is required. Double service life makes this product ideal for high production applications and wherever a large volume of coating is applied in a relatively small booth space. The longer pad life means reduced down time, few changeovers and greater economy. Rolls or pads are used in tandem. Ideal for heavy, tacky coating and slower drying finishes. Not recommended for quick dry, lacquer type coatings.</p>	<table border="1"> <thead> <tr> <th>VELOCITY (fpm)</th> <th>RESISTANCE (in. w.c.)</th> </tr> </thead> <tbody> <tr> <td>100</td> <td>0.020</td> </tr> <tr> <td>200</td> <td>0.050</td> </tr> <tr> <td>300</td> <td>0.100</td> </tr> </tbody> </table>	VELOCITY (fpm)	RESISTANCE (in. w.c.)	100	0.020	200	0.050	300	0.100	<p><b>AVERAGE EFFICIENCY RANGE</b></p> <p>94.0 TO 96.0% HIGH SOLIDS BAKE ENAMEL 91.5 TO 92.5% WATERBORNE BAKE ENAMEL</p> <p>TESTED USING TWO PADS IN TANDEM</p>
VELOCITY (fpm)	RESISTANCE (in. w.c.)									
100	0.020									
200	0.050									
300	0.100									
<p><b>3200 SERIES SPRA-GARD HIGH EFFICIENCY PAINT ARRESTORS</b></p> <p>This overspray product is also similar to the 3000 Series, but with an added polyester backing. This increases the overall efficiency needed for very finely atomized overspray particles common with certain finishes and coating methods. Offering excellent efficiencies, this product affords a 50% reduction in overspray out the stack, and the poly backing makes it ideal for coating at any production rate. It is available in roll and pad form and its recommended use is two in tandem.</p>	<table border="1"> <thead> <tr> <th>VELOCITY (fpm)</th> <th>RESISTANCE (in. w.c.)</th> </tr> </thead> <tbody> <tr> <td>100</td> <td>0.055</td> </tr> <tr> <td>200</td> <td>0.125</td> </tr> <tr> <td>300</td> <td>0.225</td> </tr> </tbody> </table>	VELOCITY (fpm)	RESISTANCE (in. w.c.)	100	0.055	200	0.125	300	0.225	<p><b>AVERAGE EFFICIENCY RANGE</b></p> <p>98.5 TO 99.5% HIGH SOLIDS BAKE ENAMEL 97.0 TO 98.0% WATERBORNE BAKE ENAMEL 94.0 TO 95.0% LACQUER</p> <p>TESTED USING TWO PADS IN TANDEM</p>
VELOCITY (fpm)	RESISTANCE (in. w.c.)									
100	0.055									
200	0.125									
300	0.225									
<p><b>3300 SERIES SPRA-GARD HIGH EFFICIENCY PAINT ARRESTORS</b></p> <p>The finest efficiencies possible can be achieved with this series of Spra-Gard Paint Arrestors. These high efficiencies are attained through the use of a high-density polyester backing which is structurally very strong. Due to the high efficiency, only one layer of material is required and it is available in a variety of sizes, both rolls and pads.</p>	<table border="1"> <thead> <tr> <th>VELOCITY (fpm)</th> <th>RESISTANCE (in. w.c.)</th> </tr> </thead> <tbody> <tr> <td>100</td> <td>0.055</td> </tr> <tr> <td>200</td> <td>0.136</td> </tr> <tr> <td>300</td> <td>0.256</td> </tr> </tbody> </table>	VELOCITY (fpm)	RESISTANCE (in. w.c.)	100	0.055	200	0.136	300	0.256	<p><b>AVERAGE EFFICIENCY RANGE</b></p> <p>99.5 TO 99.9% HIGH SOLIDS BAKE ENAMEL 98.5 TO 99.2% WATERBORNE BAKE ENAMEL 95.0 TO 96.0% LACQUER</p> <p>TESTED USING SINGLE PAD</p>
VELOCITY (fpm)	RESISTANCE (in. w.c.)									
100	0.055									
200	0.136									
300	0.256									
<p><b>3400 SERIES SPRA-GARD HIGH CAPACITY HIGH EFFICIENCY PAINT ARRESTORS</b></p> <p>This series of Spra-Gard Paint Arrestors has all the features and advantages of the 3300 Series plus a longer service life. It is ideal for extremely high production applications, because both peak efficiency and service life can be achieved, thereby reducing downtime and increasing the time interval between changes.</p>	<table border="1"> <thead> <tr> <th>VELOCITY (fpm)</th> <th>RESISTANCE (in. w.c.)</th> </tr> </thead> <tbody> <tr> <td>100</td> <td>0.065</td> </tr> <tr> <td>200</td> <td>0.153</td> </tr> <tr> <td>300</td> <td>0.283</td> </tr> </tbody> </table>	VELOCITY (fpm)	RESISTANCE (in. w.c.)	100	0.065	200	0.153	300	0.283	<p><b>AVERAGE EFFICIENCY RANGE</b></p> <p>99.5 TO 99.9% HIGH SOLIDS BAKE ENAMEL</p> <p>TESTED USING SINGLE PAD</p>
VELOCITY (fpm)	RESISTANCE (in. w.c.)									
100	0.065									
200	0.153									
300	0.283									

## PAINT ARRESTOR PADS AND ROLLS

STOCK NO.	DESCRIPTION	QTY./PKG.
3031	20"x25" PAINT ARRESTOR	60/CARTON
3032	20"x20" PAINT ARRESTOR	60/CARTON
3020	40"x20" PAINT ARRESTOR	2/BAG
3039	40"x40" PAINT ARRESTOR	1/BAG
3131	20"x25" HIGH CAPACITY PAINT ARRESTOR	30/CARTON
3132	20"x20" HIGH CAPACITY PAINT ARRESTOR	30/CARTON
3135	20"x40" HIGH CAPACITY PAINT ARRESTOR	1/BAG
3231	20"x25" SPRA-GARD PAINT ARRESTOR	50/CARTON
3232	20"x20" SPRA-GARD PAINT ARRESTOR	50/CARTON
3251	6"x45" SPRA-GARD PAINT ARRESTOR	4/BAG
3252	7"x45" SPRA-GARD PAINT ARRESTOR	4/BAG
3253	8"x45" SPRA-GARD PAINT ARRESTOR	4/BAG
3266	30"x45" SPRA-GARD PAINT ARRESTOR	1/BAG
3331	20"x25" SPRA-GARD PAINT ARRESTOR	50/CARTON
3332	20"x20" SPRA-GARD PAINT ARRESTOR	50/CARTON
3351	6"x45" SPRA-GARD PAINT ARRESTOR	5/BAG
3352	7"x45" SPRA-GARD PAINT ARRESTOR	4/BAG
3353	8"x45" SPRA-GARD PAINT ARRESTOR	4/BAG
3366	30"x45" SPRA-GARD PAINT ARRESTOR	1/BAG

45" PRODUCT IS DESIGNED FOR OVERLAP AND POSITIVE SEAL AT VERTICAL SEAMS.  
CUSTOM SIZES ARE AVAILABLE. CONTACT MANUFACTURER FOR DETAILS.

## HARDWARE AND ACCESSORIES

STOCK NO.	DESCRIPTION	QTY./PKG.
941	20"x25"x2 1/4" HOLDING FRAME	6/CARTON
942	20"x20"x2 1/4" HOLDING FRAME	8/CARTON
1010	20" SINGLE WIRE ROD	25/TUBE
1025	25" SINGLE WIRE ROD	10/TUBE
1011	20"x25" SNAP-IN GRID	40/CARTON
1012	20"x20" SNAP-IN GRID	40/CARTON
1017	20"x20" CONVERSION GRID	10/CARTON
1018	20"x25" CONVERSION GRID	10/CARTON
1019	20"x36" CONVERSION GRID	10/CARTON
1020	CONVERSION GRID FLANGE	10/CARTON
1030	SPRA-PAK 20"Wx72"H (including grids)	1/CARTON
1015	SPRA-PAK GRID	4/CARTON
1016	SPRA-PAK UPPER SUPPORT GRID	8/CARTON

## BOOTH PAPER

STOCK NO.	DESCRIPTION
3041	36"x300' Booth Floor Paper (Kraft)
3042	42"x300' Booth Floor Paper (Kraft)
3043	60"x300' Booth Floor Paper (Kraft)
3044	72"x300' Booth Floor Paper (Kraft)

## WARRANTY

Your Research Products Corporation Paint Arrestor Overspray Collector is warranted to be free of defects in material and workmanship.

Research Products Corporation's sole and exclusive obligation under this warranty and otherwise shall be to promptly supply without charge a replacement Paint Arrestor for any which is discovered to be defective prior to use in a spraying operation, providing such Paint Arrestor is returned by you to either your supplier or to Research Products Corporation, Madison, Wisconsin 53701, not later than thirty days after discovery of any defect. Research Products Corporation shall in no manner be obligated or liable for any labor costs or other expenses, losses or damages whatsoever (other than damages for personal injuries) resulting from any such defect. This warranty shall not apply to any defects attributable to the occurrence of any casualty, mishandling or faulty installation.

The foregoing express warranty is made in lieu of any and all other warranties, either express or implied, with respect to said Paint Arrestors, and all such other warranties, including implied warranties of merchantability and fitness for any particular purpose, are herewith expressly excluded.

**IRIP<sup>®</sup> Paint Arrestors**

Research Products Corporation  
Products for better air... everywhere!  
1015 East Washington Avenue • Madison, WI 53703  
Call 1-800/334-6011 • FAX 608/257-4357

BEST AVAILABLE COPY

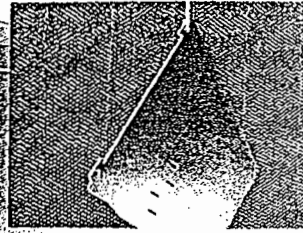
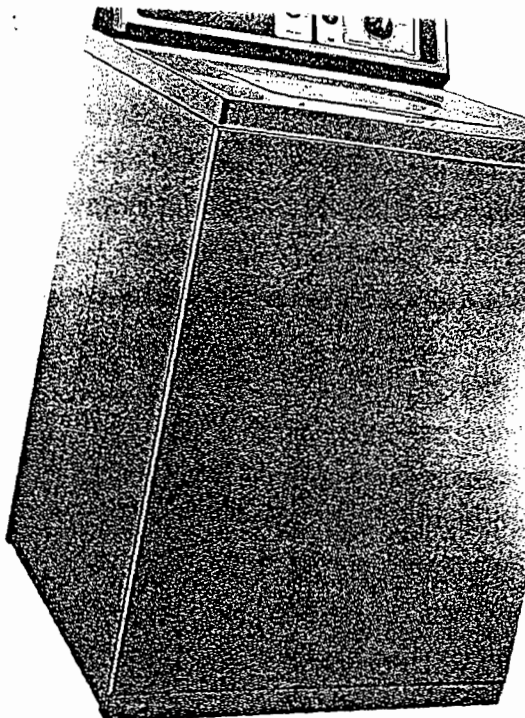

**PERFORMANCE INFORMATION**

Any overspray collection system should be evaluated on three performance criteria. First, *efficiency* in removing paint particulate from the exhaust air before it reaches the stack. Second, *resistance* to

airflow, which is the amount of energy used to move the required air through the system.

Finally, a long *service life* of the product. There are RP Paint Arrestors available that are 99%+ efficient and have very low resistance to airflow. Therefore, they require minimum energy and have a long service life, retaining a significant volume of overspray before changing is required.

All performance information shown was obtained using equipment similar to that incorporated by the American Society of Heating, Refrigeration and Air Conditioning Engineers (*ASHRAE*) in evaluating performance of air cleaning media. Detailed information on the equipment, the testing procedure, and test results are available by writing for Reprint No. 4259.

**RP PAINT ARRESTOR APPLICATION/PERFORMANCE**

	3000 SERIES	3100 SERIES	3200 SERIES	3300 SERIES
ADHESIVES	■	■	■	■
AIR-DRY ENAMELS	■	■	■	■
BAKE-DRY ENAMELS	■	■	■	■
CLEAR COATS	■	■	■	■
EPOXIES	■	■	■	■
FIBERGLASS	■	■	■	■
GEL COATS	■	■	■	■
HIGH SOLIDS-ENAMELS	■	■	■	■
LACQUERS	■	■	■	■
PRIMERS-AIR DRY	■	■	■	■
STAINS	■	■	■	■
SEALERS	■	■	■	■
TEFLON	■	■	■	■
URETHANES	■	■	■	■
WATERBORNES	■	■	■	■

■ = GOOD ■ = BETTER ■ = BEST

THIS CHART INDICATES THE TYPICAL APPLICATION PERFORMANCE FOR VARIOUS TYPES OF RP PAINT ARRESTORS, BASED ON THE KEY PERFORMANCE FACTORS OF EFFICIENCY, RESISTANCE TO AIRFLOW, AND SERVICE LIFE. SINCE CONDITIONS VARY, A CAREFUL REVIEW OF YOUR SPECIFIC NEEDS MAY BE NECESSARY TO DETERMINE THE BEST RP PAINT ARRESTOR FOR YOUR APPLICATION.

**EASY TO SERVICE**

For RP Paint Arrestor pads using two layers of product, the front Paint Arrestor is discarded when it becomes loaded with paint, and a new arrestor installed. Replacing the rear Paint Arrestor in tandem applications is necessary only at extended intervals. When the rear pad shows signs of loading, it can be moved to the front and a new RP Paint Arrestor positioned at the rear. This simple procedure assures maximum service life with minimum labor. Loaded or "used" Paint Arrestors should be stored in a water-filled container until disposed of in accordance with appropriate regulations regarding paint residue.

**CODE COMPLIANCE**

RP Paint Arrestors help you meet these codes and requirements:

- N.E.P.A. Standard No. 33

- Environmental Protection Agency (EPA)

- State and Municipal Governments

**ATTACHMENT E**

**BOARDWALK RESORT SPRAY BOOTH #1 SPECIFICATIONS**

**Lee Patterson Co.**  
 1022 W. ROBINSON ST.  
 ORLANDO, FL 32805  
 PHONE: (305) 422-4567

**PRICE QUOTATION**

QUOTATION NO. LPC-250196  
 BID NO. 0791C-96RM  
 DATE: 25, JANUARY 1996  
 PROPOSED  
 SHIPPING DATE: 6 - 8 WKS ARO  
 TERMS: TO BE ANNOUNCED  
 TERR. NO. 99  
 F.O.B. OSSEO, WI  
 TO BE SHIPPED VIA MOTOR FREIGHT COLL.

TO: WALT DISNEY WORLD CO.  
 DISNEY BOARDWALK RESORT  
 ATTN: BOB MCCORMACK  
 FAX: 828-8928  
 PHONE: 934-7270

**HERE IS OUR QUOTATION ON THE GOODS NAMED, SUBJECT TO CONDITIONS NOTED:**

*CONDITIONS: The prices and terms on this quotation are not subject to verbal changes or other agreements unless approved in writing by our office. All quotations and agreements are contingent upon strikes, accidents, fires, availability of materials and all other causes beyond our control. Prices are based on costs and conditions existing on date of quotation and are subject to change by the Seller before final acceptance. Typographic and stenographic errors subject to correction. Purchaser assumes liability for patent and copyright infringement when goods are made to Purchaser's specifications. Terms inconsistent with those stated herein which may appear on Purchaser's formal order will not be binding on the Seller.*

QUANTITY	DESCRIPTION	PRICE	AMOUNT
	WE ARE PLEASED TO QUOTE THE FOLLOWING SPECIAL FLOOR STYLE, PRESSURIZED, REVERSE FLOW, DRY ARRESTOR PAINT SPRAY BOOTH WITH ELECTRIC HEATED AIR MAKE-UP UNIT.		
1	MODEL NO. IDB-108PSB-5 SPRAY BOOTH INSIDE WORKING DIMENSIONS: 8'H X 10'W X 10'D OUTSIDE DIMENSIONS: 8'2"H X 10'4" W X 12'4"D (SEE ATTACHED FOR ADDITIONAL SPECIFICATIONS)	\$	8,750.00
1	MODEL NO. ECFA-20 ELECTRIC HEATED AIR MAKE-UP UNIT (SEE ATTACHED PRODUCT DATA SHEETS FOR ADDITIONAL SPECIFICATIONS)	<del>43,155.00</del>	<del>43,155.00</del> Delete
1	ERECTION OF PAINT SPRAY BOOTH BY LEE PATTERSON CO. PERSONNEL (SEE ATTACHED FOR RESPONSIBILITIES)		725.00
	OPTIONS		1750.00
	A. NEMA 12 DELUXE CONTROL PANEL, ADD.....		<del>2,500.00</del>
	B. PERSONNEL ACCESS DOOR, ADD....		<del>435.00</del> Delete
	C. 24" X 18" OBSERVATION WINDOW, ADD...		125.00
	D. 30" Intake Fan Assembly, Add...		1480.00
	PLEASE NOTE PRICES DO NOT INCLUDE FIRE SUPPRESSION, DUCT WORK, ELECTRICAL, FREIGHT OR ANY APPLICABLE TAXES.		

QUOTE VALID FOR 30 DAYS

BY:

Michael D. Shipley  
 MICHAEL D. SHIPLEY

**BOOTH CONSTRUCTION / STRUCTURE**

The booth walls and top of exhaust chambers are manufactured from 18 gauge, galvanized steel sheets.

All panels are pre-punched with 5/16" holes located on 6" centers, with 2" precision-exterior companion flanges for easy nut and bolt assembly providing a smooth interior surface.

**EXHAUST FAN ASSEMBLY:** Size: 34" (10,000 CFM @ 1/4" s.p., for a velocity of 125 FPM)

Heavy duty, non-sparking, polypropylene blade with precision balancing. Fan is dual V-belt driven with a variable-pitch motor pulley, mounted on a precision ground steel shaft, located within the pre-lubricated, removable ball bearing assembly. Bearing and belts are located outside of the exhaust airstream.

**ELECTRIC MOTOR H.P.:** 3

Totally Enclosed, Fan-Cooled Motor - 1750 rpm, 208/230/460 volt, 3 phase, 60 hertz: integral rotor fans direct cooling air over windings - reducing heat and noise and prolonging the motor life.

**LIGHT FIXTURE(S):** Quantity: 4

48" 4-tube fluorescent light fixtures, 110 volt.

Fixture is E.T.L. listed, vapor-proof, Class I, Division 2, Groups A B C D.

Includes 15" x 53" x 1/4" clear tempered glass lens and gasketed seal

Fixture accepts 40 watt bi-pin fluorescent (lamps not included).

Light Assembly is designed to be serviced from the rear of the fixture.

**EXHAUST FILTERS:** Quantity: 20

Paint Arrestor Filters supplied with this booth are made from continuous filament glass fibers with an open weave pattern for maximum paint collection. These filters are approved and listed: Class II by Underwriters Laboratories and conform to OSHA Standards size: 20" x 20" x 2" deep.

**FILTER (GRID) RETAINERS:** Quantity: 20 sets

Designed to provide rigid retention of the exhaust filters for maximum collection of air pollutants.

**DRAFT GAUGE (MANOMETER):**

Visible monitor of filter loading-diminished air flow within the booth, a standard by which to replace the filters.

*Also Includes:*

1 set Solid swing type product entry doors (6' Wide x 6'2" High)

1 ea. Bridge type intake filter chamber

1 set Exhaust chamber turning vanes to balance booth exhaust

1 set Intake filters

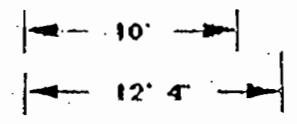
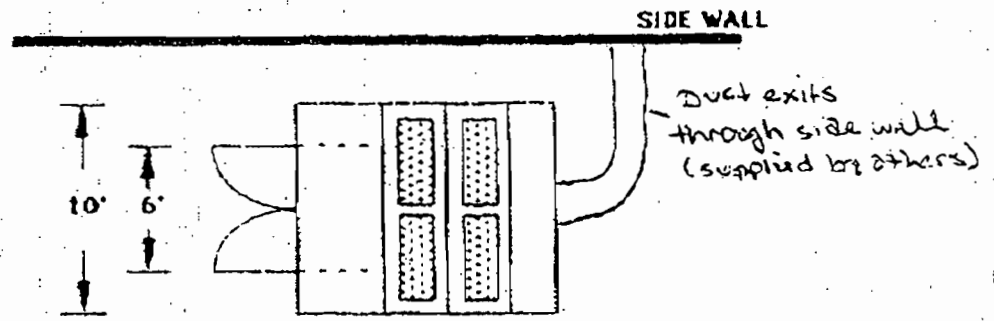

PLAN VIEW

Air intake fan  
(will also duct from  
side wall)

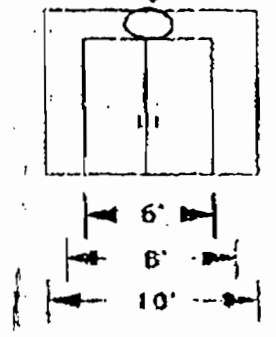

END VIEW

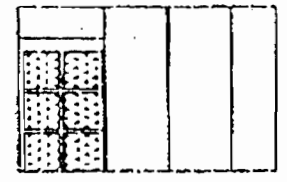
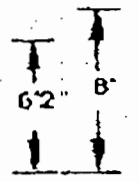

SIDE VIEW



## BEST AVAILABLE COPY

## PRODUCT DESCRIPTIONS

<b>3000 SERIES RP STANDARD PAINT ARRESTOR</b> The standard, original design is available in roll form and modular pads. This series provides good all-around performance for general applications and can be used for most coatings applied by the various spray coating methods. A degradable, economical solution to your overspray needs, its recommended usage consists of two pads in tandem.	<table border="1"> <thead> <tr> <th>VELOCITY (fpm)</th> <th>RESISTANCE (in. w.c.)</th> </tr> </thead> <tbody> <tr> <td>100</td> <td>0.020</td> </tr> <tr> <td>200</td> <td>0.060</td> </tr> <tr> <td>300</td> <td>0.120</td> </tr> </tbody> </table>	VELOCITY (fpm)	RESISTANCE (in. w.c.)	100	0.020	200	0.060	300	0.120	<table border="1"> <thead> <tr> <th>AVERAGE EFFICIENCY RANGE</th> </tr> </thead> <tbody> <tr> <td>96.5 TO 97.5% HIGH SOLIDS BAKE ENAMEL</td> </tr> <tr> <td>93.0 TO 94.0% WATERBORNE BAKE ENAMEL</td> </tr> <tr> <td>TESTED USING TWO PADS IN TANDEM</td> </tr> </tbody> </table>	AVERAGE EFFICIENCY RANGE	96.5 TO 97.5% HIGH SOLIDS BAKE ENAMEL	93.0 TO 94.0% WATERBORNE BAKE ENAMEL	TESTED USING TWO PADS IN TANDEM	
VELOCITY (fpm)	RESISTANCE (in. w.c.)														
100	0.020														
200	0.060														
300	0.120														
AVERAGE EFFICIENCY RANGE															
96.5 TO 97.5% HIGH SOLIDS BAKE ENAMEL															
93.0 TO 94.0% WATERBORNE BAKE ENAMEL															
TESTED USING TWO PADS IN TANDEM															
<b>3100 SERIES RP STANDARD HIGH CAPACITY PAINT ARRESTORS</b> This series has all the characteristics of the 3000 Series Paint Arrestor but is designed to hold up to two times the overspray before changing is required. Double service life makes this product ideal for high production applications and wherever a large volume of coating is applied in a relatively small booth space. The longer pad life means reduced down time, few changeovers and greater economy. Rolls or pads are used in tandem. Ideal for heavy, tacky coating and slower drying finishes. Not recommended for quick dry, lacquer type coatings.	<table border="1"> <thead> <tr> <th>VELOCITY (fpm)</th> <th>RESISTANCE (in. w.c.)</th> </tr> </thead> <tbody> <tr> <td>100</td> <td>0.020</td> </tr> <tr> <td>200</td> <td>0.050</td> </tr> <tr> <td>300</td> <td>0.100</td> </tr> </tbody> </table>	VELOCITY (fpm)	RESISTANCE (in. w.c.)	100	0.020	200	0.050	300	0.100	<table border="1"> <thead> <tr> <th>AVERAGE EFFICIENCY RANGE</th> </tr> </thead> <tbody> <tr> <td>94.0 TO 96.0% HIGH SOLIDS BAKE ENAMEL</td> </tr> <tr> <td>91.5 TO 92.5% WATERBORNE BAKE ENAMEL</td> </tr> <tr> <td>TESTED USING TWO PADS IN TANDEM</td> </tr> </tbody> </table>	AVERAGE EFFICIENCY RANGE	94.0 TO 96.0% HIGH SOLIDS BAKE ENAMEL	91.5 TO 92.5% WATERBORNE BAKE ENAMEL	TESTED USING TWO PADS IN TANDEM	
VELOCITY (fpm)	RESISTANCE (in. w.c.)														
100	0.020														
200	0.050														
300	0.100														
AVERAGE EFFICIENCY RANGE															
94.0 TO 96.0% HIGH SOLIDS BAKE ENAMEL															
91.5 TO 92.5% WATERBORNE BAKE ENAMEL															
TESTED USING TWO PADS IN TANDEM															
<b>3200 SERIES SPRA-GARD HIGH EFFICIENCY PAINT ARRESTORS</b> This overspray product is also similar to the 3000 Series, but with an added polyester backing. This increases the overall efficiency needed for very finely atomized overspray particles common with certain finishes and coating methods. Offering excellent efficiencies, this product affords a 50% reduction in overspray out the stack, and the poly backing makes it ideal for coating at any production rate. It is available in roll and pad form and its recommended use is two in tandem.	<table border="1"> <thead> <tr> <th>VELOCITY (fpm)</th> <th>RESISTANCE (in. w.c.)</th> </tr> </thead> <tbody> <tr> <td>100</td> <td>0.055</td> </tr> <tr> <td>200</td> <td>0.125</td> </tr> <tr> <td>300</td> <td>0.225</td> </tr> </tbody> </table>	VELOCITY (fpm)	RESISTANCE (in. w.c.)	100	0.055	200	0.125	300	0.225	<table border="1"> <thead> <tr> <th>AVERAGE EFFICIENCY RANGE</th> </tr> </thead> <tbody> <tr> <td>98.5 TO 99.5% HIGH SOLIDS BAKE ENAMEL</td> </tr> <tr> <td>97.0 TO 98.0% WATERBORNE BAKE ENAMEL</td> </tr> <tr> <td>94.0 TO 95.0% LACQUER</td> </tr> <tr> <td>TESTED USING TWO PADS IN TANDEM</td> </tr> </tbody> </table>	AVERAGE EFFICIENCY RANGE	98.5 TO 99.5% HIGH SOLIDS BAKE ENAMEL	97.0 TO 98.0% WATERBORNE BAKE ENAMEL	94.0 TO 95.0% LACQUER	TESTED USING TWO PADS IN TANDEM
VELOCITY (fpm)	RESISTANCE (in. w.c.)														
100	0.055														
200	0.125														
300	0.225														
AVERAGE EFFICIENCY RANGE															
98.5 TO 99.5% HIGH SOLIDS BAKE ENAMEL															
97.0 TO 98.0% WATERBORNE BAKE ENAMEL															
94.0 TO 95.0% LACQUER															
TESTED USING TWO PADS IN TANDEM															
<b>3300 SERIES SPRA-GARD HIGH EFFICIENCY PAINT ARRESTORS</b> The finest efficiencies possible can be achieved with this series of Spra-Gard Paint Arrestors. These high efficiencies are attained through the use of a high-density polyester backing which is structurally very strong. Due to the high efficiency, only one layer of material is required and it is available in a variety of sizes, both rolls and pads.	<table border="1"> <thead> <tr> <th>VELOCITY (fpm)</th> <th>RESISTANCE (in. w.c.)</th> </tr> </thead> <tbody> <tr> <td>100</td> <td>0.055</td> </tr> <tr> <td>200</td> <td>0.136</td> </tr> <tr> <td>300</td> <td>0.256</td> </tr> </tbody> </table>	VELOCITY (fpm)	RESISTANCE (in. w.c.)	100	0.055	200	0.136	300	0.256	<table border="1"> <thead> <tr> <th>AVERAGE EFFICIENCY RANGE</th> </tr> </thead> <tbody> <tr> <td>99.5 TO 99.9% HIGH SOLIDS BAKE ENAMEL</td> </tr> <tr> <td>98.5 TO 99.2% WATERBORNE BAKE ENAMEL</td> </tr> <tr> <td>95.0 TO 96.0% LACQUER</td> </tr> <tr> <td>TESTED USING SINGLE PAD</td> </tr> </tbody> </table>	AVERAGE EFFICIENCY RANGE	99.5 TO 99.9% HIGH SOLIDS BAKE ENAMEL	98.5 TO 99.2% WATERBORNE BAKE ENAMEL	95.0 TO 96.0% LACQUER	TESTED USING SINGLE PAD
VELOCITY (fpm)	RESISTANCE (in. w.c.)														
100	0.055														
200	0.136														
300	0.256														
AVERAGE EFFICIENCY RANGE															
99.5 TO 99.9% HIGH SOLIDS BAKE ENAMEL															
98.5 TO 99.2% WATERBORNE BAKE ENAMEL															
95.0 TO 96.0% LACQUER															
TESTED USING SINGLE PAD															
<b>3400 SERIES SPRA-GARD HIGH CAPACITY HIGH EFFICIENCY PAINT ARRESTORS</b> This series of Spra-Gard Paint Arrestors has all the features and advantages of the 3300 Series plus a longer service life. It is ideal for extremely high production applications, because both peak efficiency and service life can be achieved, thereby reducing downtime and increasing the time interval between changes.	<table border="1"> <thead> <tr> <th>VELOCITY (fpm)</th> <th>RESISTANCE (in. w.c.)</th> </tr> </thead> <tbody> <tr> <td>100</td> <td>0.065</td> </tr> <tr> <td>200</td> <td>0.153</td> </tr> <tr> <td>300</td> <td>0.283</td> </tr> </tbody> </table>	VELOCITY (fpm)	RESISTANCE (in. w.c.)	100	0.065	200	0.153	300	0.283	<table border="1"> <thead> <tr> <th>AVERAGE EFFICIENCY RANGE</th> </tr> </thead> <tbody> <tr> <td>99.5 TO 99.9% HIGH SOLIDS BAKE ENAMEL</td> </tr> <tr> <td>TESTED USING SINGLE PAD</td> </tr> </tbody> </table>	AVERAGE EFFICIENCY RANGE	99.5 TO 99.9% HIGH SOLIDS BAKE ENAMEL	TESTED USING SINGLE PAD		
VELOCITY (fpm)	RESISTANCE (in. w.c.)														
100	0.065														
200	0.153														
300	0.283														
AVERAGE EFFICIENCY RANGE															
99.5 TO 99.9% HIGH SOLIDS BAKE ENAMEL															
TESTED USING SINGLE PAD															

## PAINT ARRESTOR PADS AND ROLLS

STOCK NO.	DESCRIPTION	QTY./PKG.
3031	20"x25" PAINT ARRESTOR	60/CARTON
3032	20"x20" PAINT ARRESTOR	60/CARTON
3020	40"x20" PAINT ARRESTOR	2/BAG
3039	40"x40" PAINT ARRESTOR	1/BAG
3131	20"x25" HIGH CAPACITY PAINT ARRESTOR	30/CARTON
3132	20"x20" HIGH CAPACITY PAINT ARRESTOR	30/CARTON
3135	20"x40" HIGH CAPACITY PAINT ARRESTOR	1/BAG
3231	20"x25" SPRA-GARD PAINT ARRESTOR	50/CARTON
3232	20"x20" SPRA-GARD PAINT ARRESTOR	50/CARTON
3251	6"x45" SPRA-GARD PAINT ARRESTOR	4/BAG
3252	7"x45" SPRA-GARD PAINT ARRESTOR	4/BAG
3253	8"x45" SPRA-GARD PAINT ARRESTOR	4/BAG
3266	30"x45" SPRA-GARD PAINT ARRESTOR	1/BAG
3331	20"x25" SPRA-GARD PAINT ARRESTOR	50/CARTON
3332	20"x20" SPRA-GARD PAINT ARRESTOR	50/CARTON
3351	6"x45" SPRA-GARD PAINT ARRESTOR	5/BAG
3352	7"x45" SPRA-GARD PAINT ARRESTOR	4/BAG
3353	8"x45" SPRA-GARD PAINT ARRESTOR	4/BAG
3366	30"x45" SPRA-GARD PAINT ARRESTOR	1/BAG

PRODUCT IS DESIGNED FOR OVERLAP AND POSITIVE SEAL AT VERTICAL SEAMS.

CUSTOM SIZES ARE AVAILABLE. CONTACT MANUFACTURER FOR DETAILS.

## HARDWARE AND ACCESSORIES

STOCK NO.	DESCRIPTION	QTY./PKG.
941	20"x25"x2 1/2" HOLDING FRAME	6/CARTON
942	20"x20"x2 1/2" HOLDING FRAME	8/CARTON
1010	20" SINGLE WIRE ROD	25/TUBE
1025	25" SINGLE WIRE ROD	10/TUBE
1011	20"x25" SNAP-IN GRID	40/CARTON
1012	20"x20" SNAP-IN GRID	40/CARTON
1017	20"x20" CONVERSION GRID	10/CARTON
1018	20"x25" CONVERSION GRID	10/CARTON
1019	20"x36" CONVERSION GRID	10/CARTON
1020	CONVERSION GRID FLANGE	10/CARTON
1030	SPRA-PAK 20"Wx72"H (including grids)	1/CARTON
1015	SPRA-PAK GRID	4/CARTON
1016	SPRA-PAK UPPER SUPPORT GRID	8/CARTON

## BOOTH PAPER

STOCK NO.	DESCRIPTION
3041	36"x300" Booth Floor Paper (Kraft)
3042	42"x300" Booth Floor Paper (Kraft)
3043	60"x300" Booth Floor Paper (Kraft)
3044	72"x300" Booth Floor Paper (Kraft)

## WARRANTY

Your Research Products Corporation Paint Arrestor Overspray Collector is warranted to be free of defects in material and workmanship.

Research Products Corporation's sole and exclusive obligation under this warranty and otherwise shall be to promptly supply without charge a replacement Paint Arrestor for any which is discovered to be defective prior to use in a spraying operation, providing such Paint Arrestor is returned by you to either your supplier or to Research Products Corporation, Madison, Wisconsin 53701, not later than thirty days after discovery of any defect. Research Products Corporation shall in no manner be obligated or liable for any labor costs or other expenses, losses or damages whatsoever (other than damages of a personal injuries) resulting from any such defect. This warranty shall not apply to any defects attributable to the occurrence of any casualty, mishandling or faulty installation.

The foregoing express warranty is made in lieu of any and all other warranties, either express or implied, with respect to said Paint Arrestors, and all such other warranties, including implied warranties of merchantability and fitness for a particular purpose.

**IRP® Paint Arrestors**

Research Products Corporation  
 Products for better air... everywhere!  
 1015 East Washington Avenue • Madison, WI 53703  
 Call 1-800/334-6011 • FAX 608/257-4357

BEST AVAILABLE COPY

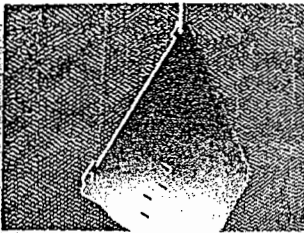
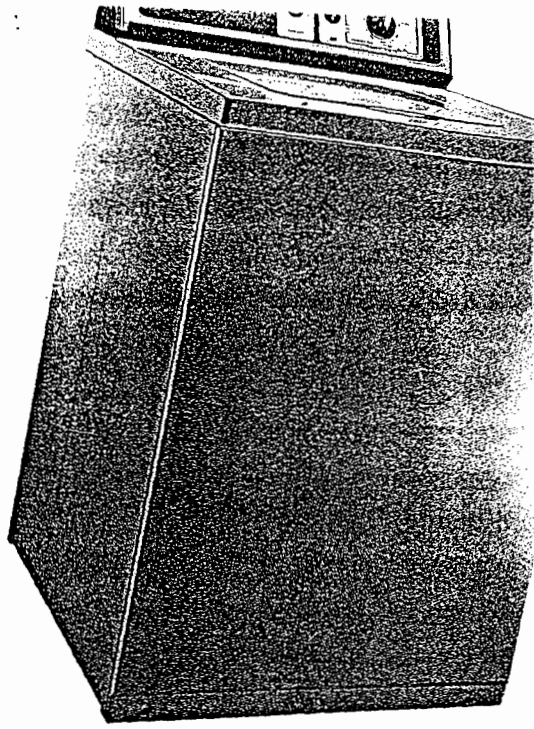

**PERFORMANCE INFORMATION**

Any overspray collection system should be evaluated on three performance criteria. First, *efficiency* in removing paint particulate from the exhaust air before it reaches the stack. Second, *resistance* to

airflow, which is the amount of energy used to move the required air through the system.

Finally, a long *service life* of the product. There are RP Paint Arrestors available that are 99%+ efficient and have very low resistance to airflow. Therefore, they require minimum energy and have a long service life, retaining a significant volume of overspray before changing is required.

All performance information shown was obtained using equipment similar to that incorporated by the American Society of Heating, Refrigeration and Air Conditioning Engineers (*ASHRAE*) in evaluating performance of air cleaning media. Detailed information on the equipment, the testing procedure, and test results are available by writing for Reprint No. 4259.

**RP PAINT ARRESTOR APPLICATION/PERFORMANCE**

	3000 SERIES	3100 SERIES	3200 SERIES	3300 SERIES
ADHESIVES	■	■	■	■
AIR-DRY ENAMELS	■	■	■	■
BAKE-DRY ENAMELS	■	■	■	■
CLEAR COATS	■	■	■	■
EPOXIES	■	■	■	■
FIBERGLASS	■	■	■	■
GEL COATS	■	■	■	■
HIGH SOLIDS-ENAMELS	■	■	■	■
LACQUERS	■	■	■	■
PRIMERS-AIR DRY	■	■	■	■
STAINS	■	■	■	■
SEALERS	■	■	■	■
TEFLON	■	■	■	■
URETHANES	■	■	■	■
WATERBORNES	■	■	■	■

■=GOOD ■=BETTER ■=BEST

THIS CHART INDICATES THE TYPICAL APPLICATION PERFORMANCE FOR VARIOUS TYPES OF RP PAINT ARRESTORS, BASED ON THE KEY PERFORMANCE FACTORS OF EFFICIENCY, RESISTANCE TO AIRFLOW, AND SERVICE LIFE. SINCE CONDITIONS VARY, A CAREFUL REVIEW OF YOUR SPECIFIC NEEDS MAY BE NECESSARY TO DETERMINE THE BEST RP PAINT ARRESTOR FOR YOUR APPLICATION.

**EASY TO SERVICE**

For RP Paint Arrestor pads using two layers of product, the front Paint Arrestor is discarded when it becomes loaded with paint, and a new arrestor installed. Replacing the rear Paint Arrestor in tandem applications is necessary only at extended intervals. When the rear pad shows signs of loading, it can be moved to the front and a new RP Paint Arrestor positioned at the rear. This simple procedure assures maximum service life with minimum labor. Loaded or "used" Paint Arrestors should be stored in a water-filled container until disposed of in accordance with appropriate regulations regarding paint residue.

**CODE COMPLIANCE**

RP Paint Arrestors help you meet these codes and requirements:

- N.E.P.A. Standard No. 33

- Environmental Protection Agency (EPA)

- State and Municipal Governments