



State of Florida
DEPARTMENT OF ENVIRONMENTAL REGULATION

| For Routing To Other Than The Addressee | |
|---|-----------------|
| To: _____ | Location: _____ |
| To: _____ | Location: _____ |
| To: _____ | Location: _____ |
| From: _____ | Date: _____ |

Interoffice Memorandum

TO: Steve Smallwood
FROM: Clair Fancy *I signed for Steve as he is on vacation*
DATE: June 20, 1990
SUBJ: Modification of Permit Number: AC 05-151435
Sea Ray Boats, Inc.

Attached for your approval and signature is a letter modifying the emission factors of Sea Ray Boat's permit for their Sykes Creek boat plant. The new factors more accurately reflect the actual emissions from the facility.

I recommend your approval and signature.

CF/JR/plm

Attachment



Florida Department of Environmental Regulation

Twin Towers Office Bldg. • 2600 Blair Stone Road • Tallahassee, Florida 32399-2400

Bob Martinez, Governor

Dale Twachmann, Secretary

John Shearer, Assistant Secretary

June 20, 1990

CERTIFIED MAIL - RETURN RECEIPT REQUESTED

Mr. John A. Cronkhite
Sr. Vice President/General Counsel
Sea Ray Boats, Inc.
2600 Sea Ray Blvd.
Knoxville, TN 37914

Dear Mr. Cronkhite:

Re: Revised Emission Factors - Sykes Creek Facility
(Permit No. AC 05-151435)

The above permit is amended as stated below to reflect the revised emission factors in your letter dated May 7, 1990:

Present Specific Condition No. 4:

4. Hydrocarbon emissions (VOC) shall not exceed the following calculated values and total VOC emissions from the facility shall not exceed 30 lbs/hr, 480 lbs/day (30 day average), and 57.5 tons/year. Compliance shall be demonstrated by applying the following raw material utilization rates and emission factors over a 90-day period:

| | Utilization Rate lbs/hr | Emission Factor | Emissions lbs/hr |
|-----------------------|----------------------------|--------------------|---------------------|
| Styrene (Resin) | 119.5 | 0.06 | 7.17 |
| Styrene (Gel Coat) | 14.9 | 0.30 | 4.46 |
| Methyl Methacrylate | 49.5 | 0.05 | 2.48 |
| MEKP | 4.7 | 0.10 | 0.47 |
| 1,1,1-Trichloroethane | 3.5 | 0.60 | 2.10 |
| Acetone | 6.25 | 1.00 | 6.25 |
| Bottom Paint | 11.7 | 0.60 | 7.02 |

New Specific Condition No. 4:

4. Hydrocarbon emissions (VOC) shall not exceed the following calculated values and total VOC emissions from the facility shall not exceed 30 lbs/hr, 480 lbs/day (30 day average), and 57.5 tons/year. Compliance shall be demonstrated by applying the following raw material utilization rates and emission factors over a 90-day period.

Mr. John A. Cronkhite
Page 2
June 20, 1990

New Specific Condition No. 4 cont'd:

| | Utilization Rate lbs/hr | Emission Factor | Emissions lbs/hr |
|-----------------------|----------------------------|--------------------|---------------------|
| Styrene (Resin) | 119.5 | 0.06 | 7.17 |
| Styrene (Gel Coat) | 14.9 | 0.30 | 4.46 |
| Methyl Methacrylate | 49.5 | 0.05 | 2.48 |
| MEKP | 4.7 | 0.10 | 0.47 |
| 1,1,1-Trichloroethane | 3.5 | 0.67 | 2.34 |
| Acetone | 6.3 | 1.00 | 6.30 |
| Bottom Paint | 11.7 | 0.60 | 7.02 |

Present Specific Condition No. 8:

8. By January 31, 1990, Sea Ray Boats shall submit a conceptual plan and potential course of action that will provide the Department with reasonable assurance that objectionable odors and toxic air pollutants in quantities that could exceed acceptable ambient concentrations will not be discharged off of the facility's property boundary or where the public has access, whichever is closest, pursuant to F.A.C. Rules 17-2.200 and 17-2.620(1) and (2). The plan should contain at a minimum, but not be limited to, various control system strategies that might be installed to reduce or eventually eliminate emissions of VOC/OS from each type of operation, associated time and cost analyses, and VOC/OS substitutes.

New Specific Condition No. 8:

8. By January 31, 1991, Sea Ray Boats shall submit a conceptual plan and potential course of action that will provide the Department with reasonable assurance that objectionable odors and toxic air pollutants in quantities that could exceed acceptable ambient concentrations will not be discharged off of the facility's property boundary or where the public has access, whichever is closest, pursuant to F.A.C. Rules 17-2.200 and 17-2.620(1) and (2). The plan should contain at a minimum, but not be limited to, various control system strategies that might be installed to reduce or eventually eliminate emissions of VOC/OS from each type of operation, associated time and cost analyses, and VOC/OS substitutes.

Mr. John A. Cronkhite
Page 3
June 20, 1990

This amendment letter shall become attachment No. 3 to your construction permit AC 05-151435.

Sincerely,

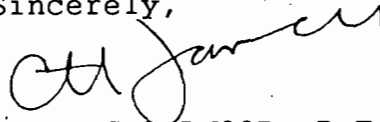

pr

STEVE SMALLWOOD, P.E.
Director
Division of Air Resources
Management

SS/JR/plm

c: C. Collins, Central District
G. E. Cantelou, Jr., P.E.

SENDER: Complete items 1 and 2 when additional services are desired, and complete items 3 and 4.
 Put your address in the "RETURN TO" Space on the reverse side. Failure to do this will prevent this card from being returned to you. The return receipt fee will provide you the name of the person delivered to and the date of delivery. For additional fees the following services are available. Consult postmaster for fees and check box(es) for additional service(s) requested.

| | |
|---|---|
| 1. <input type="checkbox"/> Show to whom delivered, date, and addressee's address. (Extra charge) 2. <input type="checkbox"/> Restricted Delivery (Extra charge) | |
| 3. Article Addressed to: John A. Cronkhite Sr. Vice Pres. / Gen. Counsel Sea Ray Boats, Inc. 2600 Sea Ray Blvd. Knoxville, TN 37914 | 4. Article Number P 256 396 105 Type of Service: <input type="checkbox"/> Registered <input type="checkbox"/> Insured <input checked="" type="checkbox"/> Certified <input type="checkbox"/> COD <input type="checkbox"/> Express Mail <input type="checkbox"/> Return Receipt for Merchandise |
| Always obtain signature of addressee or agent and DATE DELIVERED. | |
| 5. Signature - Address X | 8. Addressee's Address (ONLY if requested and fee paid) |
| 6. Signature - Agent X <i>SM-COS</i> | |
| 7. Date of Delivery 6-25 | |

PS Form 3811, Mar. 1988 * U.S.G.P.O. 1988-212-865 DOMESTIC RETURN RECEIPT

P 256 396 105
RECEIPT FOR CERTIFIED MAIL
 NO INSURANCE COVERAGE PROVIDED
 NOT FOR INTERNATIONAL MAIL
 (See Reverse)

PS Form 3800, June 1985
 * U.S.G.P.O. 1989-234-555

| | |
|---|----|
| Recipient Name <i>John A Cronkhite</i> | |
| Street and No. <i>Sea Ray Boats</i> | |
| P.O., State and ZIP Code <i>2600 Sea Ray Blvd</i> | |
| Postage <i>Knoxville TN</i> | |
| Certified Fee | |
| Special Delivery Fee | |
| Restricted Delivery Fee | |
| Return Receipt showing to whom and Date Delivered | |
| Return Receipt showing to whom, Date, and Address of Delivery | |
| TOTAL Postage and Fees | \$ |
| Postmark or Date <i>6-22-90</i> <i>AC 05-151435</i> | |



RECEIVED

MAY 17 1990

DER-BAQM

May 7, 1990

Mr. Clair Fancy
Chief Bureau of Air Regulation
Florida Department of Environmental Regulation
2600 Blair Stone Road
Tallahassee, FL 32399-2400

RE: AC05-151435
Sea Ray Boats, Inc.
Sykes Creek Plant
Merritt Island, Florida

Dear Mr. Fancy:

Please accept this letter as a formal request for two modifications to the referenced construction permit.

We have had discussions with Mr. Collins and Mr. Turner of the DER district office and are advised that we should have our construction permit modified to cover an exceedance discovered due to an underestimate of carpet glue required in the manufacture of certain models fo boats. Be advised that our original estimates (those contained in the construction permit application) were based entirely on theory since these boats had not been built before, and the actual use the glue was about ten percent greater than originally projected.

We therefore request that the facilities permitted emission rate of 1,1,1-trichloroethane be modified to 2.34 #/hr over an 8 hour period instead of 2.10 #/hr over a 16 hour period (permitted rate).

We also request that Specific Condition #8's due date be extended, since it was our intent to produce an air model using the parameters of the operation permit to demonstrate acceptable ambient concentrations.

Thank you for your considerations. If you have any questions, please call me at (803) 648-9300.

Yours truly,

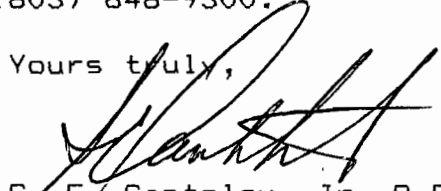
G. E. Cantelou, Jr. P.E.

cc: *J. Reynolds*
C. Collins
B. Andrews

401 Park Ave. S.W. / P.O. Box 3102 / Aiken, S.C. 29802 / (803) 648-9300

CANTELOU ASSOCIATES

ENGINEERING - PLANNING

401 Park Ave. S.W. / P.O. Box 3102 / Aiken, S.C. 29802

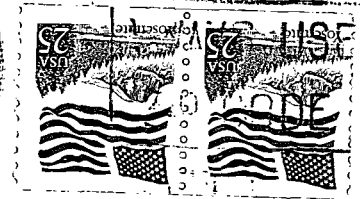

Mr. Clair Fancy
Chief Bureau of Air Regulation
FL.Dept. of Environmental Regulation
2600 Blair Stone Road
Tallahassee, FL. 32399-2400



May 3, 1990

Florida Department of Environmental Regulation
3319 Maguire Boulevard
Suite 232
Orlando, Florida 32803-3767

Attention: John Turner

RE: Sea Ray Boats, Inc.
Completeness Air Summary
AC05-151435
Sykes Creek Plant
Merritt Island, Florida

Dear Mr. Turner:

The following items are submitted in response to your letter of April 18, 1990.

- Exhibit 1. Letter of authorization for Jeff Skuda.
- Exhibit 2. Calculated compliance results.
- Exhibit 3. Clarification of utilization rates, emission rates and assumptions, and potential emissions.
- Exhibit 4. Copy of letter to Mr. Clair Fancy regarding construction permit modification.
- Exhibit 5. Same as Exhibit "4" for conceptual plan for Permit Specific Condition No. 8.

The visible emission test results will be resubmitted when the permit applications for AC05-165270 and AC05-165271 are completed and submitted.

If you require additional information, please advise.

Yours truly,

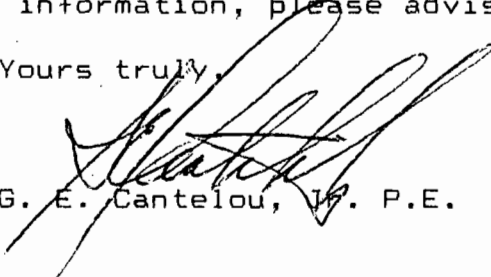
G. E. Cantelou, Jr. P.E.

GEC/sc

Enclosures



SEA RAY BOATS, INC.
WORLD HEADQUARTERS, 2600 SEA RAY BLVD., KNOXVILLE, TENNESSEE 37914 (615) 522-4181

May 1, 1990

Florida Department of Environmental Regulation
Air Resources Management Section
3319 Maguire Boulevard
Orlando, Florida 32803-3767

RE: Operational Permit (Ref. #AC05-151435)

To Whom It May Concern:

Please be advised that Jeff Skuda is authorized by Sea Ray Boats, Inc., to sign and make application for our operational permit (noted above). If any additional information is needed, please feel free to contact me.

Thank you in advance for your cooperation.

Sincerely,

SEA RAY BOATS, INC.

Gary W. Stoecker
Senior Vice President/Manufacturing

GWS:cbh

EXHIBIT "2"

| | PERMITTED (#/HR) | ACTUAL (#/HR) |
|---------------------------|---------------------|------------------|
| STYRENE (RESIN & GELCOAT) | 11.63 | 9.07 |
| METHYL METHACRYLATE | 2.48 | 0.0 |
| MEKP | 0.47 | 0.06 |
| 1,1,1-TRICHLOROETHANE | 2.10 | 2.34 |
| ACETONE | 6.25 | 4.18 |
| BOTTOM PAINT | 7.02 | 2.28 |

EXHIBIT "3"

ACTUAL EMISSIONS

STYRENE:

(9.07 #/hr) (48 wk/yr X 5 days/wk X 8 hr/day) = 17,414 #/yr = 8.7 T/yr

METHYL METHACRALATE:

NO LONGER A COMPONENT IN THE GELCOATS USED,
STYRENE WAS SUBSTITUTED BY MANUFACTURER

MEK:

(0.06 #/hr) (48 wk/yr X 5 days/wk X 8 hr/day) = 115 #/yr = .06 T/yr

1,1,1-TRICHLOROETHANE:

(2.34 #/hr) (48 wk/yr X 5 days/wk X 8 hr/day) = 4,493 #/yr = 2.2 T/yr

ACETONE:

(4.18 #/hr) (48 wk/yr X 5 days/wk X 8 hr/day) = 8,026 #/yr = 4.0 T/yr

BOTTOM PAINT & MISC:

(2.28 #/hr) (48 wk/yr X 5 days/wk X 8 hr/day) = 4,378 #/yr = 2.2 T/yr

POTENTIAL EMISSIONS

STYRENE:

$$(11.63 \text{ \#/hr}) (48 \text{ wk/yr} \times 5 \text{ days/wk} \times 8 \text{ hr/day}) = 22,330 \text{ \#/yr} = 11.2 \text{ T/yr}$$

METHYL METHACRALATE:

$$(2.48 \text{ \#/hr}) (48 \text{ wk/yr} \times 5 \text{ days/wk} \times 8 \text{ hr/day}) = 4,762 \text{ \#/yr} = 2.4 \text{ T/yr}$$

MEK:

$$(0.47 \text{ \#/hr}) (48 \text{ wk/yr} \times 5 \text{ days/wk} \times 8 \text{ hr/day}) = 902 \text{ \#/yr} = .45 \text{ T/yr}$$

1,1,1-TRICHLOROETHANE:

$$(2.10 \text{ \#/hr}) (48 \text{ wk/yr} \times 5 \text{ days/wk} \times 8 \text{ hr/day}) = 4,032 \text{ \#/yr} = 2.0 \text{ T/yr}$$

ACETONE:

$$(6.25 \text{ \#/hr}) (48 \text{ wk/yr} \times 5 \text{ days/wk} \times 8 \text{ hr/day}) = 12,000 \text{ \#/yr} = 6.0 \text{ T/yr}$$

BOTTOM PAINT:

$$(7.02 \text{ \#/hr}) (48 \text{ wk/yr} \times 5 \text{ days/wk} \times 8 \text{ hr/day}) = 13,478 \text{ \#/yr} = 6.7 \text{ T/yr}$$



State of Florida
DEPARTMENT OF ENVIRONMENTAL REGULATION

| For Routing To Other Than The Addressee | |
|---|-----------------|
| To: _____ | Location: _____ |
| To: _____ | Location: _____ |
| To: _____ | Location: _____ |
| From: _____ | Date: _____ |

Interoffice Memorandum

TO: Dale Twachtmann

fr FROM: Steve Smallwood *Smallwood*

DATE: December 12, 1989

SUBJ: Amendments to Construction Permits Nos. AC 05-151435,
AC 05-165270, and AC 05-165271 (Sea Ray Boats, Inc.)

Attached for your approval and signature is a letter extending the expiration dates for the above referenced construction permits.

The Bureau recommends approval of these amendments.

Attachment

SS/JR/plm

RECEIVED
DEC 12 1989

Office of the Secretary

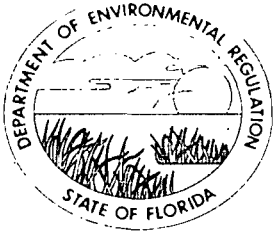

Florida Department of Environmental Regulation

Twin Towers Office Bldg. • 2600 Blair Stone Road • Tallahassee, Florida 32399-2400

Bob Martinez, Governor

Dale Twachtmann, Secretary

John Shearer, Assistant Secretary

December 12, 1989

CERTIFIED MAIL - RETURN RECEIPT REQUESTED

Mr. John A. Cronkhite
Senior Vice President/General Counsel
Sea Ray Boats, Inc.
2600 Sea Ray Boulevard
Knoxville, Tennessee 37914

Dear Mr. Cronkhite:

The Department received your request for an extension of the expiration dates for the construction permits referenced below. The request is acceptable and the following shall be changed:

| <u>PROJECT</u> | <u>FROM</u> | <u>TO</u> |
|----------------|-----------------|--------------------|
| AC 05-151435 | August 31, 1989 | May 31, 1990 |
| AC 05-165270 | March 31, 1990 | September 30, 1990 |
| AC 05-165271 | March 31, 1990 | September 30, 1990 |

Attachment to be Incorporated:

Letter from Sea Ray Boats, Inc. dated November 22, 1989, requesting a change in the expiration dates.

A copy of this letter must be attached to the above construction permits and shall become a part of these permits.

Sincerely,

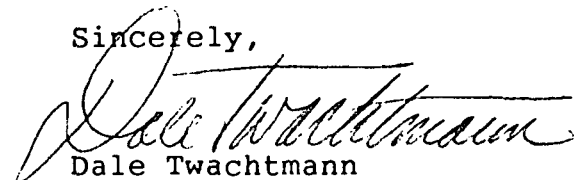

Dale Twachtmann
Secretary

DT/plm

cc: C. Collins, CF District
G. E. Cantelou, Jr., P.E.

SENDER: Complete items 1 and 2 when additional services are desired, and complete items 3 and 4. Put your address in the "RETURN TO" Space on the reverse side. Failure to do this will prevent this card from being returned to you. The return receipt fee will provide you the name of the person delivered to and the date of delivery. For additional fees the following services are available. Consult postmaster for fees and check box(es) for additional service(s) requested.

1. Show to whom delivered, date, and addressee's address. (Extra charge) 2. Restricted Delivery (Extra charge)

3. Article Addressed to:
 Mr. John A. Cronkhite.
 Sr. Vice President/Gen. Counsel
 Sea Ray Boats, Inc.
 2600 Sea Ray Blvd.
 Knoxville, TN 37914

4. Article Number
 P 938 762 790

Type of Service:
 Registered Insured
 Certified COD
 Express Mail Return Receipt for Merchandise

Always obtain signature of addressee or agent and DATE DELIVERED.

5. Signature Address
 X *McCluskey*

6. Signature Agent
 X

7. Date of Delivery
 1-02-90

8. Addressee's Address (ONLY if requested and fee paid)

PS Form 3811, Mar. 1988 * U.S.G.P.O. 1988-212-865 DOMESTIC RETURN RECEIPT

938 762 790

RECEIPT FOR CERTIFIED MAIL
 NO INSURANCE COVERAGE PROVIDED
 NOT FOR INTERNATIONAL MAIL
 (See Reverse)

| | |
|--|----|
| Sent to | |
| Mr. John A. Cronkhite, Sea Ray Boats | |
| Street and No. 2600 Sea Ray Blvd. | |
| P.O., State, and ZIP Code Knoxville, TN 37914 | |
| Postage | \$ |
| Certified Fee | |
| Special Delivery Fee | |
| Restricted Delivery Fee | |
| Return Receipt showing to whom and Date Delivered | |
| Return Receipt showing to whom, Date, and Address of Delivery | |
| TOTAL Postage and Fees | \$ |
| Postmark or Date Mailed: 12-22-89 Permit: AC 05-151435 AC 05-165270, -271 | |

PS Form 3800, June 1985



SEA RAY BOATS, INC.
WORLD HEADQUARTERS, 2600 SEA RAY BLVD., KNOXVILLE, TENNESSEE 37914 (615) 522-4181

November 22, 1989

RECEIVED
NOV 28 1989
DER-BAQIV

Mr. Clair Fancy
Chief Bureau of Air Regulation
Florida Department of Environmental Regulation
2600 Blair Stone Road
Tallahassee, Florida 32399-2400

Dear Mr. Fancy:

Please be advised that Sea Ray Boats has experienced unforeseen production reductions due to the recent economic and business cycle. Two plants in Tennessee and another in South Carolina have been closed.

Our facilities in Merritt Island have also been undergoing a restructuring of personnel and new product line.

Due to these recent business adjustments we have been unable to complete the permitting process as required.

Sea Ray Boats hereby requests that your department grant a 180 day extension of our construction permits numbered AC05-165270, AC05-165271 and AC05-151435.

This extension will give us the time needed to complete the process.

Thank you for your assistance in this matter.

Very truly yours,

SEA RAY BOATS, INC.

John A. Cronkhite
Senior Vice President/
General Counsel

JAC:lr

cc: J. Reynolds
C. Collins
E/F/BT



AIRBILL

USE THIS AIRBILL FOR DOMESTIC SHIPMENTS WITHIN THE CONTINENTAL U.S.A. ALASKA AND HAWAII.
USE THE INTERNATIONAL AIR WAYBILL FOR SHIPMENTS TO PUERTO RICO.
QUESTIONS? CALL 800-238-5355 TOLL FREE.

PACKAGE TRACKING NUMBER

2175821200

3313M

2175821200

RECIPIENT'S COPY

| | |
|------------------|--|
| Date 11/27/89 | |
|------------------|--|

| | | | | | | | |
|---|--|--|--|---|--|---|--|
| From (Your Name) Please Print John A. Cronkhite | | Your Phone Number (Very Important) (615)522-4181 | | To (Recipient's Name) Please Print Clair Fancy | | Recipient's Phone Number (Very Important) | |
| Company SEA RAY BOATS INC/GRP OFFICE | | Department/Floor No. | | Company Florida Dept. of Environmental | | Department/Floor No. | |
| Street Address 00 SEA RAY BLVD | | | | Exact Street Address (We Cannot Deliver to P.O. Boxes or P.O. Zip Codes.) 2600 Blair Stone Road | | | |
| City MOXVILLE TN | | State TN | | City Tallahassee, FL | | State FL | |
| ZIP Required 37914 | | ZIP Required 32399-2400 | | ZIP Required | | ZIP Required | |

| | | | | | | | |
|--|--|--|--|---|--|--|--|
| YOUR BILLING REFERENCE INFORMATION (FIRST 24 CHARACTERS WILL APPEAR ON INVOICE.) | | | | IF HOLD FOR PICK-UP, Print FEDEX Address Here | | | |
| PAYMENT <input checked="" type="checkbox"/> Bill Sender <input type="checkbox"/> Bill Recipient's FedEx Acct. No. <input type="checkbox"/> Bill 3rd Party FedEx Acct. No. <input type="checkbox"/> Bill Credit Card <input type="checkbox"/> Cash | | | | Street Address City State ZIP Required | | | |

| SERVICES | | DELIVERY AND SPECIAL HANDLING | | PACKAGES | WEIGHT | YOUR DECLARED VALUE | OVER SIZE | Emp. No. | Date | Federal Express Use | |
|--|--|---|---|----------|--------|---------------------|-----------|----------|------|--|-----------------------|
| 1 <input checked="" type="checkbox"/> PRIORITY 1 Overnight Delivery | 6 <input checked="" type="checkbox"/> OVERNIGHT LETTER* | 1 <input type="checkbox"/> HOLD FOR PICK-UP (Fill in Box #) | | | | | | | | <input type="checkbox"/> Cash Received | Base Charges |
| 2 <input type="checkbox"/> COURIER-PAK OVERNIGHT ENVELOPE* | 7 <input type="checkbox"/> | 2 <input checked="" type="checkbox"/> DELIVER WEEKDAY | | | | | | | | <input type="checkbox"/> Return Shipment <input type="checkbox"/> Third Party <input type="checkbox"/> Chg. To Del <input type="checkbox"/> Chg. To Hold | Declared Value Charge |
| 3 <input type="checkbox"/> OVERNIGHT BOX | 8 <input type="checkbox"/> | 3 <input type="checkbox"/> DELIVER SATURDAY (Extra charge) | | | | | | | | Street Address | Other 1 |
| 4 <input type="checkbox"/> OVERNIGHT TUBE | 9 <input type="checkbox"/> | 4 <input type="checkbox"/> DANGEROUS GOODS (Extra charge) | | | | | | | | City State Zip | Other 2 |
| 5 <input type="checkbox"/> STANDARD AIR Delivery not later than second business day | 10 <input type="checkbox"/> | 5 <input type="checkbox"/> CONSTANT SURVEILLANCE SERVICE (CSS) (Extra charge) (Release Signature Not Applicable) | | | | | | | | Received By | Total Charges |
| | | 6 <input type="checkbox"/> DRY ICE Lbs. | Total | Total | Total | | | | | <input checked="" type="checkbox"/> X | |
| | | 7 <input checked="" type="checkbox"/> OTHER SPECIAL SERVICE | Received At | | | | | | | Date/Time Received | FedEx Employee Number |
| | | 8 <input type="checkbox"/> | 1 <input type="checkbox"/> Regular Stop | | | | | | | PART #111800 REVISION DATE 7/88 PRINTED IN U.S.A. FXEM | |
| | | 9 <input type="checkbox"/> SATURDAY PICK-UP (Extra charge) | 2 <input type="checkbox"/> On-Call Stop | | | | | | | 009 | |
| | | 10 <input type="checkbox"/> | 3 <input type="checkbox"/> Drop Box | | | | | | | © 1988 F.E.C. | |
| | | 11 <input type="checkbox"/> | 4 <input type="checkbox"/> B.S.C. | | | | | | | | |
| | | 12 <input type="checkbox"/> HOLIDAY DELIVERY (if offered) (Extra charge) | 5 <input type="checkbox"/> Station | | | | | | | | |
| | | | FEDEX Corp. Employee No. | | | | | | | Sender authorizes Federal Express to deliver this shipment without obtaining a delivery signature and shall indemnify and hold harmless Federal Express from any claims resulting therefrom. | |
| | | | Date/Time for FEDEX Use | | | | | | | Release Signature: | |



State of Florida
DEPARTMENT OF ENVIRONMENTAL REGULATION

| For Routing To Other Than The Addressee | |
|---|-----------------|
| To: _____ | Location: _____ |
| To: _____ | Location: _____ |
| To: _____ | Location: _____ |
| From: _____ | Date: _____ |

Interoffice Memorandum

TO: Dale Twachtmann
FROM: Steve Smallwood 
DATE: July 18, 1989
SUBJ: Modification of Permit Number: AC 05-151435
Sea Ray Boats, Inc.

Attached for your approval and signature is a letter modifying the emission factors of Sea Ray Boat's permit for their Sykes Creek boat plant. The new factors more accurately reflect the actual emissions from the facility.

I recommend your approval and signature.

SS/JR/t

attachment

RECEIVED
JUL 18 1989

Office of the Secretary

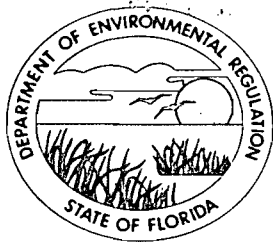

Florida Department of Environmental Regulation

Twin Towers Office Bldg. • 2600 Blair Stone Road • Tallahassee, Florida 32399-2400

Bob Martinez, Governor

Dale Twachtmann, Secretary

John Shearer, Assistant Secretary

July 18, 1989

CERTIFIED MAIL - RETURN RECEIPT REQUESTED

Mr. John A. Cronkhite
Sr. Vice President/General Counsel
Sea Ray Boats, Inc.
2600 Sea Ray Blvd.
Knoxville, TN 37914

Dear Mr. Cronkhite:

Re: Revised Emission Factors - Sykes Creek Facility
(Permit No. AC 05-151435)

The above permit is amended as stated below to reflect the revised emission factors in your letter dated April 28, 1989:

Present Specific Condition No. 4:

4. Hydrocarbon emissions (VOC) shall not exceed the following calculated values and total VOC emissions from the facility shall not exceed 49.8 lbs/hr, 797 lbs/day (30 day average), and 95.6 tons/year. Compliance shall be demonstrated by applying the following raw material utilization rates and emission factors:

| | Utilization Rate lbs/hr | Emission Factor | Emissions lbs/hr |
|-----------------------|----------------------------|--------------------|---------------------|
| Styrene | 372.5 | 0.08 | 29.80 |
| Methyl Methacrylate | 49.5 | 0.08 | 3.96 |
| MEKP | 4.7 | 0.10 | 0.47 |
| 1,1,1-Trichloroethane | 3.5 | 0.66 | 2.31 |
| Acetone | 12.5 | 0.50 | 6.25 |
| Bottom Paint | 11.7 | 0.60 | 7.02 |

New Specific Condition No. 4:

4. Hydrocarbon emissions (VOC) shall not exceed the following calculated values and total VOC emissions from the facility shall not exceed 30 lbs/hr, 480 lbs/day (30 day average), and 57.5 tons/year. Compliance shall be demonstrated by applying the following raw material utilization rates and emission factors over a 90-day period.

Mr. John A. Cronkhite
Page Two
July 18, 1989

| | Utilization Rate lbs/hr | Emission Factor | Emissions lbs/hr |
|-----------------------|----------------------------|--------------------|---------------------|
| Styrene (Resin) | 119.5 | 0.06 | 7.17 |
| Styrene (Gel Coat) | 14.9 | 0.30 | 4.46 |
| Methyl Methacrylate | 49.5 | 0.05 | 2.48 |
| MEKP | 4.7 | 0.10 | 0.47 |
| 1,1,1-Trichloroethane | 3.5 | 0.60 | 2.10 |
| Acetone | 6.25 | 1.00 | 6.25 |
| Bottom Paint | 11.7 | 0.60 | 7.02 |

New Specific Condition No. 4A:

4.A. Nonvolatile acetone substitutes shall be used to the maximum extent practicable to further reduce the quantity of acetone consumed.

New Specific Condition No. 8:

8. By January 31, 1990, Sea Ray Boats shall submit a conceptual plan and potential course of action that will provide the Department with reasonable assurance that objectionable odors and toxic air pollutants in quantities that could exceed acceptable ambient concentrations will not be discharged off of the facility's property boundary or where the public has access, whichever is closest, pursuant to F.A.C. Rules 17-2.200 and 17-2.620(1) and (2). The plan should contain at a minimum, but not be limited to, various control system strategies that might be installed to reduce or eventually eliminate emissions of VOC/OS from each type of operation, associated time and cost analyses, and VOC/OS substitutes.

This amendment letter shall become attachment No. 2 to your construction permit AC 05-151435.

Sincerely,

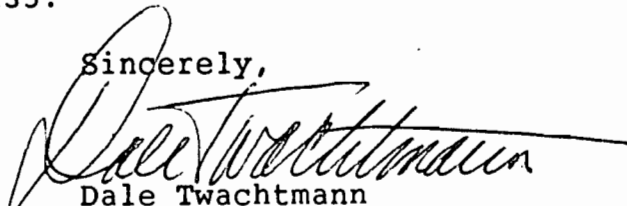

Dale Twachtmann
Secretary

DT/kt

cc: C. Collins, Central District
G. E. Cantelou, Jr., P.E.

SENDER: Complete items 1 and 2 when additional services are desired, and complete items 3 and 4. Put your address in the "RETURN TO" Space on the reverse side. Failure to do this will prevent this card from being returned to you. The return receipt fee will provide you the name of the person delivered to and the date of delivery. For additional fees the following services are available. Consult postmaster for fees and check box(es) for additional service(s) requested.

1. Show to whom delivered, date, and addressee's address. (Extra charge) 2. Restricted Delivery (Extra charge)

| | |
|--|--|
| 3. Article Addressed to: Mr. John A. Cronkhite Sr. Vice Pres./General Counsel Sea Ray Boats, Inc. 2600 Sea Ray Blvd. Knoxville, TN 37914 | 4. Article Number P938 762 627 Type of Service: <input type="checkbox"/> Registered <input type="checkbox"/> Insured <input checked="" type="checkbox"/> Certified <input type="checkbox"/> COD <input type="checkbox"/> Express Mail <input type="checkbox"/> Return Receipt for Merchandise |
| 5. Signature - Addressee X <i>[Signature]</i> | 8. Addressee's Address (ONLY if requested and fee paid) |
| 6. Signature - Agent X | |
| 7. Date of Delivery 7-28-89 | |

PS Form 3811, Mar. 1988 * U.S.G.P.O. 1988-212-865 DOMESTIC RETURN RECEIPT

P 938 762 627

RECEIPT FOR CERTIFIED MAIL
 NO INSURANCE COVERAGE PROVIDED
 NOT FOR INTERNATIONAL MAIL
 (See Reverse)

| | |
|---|----|
| Sent to Mr. John A. Cronkhite, Sea Ray Boats | |
| Street and No. 2600 Sea Ray Blvd. | |
| P.O., State and ZIP Code Knoxville, TN 37914 | |
| Postage | \$ |
| Certified Fee | |
| Special Delivery Fee | |
| Restricted Delivery Fee | |
| Return Receipt showing to whom and Date Delivered | |
| Return Receipt showing to whom, Date, and Address of Delivery | |
| TOTAL Postage and Fees | \$ |
| Remark or Date Mailed: 7-26-89 Permit: AC 05-151435 | |

PS Form 3800, June 1985

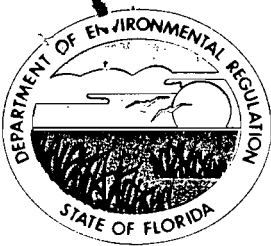

Florida Department of Environmental Regulation

Twin Towers Office Bldg. • 2600 Blair Stone Road • Tallahassee, Florida 32399-2400

Bob Martinez, Governor

Dale Twachmann, Secretary

John Shearer, Assistant Secretary

STATE OF FLORIDA DEPARTMENT OF ENVIRONMENTAL REGULATION NOTICE OF PERMIT

Mr. John A. Cronkhite
Senior Vice President/General Counsel
Sea Ray Boats, Inc.
2600 Sea Ray Boulevard
Knoxville, Tennessee 37914

October 17, 1988

Enclosed is construction permit No. AC 05-151435 to construct a fiberglass boat plant in Brevard County, Florida. This permit is issued pursuant to Section 403, Florida Statutes.

Any Party to this permit has the right to seek judicial review of the permit pursuant to Section 120.68, Florida Statutes, by the filing of a Notice of Appeal pursuant to Rule 9.110, Florida Rules of Appellate Procedure, with the Clerk of the Department in the Office of General Counsel, 2600 Blair Stone Road, Tallahassee, Florida 32399-2400; and by filing a copy of the Notice of Appeal accompanied by the applicable filing fees with the appropriate District Court of Appeal. The Notice of Appeal must be filed within 30 days from the date this permit is filed with the Clerk of the Department.

Executed in Tallahassee, Florida.

STATE OF FLORIDA DEPARTMENT
OF ENVIRONMENTAL REGULATION

C. H. Fancy, P.E.
Deputy Chief
Bureau of Air Quality Management

Copy furnished to:

C. Collins, CF District
G. E. Cantelou, Jr., P.E.

CERTIFICATE OF SERVICE

The undersigned duly designated deputy clerk hereby certifies that this NOTICE OF PERMIT and all copies were mailed before the close of business on 10/18/88.

FILING AND ACKNOWLEDGEMENT
FILED, on this date, pursuant to
§120.52(9), Florida Statutes, with
the designated Department Clerk,
receipt of which is hereby
acknowledged.

Judy Rogers
Clerk

10/18/88
Date

Final Determination

Sea Ray Boats, Inc.
Merritt Island, Brevard County, Florida

Construction of Fiberglass Boat Plant
Permit No. AC 05-151435

Florida Department of Environmental Regulation
Bureau of Air Quality Management
Central Air Permitting

October 13, 1988

Final Determination

The construction permit application has been reviewed by the Department. Public Notice of the Department's Intent to Issue was published in the Florida Today Newspaper on September 20, 1988. The Technical Evaluation and Preliminary Determination were available for public inspection at the DER's Central Florida District office in Orlando and the DER Bureau of Air Quality Management office in Tallahassee.

No comments were received during the Public Notice period. Therefore, the final action of the Department will be to issue the construction permit as drafted.

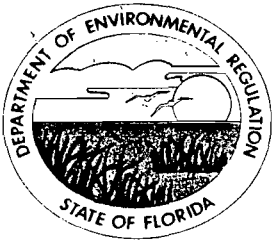

Florida Department of Environmental Regulation

Twin Towers Office Bldg. • 2600 Blair Stone Road • Tallahassee, Florida 32399-2400

Bob Martinez, Governor

Dale Twachtman, Secretary

John Shearer, Assistant Secretary

PERMITTEE:

Sea Ray Boats, Inc.
Sea Ray Drive
Merritt Island, FL

Permit Number: AC 05-151435

Expiration Date: August 31, 1989

County: Brevard

Latitude/Longitude: 28° 24' 26"N
80° 42' 03"W

Project: Fiberglass Boat Plant

This permit is issued under the provisions of Chapter 403, Florida Statutes, and Florida Administrative Code (F.A.C.) Rules 17-2 and 17-4. The above named permittee is hereby authorized to perform the work or operate the facility shown on the application and approved drawing(s), plans, and other documents attached hereto or on file with the Department and made a part hereof and specifically described as follows:

For the construction of a facility to produce fiberglass pleasure boats. This project will be located near the Canaveral Port Authority in Merritt Island, Brevard County, Florida. The UTM coordinates of this site are Zone 17, 529.3 km E and 3,142.1 km N.

Construction shall be in accordance with the permit application and plans, documents, and reference material submitted unless otherwise stated in the Preliminary Determination and Technical Evaluation or the General and Specific Conditions herein.

Attachments:

1. Application to Operate/Construct Air Pollution Sources, DER Form 17-202(1), received on June 30, 1988.

PERMITTEE:
Sea Ray Boats, Inc.

Permit Number: AC 05-151435
Expiration Date: August 31, 1989

GENERAL CONDITIONS:

1. The terms, conditions, requirements, limitations, and restrictions set forth herein are "Permit Conditions" and as such are binding upon the permittee and enforceable pursuant to the authority of Sections 403.161, 403.727, or 403.859 through 403.861, Florida Statutes. The permittee is hereby placed on notice that the Department will review this permit periodically and may initiate enforcement action for any violation of the "Permit Conditions" by the permittee, its agents, employees, servants or representatives.

2. This permit is valid only for the specific processes and operations applied for and indicated in the approved drawings or exhibits. Any unauthorized deviation from the approved drawings, exhibits, specifications, or conditions of this permit may constitute grounds for revocation and enforcement action by the Department.

3. As provided in Subsections 403.087(6) and 403.722(5), Florida Statutes, the issuance of this permit does not convey any vested rights or any exclusive privileges. Nor does it authorize any injury to public or private property or any invasion of personal rights, nor any infringement of federal, state or local laws or regulations. This permit does not constitute a waiver of or approval of any other Department permit that may be required for other aspects of the total project which are not addressed in the permit.

4. This permit conveys no title to land or water, does not constitute state recognition or acknowledgement of title, and does not constitute authority for the use of submerged lands unless herein provided and the necessary title or leasehold interests have been obtained from the state. Only the Trustees of the Internal Improvement Trust Fund may express state opinion as to title.

5. This permit does not relieve the permittee from liability for harm or injury to human health or welfare, animal, plant or aquatic life or property and penalties therefore caused by the construction or operation of this permitted source, nor does it allow the permittee to cause pollution in contravention of Florida Statutes and Department rules, unless specifically authorized by an order from the Department.

PERMITTEE:
Sea Ray Boats, Inc.

Permit Number: AC 05-151435
Expiration Date: August 31, 1989

GENERAL CONDITIONS:

6. The permittee shall at all times properly operate and maintain the facility and systems of treatment and control (and related appurtenances) that are installed or used by the permittee to achieve compliance with the conditions of this permit, as required by Department rules. This provision includes the operation of backup or auxiliary facilities or similar systems when necessary to achieve compliance with the conditions of the permit and when required by Department rules.

7. The permittee, by accepting this permit, specifically agrees to allow authorized Department personnel, upon presentation of credentials or other documents as may be required by law, access to the premises, at reasonable times, where the permitted activity is located or conducted for the purpose of:

- a. Having access to and copying any records that must be kept under the conditions of the permit;
- b. Inspecting the facility, equipment, practices, or operations regulated or required under this permit; and
- c. Sampling or monitoring any substances or parameters at any location reasonably necessary to assure compliance with this permit or Department rules.

Reasonable time may depend on the nature of the concern being investigated.

8. If, for any reason, the permittee does not comply with or will be unable to comply with any condition or limitation specified in this permit, the permittee shall immediately notify and provide the Department with the following information:

- a. a description of and cause of non-compliance; and
- b. the period of noncompliance, including exact dates and times; or, if not corrected, the anticipated time the noncompliance is expected to continue, and steps being taken to reduce, eliminate, and prevent recurrence of the noncompliance.

PERMITTEE:
Sea Ray Boats, Inc.

Permit Number: AC 05-151435
Expiration Date: August 31, 1989

GENERAL CONDITIONS:

The permittee shall be responsible for any and all damages which may result and may be subject to enforcement action by the Department for penalties or revocation of this permit.

9. In accepting this permit, the permittee understands and agrees that all records, notes, monitoring data and other information relating to the construction or operation of this permitted source, which are submitted to the Department, may be used by the department as evidence in any enforcement case arising under the Florida Statutes or Department rules, except where such use is proscribed by Sections 403.73 and 403.111, Florida Statutes.

10. The permittee agrees to comply with changes in Department rules and Florida Statutes after a reasonable time for compliance, provided however, the permittee does not waive any other rights granted by Florida Statutes or Department rules.

11. This permit is transferable only upon Department approval in accordance with Florida Administrative Code Rules 17-4.12 and 17-30.30, as applicable. The permittee shall be liable for any noncompliance of the permitted activity until the transfer is approved by the Department.

12. This permit is required to be kept at the work site of the permitted activity during the entire period of construction or operation.

13. This permit also constitutes:

- () Determination of Best Available Control Technology (BACT)
- () Determination of Prevention of Significant Deterioration (PSD)
- () Compliance with New Source Performance Standards

14. The permittee shall comply with the following monitoring and record keeping requirements:

- a. Upon request, the permittee shall furnish all records and plans required under Department rules. The retention period for all records will be extended automatically, unless otherwise stipulated by the Department, during the course of any unresolved enforcement action.

PERMITTEE:
Sea Ray Boats, Inc.

Permit Number: AC 05-151435
Expiration Date: August 31, 1989

GENERAL CONDITIONS:

- b. The permittee shall retain at the facility or other location designated by this permit records of all monitoring information (including all calibration and maintenance records and all original strip chart recordings for continuous monitoring instrumentation), copies of all reports required by this permit, and records of all data used to complete the application for this permit. The time period of retention shall be at least three years from the date of the sample, measurement, report or application unless otherwise specified by Department rule.
- c. Records of monitoring information shall include:
- the date, exact place, and time of sampling or measurements;
 - the person responsible for performing the sampling or measurements;
 - the date(s) analyses were performed;
 - the person responsible for performing the analyses;
 - the analytical techniques or methods used; and
 - the results of such analyses.

15. When requested by the Department, the permittee shall within a reasonable time furnish any information required by law which is needed to determine compliance with the permit. If the permittee becomes aware that relevant facts were not submitted or were incorrect in the permit application or in any report to the Department, such facts or information shall be submitted or corrected promptly.

SPECIFIC CONDITIONS:

1. The construction and operation of this source shall be in accordance with the capacities and specifications stated in the application.
2. The plant shall be allowed to operate for up to 3,840 hours per year.

PERMITTEE:
Sea Ray Boats, Inc.

Permit Number: AC 05-151435
Expiration Date: August 31, 1989

SPECIFIC CONDITIONS:

3. Visible emissions from the dust collectors shall not be greater than 5% opacity and compliance shall be demonstrated at 90-100% of permitted capacity using DER Method 9 in accordance with F.A.C. Rule 17-2.700.

4. Hydrocarbon emissions (VOC) shall not exceed the following calculated values and total VOC emissions from the facility shall not exceed 49.8 lbs/hr, 797 lbs/day (30 day average), and 95.6 tons/yr. Compliance shall be demonstrated by applying the following raw material utilization rates and emission factors:

| | Utilization Rate lbs/hr | Emission Factor | Emissions (lbs/hr) |
|------------------------|----------------------------|--------------------|-----------------------|
| Styrene | 372.5 | 0.08 | 29.80 |
| Methyl Methacrylate | 49.5 | 0.08 | 3.96 |
| MEKP | 4.7 | 0.10 | 0.47 |
| 1,1,1,-Trichloroethane | 3.5 | 0.66 | 2.31 |
| Acetone | 12.5 | 0.50 | 6.25 |
| Bottom Paint | 11.7 | 0.60 | 7.02 |

5. No air pollutants shall be discharged which cause or contribute to an objectionable odor.

6. The compliance test shall be conducted within 30 days after operation begins and the results reported to the Department's Central Florida District office before this construction permit expires. The Department shall be notified at least 15 days in advance of the test and at least 5 days prior to the plant being placed in operation.

7. An application for a permit to operate shall be submitted to the Department's Central Florida District office at least 60 days prior to the expiration date of this permit or within 45 days of testing, whichever occurs first.

Issued this 14 day of Oct., 1988

STATE OF FLORIDA DEPARTMENT OF
ENVIRONMENTAL REGULATION

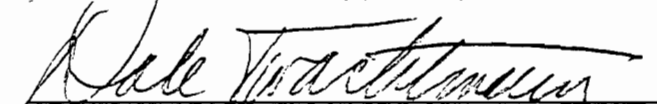

Dale Twachtman, Secretary



State of Florida
DEPARTMENT OF ENVIRONMENTAL REGULATION

| For Routing To Other Than The Addressee | |
|---|-----------------|
| To: _____ | Location: _____ |
| To: _____ | Location: _____ |
| To: _____ | Location: _____ |
| From: _____ | Date: _____ |

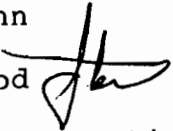
Interoffice Memorandum

TO: Dale Twachtmann
FROM: Steve Smallwood 
SUBJ: Approval of Construction Permit No. AC 05-151435
Sea Ray Boats, Inc.
DATE: October 13, 1988

Attached for your approval and signature is a permit prepared by Central Air Permitting for the above mentioned company to construct a fiberglass boat building plant in Merritt Island.

No comments were received during the public notice period.

Day 90, after which this permit will be issued by default, is October 28, 1988.

I recommend your approval and signature.

SS/JR/s

attachments

*Please call
Clair Francis
when signed
8-1344*

SENDER: Complete items 1 and 2 when additional services are desired, and complete items 3 and 4.

Put your address in the "RETURN TO" Space on the reverse side. Failure to do this will prevent this card from being returned to you. The return receipt fee will provide you the name of the person delivered to and the date of delivery. For additional fees the following services are available. Consult postmaster for fees and check box(es) for additional service(s) requested.

1. Show to whom delivered, date, and addressee's address. 2. Restricted Delivery
 †(Extra charge)† †(Extra charge)†

| | |
|---|--|
| 3. Article Addressed to: Mr. John A. Cronkhite Senior Vice Pres./Gen. Counsel Sea Ray Boats, Inc. 2600 Sea Ray Blvd. Knoxville, TN 37914 | 4. Article Number P 274 007 475 Type of Service: <input type="checkbox"/> Registered <input type="checkbox"/> Insured <input checked="" type="checkbox"/> Certified <input type="checkbox"/> COD <input type="checkbox"/> Express Mail Always obtain signature of addressee or agent and <u>DATE DELIVERED</u> . |
| 5. Signature - Addressee <i>[Signature]</i> | 8. Addressee's Address (ONLY if requested and fee paid) <i>not Pd</i> |
| 6. Signature - Agent X | |
| 7. Date of Delivery | |

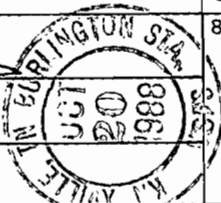

PS Form 3811, Mar. 1987

★ U.S.G.P.O. 1987-178-268

DOMESTIC RETURN RECEIPT

P 274 007 475

RECEIPT FOR CERTIFIED MAIL

NO INSURANCE COVERAGE PROVIDED
 NOT FOR INTERNATIONAL MAIL
 (See Reverse)

★ U.S.G.P.O. 1985-480-794

| | |
|---|---|
| Sent to Mr. John A. Cronkhite, Sea Ray Boats | |
| Street and No. 2600 Sea Ray Drive | |
| P.O., State and ZIP Code Knoxville, TN 37914 | |
| Postage | S |
| Certified Fee | |
| Special Delivery Fee | |
| Restricted Delivery Fee | |
| Return Receipt showing to whom and Date Delivered | |
| Return Receipt showing to whom, Date, and Address of Delivery | |
| TOTAL Postage and Fees | S |
| Postmark or Date Mailed: 10-18-88 Permit: AC 05-151435 | |

PS Form 3800, June 1985



SEA RAY BOATS, INC.
WORLD HEADQUARTERS, 2600 SEA RAY BLVD., KNOXVILLE, TENNESSEE 37914 (615) 522-4181

file copy

September 26, 1988

#9396418084
VIA FEDERAL EXPRESS

RECEIVED

SEP 27 1988

DER-BAQM

Mr. C. H. Fancy, P.E.
Deputy Chief
Bureau of Air Quality Management
Florida Department of Environmental Regulation
Twin Towers Office Building
2600 Blair Stone Road
Tallahassee, Florida 32399-2400

RE: Application for Permit

Dear Mr. Fancy:

Pursuant to your letter of September 8, 1988 and the instructions therein regarding our Application for Permit to construct a fiberglass boat plant in Merritt Island please find enclosed herewith our proof of publication of the Notice of Intent, which was published in the Florida Today newspaper on September 20, 1988.

Very truly yours,

SEA RAY BOATS, INC.

John A. Cronkhite
ch

John A. Cronkhite
Senior Vice President/
General Counsel

JAC:cbh

Enclosure

copied: John Reynolds
Chuck Collins, CF Dist.

CAPE PUBLICATIONS, INC.

The Times

Published Weekly on Wednesday

THE TRIBUNE

Published Weekly on Wednesday



Published Daily

STAR-ADVOCATE

Published Weekly on Wednesday

STATE OF FLORIDA
COUNTY OF BREVARD

Before the undersigned authority personally appeared Linda L. Spicer who on oath says that he/she is Legal Advertising Clerk of the FLORIDA TODAY, a newspaper published in Brevard County, Florida; that the attached copy of advertising being a Notice of Intent

in the matter of permit to Sea Ray Boats, Inc.

in the Court

was published in the FLORIDA TODAY NEWSPAPER September 20, 1988 in the issues of

Affiant further says that the said FLORIDA TODAY NEWSPAPER is a newspaper published in said Brevard County, Florida and that the said newspaper has heretofore been continuously published in said Brevard County, Florida regularly as stated above, and has been entered as second class mail matter at the post office in COCOA, said Brevard County, Florida for a period of one year next preceeding the first publication of the attached copy of advertisement; and affiant further says that he has neither paid nor promised any person, firm or corporation any discount, rebate, commission or refund for the purpose of securing this advertisement for publication in said newspaper.

Linda L. Spicer (handwritten signature)

Sworn and subscribed to before me this 20th day of September 1988

Carol S. Hammack (handwritten signature)

Notary Public, Florida, State at Large My Commission Expires May 27 1989

State of Florida Department of Environmental Regulation Notice of Intent The Department of Environmental Regulation hereby gives notice of its intent to issue a permit to Sea Ray Boats, Inc. to construct a fiberglass boat building plant at their facility in Merritt Island, Florida. The Department is issuing this Intent to issue for the reasons stated in the Technical Evaluation and Preliminary Determination. Persons whose substantial interests are affected by the Department's proposed permitting decision may petition for an administrative determination (hearing) in accordance with Section 120.57, Florida Statutes. The petition must conform to the requirements of Chapters 17-103 and 28-5, Florida Administrative Code, and must be filed (received) in the Department's Office of General Counsel, 2600 Blair Stone Road, Twin Towers Office Building, Tallahassee, Florida 32399-2400, within fourteen (14) days of publication of this notice. Failure to file a petition within this time period constitutes a waiver of any right such person has to request an administrative determination (hearing) under Section 120.57, Florida Statutes. If a petition is filed, the administrative hearing process is designed to formulate agency action. Accordingly, the Department's final action may be different from the proposed agency action. Therefore, persons who may not wish to file a petition may wish to intervene in the proceeding. A petition for intervention must be filed pursuant to Rule 28-5.207, Florida Administrative Code, at least five (5) days before the final hearing and be filed with the hearing officer if one has been assigned at the Division of Administrative Hearings, Department of Administration, 2009 Apalachee Parkway, Tallahassee, Florida 32301. If no hearing officer has been assigned, the petition is to be filed with the Department's Office of General Counsel, 2600 Blair Stone Road, Tallahassee, Florida 32399-2400. Failure to petition to intervene within the allowed time frame constitutes a waiver of any right such person has to request a hearing under Section 120.57, Florida Statutes. The application is available for public inspection during normal business hours, 8:00 a.m. to 5:00 p.m., Monday through Friday, except for legal holidays, at: Dept. of Environmental Regulation Bureau of Air Quality Management 2600 Blair Stone Road Tallahassee, Florida 32399-2400 Dept. of Environmental Regulation Central Florida District 3319 Maguire Blvd., Suite 232 Orlando, Florida 32803-3767 Any person may send written comments on the proposed action to Mr. Bill Thomas at the department's Tallahassee address. All comments mailed within 14 days of the publication of this notice will be considered in the Department's final determination. 1-094028-1T-9/20, 1988, Tuesday



PM
9-16-88
Augusta, GA

file copy

RECEIVED

SEP 19 1988

DER-BAQW

September 16, 1988

Mr. Bill Thomas
Bureau of Air Quality Management
Twin Towers Office Building
2600 Blair Stone Road
Tallahassee, FL 32399-2400

RE: Permit #AC 05-151435
Sea Ray Boats, Inc.
Merritt Island, FL

Dear Mr. Thomas:

Please be advised that since this facility will not be operating at full capacity until after the end of the first year, this facility will be unable to comply with the specific conditions of the referenced permit.

We are requesting that we be allowed to submit, according to EPA Method 24, emissions rates using Material Safety Data Sheets and Usage Logs such as the one attached.

If you have any questions or care to discuss, please call at (803) 648-9300.

Yours truly,

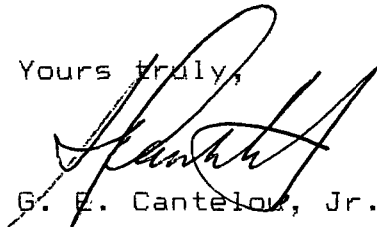

G. E. Cantelou, Jr. P. E.

GEC:sc

Attachment

copied: *G. Reynolds*
C. Collins, CF Dist
CAF/ST

CANTELOU ASSOCIATES

CONSULTING ENGINEERS • SURVEYORS & PLANNERS
1359 Silver Bluff Rd. Suite B-3 / P.O. Box 3102 / Aiken, S.C. 29802

Mr. Bill Thomas
Bureau of Air Quality Management
Twin Towers Office Building
2600 Blair Stone Road
Tallahassee, FL 32399-2400

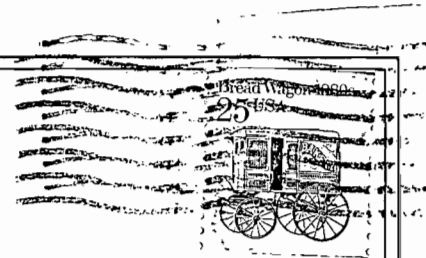
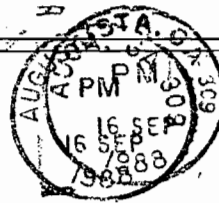

USAGE LOG

WEEK ENDING: _____

| MONDAY | | (1) | (2) | (3) | (4) | (5) | (6) |
|--------------|-----------------------|---------|------------|-------------|--------------|----------------------------------|---------------------------------|
| DESCRIPTION | | DENSITY | VOC FACTOR | TIME FACTOR | AMOUNTS USED | TOTAL VOC EMISSIONS | HOURLY VOC EMISSIONS |
| PRODUCT | COMPONENT | #/GAL | % BY WT | HRS/DAY | (GALS) | (5) = (1)X(2)X(4)/2000 (TONS) | (6) = (1)X(2)X(4)/(3) (#/HR) |
| RESIN | STYRENE | 9.15 | 8 | 16 | | | |
| GEL COAT | STYRENE | 10.7 | 8 | 16 | | | |
| | METHYL METHACRALATE | 10.7 | 8 | 16 | | | |
| MEKP | MEKP | 8.0 | 10 | 16 | | | |
| ADHESIVE | 1,1,1-TRICHLOROETHANE | 10.5 | 66 | 16 | | | |
| ACETONE | ACETONE | 6.1 | 50 | 16 | | | |
| BOTTOM PAINT | BOTTOM PAINT | 11.4 | 60 | 16 | | | |

TOTAL DAILY EMISSIONS _____

| TUESDAY | | (1) | (2) | (3) | (4) | (5) | (6) |
|--------------|-----------------------|---------|------------|-------------|--------------|----------------------------------|---------------------------------|
| DESCRIPTION | | DENSITY | VOC FACTOR | TIME FACTOR | AMOUNTS USED | TOTAL VOC EMISSIONS | HOURLY VOC EMISSIONS |
| PRODUCT | COMPONENT | #/GAL | % BY WT | HRS/DAY | (GALS) | (5) = (1)X(2)X(4)/2000 (TONS) | (6) = (1)X(2)X(4)/(3) (#/HR) |
| RESIN | STYRENE | 9.15 | 8 | 16 | | | |
| GEL COAT | STYRENE | 10.7 | 8 | 16 | | | |
| | METHYL METHACRALATE | 10.7 | 8 | 16 | | | |
| MEKP | MEKP | 8.0 | 10 | 16 | | | |
| ADHESIVE | 1,1,1-TRICHLOROETHANE | 10.5 | 66 | 16 | | | |
| ACETONE | ACETONE | 6.1 | 50 | 16 | | | |
| BOTTOM PAINT | BOTTOM PAINT | 11.4 | 60 | 16 | | | |

TOTAL DAILY EMISSIONS _____

| WEDNESDAY | | (1) | (2) | (3) | (4) | (5) | (6) |
|--------------|-----------------------|---------|------------|-------------|--------------|----------------------------------|---------------------------------|
| DESCRIPTION | | DENSITY | VOC FACTOR | TIME FACTOR | AMOUNTS USED | TOTAL VOC EMISSIONS | HOURLY VOC EMISSIONS |
| PRODUCT | COMPONENT | #/GAL | % BY WT | HRS/DAY | (GALS) | (5) = (1)X(2)X(4)/2000 (TONS) | (6) = (1)X(2)X(4)/(3) (#/HR) |
| RESIN | STYRENE | 9.15 | 8 | 16 | | | |
| GEL COAT | STYRENE | 10.7 | 8 | 16 | | | |
| | METHYL METHACRALATE | 10.7 | 8 | 16 | | | |
| MEKP | MEKP | 8.0 | 10 | 16 | | | |
| ADHESIVE | 1,1,1-TRICHLOROETHANE | 10.5 | 66 | 16 | | | |
| ACETONE | ACETONE | 6.1 | 50 | 16 | | | |
| BOTTOM PAINT | BOTTOM PAINT | 11.4 | 60 | 16 | | | |

TOTAL DAILY EMISSIONS _____

| THURSDAY | | (1) | (2) | (3) | (4) | (5) | (6) |
|--------------|-----------------------|---------|------------|-------------|--------------|----------------------------------|---------------------------------|
| DESCRIPTION | | DENSITY | VOC FACTOR | TIME FACTOR | AMOUNTS USED | TOTAL VOC EMISSIONS | HOURLY VOC EMISSIONS |
| PRODUCT | COMPONENT | #/GAL | % BY WT | HRS/DAY | (GALS) | (5) = (1)X(2)X(4)/2000 (TONS) | (6) = (1)X(2)X(4)/(3) (#/HR) |
| RESIN | STYRENE | 9.15 | 8 | 16 | | | |
| GEL COAT | STYRENE | 10.7 | 8 | 16 | | | |
| | METHYL METHACRALATE | 10.7 | 8 | 16 | | | |
| MEKP | MEKP | 8.0 | 10 | 16 | | | |
| ADHESIVE | 1,1,1-TRICHLOROETHANE | 10.5 | 66 | 16 | | | |
| ACETONE | ACETONE | 6.1 | 50 | 16 | | | |
| BOTTOM PAINT | BOTTOM PAINT | 11.4 | 60 | 16 | | | |

TOTAL DAILY EMISSIONS _____

| FRIDAY | | (1) | (2) | (3) | (4) | (5) | (6) |
|--------------|-----------------------|---------|------------|-------------|--------------|----------------------------------|---------------------------------|
| DESCRIPTION | | DENSITY | VOC FACTOR | TIME FACTOR | AMOUNTS USED | TOTAL VOC EMISSIONS | HOURLY VOC EMISSIONS |
| PRODUCT | COMPONENT | #/GAL | % BY WT | HRS/DAY | (GALS) | (5) = (1)X(2)X(4)/2000 (TONS) | (6) = (1)X(2)X(4)/(3) (#/HR) |
| RESIN | STYRENE | 9.15 | 8 | 16 | | | |
| GEL COAT | STYRENE | 10.7 | 8 | 16 | | | |
| | METHYL METHACRALATE | 10.7 | 8 | 16 | | | |
| MEKP | MEKP | 8.0 | 10 | 16 | | | |
| ADHESIVE | 1,1,1-TRICHLOROETHANE | 10.5 | 66 | 16 | | | |
| ACETONE | ACETONE | 6.1 | 50 | 16 | | | |
| BOTTOM PAINT | BOTTOM PAINT | 11.4 | 60 | 16 | | | |

TOTAL DAILY EMISSIONS _____

TOTAL WEEKLY EMISSIONS _____

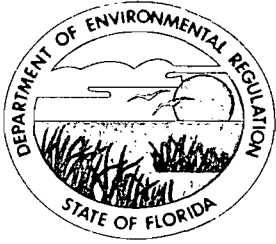

Florida Department of Environmental Regulation

Twin Towers Office Bldg. • 2600 Blair Stone Road • Tallahassee, Florida 32399-2400

Bob Martinez, Governor

Dale Twachtmann, Secretary

John Shearer, Assistant Secretary

September 8, 1988

CERTIFIED MAIL-RETURN RECEIPT REQUESTED

Mr. John A. Cronkhite
Senior Vice President/General Counsel
Sea Ray Boats, Inc.
2600 Sea Ray Boulevard
Knoxville, Tennessee 37914

Dear Mr. Cronkhite:

Attached is one copy of the Technical Evaluation and Preliminary Determination and proposed permit for construction of a fiberglass boat plant at your Merritt Island facility.

Please submit any written comments you wish to have considered concerning the Department's proposed action to Mr. Bill Thomas of the Bureau of Air Quality Management.

Sincerely,

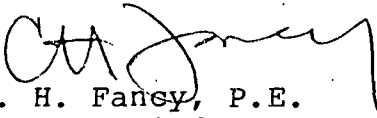
C. H. Fancy, P.E.
Deputy Chief
Bureau of Air Quality
Management

CHF/JR/s

Attachments

cc: C. Collins, CF District
G. E. Cantelou, Jr., P.E.

BEFORE THE STATE OF FLORIDA
DEPARTMENT OF ENVIRONMENTAL REGULATION

In the Matter of
Application for Permit by:

Sea Ray Boats, Inc.
Sea Ray Drive
Merritt Island, Florida

DER File No. AC 05-151435

INTENT TO ISSUE

The Department of Environmental Regulation hereby gives notice of its intent to issue a permit (copy attached) for the proposed project as detailed in the application specified above. The Department is issuing this Intent to Issue for the reasons stated in the attached Technical Evaluation and Preliminary Determination.

The applicant, Sea Ray Boats, Inc., applied on June 30, 1988, to the Department of Environmental Regulation for a permit to construct a fiberglass boat facility in Merritt Island, Brevard County, Florida.

The Department has permitting jurisdiction under Chapter 403, Florida Statutes, and Florida Administrative Code Rules 17-2 and 17-4. The project is not exempt from permitting procedures. The Department has determined that an air construction permit was needed for the proposed work.

Pursuant to Section 403.815, F.S. and DER Rule 17-103.150, FAC, you (the applicant) are required to publish at your own expense the enclosed Notice of Proposed Agency Action on permit applications. The notice must be published one time only in a section of a major local newspaper of general circulation in the county in which the project is located and within thirty (30) days from receipt of this intent. Proof of publication must be provided to the Department within seven days of publication of the notice. Failure to publish the notice and provide proof of publication within the allotted time may result in the denial of the permit.

The Department will issue the permit with the attached conditions unless a petition for an administrative proceeding (hearing) is filed pursuant to the provisions of Section 120.57, F.S. A person whose substantial interests are affected by the

Department's proposed permitting decision may petition for an administrative proceeding (hearing) in accordance with Section 120.57, Florida Statutes. Petitions must comply with the requirements of Florida Administrative Code Rules 17-103.155 and 28-5.201 (copy enclosed) and be filed with (received by) the Office of General Counsel of the Department at 2600 Blair Stone Road, Tallahassee, Florida 32399-2400. Petitions filed by the permit applicant must be filed within fourteen (14) days of receipt of this intent. Petitions filed by other persons must be filed within fourteen (14) days of publication of the public notice or within fourteen (14) days of receipt of this intent, whichever first occurs. Failure to file a petition within this time period shall constitute a waiver of any right such person may have to request an administrative determination (hearing) under Section 120.57, Florida Statutes, concerning the subject permit application. Petitions which are not filed in accordance with the above provisions will be dismissed.

Executed in Tallahassee, Florida.

STATE OF FLORIDA DEPARTMENT
OF ENVIRONMENTAL REGULATION



C. H. Fancy, P.E.
Deputy Chief
Bureau of Air Quality
Management

Copies furnished to:

C. Collins, CF District
G. E. Cahtelou, Jr., P.E.

RULES OF THE ADMINISTRATIVE COMMISSION
MODEL RULES OF PROCEDURE
CHAPTER 28-5
DECISIONS DETERMINING SUBSTANTIAL INTERESTS

28-5.15 Requests for Formal and Informal Proceedings

- (1) Requests for proceedings shall be made by petition to the agency involved. Each petition shall be printed, typewritten or otherwise duplicated in legible form on white paper of standard legal size. Unless printed, the impression shall be on one side of the paper only and lines shall be double spaced and indented.
- (2) All petitions filed under these rules should contain:
 - (a) The name and address of each agency affected and each agency's file or identification number, if known;
 - (b) The name and address of the petitioner or petitioners;
 - (c) All disputed issues of material fact. If there are none, the petition must so indicate;
 - (d) A concise statement of the ultimate facts alleged, and the rules, regulations and constitutional provisions which entitle the petitioner to relief;
 - (e) A statement summarizing any informal action taken to resolve the issues, and the results of that action;
 - (f) A demand for the relief to which the petitioner deems himself entitled; and
 - (g) Such other information which the petitioner contends is material.

CERTIFICATE OF SERVICE

The undersigned duly designated deputy clerk hereby certifies that this NOTICE OF INTENT TO ISSUE and all copies were mailed before the close of business on 9-9-88.

FILING AND ACKNOWLEDGEMENT
FILED, on this date, pursuant to
§120.52(9), Florida Statutes, with
the designated Department Clerk,
receipt of which is hereby
acknowledged.

Judy Rogers
Clerk

9-9-88
Date

State of Florida
Department of Environmental Regulation
Notice of Intent

The Department of Environmental Regulation hereby gives notice of its intent to issue a permit to Sea Ray Boats, Inc. to construct a fiberglass boat building plant at their facility in Merritt Island, Florida. The Department is issuing this Intent to Issue for the reasons stated in the Technical Evaluation and Preliminary Determination.

Persons whose substantial interests are affected by the Department's proposed permitting decision may petition for an administrative determination (hearing) in accordance with Section 120.57, Florida Statutes. The petition must conform to the requirements of Chapters 17-103 and 28-5, Florida Administrative Code, and must be filed (received) in the Department's Office of General Counsel, 2600 Blair Stone Road, Twin Towers Office Building, Tallahassee, Florida 32399-2400, within fourteen (14) days of publication of this notice. Failure to file a petition within this time period constitutes a waiver of any right such person has to request an administrative determination (hearing) under Section 120.57, Florida Statutes.

If a petition is filed, the administrative hearing process is designed to formulate agency action. Accordingly, the Department's final action may be different from the proposed agency action. Therefore, persons who may not wish to file a petition may wish to intervene in the proceeding. A petition for intervention must be filed pursuant to Rule 28-5.207, Florida Administrative Code, at least five (5) days before the final hearing and be filed with the hearing officer if one has been assigned at the Division of Administrative Hearings, Department of Administration, 2009 Apalachee Parkway, Tallahassee, Florida 32301. If no hearing officer has been assigned, the petition is to be filed with the Department's Office of General Counsel, 2600 Blair Stone Road, Tallahassee, Florida 32399-2400. Failure to petition to intervene within the allowed time frame constitutes a waiver of any right such person has to request a hearing under Section 120.57, Florida Statutes.

The application is available for public inspection during normal business hours, 8:00 a.m. to 5:00 p.m., Monday through Friday, except legal holidays, at:

Dept. of Environmental Regulation
Bureau of Air Quality Management
2600 Blair Stone Road
Tallahassee, Florida 32399-2400

Dept. of Environmental Regulation
Central Florida District
3319 Maguire Blvd., Suite 232
Orlando, Florida 32803-3767

Any person may send written comments on the proposed action to Mr. Bill Thomas at the Department's Tallahassee address. All comments mailed within 14 days of the publication of this notice will be considered in the Department's final determination.

Technical Evaluation
and
Preliminary Determination

Sea Ray Boats, Inc.
Brevard County
Merritt Island, Florida

Fiberglass Boat Plant
Permit No. AC 05-151435

Florida Department of Environmental Regulation
Bureau of Air Quality Management
Central Air Permitting

September 8, 1988

I. Application Information

A. Applicant

Sea Ray Boats, Inc.
Sea Ray Drive
Merritt Island, Florida

B. Request

The Department received an application on June 30, 1988, for a permit to construct a fiberglass boat plant at the applicant's site in Merritt Island, Florida. The application was deemed complete on July 29, 1988.

C. Location/Classification

The applicant's boat manufacturing facility (SIC Code 3732) is located off State Road 3 near the Canaveral Port Authority in Merritt Island. Latitude and longitude are 28°24'26" N and 80°42'03" W, respectively. The UTM coordinates of the site are: Zone 17, 529.3 km E and 3,142.1 km N.

II. Project Description/Emissions

Fiberglass pleasure boats will be manufactured using an airless mold injection method. Laminations of resin and fiberglass are applied over gel coat before the wooden and foam structural parts are installed. After lamination the boats are extracted from their molds and trimmed of excess material. Upholstered parts are then prepared and used in the final assembly along with parts manufactured elsewhere.

Fiberglass boat manufacturing generates particulate emissions (sawdust from wood working and fiberglass from grinding) as well hydrocarbon (VOC) emissions from the molding operation. The applicant proposes using a high efficiency dust collection system to collect and recover essentially all of the particulate emissions. The VOC emissions, which total less than 100 TPY and are impractical to collect and treat, will be vented from the lamination building by exhaust fans.

III. Rule Applicability

The construction permit application is subject to review under Chapter 403, Florida Statutes, and Florida Administrative Code (FAC) Rules 17-2 and 17-4. The proposed facility is to be located in an area classified as attainment for regulated air pollutants. Since the proposed facility is classified as minor, it is not subject to the new source review requirements of Rule 17-2.500. Applicable rules are (1) FAC Rule 17-2.520, Sources Not Subject to Prevention of Significant Deterioration or Nonattainment Requirements; (2) FAC Rule 17-2.610, General

Particulate Emission Limiting Standards; and (3) General Pollutant Emission Limiting Standards.

IV. Conclusion

The permit application should be approved.



Florida Department of Environmental Regulation

Twin Towers Office Bldg. • 2600 Blair Stone Road • Tallahassee, Florida 32399-2400

Bob Martinez, Governor

Dale Twachtmann, Secretary

John Shearer, Assistant Secretary

PERMITTEE:

Sea Ray Boats, Inc.
Sea Ray Drive
Merritt Island, FL

Permit Number: AC 05-151435
Expiration Date: August 31, 1989
County: Brevard
Latitude/Longitude: 28° 24' 26"N
80° 42' 03"W
Project: Fiberglass Boat Plant

This permit is issued under the provisions of Chapter 403, Florida Statutes, and Florida Administrative Code (FAC) Rules 17-2 and 17-4. The above named permittee is hereby authorized to perform the work or operate the facility shown on the application and approved drawing(s), plans, and other documents attached hereto or on file with the Department and made a part hereof and specifically described as follows:

For the construction of a facility to produce fiberglass pleasure boats. This project will be located near the Canaveral Port Authority in Merritt Island, Brevard County, Florida. The UTM coordinates of this site are Zone 17, 529.3 km E and 3,142.1 km N.

Construction shall be in accordance with the permit application and plans, documents, and reference material submitted unless otherwise stated in the Preliminary Determination and Technical Evaluation or the General and Specific Conditions herein.

Attachments:

1. Application to Operate/Construct Air Pollution Sources, DER Form 17-202(1), received on June 30, 1988.

PERMITTEE:
Sea Ray Boats, Inc.

Permit Number: AC 05-151435
Expiration Date: August 31, 1989

GENERAL CONDITIONS:

1. The terms, conditions, requirements, limitations, and restrictions set forth herein are "Permit Conditions" and as such are binding upon the permittee and enforceable pursuant to the authority of Sections 403.161, 403.727, or 403.859 through 403.861, Florida Statutes. The permittee is hereby placed on notice that the Department will review this permit periodically and may initiate enforcement action for any violation of the "Permit Conditions" by the permittee, its agents, employees, servants or representatives.

2. This permit is valid only for the specific processes and operations applied for and indicated in the approved drawings or exhibits. Any unauthorized deviation from the approved drawings, exhibits, specifications, or conditions of this permit may constitute grounds for revocation and enforcement action by the Department.

3. As provided in Subsections 403.087(6) and 403.722(5), Florida Statutes, the issuance of this permit does not convey any vested rights or any exclusive privileges. Nor does it authorize any injury to public or private property or any invasion of personal rights, nor any infringement of federal, state or local laws or regulations. This permit does not constitute a waiver of or approval of any other Department permit that may be required for other aspects of the total project which are not addressed in the permit.

4. This permit conveys no title to land or water, does not constitute state recognition or acknowledgement of title, and does not constitute authority for the use of submerged lands unless herein provided and the necessary title or leasehold interests have been obtained from the state. Only the Trustees of the Internal Improvement Trust Fund may express state opinion as to title.

5. This permit does not relieve the permittee from liability for harm or injury to human health or welfare, animal, plant or aquatic life or property and penalties therefore caused by the construction or operation of this permitted source, nor does it allow the permittee to cause pollution in contravention of Florida Statutes and Department rules, unless specifically authorized by an order from the Department.

PERMITTEE:
Sea Ray Boats, Inc.

Permit Number: AC 05-151435
Expiration Date: August 31, 1989

GENERAL CONDITIONS:

6. The permittee shall at all times properly operate and maintain the facility and systems of treatment and control (and related appurtenances) that are installed or used by the permittee to achieve compliance with the conditions of this permit, as required by Department rules. This provision includes the operation of backup or auxiliary facilities or similar systems when necessary to achieve compliance with the conditions of the permit and when required by Department rules.

7. The permittee, by accepting this permit, specifically agrees to allow authorized Department personnel, upon presentation of credentials or other documents as may be required by law, access to the premises, at reasonable times, where the permitted activity is located or conducted for the purpose of:

- a. Having access to and copying any records that must be kept under the conditions of the permit;
- b. Inspecting the facility, equipment, practices, or operations regulated or required under this permit; and
- c. Sampling or monitoring any substances or parameters at any location reasonably necessary to assure compliance with this permit or Department rules.

Reasonable time may depend on the nature of the concern being investigated.

8. If, for any reason, the permittee does not comply with or will be unable to comply with any condition or limitation specified in this permit, the permittee shall immediately notify and provide the Department with the following information:

- a. a description of and cause of non-compliance; and
- b. the period of noncompliance, including exact dates and times; or, if not corrected, the anticipated time the noncompliance is expected to continue, and steps being taken to reduce, eliminate, and prevent recurrence of the noncompliance.

PERMITTEE:
Sea Ray Boats, Inc.

Permit Number: AC 05-151435
Expiration Date: August 31, 1989

GENERAL CONDITIONS:

The permittee shall be responsible for any and all damages which may result and may be subject to enforcement action by the Department for penalties or revocation of this permit.

9. In accepting this permit, the permittee understands and agrees that all records, notes, monitoring data and other information relating to the construction or operation of this permitted source, which are submitted to the Department, may be used by the department as evidence in any enforcement case arising under the Florida Statutes or Department rules, except where such use is proscribed by Sections 403.73 and 403.111, Florida Statutes.

10. The permittee agrees to comply with changes in Department rules and Florida Statutes after a reasonable time for compliance, provided however, the permittee does not waive any other rights granted by Florida Statutes or Department rules.

11. This permit is transferable only upon Department approval in accordance with Florida Administrative Code Rules 17-4.12 and 17-30.30, as applicable. The permittee shall be liable for any noncompliance of the permitted activity until the transfer is approved by the Department.

12. This permit is required to be kept at the work site of the permitted activity during the entire period of construction or operation.

13. This permit also constitutes:

- () Determination of Best Available Control Technology (BACT)
- () Determination of Prevention of Significant Deterioration (PSD)
- () Compliance with New Source Performance Standards

14. The permittee shall comply with the following monitoring and record keeping requirements:

- a. Upon request, the permittee shall furnish all records and plans required under Department rules. The retention period for all records will be extended automatically, unless otherwise stipulated by the Department, during the course of any unresolved enforcement action.

PERMITTEE:
Sea Ray Boats, Inc.

Permit Number: AC 05-151435
Expiration Date: August 31, 1989

GENERAL CONDITIONS:

- b. The permittee shall retain at the facility or other location designated by this permit records of all monitoring information (including all calibration and maintenance records and all original strip chart recordings for continuous monitoring instrumentation), copies of all reports required by this permit, and records of all data used to complete the application for this permit. The time period of retention shall be at least three years from the date of the sample, measurement, report or application unless otherwise specified by Department rule.
- c. Records of monitoring information shall include:
- the date, exact place, and time of sampling or measurements;
 - the person responsible for performing the sampling or measurements;
 - the date(s) analyses were performed;
 - the person responsible for performing the analyses;
 - the analytical techniques or methods used; and
 - the results of such analyses.

15. When requested by the Department, the permittee shall within a reasonable time furnish any information required by law which is needed to determine compliance with the permit. If the permittee becomes aware that relevant facts were not submitted or were incorrect in the permit application or in any report to the Department, such facts or information shall be submitted or corrected promptly.

SPECIFIC CONDITIONS:

1. The construction and operation of this source shall be in accordance with the capacities and specifications stated in the application.
2. The plant shall be allowed to operate for up to 3,840 hours per year.

PERMITTEE:
Sea Ray Boats, Inc.

Permit Number: AC 05-151435
Expiration Date: August 31, 1989

SPECIFIC CONDITIONS:

3. Visible emissions from the dust collectors shall not be greater than 5% opacity and compliance shall be demonstrated at 90-100% of permitted capacity using DER Method 9 in accordance with FAC Rule 17-2.700.

4. Hydrocarbon emissions (VOC) shall not exceed the following calculated values and total VOC emissions from the facility shall not exceed 49.8 lbs/hr, 797 lbs/day (30 day average), and 95.6 tons/yr. Compliance shall be demonstrated by applying the following raw material utilization rates and emission factors:

| | Utilization Rate lbs/hr | Emission Factor | Emissions (lbs/hr) |
|------------------------|----------------------------|--------------------|-----------------------|
| Styrene | 372.5 | 0.08 | 29.80 |
| Methyl Methacrylate | 49.5 | 0.08 | 3.96 |
| MEKP | 4.7 | 0.10 | 0.47 |
| 1,1,1,-Trichloroethane | 3.5 | 0.66 | 2.31 |
| Acetone | 12.5 | 0.50 | 6.25 |
| Bottom Paint | 11.7 | 0.60 | 7.02 |

5. No air pollutants shall be discharged which cause or contribute to an objectionable odor.

6. The compliance test shall be conducted within 30 days after operation begins and the results reported to the Department before this construction permit expires. The Department shall be notified at least 15 days in advance of the test and at least 5 days prior to the plant being placed in operation.

7. An application for a permit to operate shall be submitted to the Department's Central Florida District office at least 60 days prior to the expiration date of this permit or within 45 days of testing, whichever occurs first.

Issued this _____ day of _____, 1988

STATE OF FLORIDA DEPARTMENT OF
ENVIRONMENTAL REGULATION

Dale Twachtmann, Secretary

ATTACHMENT 1

Available Upon Request.

P 274 007 448

RECEIPT FOR CERTIFIED MAIL

NO INSURANCE COVERAGE PROVIDED
NOT FOR INTERNATIONAL MAIL
(See Reverse)

* U.S.G.P.O. 1985-480-794

PS Form 3800, June 1985

| | |
|---|----|
| Sent to Mr. John A. Cronkhite, Sea Ray Boats | |
| Street and No. 2600 Sea Ray Blvd. | |
| P.O., State and ZIP Code Knoxville, TN 37914 | |
| Postage | \$ |
| Certified Fee | |
| Special Delivery Fee | |
| Restricted Delivery Fee | |
| Return Receipt showing to whom and Date Delivered | |
| Return Receipt showing to whom, Date, and Address of Delivery | |
| TOTAL Postage and Fees | \$ |
| Postmark or Date Mailed 9-9-88 Permit: AC 05-151435 | |

SENDER: Complete items 1 and 2 when additional services are desired, and complete items 3 and 4.

Put your address in the "RETURN TO" Space on the reverse side. Failure to do this will prevent this card from being returned to you. The return receipt fee will provide you the name of the person delivered to and the date of delivery. For additional fees the following services are available. Consult postmaster for fees and check box(es) for additional service(s) requested.

- 1. Show to whom delivered, date, and addressee's address. ↑(Extra charge)↑
- 2. Restricted Delivery ↑(Extra charge)↑

| | |
|--|---|
| 3. Article Addressed to: Mr. John A. Cronkhite Senior VP/General Counsel Sea Ray Boats, Inc. 2600 Sea Ray Blvd. Knoxville, TN 37914 | 4. Article Number P 274 007 448 Type of Service: <input type="checkbox"/> Registered <input type="checkbox"/> Insured <input checked="" type="checkbox"/> Certified <input type="checkbox"/> COD <input type="checkbox"/> Express Mail |
| Always obtain signature of addressee or agent and DATE DELIVERED. | |
| 5. Signature - Addressee <input checked="" type="checkbox"/> <i>John A. Cronkhite</i> | 8. Addressee's Address (ONLY if requested and fee paid) |
| 6. Signature - Agent <input checked="" type="checkbox"/> | |
| 7. Date of Delivery | |

PS Form 3811, Mar. 1987

* U.S.G.P.O. 1987-178-268

DOMESTIC RETURN RECEIPT

P 274 007 449

RECEIPT FOR CERTIFIED MAIL

NO INSURANCE COVERAGE PROVIDED
NOT FOR INTERNATIONAL MAIL
(See Reverse)

* U.S.G.P.O. 1985-480-794

PS Form 3800, June 1985

| | |
|---|----|
| Sent to G. E. Cantelou, P.E., Cantelou Assoc. | |
| Street and No. P.O. Box 2102 | |
| P.O., State and ZIP Code Aiken, SC 29802 | |
| Postage | \$ |
| Certified Fee | |
| Special Delivery Fee | |
| Restricted Delivery Fee | |
| Return Receipt showing to whom and Date Delivered | |
| Return Receipt showing to whom, Date, and Address of Delivery | |
| TOTAL Postage and Fees | \$ |
| Postmark or Date Mailed: 9-9-88 Permit: AC 05-151435 | |

SENDER: Complete items 1 and 2 when additional services are desired, and complete items 3 and 4.

Put your address in the "RETURN TO" Space on the reverse side. Failure to do this will prevent this card from being returned to you. The return receipt fee will provide you the name of the person delivered to and the date of delivery. For additional fees the following services are available. Consult postmaster for fees and check box(es) for additional service(s) requested.

- 1. Show to whom delivered, date, and addressee's address. ↑(Extra charge)↑
- 2. Restricted Delivery ↑(Extra charge)↑

| | |
|---|---|
| 3. Article Addressed to: G. E. Cantelou, Jr., P.E. Cantelou Associates, Inc. Post Office Box 2102 Aiken, South Carolina 29802 | 4. Article Number P 274 007 449 Type of Service: <input type="checkbox"/> Registered <input type="checkbox"/> Insured <input checked="" type="checkbox"/> Certified <input type="checkbox"/> COD <input type="checkbox"/> Express Mail |
| Always obtain signature of addressee or agent and DATE DELIVERED. | |
| 5. Signature - Addressee <input checked="" type="checkbox"/> <i>Brenda Cantelou</i> | 8. Addressee's Address (ONLY if requested and fee paid) |
| 6. Signature - Agent <input checked="" type="checkbox"/> | |
| 7. Date of Delivery <i>9-13-88</i> | |

PS Form 3811, Mar. 1987

* U.S.G.P.O. 1987-178-268

DOMESTIC RETURN RECEIPT

APPLICATION TRACKING SYSTEM

06/30/88

APPL NO:151435

APPL RECVD:06/30/88 TYPE CODE:AC SUBCODE:05 LAST UPDATE:06/30/88

DER OFFICE RECVD:ORL DER OFFICE TRANSFER TO:BAQ APPLICATION COMPLETE: / /

DER PROCESSOR:J-TURNER

APPL STATUS:AC DATE:06/30/88 (ACTIVE/DENIED/WITHDRAWN/EXEMPT/ISSUED/GENERAL)

RELIEF: (SSAC/EXEMPTIONS/VARIANCE)

(Y/N) N MANUAL TRACKING DISTRICT:30 COUNTY:05
(Y/N) N DNR REVIEW REQD? LAT/LONG:28.24.26/80.42.03
(Y/N) N PUBLIC NOTICE REQD? BASIN-SEGMENT:
(Y/N) N GOV BODY LOCAL APPROVAL REQD? COE #:
(Y/N) Y LETTER OF INTENT REQD? (I/ISSUE D/DENY) ALT#:

PROJECT SOURCE NAME:SEA RAY BOATS/LAMINATION & ASSEMBLY

STREET:SEA RAY DRIVE CITY:MERRITT ISLAND

STATE:FL ZIP: PHONE:

APPLICATION NAME:CANTELOU ASSOCIATES, INC.

STREET:POST OFFICE BOX 3102 CITY:AIKEN

STATE:SC ZIP:29802 PHONE:803-648-9300

AGENT NAME:

STREET: CITY:

STATE: ZIP: PHONE:

FEE #1 DATE PAID:06/30/88 AMOUNT PAID:00750 RECEIPT NUMBER:00124304

Table with columns for event codes (B, C, D, E, F, G, H, I, J, K, L, M, N), descriptions, and dates. Includes rows for 'DATE APPLICANT INFORMED OF NEED FOR PUBLIC NOTICE', 'DATE DER SENT DNR APPLICATION', etc.

COMMENTS: 1. How or current facility? 2. checkmate fee? 3. One copy received.

STATE OF FLORIDA
DEPARTMENT OF ENVIRONMENTAL REGULATION

Nº 124304

RECEIPT FOR APPLICATION FEES AND MISCELLANEOUS REVENUE

Received from Sea Ray, Inc. Date June 30, 1988

Address 3600 Sea Ray Blvd. Kissimmee, Fla. 32741 Dollars \$ 750.00

Applicant Name & Address _____

Source of Revenue same

Revenue Code 0010-31 ck 5947 Application Number ADOS-151435

By V. Lelchak

STATE OF FLORIDA
DEPARTMENT OF ENVIRONMENTAL REGULATION

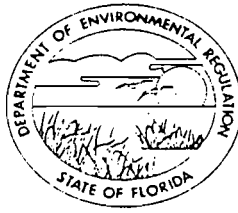

BOB MARTINEZ
GOVERNOR
DALE TWACHTMANN
SECRETARY
ALEX ALEXANDER
DISTRICT MANAGER

CENTRAL FLORIDA DISTRICT
3319 MAGUIRE BOULEVARD
SUITE 202
ORLANDO, FLORIDA 32803-3757

P 750
JUN 30 1988 D

APPLICATION TO OPERATE/CONSTRUCT AIR POLLUTION SOURCES

SOURCE TYPE: Fiberglass Boat Plant New¹ Existing

APPLICATION TYPE: Construction Operation Modification

COMPANY NAME: Sea Ray Boats, Inc. COUNTY: DER BACH

Identify the specific emission point source(s) addressed in this application (i.e. Lime Kiln No. 4 with Venturi Scrubber; Peaking Unit No. 2, Gas Fired Lamination & Assembly

SOURCE LOCATION: Street Sea Ray Drive City Merritt Island Building

UTM: East Zone 17 - 529,300 E North 3,142,100 N

Latitude 28° 24' 26" N Longitude 80° 42' 03" W

APPLICANT NAME AND TITLE: Cantelou Associates, Inc.

APPLICANT ADDRESS: P. O. Box 3102, Aiken, S. C., 29802

SECTION I: STATEMENTS BY APPLICANT AND ENGINEER

A. APPLICANT

I am the undersigned owner or authorized representative* of Sea Ray Boats, Inc.
Sykes Creek Plant

I certify that the statements made in this application for a Boat Manuf. Plant permit are true, correct and complete to the best of my knowledge and belief. Further I agree to maintain and operate the pollution control source and pollution control facilities in such a manner as to comply with the provision of Chapter 403, Florida Statutes, and all the rules and regulations of the department and revisions thereof. I also understand that a permit, if granted by the department, will be non-transferable and I will promptly notify the department upon sale or legal transfer of the permitted establishment.

*Attach letter of authorization

Signed: [Signature]
G. E. Cantelou, Jr. P.E.
Name and Title (Please Type)

Date: 6-28-88 Telephone No. 803-648-9300

B. PROFESSIONAL ENGINEER REGISTERED IN FLORIDA (where required by Chapter 471, F.S.)

This is to certify that the engineering features of this pollution control project have been designed/examined by me and found to be in conformity with modern engineering principles applicable to the treatment and disposal of pollutants characterized in the permit application. There is reasonable assurance, in my professional judgment, that

¹ See Florida Administrative Code Rule 17-2.100(57) and (104)

the pollution control facilities, when properly maintained and operated, will discharge an effluent that complies with all applicable statutes of the State of Florida and the rules and regulations of the department. It is also agreed that the undersigned will furnish, if authorized by the owner, the applicant a set of instructions for the proper maintenance and operation of the pollution control facilities and, if applicable, pollution sources.

Signed _____

G. E. Cantelou, Jr. P. E.

Name (Please Type)

Cantelou Associates, Inc.

Company Name (Please Type)

P. O. Box 3102, Aiken, S. C. 29802

Mailing Address (Please Type)

Florida Registration No. 18006 Date: June 28, 1988 Telephone No. 803/648-9300

SECTION II: GENERAL PROJECT INFORMATION

A. Describe the nature and extent of the project. Refer to pollution control equipment, and expected improvements in source performance as a result of installation. State whether the project will result in full compliance. Attach additional sheet if necessary.

The proposed facility will produce fiberglass pleasure boats. The complete procedure is described in detail under Section V:

Supplemental Requirements Article 7.

B. Schedule of project covered in this application (Construction Permit Application Only)

Start of Construction August 1, 1988 Completion of Construction March 30, 1989

C. Costs of pollution control system(s): (Note: Show breakdown of estimated costs only for individual components/units of the project serving pollution control purposes. Information on actual costs shall be furnished with the application for operation permit.)

Dust Collection System - \$120,000 (approximately)

D. Indicate any previous DER permits, orders and notices associated with the emission point, including permit issuance and expiration dates.

Permit Number 051322579

3840

E. Requested permitted equipment operating time: hrs/day 16 ; days/wk 5 ; wks/yr 48 ;
if power plant, hrs/yr _____ ; if seasonal, describe: Does Not Apply

F. If this is a new source or major modification, answer the following questions.
(Yes or No)

- 1. Is this source in a non-attainment area for a particular pollutant? No
 - a. If yes, has "offset" been applied? _____
 - b. If yes, has "Lowest Achievable Emission Rate" been applied? _____
 - c. If yes, list non-attainment pollutants. _____
- 2. Does best available control technology (BACT) apply to this source?
If yes, see Section VI. No
- 3. Does the State "Prevention of Significant Deterioration" (PSD)
requirement apply to this source? If yes, see Sections VI and VII. No
- 4. Do "Standards of Performance for New Stationary Sources" (NSPS)
apply to this source? No
- 5. Do "National Emission Standards for Hazardous Air Pollutants"
(NESHAP) apply to this source? No

- H. Do "Reasonably Available Control Technology" (RACT) requirements apply
to this source? No
 - a. If yes, for what pollutants? _____
 - b. If yes, in addition to the information required in this form,
any information requested in Rule 17-2.650 must be submitted.

Attach all supportive information related to any answer of "Yes". Attach any justifi-
cation for any answer of "No" that might be considered questionable.

SECTION III: AIR POLLUTION SOURCES & CONTROL DEVICES (Other than Incinerators)

A. Raw Materials and Chemicals Used in your Process, if applicable:

| Description | Contaminants | | Utilization Rate - lbs/hr | Relate to Flow Diagram |
|----------------|------------------------|------|---------------------------|------------------------|
| | Type | % Wt | | |
| Resin | Styrene | 40 | 323. | Step 2 |
| Gelcoat | Styrene | 35 | { 49.5 } | Step 1 |
| Gelcoat | Methyl Methacralate | 5 | | Step 1 |
| MEKP9 | MEKP | 34 | 4.7 | Steps 1,2 |
| Glue(adhesive) | 1,1,1-Tri-chloroethane | 34 | 3.5 | Step 4 |
| Acetone | Acetone | 99 | 12.5 | Steps 1,1,5 |
| Bottom Paint | *1 Misc. | 43 | 11.7 | Step 5 (outside) |

B. Process Rate, if applicable: (See Section V, Item 1)

1. Total Process Input Rate (lbs/hr): _____

2. Product Weight (lbs/hr): _____

C. Airborne Contaminants Emitted: (Information in this table must be submitted for each emission point, use additional sheets as necessary)

| Name of Contaminant | Emission ¹ | | Allowed ² Emission Rate per Rule 17-2 | Allowable ³ Emission lbs/hr | Potential ⁴ Emission | | Relate to Flow Diagram |
|------------------------|-----------------------|-------------|--|--|---------------------------------|-------|------------------------|
| | Maximum lbs/hr | Actual T/yr | | | lbs/yr | T/yr | |
| Styrene | 29.8 | 57.2 | Not Determined | | 260,000 | 130.0 | Step 1,2 |
| Methyl Methacralate | 3.96 | 7.6 | Not Determined | | 34,600 | 17.3 | Step 1 |
| MEKP | 0.47 | 0.9 | Not Determined | | 4,000 | 2.0 | Step 1,2 |
| 1,1,1-Tri-chloroethane | 2.31 | 4.4 | Not Determined | | 20,100 | 10.1 | Step 4 |
| Acetone | 6.25 | 12. | Not Determined | | 54,600 | 27.3 | Step 1,2,5 |
| *1 Misc. | 7 | 13.4 | Not Determined | | 61,000 | 30.5 | Step 3,4,5 |

¹See Section V, Item 2.

217.2

²Reference applicable emission standards and units (e.g. Rule 17-2.600(5)(b)2. Table II, E. (1) - 0.1 pounds per million BTU heat input)

³Calculated from operating rate and applicable standard.

⁴Emission, if source operated without control (See Section V, Item 3).

D. Control Devices: (See Section V, Item 4)

| Name and Type (Model & Serial No.) | Contaminant | Efficiency | Range of Particles Size Collected (in microns) (If applicable) | Basis for Efficiency (Section V Item 5) |
|--|---------------|------------|---|--|
| Dust Collector Mfg., Not Determined | SawDust(Wood) | ±99% | (Not Vented) | |
| | | | | |
| | | | | |
| | | | | |
| | | | | |
| | | | | |

E. Fuels

| Type (Be Specific) | Consumption* | | Maximum Heat Input (MMBTU/hr) |
|--------------------|--------------|---------|----------------------------------|
| | avg/hr | max./hr | |
| | | | |
| | | | |
| | | | |
| | | | |

*Units: Natural Gas--MMCF/hr; Fuel Oils--gallons/hr; Coal, wood, refuse, other--lbs/hr.

Fuel Analysis:

Percent Sulfur: _____ Percent Ash: _____

Density: _____ lbs/gal Typical Percent Nitrogen: _____

Heat Capacity: _____ BTU/lb _____ BTU/gal

Other Fuel Contaminants (which may cause air pollution): _____

F. If applicable, indicate the percent of fuel used for space heating.

Annual Average _____ Maximum _____

G. Indicate liquid or solid wastes generated and method of disposal.

Contaminated acetone is recycled by licensed handler off-site

Solid waste generated is non-toxic and non-hazardous and is disposed

of offsite (incinerated)

H. Emission Stack Geometry and Flow Characteristics (Provide data for each stack):

Stack Height: DOES NOT APPLY ft. Stack Diameter: _____ ft.
 Gas Flow Rate: _____ ACFM _____ DSCFM Gas Exit Temperature: _____ °F.
 Water Vapor Content: _____ % Velocity: _____ FPS

SECTION IV: INCINERATOR INFORMATION DOES NOT APPLY

| Type of Waste | Type 0 (Plastics) | Type I (Rubbish) | Type II (Refuse) | Type III (Garbage) | Type IV (Pathological) | Type V (Liq. & Gas By-prod.) | Type VI (Solid By-prod.) |
|--------------------------|-------------------|------------------|------------------|--------------------|------------------------|------------------------------|--------------------------|
| Actual lb/hr Incinerated | | | | | | | |
| Uncontrolled (lbs/hr) | | | | | | | |

Description of Waste _____

Total Weight Incinerated (lbs/hr) _____ Design Capacity (lbs/hr) _____

Approximate Number of Hours of Operation per day _____ day/wk _____ wks/yr. _____

Manufacturer _____

Date Constructed _____ Model No. _____

| | Volume (ft) ³ | Heat Release (BTU/hr) | Fuel | | Temperature (°F) |
|-------------------|--------------------------|-----------------------|------|--------|------------------|
| | | | Type | BTU/hr | |
| Primary Chamber | | | | | |
| Secondary Chamber | | | | | |

Stack Height: _____ ft. Stack Diameter: _____ Stack Temp. _____

Gas Flow Rate: _____ ACFM _____ DSCFM* Velocity: _____ FPS

*If 50 or more tons per day design capacity, submit the emissions rate in grains per standard cubic foot dry gas corrected to 50% excess air.

Type of pollution control device: Cyclone Wet Scrubber Afterburner
 Other (specify) _____

Brief description of operating characteristics of control devices: _____

Ultimate disposal of any effluent other than that emitted from the stack (scrubber water, ash, etc.):

NOTE: Items 2, 3, 4, 6, 7, 8, and 10 in Section V must be included where applicable.

SECTION V: SUPPLEMENTAL REQUIREMENTS *See Attachment I

Please provide the following supplements where required for this application.

1. Total process input rate and product weight -- show derivation [Rule 17-2.100(127)]
2. To a construction application, attach basis of emission estimate (e.g., design calculations, design drawings, pertinent manufacturer's test data, etc.) and attach proposed methods (e.g., FR Part 60 Methods 1, 2, 3, 4, 5) to show proof of compliance with applicable standards. To an operation application, attach test results or methods used to show proof of compliance. Information provided when applying for an operation permit from a construction permit shall be indicative of the time at which the test was made.
3. Attach basis of potential discharge (e.g., emission factor, that is, AP42 test).
4. With construction permit application, include design details for all air pollution control systems (e.g., for baghouse include cloth to air ratio; for scrubber include cross-section sketch, design pressure drop, etc.)
5. With construction permit application, attach derivation of control device(s) efficiency. Include test or design data. Items 2, 3 and 5 should be consistent: actual emissions = potential (1-efficiency).
6. An 8 1/2" x 11" flow diagram which will, without revealing trade secrets, identify the individual operations and/or processes. Indicate where raw materials enter, where solid and liquid waste exit, where gaseous emissions and/or airborne particles are evolved and where finished products are obtained.
7. An 8 1/2" x 11" plot plan showing the location of the establishment, and points of airborne emissions, in relation to the surrounding area, residences and other permanent structures and roadways (Example: Copy of relevant portion of USGS topographic map).
8. An 8 1/2" x 11" plot plan of facility showing the location of manufacturing processes and outlets for airborne emissions. Relate all flows to the flow diagram.

9. The appropriate application fee in accordance with Rule 17-4.05. The check should be made payable to the Department of Environmental Regulation.
10. With an application for operation permit, attach a Certificate of Completion of Construction indicating that the source was constructed as shown in the construction permit.

SECTION VI: BEST AVAILABLE CONTROL TECHNOLOGY

A. Are standards of performance for new stationary sources pursuant to 40 C.F.R. Part 60 applicable to the source?

Yes No

| Contaminant | Rate or Concentration |
|-------------|-----------------------|
| | |
| | |
| | |

B. Has EPA declared the best available control technology for this class of sources (If yes, attach copy)

Yes No

| Contaminant | Rate or Concentration |
|-------------|-----------------------|
| | |
| | |
| | |

C. What emission levels do you propose as best available control technology?

| Contaminant | Rate or Concentration |
|-------------|-----------------------|
| | |
| | |
| | |

D. Describe the existing control and treatment technology (if any).

- | | |
|---------------------------|--------------------------|
| 1. Control Device/System: | 2. Operating Principles: |
| 3. Efficiency:* | 4. Capital Costs: |

*Explain method of determining

5. Useful Life:

6. Operating Costs:

7. Energy:

8. Maintenance Cost:

9. Emissions:

Contaminant

Rate or Concentration

| Contaminant | Rate or Concentration |
|-------------|-----------------------|
| | |
| | |
| | |
| | |

10. Stack Parameters

- a. Height: ft.
- b. Diameter: ft.
- c. Flow Rate: ACFM
- d. Temperature: °F.
- e. Velocity: FPS

E. Describe the control and treatment technology available (As many types as applicable, use additional pages if necessary).

1.
 - a. Control Device:
 - b. Operating Principles:
 - c. Efficiency:¹
 - d. Capital Cost:
 - e. Useful Life:
 - f. Operating Cost:
 - g. Energy:²
 - h. Maintenance Cost:
 - i. Availability of construction materials and process chemicals:
 - j. Applicability to manufacturing processes:
 - k. Ability to construct with control device, install in available space, and operate within proposed levels:

2.
 - a. Control Device:
 - b. Operating Principles:
 - c. Efficiency:¹
 - d. Capital Cost:
 - e. Useful Life:
 - f. Operating Cost:
 - g. Energy:²
 - h. Maintenance Cost:
 - i. Availability of construction materials and process chemicals:

¹Explain method of determining efficiency.

²Energy to be reported in units of electrical power - KWH design rate.

j. Applicability to manufacturing processes:

k. Ability to construct with control device, install in available space, and operate within proposed levels:

3.

a. Control Device:

b. Operating Principles:

c. Efficiency:¹

d. Capital Cost:

e. Useful Life:

f. Operating Cost:

g. Energy:²

h. Maintenance Cost:

i. Availability of construction materials and process chemicals:

j. Applicability to manufacturing processes:

k. Ability to construct with control device, install in available space, and operate within proposed levels:

4.

a. Control Device:

b. Operating Principles:

c. Efficiency:¹

d. Capital Costs:

e. Useful Life:

f. Operating Cost:

g. Energy:²

h. Maintenance Cost:

i. Availability of construction materials and process chemicals:

j. Applicability to manufacturing processes:

k. Ability to construct with control device, install in available space, and operate within proposed levels:

F. Describe the control technology selected:

1. Control Device:

2. Efficiency:¹

3. Capital Cost:

4. Useful Life:

5. Operating Cost:

6. Energy:²

7. Maintenance Cost:

8. Manufacturer:

9. Other locations where employed on similar processes;

a. (1) Company:

(2) Mailing Address:

(3) City:

(4) State:

¹Explain method of determining efficiency.

²Energy to be reported in units of electrical power - KWH design rate.

(5) Environmental Manager:

(6) Telephone No.:

(7) Emissions:¹

Contaminant

Rate or Concentration

(8) Process Rate:¹

b. (1) Company:

(2) Mailing Address:

(3) City:

(4) State:

(5) Environmental Manager:

(6) Telephone No.:

(7) Emissions:¹

Contaminant

Rate or Concentration

(8) Process Rate:¹

10. Reason for selection and description of systems:

¹Applicant must provide this information when available. Should this information not be available, applicant must state the reason(s) why.

SECTION VII - PREVENTION OF SIGNIFICANT DETERIORATION DOES NOT APPLY

A. Company Monitored Data

1. _____ no. sites _____ TSP _____ () SO₂* _____ Wind spd/dir

Period of Monitoring _____ / _____ / _____ to _____ / _____ / _____
month day year month day year

Other data recorded _____

Attach all data or statistical summaries to this application.

*Specify bubbler (B) or continuous (C).

2. Instrumentation, Field and Laboratory

- a. Was instrumentation EPA referenced or its equivalent? [] Yes [] No
- b. Was instrumentation calibrated in accordance with Department procedures?
[] Yes [] No [] Unknown

B. Meteorological Data Used for Air Quality Modeling

1. _____ Year(s) of data from _____ / _____ / _____ to _____ / _____ / _____
month day year month day year
2. Surface data obtained from (location) _____
3. Upper air (mixing height) data obtained from (location) _____
4. Stability wind rose (STAR) data obtained from (location) _____

C. Computer Models Used

1. _____ Modified? If yes, attach description.
2. _____ Modified? If yes, attach description.
3. _____ Modified? If yes, attach description.
4. _____ Modified? If yes, attach description.

Attach copies of all final model runs showing input data, receptor locations, and principle output tables.

D. Applicants Maximum Allowable Emission Data

| Pollutant | Emission Rate |
|-----------------|-----------------|
| TSP | _____ grams/sec |
| SO ₂ | _____ grams/sec |

E. Emission Data Used in Modeling

Attach list of emission sources. Emission data required is source name, description of point source (on NEDS point number), UTM coordinates, stack data, allowable emissions, and normal operating time.

F. Attach all other information supportive to the PSD review.

G. Discuss the social and economic impact of the selected technology versus other applicable technologies (i.e., jobs, payroll, production, taxes, energy, etc.). Include assessment of the environmental impact of the sources.

H. Attach scientific, engineering, and technical material, reports, publications, journals, and other competent relevant information describing the theory and application of the requested best available control technology.

ATTACHMENT I

SECTION V: SUPPLEMENTAL REQUIREMENTS

1. Not required.
2. See Attachment II.
3. Attached see Exhibit "A", Part 1 - excerpt from Cal-OSHA study indicating the emission factor for styrene from resins is 6%, Part 2 - Product data sheets.
4. Dust collector not vented to atmosphere.
5. Dust Collector not vented efficiency = 100%
6. See Exhibit "B".
7. See Exhibit "C".
8. See Exhibit "D".
9. \$750 permit fee.
10. Not required.

UTILIZATION RATE:RESIN

$$\frac{1,240,000 \text{ lbs/year}}{48 \frac{\text{wks}}{\text{yr}} \times 5 \frac{\text{days}}{\text{wk}} \times 16 \frac{\text{hrs}}{\text{day}}} = 323 \text{ lbs/hr.}$$

GELCOAT

$$\frac{190,000 \text{ lbs/year}}{48 \frac{\text{wks}}{\text{yr}} \times 5 \frac{\text{days}}{\text{wk}} \times 16 \frac{\text{hrs}}{\text{day}}} = 49.5 \text{ lbs/hr.}$$

MEKP-9

$$\frac{18,000 \text{ lbs/year}}{48 \frac{\text{wks}}{\text{yr}} \times 5 \frac{\text{days}}{\text{wk}} \times 16 \frac{\text{hrs}}{\text{day}}} = 4.7 \text{ lbs/hr.}$$

GLUE (Adhesive)

$$\frac{13,410 \text{ lbs/yr.}}{48 \frac{\text{wks}}{\text{yr}} \times 5 \frac{\text{days}}{\text{wk}} \times 16 \frac{\text{hrs}}{\text{day}}} = 3.5 \text{ lbs/hr.}$$

ACETONE

$$\frac{48,000 \text{ lbs/yr.}}{48 \frac{\text{wks}}{\text{yr}} \times 5 \frac{\text{days}}{\text{wk}} \times 16 \frac{\text{hrs}}{\text{day}}} = 12.5 \text{ lbs/hr.}$$

BOTTOM PAINT

$$\frac{45,000 \text{ lbs/yr.}}{48 \frac{\text{wks}}{\text{yr}} \times 5 \frac{\text{days}}{\text{wk}} \times 16 \frac{\text{hrs}}{\text{day}}} = 11.7 \text{ lbs/hr.}$$

EMISSIONS:

Styrene

(emissions rate)(utilization rate) = emissions

$(0.08)(323 \text{ lbs/hr}) + (0.08)(49.5) = 29.80 \frac{\text{lbs}}{\text{yr}}$
resin ↑ solvent ↑

Methyl Methacrylate

$(0.08)(49.5 \frac{\text{lbs}}{\text{yr}}) = 3.96 \frac{\text{lbs}}{\text{yr}}$

MEKP

$(0.10)(4.7 \frac{\text{lb}}{\text{hr}}) = 0.47 \frac{\text{lbs}}{\text{yr}}$
↑ ESTIMATED

1,1,1-Trichloroethane

$(0.66)(3.5 \frac{\text{lbs}}{\text{yr}}) = 2.31 \frac{\text{lbs}}{\text{yr}}$ *

Acetone

$(0.50)(12.5 \frac{\text{lbs}}{\text{yr}}) = 6.25 \frac{\text{lbs}}{\text{yr}}$

Bottom Paint *MISC

$(0.60)(11.7 \frac{\text{lbs}}{\text{yr}}) = 7.02 \frac{\text{lbs}}{\text{yr}}$

* REPORTING NOT REQUIRED

Occupational Exposures to Styrene and Other Health Hazards in the Fiberglass Reinforced Plastics Industry

A Special Studies Report by 

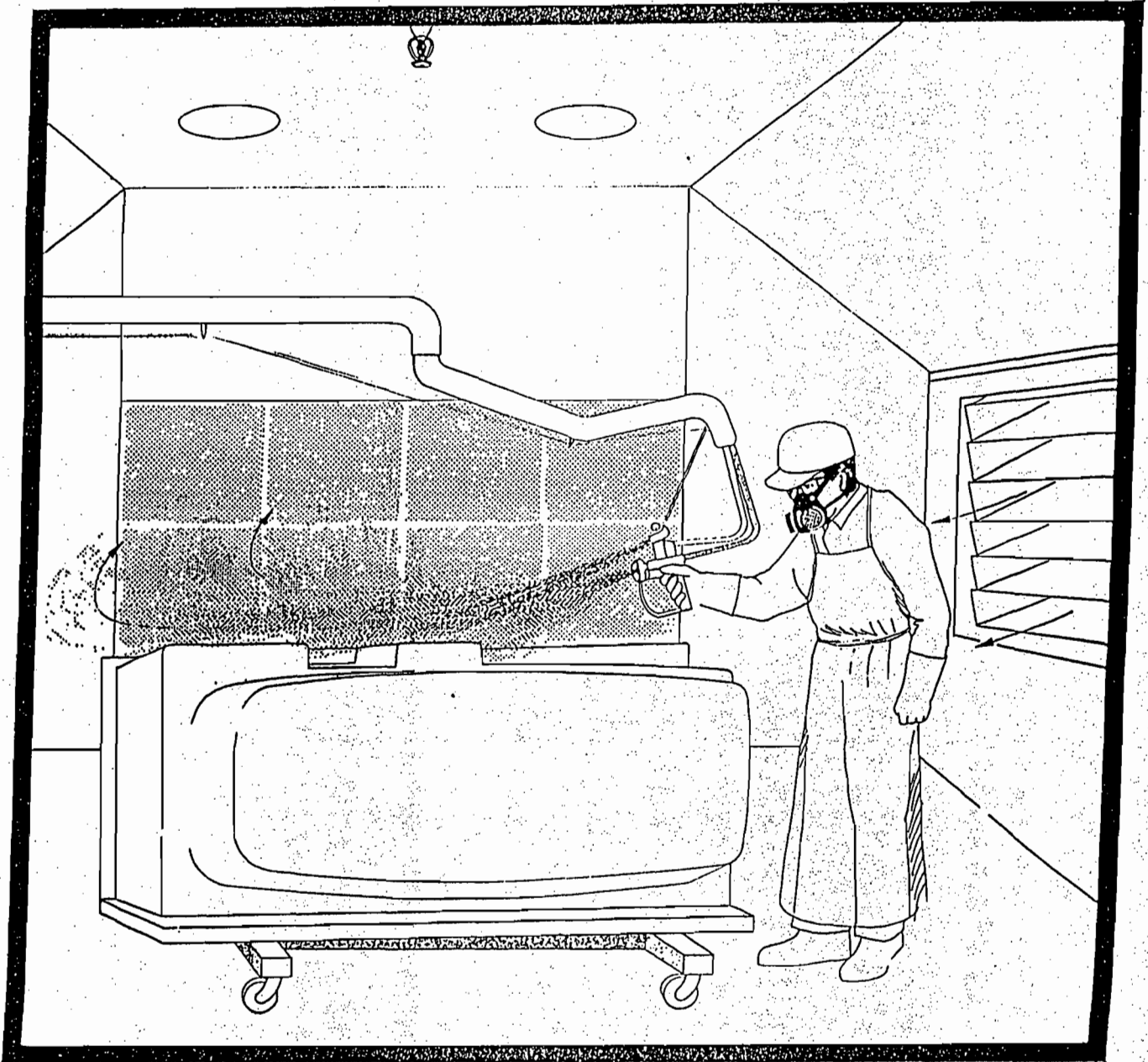

Department of Industrial Relations 

State of California
George Deukmejian, Governor
Ron Rinaldi, Director of Industrial Relations

worker performed almost continuous spraying while standing on a portable platform that was inserted into the tank that also supported a large duct with high velocity airflow that exhausted vapors very close to the point of generation.

Two facilities, using a unique production process to ensure good secondary bonding between resin layers, also had the side effect of obtaining low ambient exposure levels from the process. After gelcoating and hand laminating the mold, the part was covered with plastic sheeting and a vacuum pulled while the part is curing. Covering the part and pulling a vacuum through the space between the part and the plastic, removes styrene vapor from the work place air and reduces employee exposure.

The majority of companies which installed some form of dilution ventilation, for example, filter banks on the walls that pull a large volume of air, were mostly ineffective. They were either too far from the source of the exposure or were defeated by lack of directionality and turbulence.

Substitution

NIOSH estimates that approximately 6% of styrene monomer in a 40/60 polyester resin mixture vaporizes during the curing process. Methyl styrene (also called vinyl toluene) is a close chemical cousin of styrene that has a lower vapor pressure, reducing the amount of vaporization. Methyl styrene has three isomers, para, meta, or the ortho form. Two production facilities were using a resin mixture containing 60% polyester, 14% styrene and 26% para-methyl styrene.

FIGURE V.3

Styrene and the Three Isomers of Methyl Styrene

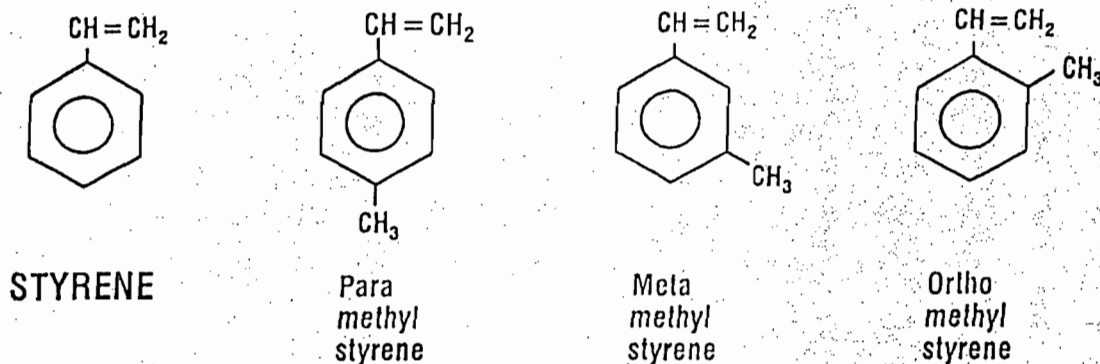

EXHIBIT "A"
PART 2

Material Safety Data Sheet

| | | | |
|---|--|-------------------------|----------------|
| Manufacturer's Name | Alpha Resins Corporation | Emergency Telephone No. | (813) 858-4431 |
| Address | 4620 N. Galloway Road Lakeland, Florida 33805 | Other Information Calls | (813) 858-4431 |
| Signature of Person Responsible for Preparation | Pete Peterson | Date Prepared | Dec. 31, 1987 |

SECTION 1 - IDENTITY

| | | | |
|--|-----------------------------|-----------------|--------------------------|
| Common Name: (used on label) (Trade Name & Synonym) | 80-530 | Cas No. | Mixture |
| Chemical Name | Unsaturated Polyester Resin | Chemical Family | Diacid/Glycol Condensate |
| Formula | Mixture | | |

SECTION 2 - HAZARDOUS INGREDIENTS

| Principal Hazardous Component (chemical & common names) | % | OSHA PEL |
|---|----|----------|
| STYRENE (100-42-5) | 39 | 100ppm |

SECTION 3 - PHYSICAL & CHEMICAL CHARACTERISTICS (Fire & Explosion Data)

| | | | | | |
|--------------------------------|-------------|---------------------------------------|-----------|-----------------------------|-------|
| Boiling Point | 293°F | Specific Gravity (H ₂ O=1) | 1.0 - 1.1 | Vapor Pressure (mm Hg) | < 4.5 |
| Percent Volatile by Volume (%) | 39 | Vapor Density (Air = 1) | 3.6 | Evaporation Rate (Bu Act=1) | 3.1 |
| Solubility in Water | Very slight | Reactivity in Water | None | | |

Appearance and Odor: Viscous liquid with sweet pungent odor.

| | | | | | | |
|-------------|-------------------------------------|-------|-------|--------------------|---|---------------------------|
| Flash Point | Flammable Limits in Air % by Volume | Lower | Upper | Extinguisher Media | Water fog, foam Dry chem., CO ₂ | Auto-ignition Temperature |
| | | 1.1 | 6.1 | | | |

Special Fire Fighting Procedures: If electrical equipment is involved, the use of foam should be avoided. Handling equipment should be cooled by water stream if exposed to fire.

Unusual Fire and Explosion Hazards: At elevated temperatures, such as in a fire condition, polymerization may take place resulting in violent rupture of closed containers. Wear positive pressure apparatus, eye protection, and keep vapors away from possible ignition sources.

SECTION 4 - PHYSICAL HAZARDS

Stability: Unstable Conditions: Sunlight, open flames, contamination, and prolonged storage above 75° F. Stable to Avoid

Incompatibility (Materials to Avoid): Acids, oxidizing agents, free radical initiators such as peroxides, and metallic halides and soaps.

Hazardous Decomposition Products: Carbon monoxide, carbon dioxide and low molecular weight hydrocarbons.

Hazardous Polymerization: Will Not Occur May Occur Conditions to Avoid: Open flames, contamination and prolonged exposure to sunlight or temperatures greater than 75° F.

SECTION 5 - HEALTH HAZARDS

1. **Signs and Symptoms of Exposure** I. Acute
 Overexposure May irritate eyes, nose, throat, and skin.

2. **Chronic**
 Overexposure May feel drugged, become sleepy, or unconscious. Repeated skin contact may cause rash.

Medical Conditions Generally Approved by Exposure Pre-existing respiratory and skin disorders

Chemical Listed as Carcinogen or Potential Carcinogen National Toxicology Program Yes No I.A.R.C. Monographs Yes No OSHA Yes No

OSHA Permissible Exposure Limit 100ppm ACGIH Threshold Limit Value 50ppm Other Exposure Limit Used STEL=100ppm

Emergency and First Aid Procedures PRIMARY ROUTES OF ENTRY

I. Inhalation Move exposed person(s) to fresh air. Get medical attention.

2. **Eyes** Contact lens should not be worn while working with this material. Immediately flush with plenty of water for at least 15 minutes. Get prompt medical attention.

3. **Skin** Wash exposed skin with soap and water. Get medical attention if irritation develops. Remove contaminated clothing, shoes, and thoroughly clean before reuse.

4. **Ingestion** DO NOT induce vomiting. Call physician immediately.

SECTION 6 - SPECIAL PROTECTION INFORMATION

Respiratory Protection (Specify Type) Chemical cartridge respirator with NIOSH/OSHA approved organic vapor cartridge to 400ppm. Above 400ppm SCBA.

Ventilation Local Exhaust Preferred Mechanical (General) Acceptable Special Explosion proof Other N/A

Protective Gloves Rubber or other resistant material Eye Protection Chemical goggles

Other Protective Clothing or Equipment Chemical resistant aprons or coats to avoid skin contact.

SECTION 7 - SPECIAL PRECAUTIONS AND SPILL/LEAK PROCEDURES

Precautions to be Taken in Handling and Storage Store in an area below 75° F and out of direct sunlight. Keep from heat, spark, and smoking areas. Empty containers may be hazardous.

Other Precautions Do not transfer to bottles or unlabeled containers. Equipment should be grounded during transfer with non-sparking pumps used.

Steps to be Taken in Case Material is Released or Spilled Remove all sources of ignition. Ventilate area. Prevent material from entering drains. Absorbent should be vermiculite, dry sand or earth.

Waste Disposal Methods Small spill - Soak up with absorbent and scoop into drums.
 Large spill - Dike and pump into drums. Dispose of in accordance with local state and federal regulations.

IMPORTANT

Do not leave any blank spaces. If required information is unavailable, unknown, or does not apply, so indicate.

THE ALPHA CORPORATION HAS MADE EVERY EFFORT TO ENSURE THE ACCURACY OF THE FOREGOING INFORMATION. NO WARRANTIES OF ACCURACY ARE MADE, HOWEVER, AS TO CHEMICAL OR PHYSICAL CHANGES THAT MAY OCCUR IN THE TRANSPORTATION, STORAGE OR USE OF THIS MATERIAL AFTER IT LEAVES ALPHA'S CONTROL.

any
2000/1981

MATERIAL SAFETY DATA SHEET

SECTION I - MANUFACTURERS INFORMATION

PRODUCT CODE IDENTITY: 944WA62 330 PRODUCT NAME: WHITE *Gel Coat*
 NAME : COOK PAINT AND VARNISH COMPANY DATE OF MSDS: 01/15/88
 ADDRESS: P.O. BOX 419389
 KANSAS CITY, MO 64141-6389 EMERGENCY TELEPHONE: 816-391-6000
 INFORMATION TELEPHONE: 816-391-6003

ATTN: SAFETY AND HEALTH OFFICER
 SEA RAY BOATS-KNX
 2601 SEA RAY BLVD
 KNOXVILLE TN 37914

CUSTOMER NUMBER: 285455
 DATE PRINTED: 04/25/88

SECTION II - HAZARDOUS INGREDIENTS

TYRENE MONOMER

CAS #: 100-42-5 PERCENT: 35.000 VAPOR PRESSURE: 4.5
 (MMHG/DEG F)
 EXPOSURE LIMIT:
 ACGIH TLV/TWA: 50 PPM (SKIN) (215 MG/CU.M.)
 ACGIH TLV/STEL: 100 PPM (SKIN) (425 MG/CU.M.)
 OSHA PEL: 100 PPM (425 MG/CU.M.)
 OSHA PEL/CEILING: 200 PPM (850 MG/CU.M.)
 OTHER: OSHA: 600 PPM/5 MIN/3 HR PEAK

TITANIUM DIOXIDE
SEE ACGIH TLV BOOKLET, APPENDIX D

CAS #: 13463-67-7 PERCENT: 15.000 VAPOR PRESSURE: N/A
 (MMHG/DEG F)
 EXPOSURE LIMIT:
 ACGIH TLV/TWA: 10MG/CU.M. AS DUST, 5MG/CU.M. AS FUMES
 OSHA PEL: 15MG/CU.M.

SILICA, AMORPHOUS

CAS #: 7631-86-9 PERCENT: LESS THAN 5 VAPOR PRESSURE: N/A
 (MMHG/DEG F)
 EXPOSURE LIMIT:
 ACGIH TLV/TWA: 10MG/CU.M. TOTAL DUST
 OSHA PEL: 20M PPCF AS DUST

ALC (HYDROUS MAGNESIUM SILICATE)

CAS #: 14807-96-6 PERCENT: 10.000 VAPOR PRESSURE: N/A
 (MMHG/DEG F)
 EXPOSURE LIMIT:
 ACGIH TLV/TWA: 2 MG/M3 RESPIRABLE DUST
 OSHA PEL: 20 M PPCF

ETHYL METHACRYLATE

CAS #: 80-62-6 PERCENT: 5.000 VAPOR PRESSURE: 29.0
 (MMHG/DEG F)
 EXPOSURE LIMIT:
 ACGIH TLV/TWA: 100 PPM (410 MG/CU.M.)
 ACGIH TLV/STEL: 125 PPM (510 MG/CU.M.)
 OSHA PEL: 100 PPM (410 MG/CU.M.)

MAXIMUM VOC NOT CONSUMED DURING CURING IS 40 GRAM/LITER (OR 230 GRAMS/SQUARE METER OF SURFACE AREA OPEN TO AIR). MAXIMUM VOC OF UNCATALYZED RESINS AND GEL COATS IS 600 GRAMS/LITER.

*Replaces
 Bond &
 Oxyter
 (1988)*

MATERIAL SAFETY DATA SHEET

PRODUCT CODE IDENTITY: 944WA62 330 PRODUCT NAME: WHITE

SECTION III - HEALTH HAZARD DATA

EFFECTS OF OVEREXPOSURE TO PRODUCT. PRIMARY ROUTES OF ENTRY ARE:

EYE CONTACT: IRRITATION. SYMPTOMS ARE TEARING, REDNESS AND DISCOMFORT.

SKIN CONTACT: IRRITATION. CAN CAUSE DEFATTING OF SKIN WHICH MAY LEAD TO DERMATITIS.

INHALATION: IRRITATION TO NOSE AND THROAT. EXTENDED OR REPEATED EXPOSURE TO CONCENTRATIONS ABOVE THE RECOMMENDED EXPOSURE LIMITS MAY CAUSE BRAIN OR NERVOUS SYSTEM DEPRESSION, CAUSING DIZZINESS, HEADACHE OR NAUSEA AND IF CONTINUED INDEFINITELY, LOSS OF CONSCIOUSNESS, LIVER AND KIDNEY DAMAGE.

REPORTS HAVE ASSOCIATED REPEATED OR PROLONGED OCCUPATIONAL OVEREXPOSURE TO SOLVENTS WITH PERMANENT BRAIN AND NERVOUS SYSTEM DAMAGE.

INGESTION: MAY CAUSE MOUTH, THROAT, ESOPHAGUS AND STOMACH IRRITATION, NAUSEA, VOMITING AND DIARRHEA.

MEDICAL CONDITIONS THAT MAY BE AGGRAVATED BY EXPOSURE TO THIS PRODUCT: PREEXISTING EYE, SKIN, LIVER, KIDNEY AND RESPIRATORY DISORDERS.

EMERGENCY AND FIRST AID PROCEDURES:

IN CASE OF EYE CONTACT, FLUSH IMMEDIATELY WITH PLENTY OF WATER FOR AT LEAST 15 MINUTES AND GET MEDICAL ATTENTION; FOR SKIN, WASH THOROUGHLY WITH SOAP AND WATER. IF AFFECTED BY INHALATION OF VAPORS OR SPRAY MIST, REMOVE TO FRESH AIR. IF SWALLOWED, GET MEDICAL ATTENTION IMMEDIATELY.

SECTION IV - PHYSICAL DATA

BOILING POINT, DEG. F. 212

VAPOR DENSITY IS HEAVIER THAN AIR

WEIGHT PER GALLON: 10.76

EVAPORATION RATE IS SLOWER THAN ETHER

PERCENT VOLATILE BY VOLUME: 53.826

SECTION V - FIRE AND EXPLOSION HAZARD DATA

SHA FLAMMABILITY CLASSIFICATION: FLAMMABLE LIQUID CLASS IC

FLASH POINT SETA CLOSED CUP, DEG F: 82

DOT HAZARD CLASS: RED-LABEL, FLAMMABLE LIQUID

LEL: 1.10

EXTINGUISHING MEDIA: FOAM, CARBON DIOXIDE, DRY CHEMICAL, WATER FOG.

UNUSUAL FIRE AND EXPLOSION HAZARDS:

IF POLYMERIZATION TAKES PLACE IN A CONTAINER, THERE IS POSSIBILITY OF VIOLENT RUPTURE OF THE CONTAINER. STYRENE VAPORS ARE UNINHIBITED AND MAY FORM POLYMERS IN VENTS OR FLAME ARRESTORS OF STORAGE TANKS RESULTING IN STOPPAGE OF VENTS. VAPORS MAY CAUSE FLASH FIRE. KEEP CONTAINERS TIGHTLY CLOSED AND ISOLATE FROM HEAT, ELECTRICAL EQUIPMENT, SPARKS AND FLAME. NEVER USE WELDING OR CUTTING TORCH ON OR NEAR DRUM (EVEN EMPTY) BECAUSE PRODUCT (EVEN JUST RESIDUE) CAN IGNITE EXPLOSIVELY.

SPECIAL FIRE FIGHTING PROCEDURES:

FULL PROTECTIVE EQUIPMENT INCLUDING SELF-CONTAINED BREATHING APPARATUS SHOULD BE USED. WATER SPRAY MAY BE INEFFECTIVE. IF WATER IS USED, FOG NOZZLES ARE PREFERABLE. WATER MAY BE USED TO COOL CLOSED CONTAINERS TO PREVENT PRESSURE BUILD-UP AND POSSIBLE AUTO-IGNITION OR EXPLOSION WHEN EXPOSED TO EXTREME HEAT

PRODUCT CODE IDENTITY: 944WA62 330 PRODUCT NAME: WHITE

SECTION VI - REACTIVITY DATA

STABILITY: STABLE HAZARDOUS POLYMERIZATION: MAY OCCUR.

CONDITIONS TO AVOID:

ELEVATED TEMPERATURES. IMPROPER ADDITION OF PROMOTER AND/OR CATALYST. AVOID DIRECT CONTACT OF MEKP CATALYST WITH ACCELERATOR. IF AN ACCELERATOR SUCH AS COBALT DRIER IS TO BE ADDED, MIX THIS ACCELERATOR WITH BASE MATERIAL BEFORE ADDING CATALYST.

INCOMPATIBILITY (MATERIALS TO AVOID):

OXIDIZERS, PEROXIDES, STRONG ACIDS, ALUMINUM CHLORIDE AND VINYL POLYMERS.

HAZARDOUS DECOMPOSITION PRODUCTS:

THERMAL DECOMPOSITION OR COMBUSTION CAN PRODUCE FUMES CONTAINING ORGANIC ACIDS, CARBON DIOXIDE AND CARBON MONOXIDE.

SECTION VII - SPILL OR LEAK PROCEDURES

STEPS TO BE TAKEN IN CASE MATERIAL IS RELEASED OR SPILLED:

REMOVE ALL SOURCES OF IGNITION (FLAMES, HOT SURFACES, AND ELECTRICAL, STATIC, OR FRICTIONAL SPARKS). AVOID BREATHING VAPORS. VENTILATE AREA. CONTAIN AND REMOVE WITH INERT ABSORBENT AND NON-SPARKING TOOLS.

WASTE DISPOSAL METHOD:

DISPOSE OF IN ACCORDANCE WITH LOCAL, STATE AND FEDERAL REGULATIONS. DO NOT INCINERATE CLOSED CONTAINERS. INCINERATE IN APPROVED FACILITY.

SECTION VIII - SPECIAL PROTECTION INFORMATION

RESPIRATORY PROTECTION:

DO NOT BREATHE OR INGEST VAPORS, SPRAY MIST OR DUST WHILE APPLYING, SANDING, GRINDING, OR SAWING CURED PRODUCT. WEAR AN APPROPRIATE, (NIOSH/MSHA APPROVED) PROPERLY FITTED RESPIRATOR DURING APPLICATION AND OTHER USE OF THIS PRODUCT UNTIL ALL VAPORS, MISTS, AND DUSTS ARE EXHAUSTED, UNLESS AIR MONITORING DEMONSTRATES VAPOR AND MIST AND DUST LEVELS ARE BELOW APPLICABLE LIMITS. FOLLOW RESPIRATOR MANUFACTURER'S DIRECTIONS FOR RESPIRATOR USE. OBSERVE OSHA STANDARD 29CFR 1910.134.

VENTILATION:

PROVIDE GENERAL CLEAN AIR DILUTION OR LOCAL EXHAUST VENTILATION IN VOLUME AND PATTERN TO KEEP THE AIR CONTAMINANT CONCENTRATION BELOW THE LOWER EXPLOSION LIMIT AND BELOW CURRENT APPLICABLE EXPOSURE LIMITS IN THE MIXING, APPLICATION AND CURING AREAS; AND TO REMOVE DECOMPOSITION PRODUCT DURING WELDING AND FLAME CUTTING ON SURFACES COATED WITH THIS PRODUCT. IN CONFINED AREAS, USE ONLY WITH FORCED VENTILATION ADEQUATE TO KEEP VAPOR CONCENTRATION BELOW 20% OF LOWER EXPLOSION LIMITS. REFER TO OSHA STANDARDS 29CFR 1910.94, 1910.107, 1910.108.

NOTE: HEAVY SOLVENT VAPORS SHOULD BE REMOVED FROM LOWER LEVELS OF THE WORK AREA AND ALL IGNITION SOURCES (NONEXPLOSION-PROOF MOTORS, ETC.) SHOULD BE ELIMINATED.

PROTECTIVE GLOVES: USE SOLVENT IMPERMEABLE GLOVES TO AVOID CONTACT WITH PRODUCT

EYE PROTECTION:

DO NOT GET IN EYES. USE SAFETY EYEWEAR WITH SPLASH GUARDS OR SIDE SHIELDS, CHEMICAL GOGGLES, FACE SHIELDS.

OTHER PROTECTIVE EQUIPMENT:

AVOID CONTACT WITH SKIN. USE PROTECTIVE CLOTHING. PREVENT CONTACT WITH CONTAMINATED CLOTHING. WASH CONTAMINATED CLOTHING, INCLUDING SHOES, BEFORE REUSE.

SECTION IX - SPECIAL PRECAUTIONS

PRECAUTIONS TO BE TAKEN IN HANDLING AND STORING:

DO NOT STORE ABOVE 120 DEG. F. STORE LARGE QUANTITIES IN BUILDINGS DESIGNED

PRODUCT CODE IDENTITY: 944WA62 330 PRODUCT NAME: WHITE

TO COMPLY WITH OSHA 1910.106. KEEP AWAY FROM HEAT, SPARKS AND FLAME. KEEP CONTAINERS CLOSED WHEN NOT IN USE AND UPRIGHT TO PREVENT LEAKAGE.

OTHER PRECAUTIONS:

CONTAINERS SHOULD BE GROUNDED WHEN POURING. DO NOT TAKE INTERNALLY. WASH HANDS AFTER USING AND BEFORE SMOKING OR EATING. EMPTIED CONTAINERS MAY RETAIN HAZARDOUS RESIDUE AND EXPLOSIVE VAPORS. KEEP AWAY FROM HEAT, SPARKS AND FLAMES. DO NOT CUT, PUNCTURE OR WELD ON OR NEAR EMPTIED CONTAINERS. FOLLOW ALL HAZARD PRECAUTIONS GIVEN IN THIS DATA SHEET UNTIL CONTAINER IS THOROUGHLY CLEANED OR DESTROYED. IF THIS PRODUCT IS BLENDED WITH OTHER COMPONENTS SUCH AS THINNERS, CONVERTER, COLORANTS AND CATALYSTS PRIOR TO USE, READ ALL WARNING LABELS. ANY MIXTURE OF COMPONENTS WILL HAVE HAZARDS OF ALL COMPONENTS. FOLLOW ALL PRECAUTIONS. IF SPRAYING THIS MATERIAL, KEEP SPRAY BOOTHS CLEAN. AVOID BUILDUP OF SPRAY DUST OR OVERSPRAY IN BOOTHS OR DUCTS.

KEEP OUT OF REACH OF CHILDREN

FOR INDUSTRIAL USE ONLY

DISCLAIMER AND LIMITATION OF LIABILITY

TO THE BEST OF OUR KNOWLEDGE, THE INFORMATION CONTAINED HEREIN IS ACCURATE. TO THE EXTENT ALLOWED BY LAW, THIS STATEMENT IS MADE IN LIEU OF ANY OTHER WARRANTIES, EXPRESSED OR IMPLIED, INCLUDING BUT NOT LIMITED TO ANY IMPLIED WARRANTY OF MERCHANTABILITY OR FITNESS FOR A PARTICULAR PURPOSE, AND IS IN LIEU OF ANY OTHER OBLIGATIONS OR LIABILITY ON THE PART OF COOK PAINT AND VARNISH COMPANY.

COOK PAINT AND VARNISH COMPANY WILL NOT BE LIABLE FOR ANY INCIDENTAL OR CONSEQUENTIAL DAMAGES. FINAL DETERMINATION OF THE SUITABILITY OF THE MATERIAL FOR THE USE CONTEMPLATED, THE MANNER OF USE, AND WHETHER THE SUGGESTED USE INFRINGES ANY PATENT IS THE SOLE RESPONSIBILITY OF THE BUYER.

MATERIAL SAFETY DATA SHEET

REB 09 1988

SECTION I

MANUFACTURER THE NORAC COMPANY, INC. EMERGENCY TELEPHONE 818-334-2908
 ADDRESS 405 S. MOTOR AVENUE, AZUSA, CA 91702 CHEMTREC 1-800-424-9300
 PRODUCT NAME NOROX MEKP-9 CAS NO. 1338-23-4
 CHEMICAL NAME METHYL ETHYL KETONE PEROXIDE (MEKP)
 CHEMICAL FAMILY ORGANIC PEROXIDE FORMULA MIXTURE OF MANY

SECTION II - HAZARDOUS INGREDIENTS

| COMPONENTS | % | HAZARD DATA |
|-------------------------------|----|---------------------------|
| METHYL ETHYL KETONE PEROXIDES | 34 | ORAL--RAT LD50:484 mg/kg |
| DIMETHYL PHTHALATE | 58 | ORAL--RAT LD50:6900 mg/kg |
| 2 ETHYL HEXYL ACETATE | 7 | ORAL--RAT LD50:3000 mg/kg |
| HYDROGEN PEROXIDE | 1 | SKIN--RAT LD50:4060 mg/kg |

SECTION III - PHYSICAL DATA

BOILING POINT °F UNKNOWN SPECIFIC GRAVITY (Water =1) 1.1
 VAPOR PRESSURE mm Hg. UNKNOWN PERCENT VOLATILE BY VOLUME UNKNOWN
 VAPOR DENSITY (Air =1) >1 EVAPORATION RATE UNKNOWN
 APPEARANCE AND ODOR WATER WHITE LIQUID, SLIGHT ODOR *Note! 0.2% Red Dye may be added for color*

SECTION IV - HEALTH HAZARD DATA

THRESHOLD LIMIT VALUE 1.5 mg/m³ FOR METHYL ETHYL KETONE PEROXIDES
 EFFECTS OF EXPOSURE PROLONGED INHALATION OF VAPORS MAY CAUSE MUCOUS MEMBRANE IRRITATION AND VERTIGO.

EMERGENCY INFO: MEKP IS A STRONG IRRITANT. AVOID SWALLOWING AND ALL CONTACT WITH EYES AND SKIN. WASH CONTAMINATED AREAS THOROUGHLY WITH SOAP AND WATER. FOR EYES, IRRIGATE IMMEDIATELY FOR 30 MINUTES--CALL A PHYSICIAN. IF SWALLOWED, TAKE LARGE QUANTITIES OF MILK OR WATER AND IMMEDIATELY CALL A PHYSICIAN. FOR AID TO PHYSICIAN, SUGGEST POISON CONTROL CENTER (213) 484-5151. DAY OR NIGHT.

SECTION V - REACTIVITY DATA

INCOMPATIBILITY (Materials to avoid) DIMETHYLANILINE, COBALT NAPHTHENATE & OTHER PROMOTERS, ACCELERATORS, REDUCING AGENTS, OR ANY HOT MATERIAL

STABILITY STABLE WHEN KEPT IN ORIGINAL, CLOSED CONTAINER, OUT OF DIRECT SUNLIGHT AT TEMPERATURES BELOW 80°F.

HAZARDOUS DECOMPOSITION PRODUCTS UNKNOWN

HAZARDOUS POLYMERIZATION WILL NOT OCCUR

SECTION VI - SPECIAL PROTECTION INFORMATION

RESPIRATORY PROTECTION NONE

VENTILATION MECHANICAL, GENERAL

EYE PROTECTION SAFETY GOGGLES RECOMMENDED

GLOVES PROTECTIVE GLOVES RECOMMENDED (SOLVENT RESISTANT)

OTHER NONE

SECTION VII - FIRE AND EXPLOSION DATA

FLASH POINT (Method used) >200°F (C.O.C) FLAMMABLE LIMITS: UNKNOWN

EXTINGUISHING MEDIA WATER FROM A SAFE DISTANCE--PREFERABLY WITH A FOG NOZZLE. IN CASE OF VERY SMALL FIRES, OTHER MEANS SUCH AS CARBON DIOXIDE, FOAM OR DRY CHEMICAL EXTINGUISHERS MAY BE EFFECTIVE. DRY CHEMICAL COMBINED WITH MEKP MAY REIGNITE. LIGHT WATER ADDITIVES MAY BE PARTICULARLY EFFECTIVE AT EXTINGUISHING MEKP FIRES. IF DRY CHEMICAL IS USED TO EXTINGUISH AN MEKP FIRE, THE EXTINGUISHED AREA MUST BE THOROUGHLY WET WITH WATER TO PREVENT REIGNITION.

SPECIAL FIRE FIGHTING PROCEDURES

UNUSUAL FIRE AND EXPLOSION HAZARDS THE HEAT OF DECOMPOSITION OF THE PEROXIDES ADD TO THE HEAT OF THE FIRE. DRY CHEMICAL FIRE EXTINGUISHING AGENT MAY CATALYZE THE DECOMPOSITION.

SECTION VIII - SPILL OR LEAK PROCEDURES

STEPS TO BE TAKEN IN EVENT OF SPILL OR RELEASE DIKE TO PREVENT RUNOFF FROM ENTERING DRAINS, SEWERS, STREAMS, ETC. AND TRANSFER INTO CONTAINER. SPILLED MATERIAL SHOULD BE SWEEPED UP WITH AN INERT, MOIST, DILUENT SUCH AS PERLITE, VERMICULITE, OR SAND, AND PLACED IN A CLEAN POLYETHYLENE LINED DRUM OR POLYETHYLENE DRUM.

WASTE DISPOSAL METHOD IMMEDIATELY DISPOSE OF WASTE MATERIAL IN ACCORDANCE WITH FEDERAL, STATE AND LOCAL REGULATIONS.

SECTION IX - SPECIAL PRECAUTIONS

PRECAUTIONS TO BE TAKEN IN HANDLING AND STORING MEKP SHOULD NEVER BE ADDED TO HOT SOLVENTS OR MONOMERS AS VIOLENT DECOMPOSITION AND/OR REACTION MAY RESULT. WHEN USING SPRAY EQUIPMENT, NEVER SPRAY RAW MEKP ONTO CURING OR INTO RAW RESIN OR FLUES. KEEP MEKP IN ITS ORIGINAL CONTAINER. DO NOT STORE WITH FOOD OR DRINK. DO NOT USE NEAR FOOD OR DRINK.

OTHER PRECAUTIONS



GENERAL ADHESIVES

DATA SHEET

PRODUCT NUMBER: 69 X 3063

DATE: 12-15-87

DESCRIPTION: 69x3063 is a clear adhesive for bonding carpet and foam for marine and RV applications. Good open time and heat resistance.

APPLICATION: Apply 69x3063 either by spray, brush, or roller.

PHYSICAL CHARACTERISTICS:

| | |
|--------------------|-----------------------|
| BASE: | Thermoplastic Rubber |
| COLOR: (DRY): | Straw |
| (WET): | Amber |
| SOLIDS: | 34% +/- 1% |
| VISCOSITY: | 1000 +/- 200 cps |
| WEIGHT PER GALLON: | 10.0 lbs/gal |
| DILUENT: | 1,1,1-Trichloroethane |
| SHELF LIFE: | 6 Months |
| HEAT RESISTANCE: | 200 F. |

66070
by wet.

MANUFACTURER MAKES NO WARRANTY, EXPRESSED OR IMPLIED, OF MERCHANTABILITY OF THE PRODUCT OR FITNESS OF THE PRODUCT FOR A PARTICULAR PURPOSE. Manufacturer shall not be liable to Purchaser or any other person for loss or damage directly, indirectly, or consequentially arising from or related to the use of this product.

The user of this product assumes all risks of use and/or handling, whether or not in accordance with any directions or suggestions of the Manufacturer or Seller.

PURCHASER'S REMEDY IS LIMITED TO THE REPLACEMENT OF PRODUCT.

For industrial or professional use only. If resold or repackaged for any use other than industrial or professional, containers must be labeled in accordance with the Federal Hazardous Substances Labeling Act.

Refer to the material safety data sheet for exact details of hazardous warning information.

6100 Centennial Blvd. • PO Box 24090 • Nashville, TN 37202 • (615) 386-9955

GENERAL ADHESIVES
MATERIAL SAFETY DATA SHEET

70 Volatile
by wt/volume
= 6690

===SECTION I - MANUFACTURER'S INFORMATION===

MANUFACTURER'S NAME AND ADDRESS

GENERAL ADHESIVES
6100 CENTENNIAL BLVD.
NASHVILLE, TN. 37209

EMERGENCY TELEPHONE NUMBERS

WEEKDAYS (615) 350-8555
NIGHTS/WEEKENDS (615) 350-8989
MSDS INFORMATION (615) 350-8555

DATE PREPARED: Revised February 19, 1988

SIGNATURE OF PREPARER: *Lisa Dishmer*

IDENTITY: 69 X 3063

TRADE NAME: Carpet/Foam Adhesive

===SECTION II - HAZARDOUS INGREDIENTS/IDENTITY INFORMATION===

(Specific Chemical Identity; Common Name(s))

| HAZARDOUS COMPONENTS | OSHA PEL | ACGIH TLV | OTHER LIMITS | CAS# |
|---|----------|-----------|--------------|-----------|
| Stoddard Solvent 5-10 ⁹⁰ | 500 ppm | 100 ppm | STEL 200 ppm | 8052-41-3 |
| Methyl Chloroform (1,1,1-Trichloroethane) 50-60 ⁹⁰ | 350 ppm | 350 ppm | STEL 450 ppm | 71-55-6 |
| Diethylene Ether (Skin) * | 100 ppm | 25 ppm | STEL 100 ppm | 123-91-1 |

*The Diethylene Ether is an inhibitor in the 1,1,1-Trichloroethane. This product contains more than 0.1% but less than 3.0% Diethylene Ether. Potential risks to humans can be minimized by observing good work practices and personal hygiene procedures.

5-10 Mineral Spirits, Vorsale

===SECTION III - PHYSICAL CHEMICAL CHARACTERISTICS===

Boiling Point (F): 165-380 F Vapor Pressure: 92 @ 20 C Vapor Density: >1
(mm Hg.) (Air=1)

Specific Gravity: 1.25 Melting Point: N/A Evaporation Rate: 4.9
(Water=1) (Butyl Acetate=1)

Solubility in Water: None.

Appearance and Odor: Natural or red in color; solvent odor.

===SECTION IV - FIRE AND EXPLOSION HAZARD DATA===

Flash Point (F): None Method Used: TCC

Flammable Limits: (LEL) 8.0% (UEL) 10.5%

Extinguishing Media: CO₂, Dry Chemical, Foam, Halon.

Special Fire Fighting Procedures: Self-contained breathing apparatus must be worn.

Unusual Fire and Explosion Hazards: Cool drums with water spray to prevent pressure explosion. Vapors may ignite explosively.

===SECTION V - REACTIVITY DATA===

STABILITY: Stable: XXX Unstable: _____

Incompatibility (Materials to Avoid): Active metals such as Aluminum, Zinc, Magnesium, etc. Strong acids or bases.

Hazardous Decomposition or Byproducts: HCL, Carbon Monoxide, Chlorine and Products of partial decomposition.

Hazardous Polymerization: May Occur: _____ Will Not Occur: XXX

Conditions to Avoid: Contact with active metals such as Aluminum, Zinc, Magnesium, etc., flame, spark or extreme heat.

===SECTION VI - HEALTH HAZARD DATA===

ROUTES OF ENTRYINGESTION:

ACUTE HEALTH HAZARDS: Unlikely route of exposure. Ingesting this product may cause gastrointestinal irritation, nausea, vomiting and diarrhea.

CHRONIC HEALTH HAZARDS: N/E

EMERGENCY AND FIRST AID PROCEDURES: Do not induce vomiting. Keep the affected person warm, quiet and get medical attention. Aspiration of this material into the lungs due to vomiting can cause chemical pneumonitis which can be fatal.

SKIN:

ACUTE HEALTH HAZARDS: May cause skin irritation, jaundice or dermatitis. This product may be absorbed through the skin.

CHRONIC HEALTH HAZARDS: Reproductive abnormalities have been noted in studies animals exposed to high concentrations.

EMERGENCY AND FIRST AID PROCEDURES: If this product comes in contact with the skin, promptly wash the contaminated skin using soap and water or a skin cleanser. If this product soaks through the clothing, remove the clothing promptly and wash the skin with soap and water or a skin cleanser. If irritation persists after washing, get medical attention. not wear contaminated clothing before laundering.

EYES:

ACUTE HEALTH HAZARDS: If this product is splashed into the eye, may cause severe irritation, pain, slight corneal injury, redness, tearing and blurred vision.

CHRONIC HEALTH HAZARDS: N/E

EMERGENCY AND FIRST AID PROCEDURES: If this product gets in the eyes, wash eye immediately with large amounts of water, lifting the lower and upper lids occasionally. If irritation is present after washing, get medical attention. Contact lenses should not be worn when working with this product.

===SECTION VI - HEALTH HAZARD DATA CONT'D===

INHALATION:

ACUTE HEALTH HAZARDS: Overexposure to this product may cause nausea, irritation to the respiratory tract, fatigue, vomiting, marrow hypoplasia, and headache. Vapors may also cause eye and nasal irritation. Continued exposure at extremely high levels may cause staggering, unconsciousness, irregular heartbeat, and asphyxiation.

CHRONIC HEALTH HAZARDS: Damage to the Central Nervous System, liver, kidney and respiratory system could result from chronic continual overexposure to this product.

EMERGENCY AND FIRST AID PROCEDURES: If a person breathes in large amounts of this product, move the exposed person to fresh air at once. If breathing has stopped, perform artificial respiration. Keep the affected person warm and at rest. Get medical attention as soon as possible.

| | | | |
|------------------|------|------------------------------|-----------------|
| Carcinogenicity: | NTP? | IARC Monographs? | OSHA Regulated? |
| Yes: 1985 | No: | Yes:XXX No: | Yes: No:XXXX |
| | | Animals indefinite 20,515,79 | |
| | | Animal Positive 11,247,76 | |

Medical Conditions Generally Aggravated by Exposure: Impaired liver and renal functions, cardiac disease, central nervous system, obstructive airway diseases, and pre-existing skin disorders.

===SECTION VII - PRECAUTIONS FOR SAFE HANDLING AND USE===

Steps to be taken in case Material is Released or Spilled: Ventilate area. Contain spill. Clean up area by wiping, mopping or absorption with an absorbent material. Transfer material to a metal container. Avoid breathing vapors. Wear appropriate respirator and protective clothing.

Waste Disposal Method: Contaminated absorbent material or waste product must be disposed of in accordance with regulations in the Resource Conservation and Recovery Act and/or State, local or EPA regulations.

Precautions to be taken in Handling and Storing: Avoid contact with skin and avoid breathing vapors. Pipe vents outdoors. Store in cool, dry ventilated area. Vapors are heavier than air and will collect in low areas.

Other Precautions: No smoking in presence of vapors. Prevent moist air from entering storage area. Avoid prolonged contact with or storage in aluminum and its alloys. Contact with aluminum parts in a pressurizable fluid system may cause violent reactions.

===SECTION VIII - CONTROL MEASURES===

Respiratory Protection (Specify) Type: If exposure may or does exceed occupational exposure limits use a NIOSH/MSHA approved respirator to prevent overexposure. Use either a self-contained air supplied respirator or organic vapor respirator in accordance with 29 CFR 1910.134.

Ventilation:

Local Exhaust: Yes, generally required to reduce exposure to below OSHA allowable levels.

Mechanical (General): Not generally required if local exhaust ventilation is provided. If room air is not recirculated, but exhausted, may be adequate.

Special Exhaust: N/A

Other: Galvanized or Aluminum materials may be reactive with this product.

Protective Gloves: Employees should be provided with impervious gloves if direct skin contact is made with the product in a liquid state.

Eye Protection: Chemical Safety goggles, glasses or face shield (8" minimum) should be worn if a splash hazard is present. Contact lenses should not be worn when using this product.

Other Protective Clothing or Equipment: Impervious clothing should be worn to prevent repeated or prolonged skin contact with the product in a liquid state.

Special Work/Hygienic Practices: Wash hands with soap and water or a skin cleanser before eating, drinking, smoking, or using toilet facilities.

The following codes are being used:

N/A means: Not Applicable

N/E means: Not Established

ACETONE

REVISION OF: 06/23/86

SEA RAY BOATS INC

ORDER NO: 640W16840

2600 SEARAY BLVD
KNOXVILLE TN 37914

MCKESSON CHEMICAL COMPANY ONE POST STREET SAN FRANCISCO, CA 94104

-----EMERGENCY ASSISTANCE-----

FOR EMERGENCY ASSISTANCE INVOLVING CHEMICALS CALL CHEMTREC
(800) 424-9300.

-----FOR PRODUCT AND SALES INFORMATION-----

CONTACT YOUR LOCAL MCKESSON CHEMICAL COMPANY SERVICE CENTER

-----PRODUCT IDENTIFICATION-----

PRODUCT NAME: ACETONE

CAS NO.: 67-64-1

COMMON NAMES/SYNONYMS: ACETONE;

MCKESSON CODE: T1018

2-PROPANONE

FORMULA: C3 H6 O

DATE ISSUED: 06/86

HAZARD RATING (NFPA 704)

SUPERCEDES: 02/86

HEALTH: 1

HAZARD RATING SCALE:

FIRE: 3

0=MINIMAL 3=SERIOUS

REACTIVITY: 0

1=SLIGHT 4=SEVERE

SPECIAL: NONE

2=MODERATE

-----HAZARDOUS INGREDIENTS-----

| COMPONENT | EXPOSURE LIMITS, PPM | | | | HAZARD |
|-----------|----------------------|----------|-----------|-------------|---------------------|
| | % | OSHA PEL | ACGIH TLV | OTHER LIMIT | |
| ACETONE | 99 | 1000 | 750 | NONE | FLAMMABLE; IRRITANT |

-----PHYSICAL/CHEMICAL CHARACTERISTICS-----

ACETONE

REVISION OF: 06/23/86

BOILING POINT, DEG F: 133 VAPOR PRESSURE, MM HG/20 DEG C: 184
MELTING POINT, DEG F: -142 VAPOR DENSITY (AIR=1): 2.0
SPECIFIC GRAVITY (WATER=1): 0.79 WATER SOLUBILITY, %: 100
APPEARANCE AND ODOR: CLEAR, EVAPORATION RATE (BUTYL ACETATE=1): 14
COLORLESS LIQUID; SWEET ODOR

-----FIRST AID MEASURES-----

IF INHALED: REMOVE TO FRESH AIR. GIVE ARTIFICIAL RESPIRATION IF NOT BREATHING. GET IMMEDIATE MEDICAL ATTENTION.

IN CASE OF EYE CONTACT: IMMEDIATELY FLUSH EYES WITH LOTS OF RUNNING WATER FOR 15 MINUTES, LIFTING THE UPPER AND LOWER EYELIDS OCCASIONALLY. GET IMMEDIATE MEDICAL ATTENTION.

IN CASE OF SKIN CONTACT: IMMEDIATELY WASH SKIN WITH LOTS OF SOAP AND WATER. REMOVE CONTAMINATED CLOTHING AND SHOES; WASH BEFORE REUSE. GET MEDICAL ATTENTION IF IRRITATION PERSISTS AFTER WASHING.

IF SWALLOWED: IF CONSCIOUS, IMMEDIATELY INDUCE VOMITING BY GIVING 2 GLASSES OF WATER AND STICKING A FINGER DOWN THE THROAT. GET IMMEDIATE MEDICAL ATTENTION. DO NOT GIVE ANYTHING TO AN UNCONSCIOUS OR CONVULSING PERSON.

-----HEALTH HAZARD INFORMATION-----

PRIMARY ROUTES OF EXPOSURE: INHALATION, SKIN OR EYE CONTACT.

SIGNS AND SYMPTOMS OF EXPOSURE

INHALATION: PROLONGED OR REPEATED EXPOSURE OR BREATHING VERY HIGH CONCENTRATIONS MAY CAUSE HEADACHES, NAUSEA, VOMITING, DIZZINESS, OTHER CENTRAL NERVOUS SYSTEM EFFECTS, CONVULSIONS, AND IN EXTREME CASES, UNCONSCIOUSNESS AND DEATH.

EYE CONTACT: VAPORS WILL IRRITATE THE EYES. LIQUID AND MISTS WILL IRRITATE AND MAY BURN THE EYES.

SKIN CONTACT: BRIEF CONTACT MAY DRY THE SKIN. PROLONGED OR REPEATED CONTACT MAY IRRITATE THE SKIN, CAUSING DERMATITIS.

SWALLOWED: SWALLOWING LARGE QUANTITIES CAUSES HEADACHES, NAUSEA, VOMITING, AND PERHAPS UNCONSCIOUSNESS. CAN ALSO CAUSE LIVER AND KIDNEY

ACETONE

REVISION OF: 06/23/86

INJURY.

CHRONIC EFFECTS OF EXPOSURE: NO SPECIFIC INFORMATION AVAILABLE.

MEDICAL CONDITIONS GENERALLY AGGRAVATED BY EXPOSURE: PREEXISTING EYE OR SKIN DISORDERS MAY BE AGGRAVATED BY ACETONE EXPOSURE. ALSO, USE OF ALCOHOLIC BEVERAGES ENHANCES TOXIC EFFECTS.

-----TOXICITY DATA-----

ORAL: RAT LD50 = 9750 MG/KG

DERMAL: RABBIT LD50 = 20 G/KG

INHALATION: RAT LC50 = 16,000 PPM/4 HR

CARCINOGENICITY: THIS MATERIAL IS NOT CONSIDERED TO BE A CARCINOGEN BY THE NATIONAL TOXICOLOGY PROGRAM, THE INTERNATIONAL AGENCY FOR RESEARCH ON CANCER, OR THE OCCUPATIONAL SAFETY AND HEALTH ADMINISTRATION

OTHER DATA: INHALATION HUMAN TCLO = 500 PPM (EYE)

-----PERSONAL PROTECTION-----

VENTILATION: LOCAL MECHANICAL EXHAUST VENTILATION CAPABLE OF MAINTAINING EMISSIONS AT THE POINT OF USE BELOW THE PEL.

RESPIRATORY PROTECTION: IF USE CONDITIONS GENERATE VAPORS OR MISTS, WEAR A NIOSH-APPROVED RESPIRATOR APPROPRIATE FOR THOSE EMISSION LEVELS. APPROPRIATE RESPIRATORS MAY BE A FULL FACEPIECE OR A HALF MASK AIR-PURIFYING CARTRIDGE RESPIRATOR EQUIPPED FOR ORGANIC VAPORS/MISTS, A SELF-CONTAINED BREATHING APPARATUS IN THE PRESSURE DEMAND MODE, OR A SUPPLIED-AIR RESPIRATOR.

EYE PROTECTION: CHEMICAL GOGGLES UNLESS A FULL FACEPIECE RESPIRATOR IS ALSO WORN. IT IS GENERALLY RECOGNIZED THAT CONTACT LENSES SHOULD NOT BE WORN WHEN WORKING WITH CHEMICALS BECAUSE CONTACT LENSES MAY CONTRIBUTE TO THE SEVERITY OF AN EYE INJURY.

PROTECTIVE CLOTHING: LONG-SLEEVED SHIRT, TROUSERS, SAFETY SHOES, RUBBER GLOVES, AND RUBBER APRON.

ACETONE

REVISION OF: 06/23/86

OTHER PROTECTIVE MEASURES: AN EYEWASH AND SAFETY SHOWER SHOULD BE NEARBY AND READY FOR USE.

-----FIRE AND EXPLOSION INFORMATION-----

FLASH POINT, DEG F: 0

FLAMMABLE LIMITS IN AIR, %

METHOD USED: TCC

LOWER: 2 UPPER: 13

EXTINGUISHING MEDIA: USE WATER SPRAY, DRY CHEMICAL, CO2, OR ALCOHOL FOAM.

SPECIAL FIRE FIGHTING PROCEDURES: FIRE FIGHTERS SHOULD WEAR SELF-CONTAINED BREATHING APPARATUS AND FULL PROTECTIVE CLOTHING. USE WATER SPRAY TO COOL NEARBY CONTAINERS AND STRUCTURES EXPOSED TO FIRE.

UNUSUAL FIRE AND EXPLOSION HAZARDS: ACETONE IS EXTREMELY FLAMMABLE. EXTINGUISH ALL NEARBY SOURCES OF IGNITION. AVOID ACCUMULATION OF WATER OR ACETONE VAPORS BECAUSE AQUEOUS SOLUTIONS CONTAINING MORE THAN 2.5% ACETONE ARE FLAMMABLE.

-----HAZARDOUS REACTIVITY-----

STABILITY: STABLE

POLYMERIZATION: WILL NOT OCCUR

CONDITIONS TO AVOID: HEAT, SPARKS, AND OPEN FLAMES.

MATERIALS TO AVOID: ACIDS, OXIDIZING MATERIALS, POTASSIUM T-BUTOXIDE, ALKALIS, AMINES, ALKANOLAMINES, AMMONIA, ALDEHYDES, AND CHLORINATED COMPOUNDS.

HAZARDOUS DECOMPOSITION PRODUCTS: MAY LIBERATE CARBON MONOXIDE, CARBON DIOXIDE, AND UNIDENTIFIED ORGANIC COMPOUNDS IN BLACK SMOKE.

-----SPILL, LEAK, AND DISPOSAL PROCEDURES-----

ACTION TO TAKE FOR SPILLS OR LEAKS: WEAR PROTECTIVE EQUIPMENT INCLUDING RUBBER BOOTS, RUBBER GLOVES, RUBBER APRON, AND A SELF-CONTAINED BREATHING APPARATUS IN THE PRESSURE DEMAND MODE OR A SUPPLIED-AIR RESPIRATOR. IF THE SPILL OR LEAK IS SMALL, A FULL FACEPIECE AIR-PURIFYING CARTRIDGE RESPIRATOR EQUIPPED FOR ORGANIC VAPORS MAY BE SATISFACTORY. IN ANY EVENT, ALWAYS WEAR EYE PROTECTION. EXTINGUISH ALL IGNITION SOURCES AND ENSURE THAT ALL HANDLING EQUIPMENT IS ELECTRICALLY GROUNDED. FOR SMALL SPILLS OR DRIPS, MOP OR WIPE UP AND DISPOSE OF IN DOT-APPROVED WASTE CONTAINERS. FOR LARGE SPILLS, CONTAIN BY DIKING WITH SOIL OR

ACETONE

REVISION OF: 06/23/86

OTHER NON-COMBUSTIBLE ABSORBENT MATERIALS AND THEN PUMP INTO DOT-APPROVED WASTE CONTAINERS; OR ABSORB WITH NON-COMBUSTIBLE SORBENT MATERIAL, PLACE RESIDUE IN DOT-APPROVED WASTE CONTAINERS. KEEP OUT OF SEWERS, STORM DRAINS, SURFACE WATERS, AND SOIL. COMPLY WITH ALL APPLICABLE GOVERNMENTAL REGULATIONS ON SPILL REPORTING, AND HANDLING AND DISPOSAL OF WASTE.

DISPOSAL METHODS: DISPOSE OF CONTAMINATED PRODUCT AND MATERIALS USED IN CLEANING UP SPILLS OR LEAKS IN A MANNER APPROVED FOR THIS MATERIAL. CONSULT APPROPRIATE FEDERAL, STATE AND LOCAL REGULATORY AGENCIES TO ASCERTAIN PROPER DISPOSAL PROCEDURES.

NOTE: EMPTY CONTAINERS CAN HAVE RESIDUES, GASES AND MISTS AND ARE SUBJECT TO PROPER WASTE DISPOSAL, AS ABOVE.

-----SPECIAL PRECAUTIONS-----

HANDLING AND STORAGE PRECAUTIONS: KEEP AWAY FROM HEAT, SPARKS, AND FLAMES. STORE IN A COOL, DRY, WELL-VENTILATED PLACE AWAY FROM INCOMPATIBLE MATERIALS. VENT CONTAINER FREQUENTLY, AND MORE OFTEN IN WARM WEATHER, TO RELIEVE PRESSURE. ELECTRICALLY GROUND ALL EQUIPMENT WHEN HANDLING THIS PRODUCT AND USE ONLY NON-SPARKING TOOLS. KEEP CONTAINER TIGHTLY CLOSED WHEN NOT IN USE. DO NOT USE PRESSURE TO EMPTY CONTAINER. WASH THOROUGHLY AFTER HANDLING. DO NOT GET IN EYES, ON SKIN, OR ON CLOTHING.

REPAIR AND MAINTENANCE PRECAUTIONS: DO NOT CUT, GRIND, WELD, OR DRILL ON OR NEAR THIS CONTAINER.

OTHER PRECAUTIONS: CONTAINERS, EVEN THOSE THAT HAVE BEEN EMPTIED, WILL RETAIN PRODUCT RESIDUE AND VAPORS. ALWAYS OBEY HAZARD WARNINGS AND HANDLE EMPTY CONTAINERS AS IF THEY WERE FULL.

-----FOR ADDITIONAL INFORMATION-----

CONTACT DOUGLAS EISNER, TECHNICAL DIRECTOR, MCKESSON CHEMICAL COMPANY, DURING BUSINESS HOURS, PACIFIC TIME (415)983-9214.

-----NOTICE-----

ALL INFORMATION, RECOMMENDATIONS, AND SUGGESTIONS APPEARING HEREIN CONCERNING THIS PRODUCT ARE BASED UPON DATA OBTAINED FROM THE MANUFACTURER AND/OR RECOGNIZED TECHNICAL SOURCES; HOWEVER, MCKESSON

ACETONE

REVISION OF: 06/23/86

CHEMICAL COMPANY ("MCC") MAKES NO WARRANTY, REPRESENTATION OR GUARANTY AS TO THE ACCURACY, SUFFICIENCY OR COMPLETENESS OF THE MATERIAL SET FORTH HEREIN. IT IS THE USER'S RESPONSIBILITY TO DETERMINE THE SAFETY, TOXICITY AND SUITABILITY OF HIS OWN USE, HANDLING AND DISPOSAL OF THE PRODUCT. ADDITIONAL PRODUCT LITERATURE MAY BE AVAILABLE UPON REQUEST. SINCE ACTUAL USE BY OTHERS IS BEYOND OUR CONTROL, NO WARRANTY, EXPRESS OR IMPLIED, IS MADE BY MCC AS TO THE EFFECTS OF SUCH USE, THE RESULTS TO BE OBTAINED OR THE SAFETY AND TOXICITY OF THE PRODUCT, NOR DOES MCC ASSUME ANY LIABILITY ARISING OUT OF USE BY OTHERS OF THE PRODUCT REFERRED TO HEREIN. THE DATA IN THIS MSDS RELATE ONLY TO THE SPECIFIC MATERIAL DESIGNATED HEREIN AND DO NOT RELATE TO USE IN COMBINATION WITH ANY OTHER MATERIAL OR IN ANY PROCESS.

-----REVISION-----

0000002

06/86: ADDED HAZARD INFORMATION TO INHALATION, SWALLOWING, AND MEDICAL CONDITIONS SECTIONS. ADDED INHALATION TOXICITY DATA AND CORRECTED "OTHER" TOXICITY DATA. REVISED RESPIRATORY AND EYE PROTECTION. REVISED FIRE AND EXPLOSION INFORMATION SECTION. ADDED MATERIALS TO AVOID AND REVISED SPILL/LEAK PROCEDURES AND HANDLING ADVICE.

END OF MSDS

Best Available Copy

U.S. DEPARTMENT OF LABOR
Occupational Safety and Health Administration

Bottom Paint
OMO

MATERIAL SAFETY DATA SHEET

Required under USDL Safety and Health Regulations for Ship Repairing, Shipbuilding, and Shipbreaking (29 CFR 1915, 1916, 1917)

SECTION I

| | | |
|--|---------|---|
| MANUFACTURER'S NAME NAUTICAL COATINGS, INC. | | EMERGENCY TELEPHONE NO. 813-536-3789 |
| ADDRESS (Number, Street, City, State, and ZIP Code) 12400 Belcher Road, Largo, Fl. 33543 | | |
| CHEMICAL NAME AND SYNONYMS ANTI-FOULING PAINT | | TRADE NAME AND SYNONYMS SEA HAWK OEP-II |
| CHEMICAL FAMILY | FORMULA | |

SECTION II - HAZARDOUS INGREDIENTS

| PAINTS, PRESERVATIVES, & SOLVENTS | % | TLV (Units) | ALLOYS AND METALLIC COATINGS | % | TLV (Units) |
|---|-------------|----------------|--|---|-------------|
| PIGMENTS Tri-ethyl tin fluoride | 4.5 | | BASE METAL | | |
| CATALYST | | | ALLOYS | | |
| VEHICLE Tributyl tin methacrylate | 10.8 | | METALLIC COATINGS | | |
| SOLVENTS Aromatic hydrocarbons | 42.9 | 100 ppm | FILLER METAL PLUS COATING OR CORE FLUX | | |
| ADDITIVES | | | OTHERS | | |
| OTHERS | | | | | |
| HAZARDOUS MIXTURES OF OTHER LIQUIDS, SOLIDS, OR GASES | | | | % | TLV (Units) |
| | | | | | |
| | | | | | |
| | | | | | |

SECTION III - PHYSICAL DATA

| | | | |
|-------------------------|-------------------------------|--|-------------|
| BOILING POINT (°F.) | | SPECIFIC GRAVITY (H ₂ O=1) | 1.38 |
| VAPOR PRESSURE (mm Hg.) | | PERCENT VOLATILE BY VOLUME (%) | 60 |
| VAPOR DENSITY (AIR=1) | Greater than 1 | EVAPORATION RATE (Tributyl tin methacrylate) | 0.19 |
| SOLUBILITY IN WATER | slight | | |
| APPEARANCE AND ODOR | Liquid. Odor of Xylol. | | |

SECTION IV - FIRE AND EXPLOSION HAZARD DATA

| | | | | |
|------------------------------------|--|------------------|----|------|
| FLASH POINT (Method Used) | 790 F TCC | FLAMMABLE LIMITS | Li | U.L. |
| EXTINGUISHING MEDIA | Water spray, CO₂, Foam, dry chemical | | | |
| SPECIAL FIRE FIGHTING PROCEDURES | Fire fighters should be equipped with self contained breathing apparatus. | | | |
| UNUSUAL FIRE AND EXPLOSION HAZARDS | Flammable if exposed to heat, sparks, or flame. | | | |

SECTION V - HEALTH HAZARD DATA

THRESHOLD LIMIT VALUE Organotin compounds - 0.1mg. Sn/M³

EFFECTS OF OVEREXPOSURE Causes severe damage to eyes and skin. Toxic by ingestion. Fumes are irritating to upper respiratory tract.

EMERGENCY AND FIRST AID PROCEDURES
 In case of eye contact, flush with flowing water at least 15 minute and get immediate medical attention. Remove contaminated clothing.
 Skin: Flush with water and wash with soap & water. Inhalation: move exposed individual to fresh air.

SECTION VI - REACTIVITY DATA

| | | | |
|--|----------------|---|------------------------------------|
| STABILITY | UNSTABLE | | CONDITIONS TO AVOID |
| | STABLE | X | Exposure to heat, sparks and fire. |
| INCOMPATIBILITY (Materials to avoid) Strong oxidizing agents | | | |
| HAZARDOUS DECOMPOSITION PRODUCTS | | | |
| HAZARDOUS POLYMERIZATION | MAY OCCUR | | CONDITIONS TO AVOID |
| | WILL NOT OCCUR | X | |

SECTION VII - SPILL OR LEAK PROCEDURES

STEPS TO BE TAKEN IN CASE MATERIAL IS RELEASED OR SPILLED
 Eliminate all ignition sources. Absorb spills with sand or other inert material, using non-sparking tools. Place in suitable containers for disposal.

WASTE DISPOSAL METHOD
 Incinerate or dispose of as solid waste. Follow all applicable regulations for pollution control.

SECTION VIII - SPECIAL PROTECTION INFORMATION

| | | |
|--|----------------------|--|
| RESPIRATORY PROTECTION (Specify type) Use NIOSH approved respirator if airborne concentration exceeds TLV | | |
| VENTILATION | LOCAL EXHAUST | Required |
| | MECHANICAL (General) | Required |
| PROTECTIVE GLOVES | Required | EYE PROTECTION Chemical workers goggles |
| OTHER PROTECTIVE EQUIPMENT Emergency eye-wash | | |

SECTION IX - SPECIAL PRECAUTIONS

PRECAUTIONS TO BE TAKEN IN HANDLING AND STORAGE
 Avoid all skin and eye contact. Provide adequate ventilation,
 Do not breathe fumes. Launder contaminated clothing before re-use.

OTHER PRECAUTIONS
 Store in area suitable for flammable materials.

EXHIBIT "B"

Sea Ray Boats, INC at the Sykes Creek Facility shall be in the business of manufacturing fiberglass pleasure boats.

The process is generally described as follows:

Step 1. Gel coat (the exterior colors) are sprayed into a mold by an airless method. Gel Coat is described in the attached Material Safety Data Sheets titled Exhibit A.

Step 2. Structural resin and fiberglass is again sprayed by an airless method into the mold over the Gel Coat and wooden and foam parts are added for rigidity. Resin is described in the attached Material Safety Data Sheets titled Exhibit A.

Step 3. After the lamination (resin applications) process the hull and deck parts plus any miscellaneous small parts are extracted from their molds and are trimmed of excess or overspray. (Molds are cleaned, waxed and returned to Step 1).

Step 4. Glue is utilized in the preparation of upholstered parts, which are also used in the final assembly process.

Step 5. The boat assembly process utilizes the fiberglass parts, the exposed wooden parts and other materials and parts which come to the site in a ready to use condition (i.e. they are not manufactured on site).

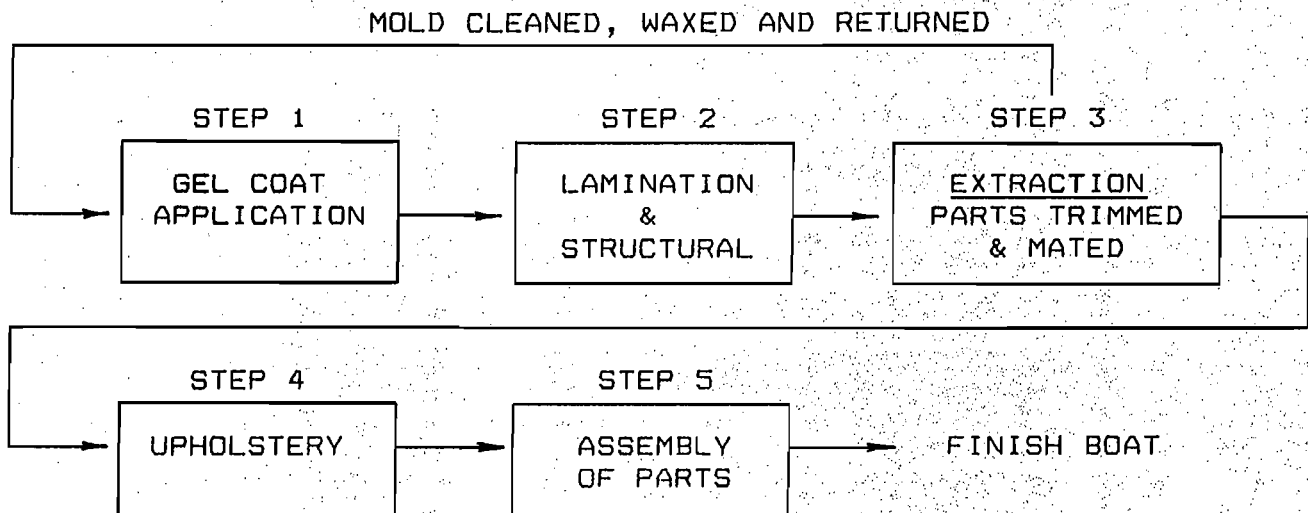

CHEMISTRY

Polyester resin is a chemical chain containing organic acids and alcohols with an ester linkage (hence the name, polyester).

Styrene is the most commonly used crosslinking agent that connects the polyester chains and creates a polyester resin which is liquid and flexible for the fabrication of parts.

Styrene, as a crosslinking agent, reacts with the available bond sites on the polyester chain, usually the unsaturated organic acid.

When the resin arrives at the plant it is in a liquid form: a polyester thinned with 30 to 45% styrene monomer and mixed with inhibitors to prevent a spontaneous cross-linking reaction.

Catalysts, promoters and temperature control the rate of cross-linking or reaction. Methyl Ethyl Ketone Peroxide is the catalyst used and is normally a 1% addition.

Acetone is used sparingly as a solvent to clean equipment after application of the resin.

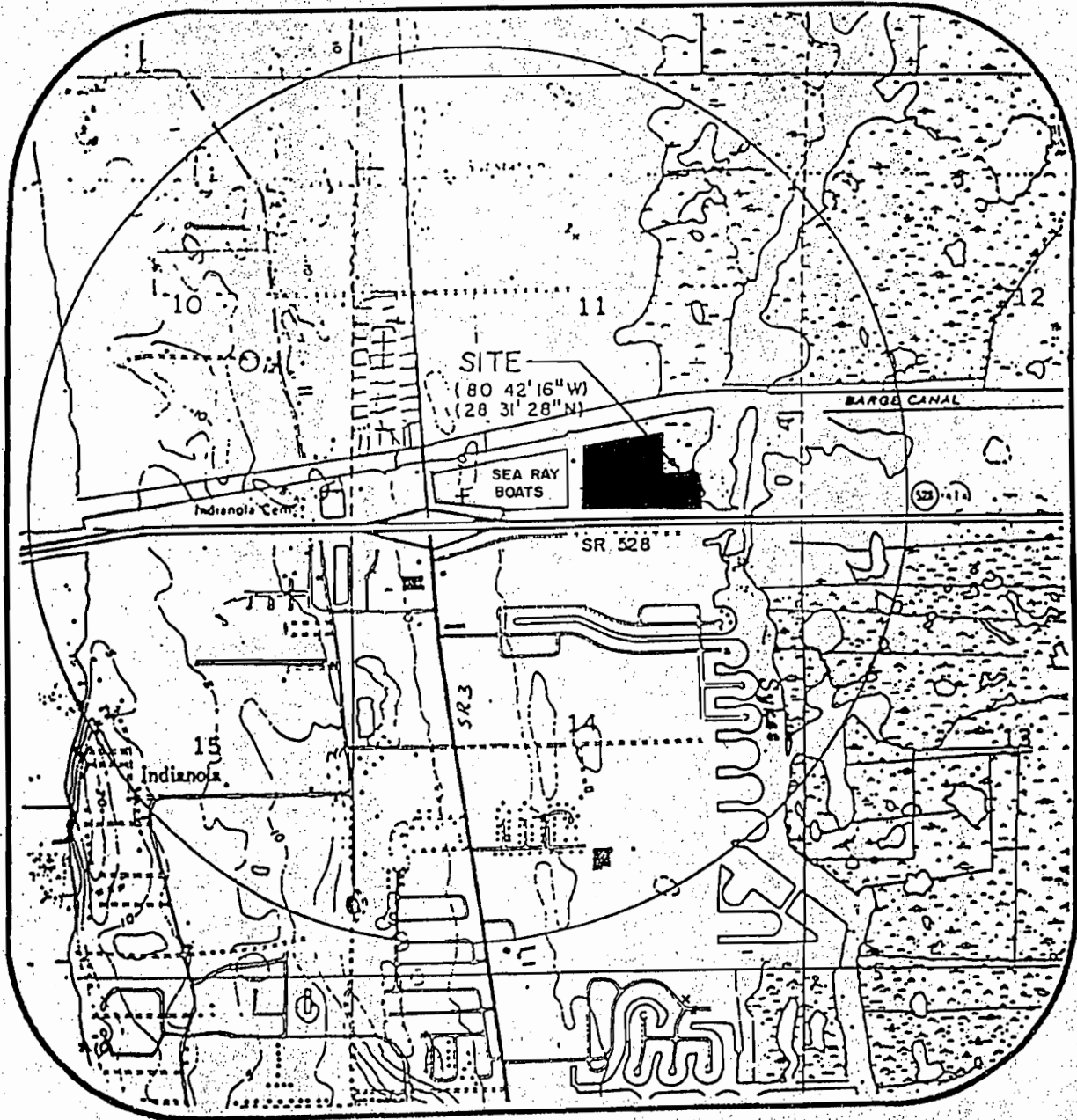

VICINITY MAP

1" = 2000'

ADJACENT PROPERTY OWNERS:

1. CANAVERAL PORT AUTHORITY
P.O. BOX 267
CAPE CANAVERAL, FL 32920

2. FLORIDA DEPARTMENT OF TRANSPORTATION

EXHIBIT "D"

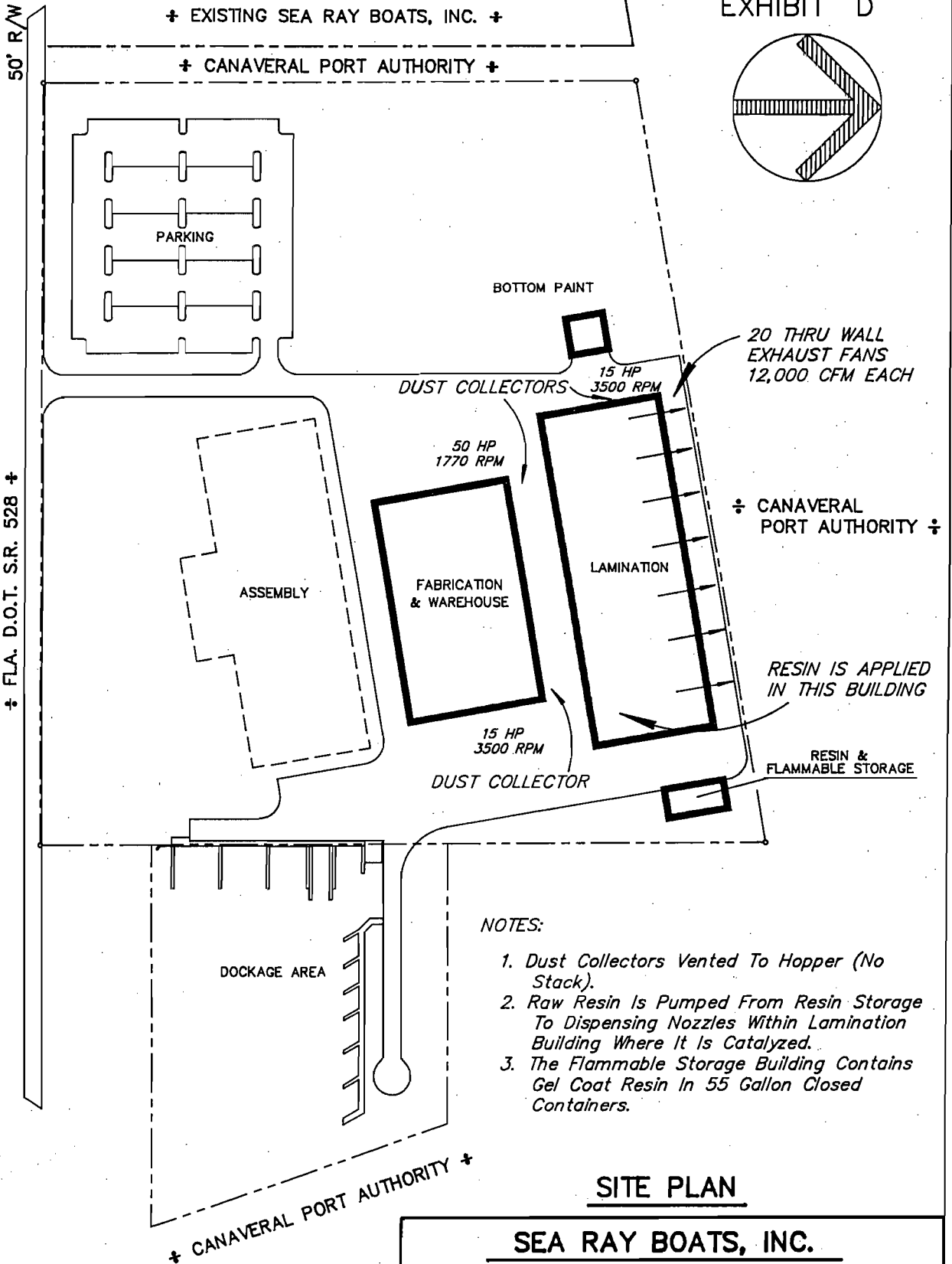
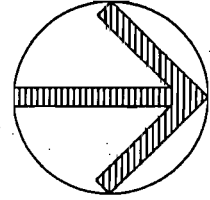

NOTES:

1. Dust Collectors Vented To Hopper (No Stack).
2. Raw Resin Is Pumped From Resin Storage To Dispensing Nozzles Within Lamination Building Where It Is Catalyzed.
3. The Flammable Storage Building Contains Gel Coat Resin In 55 Gallon Closed Containers.

SITE PLAN

SEA RAY BOATS, INC.

SYKES CREEK FACILITY

MERRITT ISLAND,

FLORIDA

SCALE:
1" = 200'

DATE:
6-20-88

DRAWN:

CANTELOU ASSOCIATES

CONSULTING ENGINEERS • SURVEYORS • PLANNERS
1359 Silver Bluff Rd. Suite B-3/P.O. Box 3102/Aiken, S.C. 29801





SEA RAY BOATS, INC.
WORLD HEADQUARTERS, 2600 SEA RAY BLVD., KNOXVILLE, TENNESSEE 37914 (615) 522-4181

June 28, 1988



State of Florida
Department of Environmental Regulation
Central Florida District
3319 Maguire Boulevard
Orlando, Florida 32803-3767

Gentlemen:

Please be advised that G. E. Cantelou, Jr., a professional engineer, is serving as a consultant to our Company in matters attendant to our new manufacturing plant to be located in Merritt Island, Florida and will be filing with your offices as our representative an Application To Operate/Construct Air Pollution Sources seeking a construction permit with respect to such facility.

Very truly yours,

SEA RAY BOATS, INC.

John A. Cronkhite
Senior Vice President/
General Counsel

JAC:cbh

USAGE LOG

WEEK ENDING: _____

| MONDAY | | (1) | (2) | (3) | (4) | (5) | (6) |
|--------------|----------------------|---------|------------|-------------|--------------|---|---|
| DESCRIPTION | | DENSITY | VOC FACTOR | TIME FACTOR | AMOUNTS USED | TOTAL VOC EMISSIONS (5) = (1)X(2)X(4)/2000 | HOURLY VOC EMISSIONS (6) = (1)X(2)X(4)/(3) |
| PRODUCT | COMPONENT | #/GAL | % BY WT | HRS/DAY | (GALS) | (TONS) | (#/HR) |
| RESIN | STYRENE | 9.15 | 8 | 16 | | | |
| GEL COAT | STYRENE | 10.7 | 8 | 16 | | | |
| | METHYL METHACRALATE | 10.7 | 8 | 16 | | | |
| MEKP | MEKP | 8.0 | 10 | 16 | | | |
| ADHESIVE | 1,1,1-TRICHLORETHANE | 10.5 | 66 | 16 | | | |
| ACETONE | ACETONE | 6.1 | 50 | 16 | | | |
| BOTTOM PAINT | BOTTOM PAINT | 11.4 | 60 | 16 | | | |

TOTAL DAILY EMISSIONS _____

| TUESDAY | | (1) | (2) | (3) | (4) | (5) | (6) |
|--------------|----------------------|---------|------------|-------------|--------------|---|---|
| DESCRIPTION | | DENSITY | VOC FACTOR | TIME FACTOR | AMOUNTS USED | TOTAL VOC EMISSIONS (5) = (1)X(2)X(4)/2000 | HOURLY VOC EMISSIONS (6) = (1)X(2)X(4)/(3) |
| PRODUCT | COMPONENT | #/GAL | % BY WT | HRS/DAY | (GALS) | (TONS) | (#/HR) |
| RESIN | STYRENE | 9.15 | 8 | 16 | | | |
| GEL COAT | STYRENE | 10.7 | 8 | 16 | | | |
| | METHYL METHACRALATE | 10.7 | 8 | 16 | | | |
| MEKP | MEKP | 8.0 | 10 | 16 | | | |
| ADHESIVE | 1,1,1-TRICHLORETHANE | 10.5 | 66 | 16 | | | |
| ACETONE | ACETONE | 6.1 | 50 | 16 | | | |
| BOTTOM PAINT | BOTTOM PAINT | 11.4 | 60 | 16 | | | |

TOTAL DAILY EMISSIONS _____

| WEDNESDAY | | (1) | (2) | (3) | (4) | (5) | (6) |
|--------------|----------------------|---------|------------|-------------|--------------|---|---|
| DESCRIPTION | | DENSITY | VOC FACTOR | TIME FACTOR | AMOUNTS USED | TOTAL VOC EMISSIONS (5) = (1)X(2)X(4)/2000 | HOURLY VOC EMISSIONS (6) = (1)X(2)X(4)/(3) |
| PRODUCT | COMPONENT | #/GAL | % BY WT | HRS/DAY | (GALS) | (TONS) | (#/HR) |
| RESIN | STYRENE | 9.15 | 8 | 16 | | | |
| GEL COAT | STYRENE | 10.7 | 8 | 16 | | | |
| | METHYL METHACRALATE | 10.7 | 8 | 16 | | | |
| MEKP | MEKP | 8.0 | 10 | 16 | | | |
| ADHESIVE | 1,1,1-TRICHLORETHANE | 10.5 | 66 | 16 | | | |
| ACETONE | ACETONE | 6.1 | 50 | 16 | | | |
| BOTTOM PAINT | BOTTOM PAINT | 11.4 | 60 | 16 | | | |

TOTAL DAILY EMISSIONS _____

| THURSDAY | | (1) | (2) | (3) | (4) | (5) | (6) |
|--------------|----------------------|---------|------------|-------------|--------------|---|---|
| DESCRIPTION | | DENSITY | VOC FACTOR | TIME FACTOR | AMOUNTS USED | TOTAL VOC EMISSIONS (5) = (1)X(2)X(4)/2000 | HOURLY VOC EMISSIONS (6) = (1)X(2)X(4)/(3) |
| PRODUCT | COMPONENT | #/GAL | % BY WT | HRS/DAY | (GALS) | (TONS) | (#/HR) |
| RESIN | STYRENE | 9.15 | 8 | 16 | | | |
| GEL COAT | STYRENE | 10.7 | 8 | 16 | | | |
| | METHYL METHACRALATE | 10.7 | 8 | 16 | | | |
| MEKP | MEKP | 8.0 | 10 | 16 | | | |
| ADHESIVE | 1,1,1-TRICHLORETHANE | 10.5 | 66 | 16 | | | |
| ACETONE | ACETONE | 6.1 | 50 | 16 | | | |
| BOTTOM PAINT | BOTTOM PAINT | 11.4 | 60 | 16 | | | |

TOTAL DAILY EMISSIONS _____

| FRIDAY | | (1) | (2) | (3) | (4) | (5) | (6) |
|--------------|----------------------|---------|------------|-------------|--------------|---|---|
| DESCRIPTION | | DENSITY | VOC FACTOR | TIME FACTOR | AMOUNTS USED | TOTAL VOC EMISSIONS (5) = (1)X(2)X(4)/2000 | HOURLY VOC EMISSIONS (6) = (1)X(2)X(4)/(3) |
| PRODUCT | COMPONENT | #/GAL | % BY WT | HRS/DAY | (GALS) | (TONS) | (#/HR) |
| RESIN | STYRENE | 9.15 | 8 | 16 | | | |
| GEL COAT | STYRENE | 10.7 | 8 | 16 | | | |
| | METHYL METHACRALATE | 10.7 | 8 | 16 | | | |
| MEKP | MEKP | 8.0 | 10 | 16 | | | |
| ADHESIVE | 1,1,1-TRICHLORETHANE | 10.5 | 66 | 16 | | | |
| ACETONE | ACETONE | 6.1 | 50 | 16 | | | |
| BOTTOM PAINT | BOTTOM PAINT | 11.4 | 60 | 16 | | | |

TOTAL DAILY EMISSIONS _____

TOTAL WEEKLY EMISSIONS _____