

(FOR INTERNAL USE ONLY)

State of Florida summary checklist for initial Title V permit applications for 'existing' Title V Sources

Facility Owner/Operator Name: City of Homestead
Facility ID No.: 0250013 Site Name: Gordon W. Ivey Power Plant
County: Dade
application receipt date 06/10/96

I. Preliminary scanning of application submitted.

- a. Was application submitted to correct permitting authority? Y ✓? N
- b. Was an application filed? Y* ✓ N
- c. Was the application filed timely? Y* ✓ N

d. Application format filed [check one].

Hard copy of official version of form? ELSA? ✓ *attacheds hardcopy*
 A facsimile of official version of form? Some combination?

- e. 4 copies (paper/electronic) submitted? Y ✓ N

- f. Electronic diskettes protected/virus scanned/marked? Y ✓ N N/A
 by K.Z. date 06/12/96

- g. Entire hard copy of Section I. provided (Pages 1-8 of form)? Y ✓ N
 Facility identified (Page 1)? [if not complete a Page 1] Y* [Attached ✓]
 R.O. certification signed and dated (Page 2)? Y* ✓ N
 P.E. certification signed and dated (Page 7)? Y* ✓ N

- h. Any confidential information submitted? Y N ✓
 If yes, R.O. provided hard copy to us and EPA? Y* N
 If yes, hard copy locked up and note filed with application? Y* N

- i. Type of application filed.
 TV application for 'existing' Title V Source only? Y ✓ N
 Any units subject to acid rain? Y ✓? N

Note(s): [*] = mandatory.

Comment(s): a., i. May not be Acid Rain. If not, will go to District.
0250013 uploaded to EARS 7/18/96 G/arc

Reviewer's initials SS date 06/14/96 Concurrence initials date / /

(FOR INTERNAL USE ONLY)

State of Florida summary checklist for initial Title V permit applications for 'existing' Title V Sources (cont'd)

II. Application logging.

ARMS Permit Number assigned 02 S 0013 - AV
logged into ARMS by initials _____ date / /

III. Initial distribution of application.

a. Disposition of 4 paper/electronic copies submitted:

- 1- Clean originals to file? Y ___ N ___
- 1- ___ District Y ___ N ___
- 1- _____ County [affected local program]? Y ___ N ___
- 1- Permit engineer(s) _____, _____

b. Disposition of electronic files submitted:

copy placed onto PC? Y ___ N ___

c. Disposition of ELSA submitted:

version used [circle]: 1.0 1.1 1.2.1 1.3 1.3a 1.3b
Uploaded to EARS? Y N ___
by E.S date 07/12/16

d. Electronic information submitted previewed? Y ___ N ___ N/A ___

Comment(s): _____

{this checklist was developed from Rule 62-213.420(1)(b)2., F.A.C. and DARM policy}

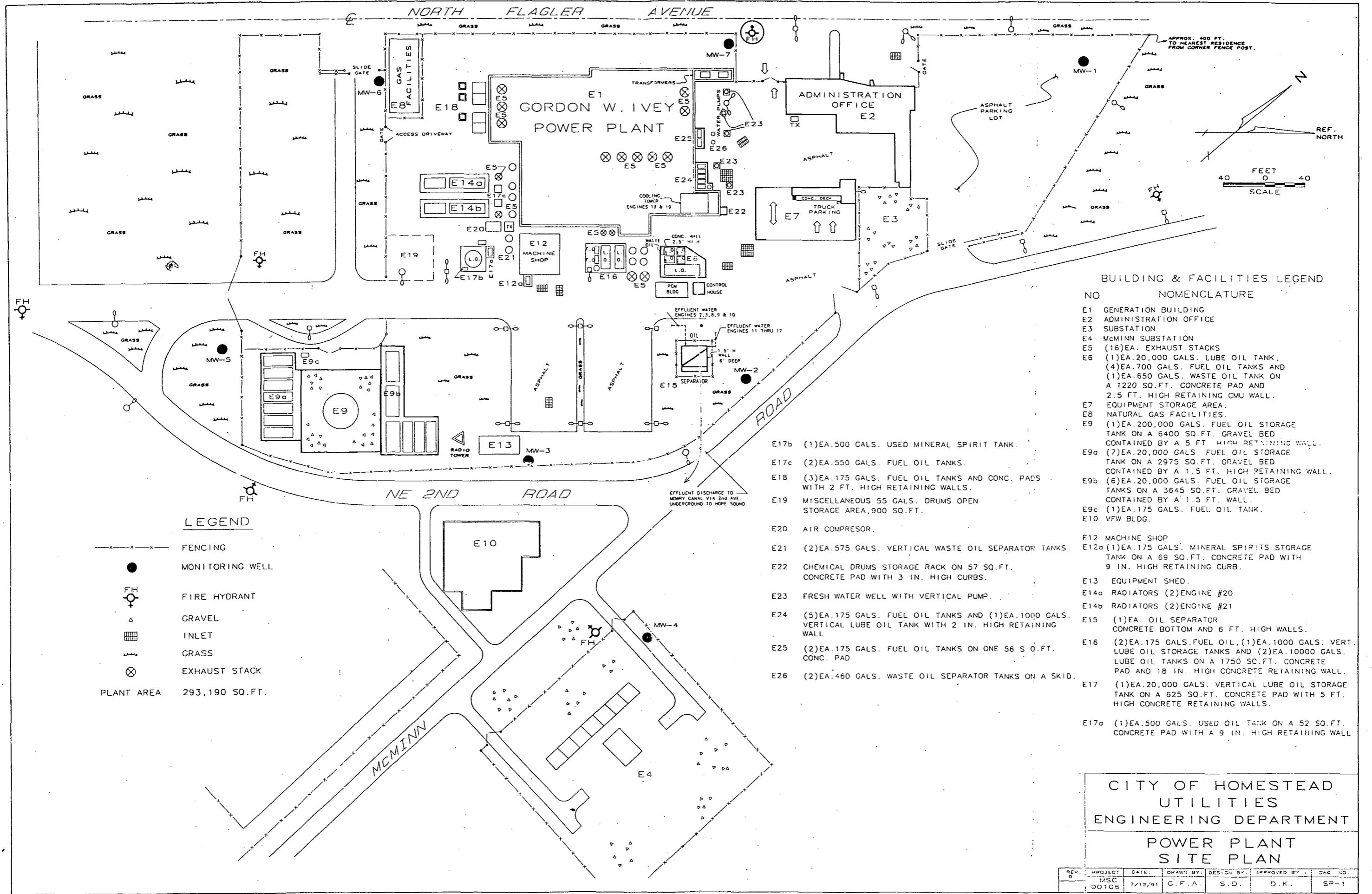

LEGEND

- FENCING
- MONITORING WELL
- FH FIRE HYDRANT
- △ GRAVEL
- ▣ INLET
- ▨ GRASS
- ⊗ EXHAUST STACK
- PLANT AREA 293,190 SQ.FT.

BUILDING & FACILITIES LEGEND

- NO NOMENCLATURE
- E1 GENERATION BUILDING
 - E2 ADMINISTRATION OFFICE
 - E3 SUBSTATION
 - E4 MCMINN SUBSTATION
 - E5 (16)EA. EXHAUST STACKS
 - E6 (1)EA. 20,000 GALS. LUBE OIL TANK, (4)EA. 700 GALS. FUEL OIL TANKS AND (1)EA. 650 GALS. WASTE OIL TANK ON A 1220 SQ.FT. CONCRETE PAD AND 2.5 FT. HIGH RETAINING CMU WALL.
 - E7 EQUIPMENT STORAGE AREA.
 - E8 NATURAL GAS FACILITIES.
 - E9 (1)EA. 200,000 GALS. FUEL OIL STORAGE TANK ON A 6400 SQ.FT. GRAVEL BED CONTAINED BY A 5 FT. HIGH RETAINING WALL. (7)EA. 20,000 GALS. FUEL OIL STORAGE TANK ON A 2975 SQ.FT. GRAVEL BED CONTAINED BY A 1.5 FT. HIGH RETAINING WALL. (6)EA. 20,000 GALS. FUEL OIL STORAGE TANKS ON A 3645 SQ.FT. GRAVEL BED CONTAINED BY A 1.5 FT. WALL.
 - E9c (1)EA. 175 GALS. FUEL OIL TANK.
 - E10 VFW BLDG.
 - E12 MACHINE SHOP
 - E12a (1)EA. 175 GALS. MINERAL SPIRITS STORAGE TANK ON A 69 SQ.FT. CONCRETE PAD WITH 9 IN. HIGH RETAINING CURB.
 - E13 EQUIPMENT SHED.
 - E14a RADIATORS (2)ENGINE #20
 - E14b RADIATORS (2)ENGINE #21
 - E15 (1)EA. OIL SEPARATOR CONCRETE BOTTOM AND 6 FT. HIGH WALLS.
 - E16 (2)EA. 175 GALS. FUEL OIL, (1)EA. 1000 GALS. VERT. LUBE OIL STORAGE TANKS AND (2)EA. 10000 GALS. LUBE OIL TANKS ON A 1750 SQ.FT. CONCRETE PAD AND 18 IN. HIGH CONCRETE RETAINING WALL.
 - E17 (1)EA. 20,000 GALS. VERTICAL LUBE OIL STORAGE TANK ON A 625 SQ.FT. CONCRETE PAD WITH 5 FT. HIGH CONCRETE RETAINING WALLS.
 - E17a (1)EA. 500 GALS. USED OIL TANK ON A 52 SQ.FT. CONCRETE PAD WITH A 9 IN. HIGH RETAINING WALL

- E17b (1)EA. 500 GALS. USED MINERAL SPIRIT TANK.
- E17c (2)EA. 550 GALS. FUEL OIL TANKS.
- E18 (3)EA. 175 GALS. FUEL OIL TANKS AND CONC. PADS WITH 2 FT. HIGH RETAINING WALLS.
- E19 MISCELLANEOUS 55 GALS. DRUMS OPEN STORAGE AREA, 900 SQ.FT.
- E20 AIR COMPRESOR.
- E21 (2)EA. 575 GALS. VERTICAL WASTE OIL SEPARATOR TANKS.
- E22 CHEMICAL DRUMS STORAGE RACK ON 57 SQ.FT. CONCRETE PAD WITH 3 IN. HIGH CURBS.
- E23 FRESH WATER WELL WITH VERTICAL PUMP.
- E24 (5)EA. 175 GALS. FUEL OIL TANKS AND (1)EA. 1000 GALS. VERTICAL LUBE OIL TANK WITH 2 IN. HIGH RETAINING WALL
- E25 (2)EA. 175 GALS. FUEL OIL TANKS ON ONE 56 S Q. FT. CONC. PAD
- E26 (2)EA. 460 GALS. WASTE OIL SEPARATOR TANKS ON A SKID.

CITY OF HOMESTEAD
 UTILITIES
 ENGINEERING DEPARTMENT
 POWER PLANT
 SITE PLAN

REV.	PROJECT	DATE	DRAWN BY	DESIGN BY	APPROVED BY	DWG. NO.
0	MSC	7/12/91	G.F.A.	S.D.	D.K.	SP-1

FIGURE 1

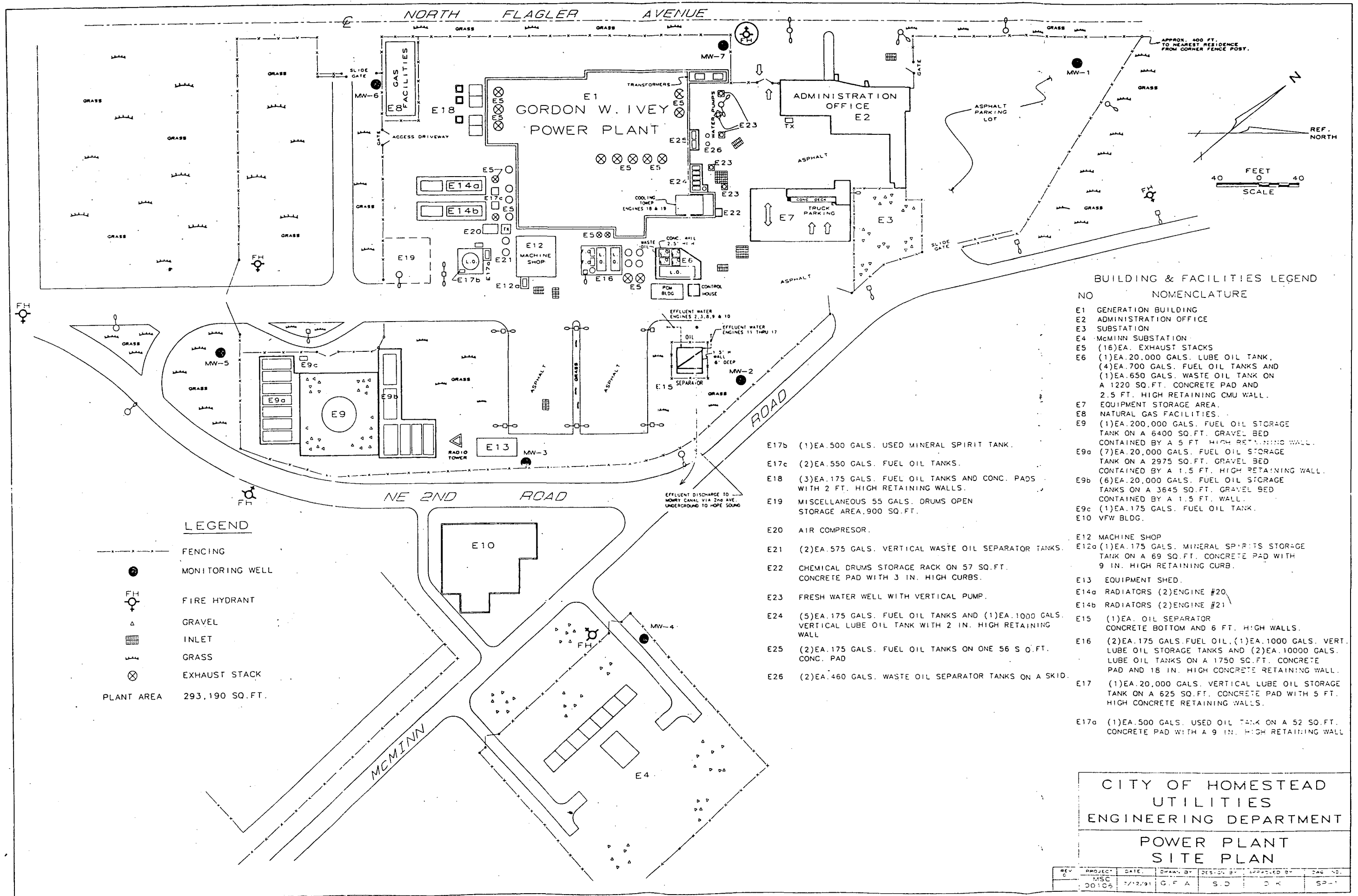

LEGEND

- FENCING
- MONITORING WELL
- FH FIRE HYDRANT
- △ GRAVEL
- ▣ INLET
- GRASS
- ⊗ EXHAUST STACK
- PLANT AREA 293,190 SQ. FT.

BUILDING & FACILITIES LEGEND

- | NO | NOMENCLATURE |
|------|--|
| E1 | GENERATION BUILDING |
| E2 | ADMINISTRATION OFFICE |
| E3 | SUBSTATION |
| E4 | McMINN SUBSTATION |
| E5 | (16)EA. EXHAUST STACKS |
| E6 | (1)EA. 20,000 GALS. LUBE OIL TANK,
(4)EA. 700 GALS. FUEL OIL TANKS AND
(1)EA. 650 GALS. WASTE OIL TANK ON
A 1220 SQ. FT. CONCRETE PAD AND
2.5 FT. HIGH RETAINING CMU WALL. |
| E7 | EQUIPMENT STORAGE AREA. |
| E8 | NATURAL GAS FACILITIES. |
| E9 | (1)EA. 200,000 GALS. FUEL OIL STORAGE
TANK ON A 6400 SQ. FT. GRAVEL BED
CONTAINED BY A 5 FT. HIGH RETAINING WALL. |
| E9a | (7)EA. 20,000 GALS. FUEL OIL STORAGE
TANK ON A 2975 SQ. FT. GRAVEL BED
CONTAINED BY A 1.5 FT. HIGH RETAINING WALL. |
| E9b | (6)EA. 20,000 GALS. FUEL OIL STORAGE
TANKS ON A 3645 SQ. FT. GRAVEL BED
CONTAINED BY A 1.5 FT. WALL. |
| E9c | (1)EA. 175 GALS. FUEL OIL TANK. |
| E10 | VFW BLDG. |
| E12 | MACHINE SHOP |
| E12a | (1)EA. 175 GALS. MINERAL SPIRITS STORAGE
TANK ON A 69 SQ. FT. CONCRETE PAD WITH
9 IN. HIGH RETAINING CURB. |
| E13 | EQUIPMENT SHED. |
| E14a | RADIATORS (2)ENGINE #20. |
| E14b | RADIATORS (2)ENGINE #21 |
| E15 | (1)EA. OIL SEPARATOR
CONCRETE BOTTOM AND 6 FT. HIGH WALLS. |
| E16 | (2)EA. 175 GALS. FUEL OIL, (1)EA. 1000 GALS. VERT.
LUBE OIL STORAGE TANKS AND (2)EA. 10000 GALS.
LUBE OIL TANKS ON A 1750 SQ. FT. CONCRETE
PAD AND 18 IN. HIGH CONCRETE RETAINING WALL. |
| E17 | (1)EA. 20,000 GALS. VERTICAL LUBE OIL STORAGE
TANK ON A 625 SQ. FT. CONCRETE PAD WITH 5 FT.
HIGH CONCRETE RETAINING WALLS. |
| E17a | (1)EA. 500 GALS. USED OIL TANK ON A 52 SQ. FT.
CONCRETE PAD WITH A 9 IN. HIGH RETAINING WALL |

- E17b (1)EA. 500 GALS. USED MINERAL SPIRIT TANK.
- E17c (2)EA. 550 GALS. FUEL OIL TANKS.
- E18 (3)EA. 175 GALS. FUEL OIL TANKS AND CONC. PADS
WITH 2 FT. HIGH RETAINING WALLS.
- E19 MISCELLANEOUS 55 GALS. DRUMS OPEN
STORAGE AREA. 900 SQ. FT.
- E20 AIR COMPRESSOR.
- E21 (2)EA. 575 GALS. VERTICAL WASTE OIL SEPARATOR TANKS.
- E22 CHEMICAL DRUMS STORAGE RACK ON 57 SQ. FT.
CONCRETE PAD WITH 3 IN. HIGH CURBS.
- E23 FRESH WATER WELL WITH VERTICAL PUMP.
- E24 (5)EA. 175 GALS. FUEL OIL TANKS AND (1)EA. 1000 GALS.
VERTICAL LUBE OIL TANK WITH 2 IN. HIGH RETAINING
WALL
- E25 (2)EA. 175 GALS. FUEL OIL TANKS ON ONE 56 S Q. FT.
CONC. PAD
- E26 (2)EA. 460 GALS. WASTE OIL SEPARATOR TANKS ON A SKID.

CITY OF HOMESTEAD
UTILITIES
ENGINEERING DEPARTMENT
**POWER PLANT
SITE PLAN**

REV	PROJECT	DATE	DRAWN BY	DESIGN BY	APPROVED BY	DWG. NO.
0	MSC	7/12/91	G.F.A.	S.D.	D.K.	SP-1

FIGURE 1