

Department of Environmental Protection

DIVISION OF AIR RESOURCES MANAGEMENT

APPLICATION FOR AIR PERMIT - LONG FORM

RECEIVED

See Instructions for Form No. 62-210.900(1)

AUG 06 1997

I. APPLICATION INFORMATION

**BUREAU OF
AIR REGULATION**

This section of the Application for Air Permit form identifies the facility and provides general information on the scope and purpose of this application. This section also includes information on the owner or authorized representative of the facility (or the responsible official in the case of a Title V source) and the necessary statements for the applicant and professional engineer, where required, to sign and date for formal submittal of the Application for Air Permit to the Department. If the application form is submitted to the Department using ELSA, this section of the Application for Air Permit must also be submitted in hard-copy.

Identification of Facility Addressed in This Application

Enter the name of the corporation, business, governmental entity, or individual that has ownership or control of the facility; the facility site name, if any; and the facility's physical location. If known, also enter the facility identification number.

1. Facility Owner/Company Name: Anderson Columbia, Inc.	
2. Site Name: Guerdon Road	
3. Facility Identification Number: [] Unknown	
4. Facility Location: Street Address or Other Locator: S. R. 41, 1 mile north of Lake City City: Lake City County: Columbia Zip Code: 32056	
5. Relocatable Facility? [x] Yes [] No	6. Existing Permitted Facility? [] Yes [x] No

Application Processing Information (DEP Use)

1. Date of Receipt of Application:	August 6, 1997
2. Permit Number:	7775042-001-AC
3. PSD Number (if applicable):	
4. Siting Number (if applicable):	

Owner/Authorized Representative or Responsible Official

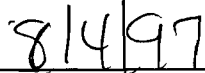
1. Name and Title of Owner/Authorized Representative or Responsible Official: Ted McRae, President
2. Owner/Authorized Representative or Responsible Official Mailing Address: Organization/Firm: Anderson Columbia, Inc. Street Address: P. O. Box 1829 City: Lake City State: Florida Zip Code: 32056
3. Owner/Authorized Representative or Responsible Official Telephone Numbers: Telephone: (904) 752 - 7585 Fax: (904) 755 - 5430
4. Owner/Authorized Representative or Responsible Official Statement: <i>I, the undersigned, am the owner or authorized representative* of the non-Title V source addressed in this Application for Air Permit or the responsible official, as defined in Rule 62-210.200, F.A.C., of the Title V source addressed in this application, whichever is applicable. I hereby certify, based on information and belief formed after reasonable inquiry, that the statements made in this application are true, accurate and complete and that, to the best of my knowledge, any estimates of emissions reported in this application are based upon reasonable techniques for calculating emissions. The air pollutant emissions units and air pollution control equipment described in this application will be operated and maintained so as to comply with all applicable standards for control of air pollutant emissions found in the statutes of the State of Florida and rules of the Department of Environmental Protection and revisions thereof. I understand that a permit, if granted by the Department, cannot be transferred without authorization from the Department, and I will promptly notify the Department upon sale or legal transfer of any permitted emissions unit.</i>  _____ Signature T. H. McRAE, President  _____ Date

* Attach letter of authorization if not currently on file.

Purpose of Application and Category

Check one (except as otherwise indicated):

Category I: All Air Operation Permit Applications Subject to Processing Under Chapter 62-213, F.A.C.

This Application for Air Permit is submitted to obtain:

[] Initial air operation permit under Chapter 62-213, F.A.C., for an existing facility which is classified as a Title V source.

[] Initial air operation permit under Chapter 62-213, F.A.C., for a facility which, upon start up of one or more newly constructed or modified emissions units addressed in this application, would become classified as a Title V source.

Current construction permit number: _____

[] Air operation permit renewal under Chapter 62-213, F.A.C., for a Title V source.

Operation permit to be renewed: _____

[] Air operation permit revision for a Title V source to address one or more newly constructed or modified emissions units addressed in this application.

Current construction permit number: _____

Operation permit to be revised: _____

[] Air operation permit revision or administrative correction for a Title V source to address one or more proposed new or modified emissions units and to be processed concurrently with the air construction permit application. Also check Category III.

Operation permit to be revised/corrected: _____

[] Air operation permit revision for a Title V source for reasons other than construction or modification of an emissions unit. Give reason for the revision; e.g., to comply with a new applicable requirement or to request approval of an "Early Reductions" proposal.

Operation permit to be revised: _____

Reason for revision: _____

Category II: All Air Operation Permit Applications Subject to Processing Under Rule 62-210.300(2)(b), F.A.C.

This Application for Air Permit is submitted to obtain:

- Initial air operation permit under Rule 62-210.300(2)(b), F.A.C., for an existing facility seeking classification as a synthetic non-Title V source.

Current operation/construction permit number(s): _____

- Renewal air operation permit under Rule 62-210.300(2)(b), F.A.C., for a synthetic non-Title V source.

Operation permit to be renewed: _____

- Air operation permit revision for a synthetic non-Title V source. Give reason for revision; e.g., to address one or more newly constructed or modified emissions units.

Operation permit to be revised: _____

Reason for revision: _____

Category III: All Air Construction Permit Applications for All Facilities and Emissions Units

This Application for Air Permit is submitted to obtain:

- Air construction permit to construct or modify one or more emissions units within a facility (including any facility classified as a Title V source).

Current operation permit number(s), if any: _____

- Air construction permit to make federally enforceable an assumed restriction on the potential emissions of one or more existing, permitted emissions units.

Current operation permit number(s): _____

- Air construction permit for one or more existing, but unpermitted, emissions units.

Application Processing Fee

Check one:

Attached - Amount: \$1,000.00

Not Applicable.

Construction/Modification Information

<p>1. Description of Proposed Project or Alterations:</p> <p>This construction permit is to allow the assembling of a mobile crushing unit and its diesel drive unit. The crushing unit will be used to crush asphalt and concrete at construction sites. The unit will be located at the Lake City plant site and will be relocated to job sites within the following counties on an as needed basis: Baker, Clay, Columbia, Dixie, Gilchrist, Hamilton, Jefferson, Lafayette, Levy, Madison, Nassau, Putnam, St. Johns, Suwannee, Taylor, Union, Monroe & Duval Counties.</p>
<p>2. Projected or Actual Date of Commencement of Construction:</p> <p>As soon as permit is granted.</p>
<p>3. Projected Date of Completion of Construction: 60 days of permit issuance</p>

Professional Engineer Certification

<p>1. Professional Engineer Name: Frank A. Darabi Registration Number: 20385</p>
<p>2. Professional Engineer Mailing Address:</p> <p>Organization/Firm: Darabi and Associates, Inc. Street Address: 730 N. E. Waldo Road City: Gainesville State: Florida Zip Code: 32641</p>
<p>3. Professional Engineer Telephone Numbers: Telephone: (352) 376 - 6533 Fax: (352) 377 - 3166</p>

4. Professional Engineer Statement:

I, the undersigned, hereby certify, except as particularly noted herein, that:*

(1) To the best of my knowledge, there is reasonable assurance that the air pollutant emissions unit(s) and the air pollution control equipment described in this Application for Air Permit, when properly operated and maintained, will comply with all applicable standards for control of air pollutant emissions found in the Florida Statutes and rules of the Department of Environmental Protection; and

(2) To the best of my knowledge, any emission estimates reported or relied on in this application are true, accurate, and complete and are either based upon reasonable techniques available for calculating emissions or, for emission estimates of hazardous air pollutants not regulated for an emissions unit addressed in this application, based solely upon the materials, information and calculations submitted with this application.

If the purpose of this application is to obtain a Title V source air operation permit (check here [] if so), I further certify that each emissions unit described in this Application for Air Permit, when properly operated and maintained, will comply with the applicable requirements identified in this application to which the unit is subject, except those emissions units for which a compliance schedule is submitted with this application.

If the purpose of this application is to obtain an air construction permit for one or more proposed new or modified emissions units (check here [] if so), I further certify that the engineering features of each such emissions unit described in this application have been designed or examined by me or individuals under my direct supervision and found to be in conformity with sound engineering principles applicable to the control of emissions of the air pollutants characterized in this application.

If the purpose of this application is to obtain an initial air operation permit or operation permit revision for one or more newly constructed or modified emissions units (check here [] if so), I further certify that, with the exception of any changes detailed as part of this application, each such emissions unit has been constructed or modified in substantial accordance with the information given in the corresponding application for air construction permit and with all provisions contained in such permit.

Eric A. Walsh 7/28/97

Signature Date

(seal)

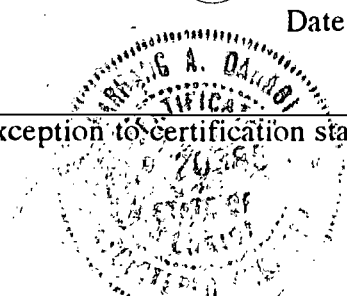

* Attach any exception to certification statement.

Application Contact

1. Name and Title of Application Contact: Scott Cleveland			
2. Application Contact Mailing Address:			
Organization/Firm:	Anderson Columbia, Inc.		
Street Address:	P. O. Box 1829		
City:	Lake City	State:	Florida
		Zip Code:	32056
3. Application Contact Telephone Numbers:			
Telephone:	(904) 752 - 7585	Fax:	(904) 755 - 3430

Application Comment

--

Facility Regulatory Classifications

1. Small Business Stationary Source? <input type="checkbox"/> Yes <input checked="" type="checkbox"/> No <input type="checkbox"/> Unknown
2. Title V Source? <input type="checkbox"/> Yes <input checked="" type="checkbox"/> No
3. Synthetic Non-Title V Source? <input type="checkbox"/> Yes <input checked="" type="checkbox"/> No
4. Major Source of Pollutants Other than Hazardous Air Pollutants (HAPs)? <input type="checkbox"/> Yes <input checked="" type="checkbox"/> No
5. Synthetic Minor Source of Pollutants Other than HAPs? <input type="checkbox"/> Yes <input checked="" type="checkbox"/> No
6. Major Source of Hazardous Air Pollutants (HAPs)? <input type="checkbox"/> Yes <input checked="" type="checkbox"/> No
7. Synthetic Minor Source of HAPs? <input type="checkbox"/> Yes <input checked="" type="checkbox"/> No
8. One or More Emissions Units Subject to NSPS? <input checked="" type="checkbox"/> Yes <input type="checkbox"/> No
9. One or More Emission Units Subject to NESHAP? <input type="checkbox"/> Yes <input checked="" type="checkbox"/> No
10. Title V Source by EPA Designation? <input type="checkbox"/> Yes <input checked="" type="checkbox"/> No
11. Facility Regulatory Classifications Comment (limit to 200 characters): NSPS subpart 000 applies

B. FACILITY REGULATIONS

Rule Applicability Analysis (Required for Category II applications and Category III applications involving non Title-V sources. See Instructions.)

Florida Administrative Code

62-4

62-210

62-296

62-297

40CFR60 subpart 000

C. FACILITY POLLUTANTS

Facility Pollutant Information

1. Pollutant Emitted	2. Pollutant Classification
PM	B

D. FACILITY POLLUTANT DETAIL INFORMATION N/A

Facility Pollutant Detail Information: Pollutant _____ of _____

1. Pollutant Emitted:		
2. Requested Emissions Cap:	(lb/hour)	(tons/year)
3. Basis for Emissions Cap Code:		
4. Facility Pollutant Comment (limit to 400 characters):		

Facility Pollutant Detail Information: Pollutant _____ of _____

1. Pollutant Emitted:		
2. Requested Emissions Cap:	(lb/hour)	(tons/year)
3. Basis for Emissions Cap Code:		
4. Facility Pollutant Comment (limit to 400 characters):		

E. FACILITY SUPPLEMENTAL INFORMATION

Supplemental Requirements for All Applications

1. Area Map Showing Facility Location: <input checked="" type="checkbox"/> Attached, Document ID: <u>001</u> <input type="checkbox"/> Not Applicable <input type="checkbox"/> Waiver Requested Portable unit - no specific site
2. Facility Plot Plan: <input checked="" type="checkbox"/> Attached, Document ID: <u>002</u> <input type="checkbox"/> Not Applicable <input type="checkbox"/> Waiver Requested
3. Process Flow Diagram(s): <input checked="" type="checkbox"/> Attached, Document ID: <u>003</u> <input type="checkbox"/> Not Applicable <input type="checkbox"/> Waiver Requested
4. Precautions to Prevent Emissions of Unconfined Particulate Matter: <input checked="" type="checkbox"/> Attached, Document ID: <u>004</u> <input type="checkbox"/> Not Applicable <input type="checkbox"/> Waiver Requested
5. Fugitive Emissions Identification: <input checked="" type="checkbox"/> Attached, Document ID: <u>Attach.003</u> <input type="checkbox"/> Not Applicable <input type="checkbox"/> Waiver Requested
6. Supplemental Information for Construction Permit Application: <input type="checkbox"/> Attached, Document ID: _____ <input checked="" type="checkbox"/> Not Applicable

Additional Supplemental Requirements for Category I Applications Only N/A

7. List of Proposed Exempt Activities: <input type="checkbox"/> Attached, Document ID: _____ <input type="checkbox"/> Not Applicable
8. List of Equipment/Activities Regulated under Title VI: <input type="checkbox"/> Attached, Document ID: _____ <input type="checkbox"/> Equipment/Activities On site but Not Required to be Individually Listed <input type="checkbox"/> Not Applicable
9. Alternative Methods of Operation: <input type="checkbox"/> Attached, Document ID: _____ <input type="checkbox"/> Not Applicable
10. Alternative Modes of Operation (Emissions Trading): <input type="checkbox"/> Attached, Document ID: _____ <input type="checkbox"/> Not Applicable

11. Identification of Additional Applicable Requirements: <input type="checkbox"/> Attached, Document ID:_____ <input type="checkbox"/> Not Applicable
12. Compliance Assurance Monitoring Plan: <input type="checkbox"/> Attached, Document ID:_____ <input type="checkbox"/> Not Applicable
13. Risk Management Plan Verification: <input type="checkbox"/> Plan Submitted to Implementing Agency - Verification Attached, Document ID:_____
<input type="checkbox"/> Plan to be Submitted to Implementing Agency by Required Date
<input type="checkbox"/> Not Applicable
14. Compliance Report and Plan: <input type="checkbox"/> Attached, Document ID:_____ <input type="checkbox"/> Not Applicable
15. Compliance Certification (Hard-copy Required): <input type="checkbox"/> Attached, Document ID:_____ <input type="checkbox"/> Not Applicable

III. EMISSIONS UNIT INFORMATION

A separate Emissions Unit Information Section (including subsections A through L as required) must be completed for each emissions unit addressed in this Application for Air Permit. If submitting the application form in hard copy, indicate, in the space provided at the top of each page, the number of this Emissions Unit Information Section and the total number of Emissions Unit Information Sections submitted as part of this application. Some of the subsections comprising the Emissions Unit Information Section of the form are intended for regulated emissions units only. Others are intended for both regulated and unregulated emissions units. Each subsection is appropriately marked.

A. TYPE OF EMISSIONS UNIT (Regulated and Unregulated Emissions Units)

Type of Emissions Unit Addressed in This Section

1. Regulated or Unregulated Emissions Unit? Check one:

The emissions unit addressed in this Emissions Unit Information Section is a regulated emissions unit.

The emissions unit addressed in this Emissions Unit Information Section is an unregulated emissions unit.

2. Single Process, Group of Processes, or Fugitive Only? Check one:

This Emissions Unit Information Section addresses, as a single emissions unit, a single process or production unit, or activity, which produces one or more air pollutants and which has at least one definable emission point (stack or vent).

This Emissions Unit Information Section addresses, as a single emissions unit, a group of process or production units and activities which has at least one definable emission point (stack or vent) but may also produce fugitive emissions.

This Emissions Unit Information Section addresses, as a single emissions unit, one or more process or production units and activities which produce fugitive emissions only.

**B. GENERAL EMISSIONS UNIT INFORMATION
(Regulated and Unregulated Emissions Units)**

Emissions Unit Description and Status

1. Description of Emissions Unit Addressed in This Section (limit to 60 characters): Diesel Drive unit for Mobile Crushing Unit		
2. Emissions Unit Identification Number: <input checked="" type="checkbox"/> No Corresponding ID <input type="checkbox"/> Unknown		
3. Emissions Unit Status Code: A	4. Acid Rain Unit? <input type="checkbox"/> Yes <input checked="" type="checkbox"/> No	5. Emissions Unit Major Group SIC Code:
6. Emissions Unit Comment (limit to 500 characters): 		

Emissions Unit Control Equipment

A. N/A

1. Description (limit to 200 characters):
2. Control Device or Method Code:

Emissions Unit Information Section _____ of _____

B.

1. Description (limit to 200 characters):

2. Control Device or Method Code:

C.

1. Description (limit to 200 characters):

2. Control Device or Method Code:

**C. EMISSIONS UNIT DETAIL INFORMATION
(Regulated Emissions Units Only)**

Emissions Unit Details

1. Initial Startup Date: N/A		
2. Long-term Reserve Shutdown Date: N/A		
3. Package Unit: D398	Manufacturer: Caterpillar	Model Number: D398
4. Generator Nameplate Rating: 500 kw	MW	
5. Incinerator Information: N/A		
	Dwell Temperature:	°F
	Dwell Time:	seconds
	Incinerator Afterburner Temperature:	°F

Emissions Unit Operating Capacity

1. Maximum Heat Input Rate:	2.8 mmBtu/hr
2. Maximum Incineration Rate:	lb/hr tons/day
3. Maximum Process or Throughput Rate:	
4. Maximum Production Rate:	
5. Operating Capacity Comment (limit to 200 characters): 20 gallons of #2 fuel oil (Diesel)/hr x 0.141 mmBtu/gallons = 2.8 mmBtu/hr	

Emissions Unit Operating Schedule

Requested Maximum Operating Schedule:		
24	hours/day	7
		days/week
52	weeks/year	2000
		hours/year

**D. EMISSIONS UNIT REGULATIONS
(Regulated Emissions Units Only)**

Rule Applicability Analysis (Required for Category II applications and Category III applications involving non Title-V sources. See Instructions.)

62-4

62-210

62-296

Emissions Unit Information Section _____ of _____

9. Actual Volumetric Flow Rate: N/A	acfm
10. Percent Water Vapor : N/A	%
11. Maximum Dry Standard Flow Rate: N/A	dscfm
12. Nonstack Emission Point Height:	8 feet
13. Emission Point UTM Coordinates: Zone: East (km): North (km):	
14. Emission Point Comment (limit to 200 characters):	

**F. SEGMENT (PROCESS/FUEL) INFORMATION
(Regulated and Unregulated Emissions Units)**

Segment Description and Rate: Segment _____ of _____

<p>1. Segment Description (Process/Fuel Type and Associated Operating Method/Mode) (limit to 500 characters): Internal Combustion Engine (Industrial/Distillate Oil (Diesel)/Reciprocating</p>	
<p>2. Source Classification Code (SCC): 2-02-001-02</p>	
<p>3. SCC Units: Thousand Gallons Burned</p>	
<p>4. Maximum Hourly Rate: 0.02</p>	<p>5. Maximum Annual Rate: 40</p>
<p>6. Estimated Annual Activity Factor: N/A</p>	
<p>7. Maximum Percent Sulfur: 0.5</p>	<p>8. Maximum Percent Ash: N/A</p>
<p>9. Million Btu per SCC Unit: 141</p>	
<p>10. Segment Comment (limit to 200 characters): 20 gal/hr x 2000 hrs/yr = 40,000 gal/yr</p>	

Segment Description and Rate: Segment _____ of _____

1. Segment Description (Process/Fuel Type and Associated Operating Method/Mode) (limit to 500 characters):	
2. Source Classification Code (SCC):	
3. SCC Units:	
4. Maximum Hourly Rate:	5. Maximum Annual Rate:
6. Estimated Annual Activity Factor:	
7. Maximum Percent Sulfur:	8. Maximum Percent Ash:
9. Million Btu per SCC Unit:	
10. Segment Comment (limit to 200 characters):	

**G. EMISSIONS UNIT POLLUTANTS
(Regulated and Unregulated Emissions Units)**

1. Pollutant Emitted	2. Primary Control Device Code	3. Secondary Control Device Code	4. Pollutant Regulatory Code
NO _x			NS
CO <5 TPY			
SO ₂ <5 TPY			
VOC <5 TPY			
PM, PM ₁₀ <5 TPY			

**H. EMISSIONS UNIT POLLUTANT DETAIL INFORMATION
(Regulated Emissions Units Only - Emissions Limited Pollutants Only)**

Pollutant Detail Information:

1. Pollutant Emitted: NO _x
2. Total Percent Efficiency of Control: %
3. Potential Emissions: 12.44 lb/hour tons/year
4. Synthetically Limited? <input checked="" type="checkbox"/> Yes <input type="checkbox"/> No
5. Range of Estimated Fugitive/Other Emissions: N/A <input type="checkbox"/> 1 <input type="checkbox"/> 2 <input type="checkbox"/> 3 _____ to _____ tons/year
6. Emission Factor: 4.41 lbs/mmBtu Reference: AP429 5th Edition, Table 3.3-2
7. Emissions Method Code: <input type="checkbox"/> 0 <input type="checkbox"/> 1 <input type="checkbox"/> 2 <input checked="" type="checkbox"/> 3 <input type="checkbox"/> 4 <input type="checkbox"/> 5
8. Calculation of Emissions (limit to 600 characters): <u>Hourly</u> 20 gph x 0.141 mmBtu/gal x 4.41 lb/mmBtu = 12.44 lbs/hr <u>Annual</u> 12.44 lbs/hr x 2000 hrs/yr x 1/2000 tons/lb = 12.44 TPY
9. Pollutant Potential/Estimated Emissions Comment (limit to 200 characters): The hours of operation is limited by permittee

Allowable Emissions (Pollutant identified on front of page) N/A

A.

1. Basis for Allowable Emissions Code:		
2. Future Effective Date of Allowable Emissions:		
3. Requested Allowable Emissions and Units:		
4. Equivalent Allowable Emissions:	lb/hour	tons/year
5. Method of Compliance (limit to 60 characters):		
6. Pollutant Allowable Emissions Comment (Desc. of Related Operating Method/Mode) (limit to 200 characters):		

B.

1. Basis for Allowable Emissions Code:		
2. Future Effective Date of Allowable Emissions:		
3. Requested Allowable Emissions and Units:		
4. Equivalent Allowable Emissions:	lb/hr	tons/year
5. Method of Compliance (limit to 60 characters):		
6. Pollutant Allowable Emissions Comment (Desc. of Related Operating Method/Mode) (limit to 200 characters):		

**I. VISIBLE EMISSIONS INFORMATION
(Regulated Emissions Units Only)**

Visible Emissions Limitation: Visible Emissions Limitation _____ of _____

1. Visible Emissions Subtype: VE20	
2. Basis for Allowable Opacity:	<input checked="" type="checkbox"/> Rule <input type="checkbox"/> Other <small>62-296.320 FAC</small>
3. Requested Allowable Opacity:	Normal Conditions: 20 % Exceptional Conditions: % Maximum Period of Excess Opacity Allowed: min/hour
4. Method of Compliance: VE Test	
5. Visible Emissions Comment (limit to 200 characters):	

Visible Emissions Limitation: Visible Emissions Limitation _____ of _____

1. Visible Emissions Subtype:	
2. Basis for Allowable Opacity:	<input type="checkbox"/> Rule <input type="checkbox"/> Other
3. Requested Allowable Opacity:	Normal Conditions: % Exceptional Conditions: % Maximum Period of Excess Opacity Allowed: min/hour
4. Method of Compliance:	
5. Visible Emissions Comment (limit to 200 characters):	

J. CONTINUOUS MONITOR INFORMATION N/A
(Regulated Emissions Units Only)

Continuous Monitoring System: Continuous Monitor _____ of _____

1. Parameter Code:	2. Pollutant(s):
3. CMS Requirement:	<input type="checkbox"/> Rule <input type="checkbox"/> Other
4. Monitor Information: Manufacturer: Model Number: Serial Number:	
5. Installation Date:	
6. Performance Specification Test Date:	
7. Continuous Monitor Comment (limit to 200 characters):	

Continuous Monitoring System: Continuous Monitor _____ of _____

1. Parameter Code:	2. Pollutant(s):
3. CMS Requirement:	<input type="checkbox"/> Rule <input type="checkbox"/> Other
4. Monitor Information: Manufacturer: Model Number: Serial Number:	
5. Installation Date:	
6. Performance Specification Test Date:	
7. Continuous Monitor Comment (limit to 200 characters):	

**K. PREVENTION OF SIGNIFICANT DETERIORATION (PSD) INCREMENT
TRACKING INFORMATION
(Regulated and Unregulated Emissions Units)**

PSD Increment Consumption Determination

1. Increment Consuming for Particulate Matter or Sulfur Dioxide?

If the emissions unit addressed in this section emits particulate matter or sulfur dioxide, answer the following series of questions to make a preliminary determination as to whether or not the emissions unit consumes PSD increment for particulate matter or sulfur dioxide. Check the first statement, if any, that applies and skip remaining statements.

-] The emissions unit is undergoing PSD review as part of this application, or has undergone PSD review previously, for particulate matter or sulfur dioxide. If so, emissions unit consumes increment.

-] The facility addressed in this application is classified as an EPA major source pursuant to paragraph (c) of the definition of "major source of air pollution" in Chapter 62-213, F.A.C., and the emissions unit addressed in this section commenced (or will commence) construction after January 6, 1975. If so, baseline emissions are zero, and emissions unit consumes increment.

-] The facility addressed in this application is classified as an EPA major source, and the emissions unit began initial operation after January 6, 1975, but before December 27, 1977. If so, baseline emissions are zero, and emissions unit consumes increment.

-] For any facility, the emissions unit began (or will begin) initial operation after December 27, 1977. If so, baseline emissions are zero, and emissions unit consumes increment.

-] None of the above apply. If so, the baseline emissions of the emissions unit are nonzero. In such case, additional analysis, beyond the scope of this application, is needed to determine whether changes in emissions have occurred (or will occur) after the baseline date that may consume or expand increment.

2. Increment Consuming for Nitrogen Dioxide?

If the emissions unit addressed in this section emits nitrogen oxides, answer the following series of questions to make a preliminary determination as to whether or not the emissions unit consumes PSD increment for nitrogen dioxide. Check first statement, if any, that applies and skip remaining statements.

-] The emissions unit addressed in this section is undergoing PSD review as part of this application, or has undergone PSD review previously, for nitrogen dioxide. If so, emissions unit consumes increment.
-] The facility addressed in this application is classified as an EPA major source pursuant to paragraph (c) of the definition of "major source of air pollution" in Chapter 62-213, F.A.C., and the emissions unit addressed in this section commenced (or will commence) construction after February 8, 1988. If so, baseline emissions are zero, and emissions unit consumes increment.
-] The facility addressed in this application is classified as an EPA major source, and the emissions unit began initial operation after February 8, 1988, but before March 28, 1988. If so, baseline emissions are zero, and emissions unit consumes increment.
-] For any facility, the emissions unit began (or will begin) initial operation after March 28, 1988. If so, baseline emissions are zero, and emissions unit consumes increment.
-] None of the above apply. If so, the baseline emissions of the emissions unit are nonzero. In such case, additional analysis, beyond the scope of this application, is needed to determine whether changes in emissions have occurred (or will occur) after the baseline date that may consume or expand increment.

3. Increment Consuming/Expanding Code:		
PM	<input type="checkbox"/>] C	<input type="checkbox"/>] E <input type="checkbox"/>] Unknown
SO2	<input type="checkbox"/>] C	<input type="checkbox"/>] E <input type="checkbox"/>] Unknown
NO2	<input type="checkbox"/>] C	<input type="checkbox"/>] E <input type="checkbox"/>] Unknown
4. Baseline Emissions:		
PM	lb/hour	tons/year
SO2	lb/hour	tons/year
NO2		tons/year
5. PSD Comment (limit to 200 characters):		

**L. EMISSIONS UNIT SUPPLEMENTAL INFORMATION
(Regulated Emissions Units Only)**

Supplemental Requirements for All Applications

1. Process Flow Diagram <input type="checkbox"/> Attached, Document ID: _____ <input type="checkbox"/> Not Applicable <input type="checkbox"/> Waiver Requested
2. Fuel Analysis or Specification <input type="checkbox"/> Attached, Document ID: _____ <input type="checkbox"/> Not Applicable <input type="checkbox"/> Waiver Requested
3. Detailed Description of Control Equipment <input type="checkbox"/> Attached, Document ID: _____ <input type="checkbox"/> Not Applicable <input type="checkbox"/> Waiver Requested
4. Description of Stack Sampling Facilities <input type="checkbox"/> Attached, Document ID: _____ <input type="checkbox"/> Not Applicable <input type="checkbox"/> Waiver Requested
5. Compliance Test Report <input type="checkbox"/> Attached, Document ID: _____ <input type="checkbox"/> Previously submitted, Date: _____ <input type="checkbox"/> Not Applicable
6. Procedures for Startup and Shutdown <input type="checkbox"/> Attached, Document ID: _____ <input type="checkbox"/> Not Applicable
7. Operation and Maintenance Plan <input type="checkbox"/> Attached, Document ID: _____ <input type="checkbox"/> Not Applicable
8. Supplemental Information for Construction Permit Application <input type="checkbox"/> Attached, Document ID: _____ <input type="checkbox"/> Not Applicable
9. Other Information Required by Rule or Statute <input type="checkbox"/> Attached, Document ID: _____ <input type="checkbox"/> Not Applicable

Additional Supplemental Requirements for Category I Applications Only

10. Alternative Methods of Operation <input type="checkbox"/> Attached, Document ID: _____ <input type="checkbox"/> Not Applicable
11. Alternative Modes of Operation (Emissions Trading) <input type="checkbox"/> Attached, Document ID: _____ <input type="checkbox"/> Not Applicable
12. Identification of Additional Applicable Requirements <input type="checkbox"/> Attached, Document ID: _____ <input type="checkbox"/> Not Applicable
13. Compliance Assurance Monitoring Plan <input type="checkbox"/> Attached, Document ID: _____ <input type="checkbox"/> Not Applicable
14. Acid Rain Application (Hard-copy Required) <input type="checkbox"/> Acid Rain Part - Phase II (Form No. 62-210.900(1)(a)) Attached, Document ID: _____ <input type="checkbox"/> Repowering Extension Plan (Form No. 62-210.900(1)(a)1.) Attached, Document ID: _____ <input type="checkbox"/> New Unit Exemption (Form No. 62-210.900(1)(a)2.) Attached, Document ID: _____ <input type="checkbox"/> Retired Unit Exemption (Form No. 62-210.900(1)(a)3.) Attached, Document ID: _____ <input type="checkbox"/> Not Applicable

ATTACHMENT 001

LAKE CITY WEST QUADRANGLE
FLORIDA-COLUMBIA CO.
7.5 MINUTE SERIES (TOPOGRAPHIC)

25 MI. SPRINGS 7 MI. 40' R. 16 E. R. 17 E. 341 BENTON 16 MI. 2 590 000 FEET 82° 37' 30"

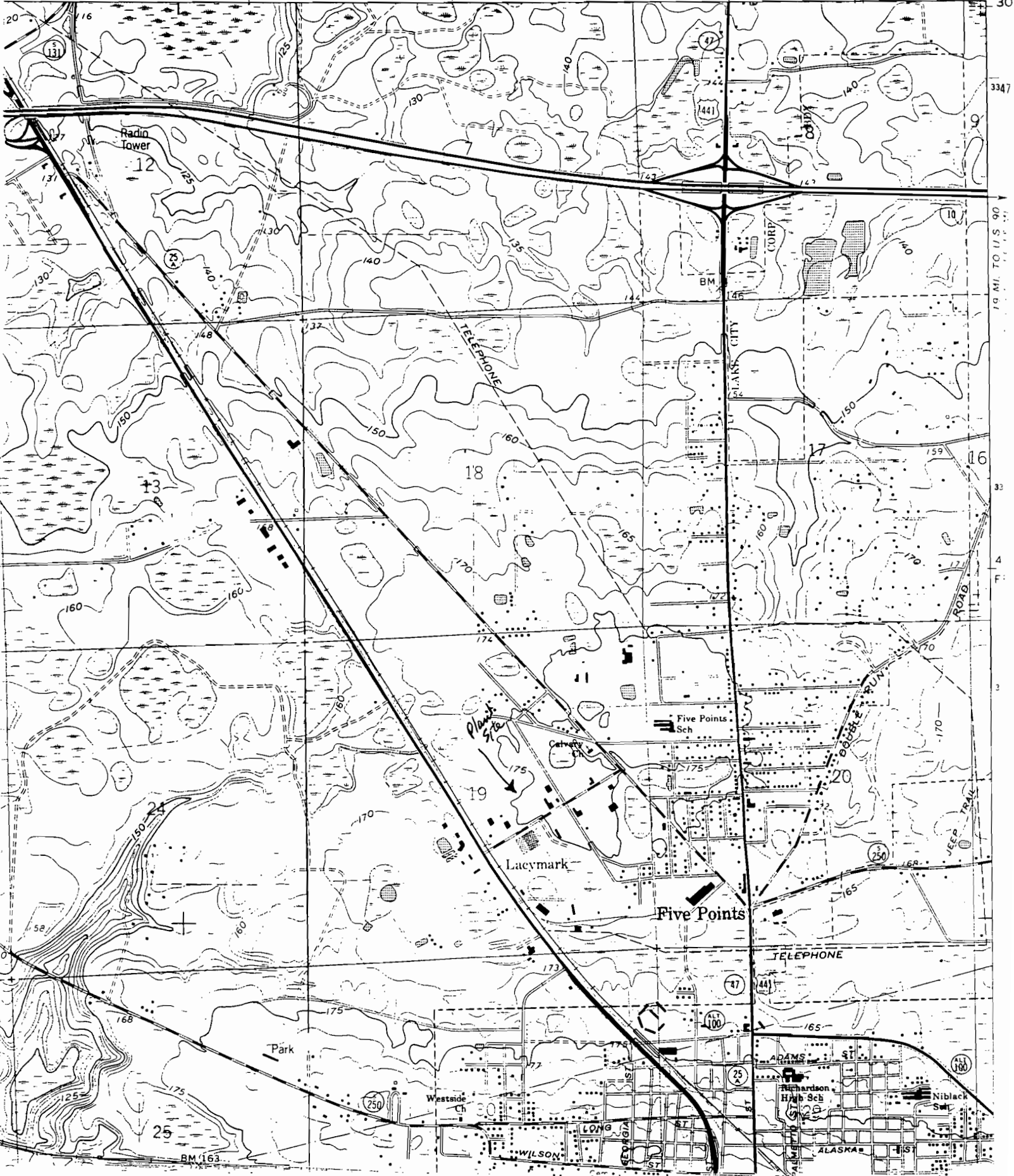

ATTACHMENT 002

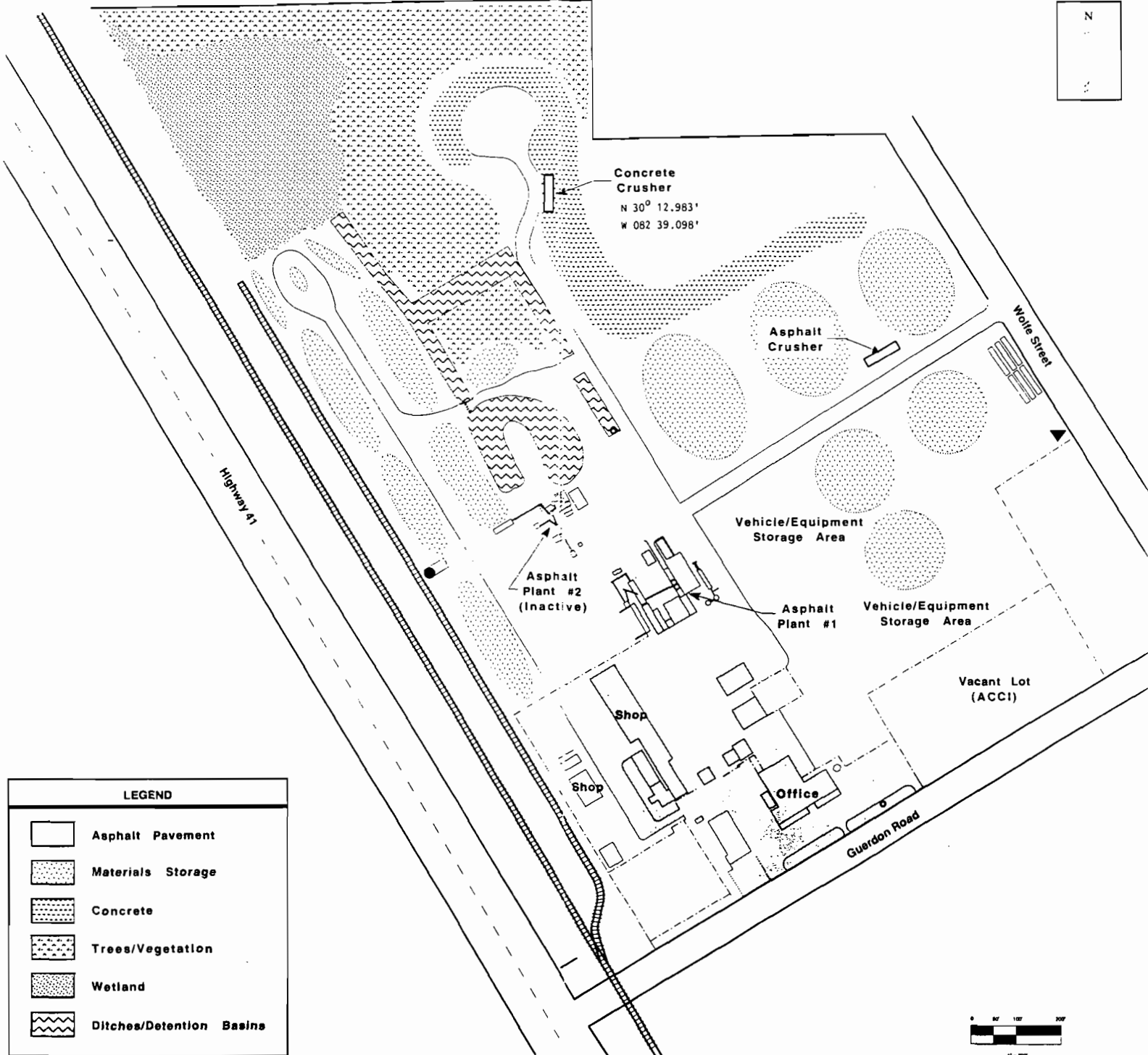

Attachment 003

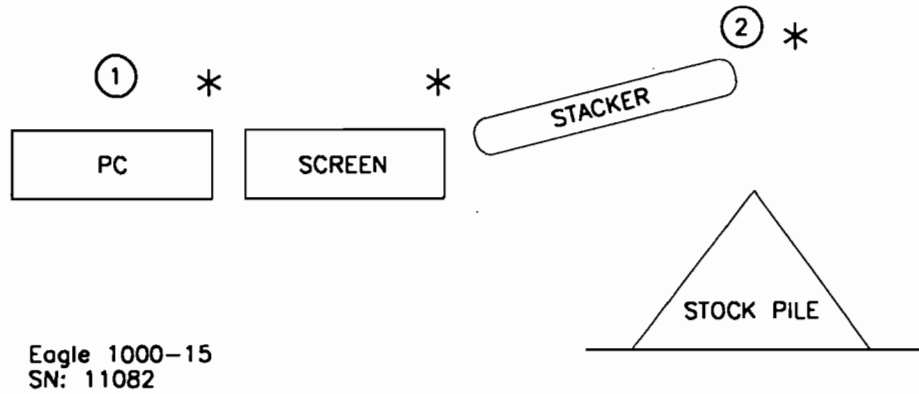

Eagle 1000-15
SN: 11082

SPREAD 03



LEGEND

- PC Primary Crusher
- * Emission Points

Anderson Columbia, Inc
Crusher No 1

**DARABI
AND
ASSOCIATES, INC.**
Environmental Consultants

Attachment 004

Precaution to Prevent Emission of Uncombined Particles

1. All unpaved roads at access ramps to be altered as necessary to minimize fugitive emission.
2. The concrete is to be wetted prior to the crushing operation.
3. Apply spray mist at the Hammer location.