



Department of Environmental Protection

Lawton Chiles
Governor

Twin Towers Office Building
2600 Blair Stone Road
Tallahassee, Florida 32399-2400

Virginia B. Wetherell
Secretary

Notice of Permit Amendment

In the matter of an
Application for Permit by:

DEP File No. 7770253-005-AO
Portable Unit

Mr. Michael Slade
Executive Vice President
Ranger Construction Industries, Inc.
Post Office Box 15065
West Palm Beach, Florida 33416-5056

Enclosed is an amendment to Operation Permit Number 7770253-005-AO for a portable recyclable asphalt crusher plant. This permit amendment authorizes operation of this plant at 1200 Elboc Way, Winter Garden, Orange County, Florida. This permit is issued pursuant to Section 403, Florida Statutes.

Any party to this Order (permit) has the right to seek judicial review of the permit pursuant to Section 120.68, Florida Statutes, by filing of a Notice of Appeal pursuant to Rule 9.110, Florida Rules of Appellate Procedure, with the Clerk of the Department in the Office of General Counsel, 2600 Blair Stone Road, Tallahassee, Florida 32399-2400; and by filing a copy of the Notice of Appeal accompanied by the applicable filing fees with the appropriate District Court of Appeal. The Notice of Appeal must be filed within 14 days from the date this Notice is filed with the Clerk of the Department.

Executed in Tallahassee, Florida.

STATE OF FLORIDA DEPARTMENT
OF ENVIRONMENTAL PROTECTION

C. H. Fancy, P.E., Chief
Bureau of Air Regulation
2600 Blair Stone Road
Tallahassee, Florida 32399-2400
904-488-1344

Ranger Construction Industries, Inc.

Permit No. 7770253-005-AO

CERTIFICATE OF SERVICE

The undersigned duly designated deputy clerk hereby certifies that this NOTICE OF PERMIT AMENDMENT (including the permit amendment) was mailed by certified mail(*) and that all copies were mailed by U.S. mail before the close of business on 9-10-96 to the following:

Michael Slade, Ranger Construction Industries, Inc.*

District Air Program Administrators
County Air Program Administrators

Clerk Stamp

FILING AND ACKNOWLEDGMENT

FILED, on this date, pursuant to §120.52(11), Florida Statutes, with the designated Department Clerk, receipt of which is hereby acknowledged.

Kenn Jober

Clerk

9-10-96

Date

Final Determination
Operation Permit Amendment

Ranger Construction Industries, Inc.
Permit No. 7770253-005-AO

An Intent to Issue an air permit amendment to allow Ranger Construction Industries, Inc., P.O. Box 15065, West Palm Beach, Florida 33416-5065, to operate their portable 150 TPH Astec Recyclable Asphalt Crusher Plant at 1200 Elboc Way, Winter Garden, Orange County, Florida, was distributed on August 19, 1996. The Public Notice of Intent to Issue Air Permit Amendment was published in the Orlando Sentinel on August 26, 1996.

Copies of the Evaluation were available for public inspection at the Department's offices in Tallahassee and Orlando and at the Orange County Environmental Protection Department in Orlando.

No comments were submitted on the Department's intent to amend the permit. The final action of the Department will be to issue the permit amendment as proposed.

Fold at line over top of envelope to

Is your RETURN ADDRESS completed on the reverse side?	SENDER: <ul style="list-style-type: none">• Complete items 1 and/or 2 for additional services.• Complete items 3, and 4a & b.• Print your name and address on the reverse of this form so that we can return this card to you.• Attach this form to the front of the mailpiece, or on the back if space does not permit.• Write "Return Receipt Requested" on the mailpiece below the article number.• The Return Receipt will show to whom the article was delivered and the date delivered.	I also wish to receive the following services (for an extra fee): <ul style="list-style-type: none">1. <input type="checkbox"/> Addressee's Address2. <input type="checkbox"/> Restricted Delivery Consult postmaster for fee.
	3. Article Addressed to: Michael Glade, Exe, V.P. Ranger Construction PO Box 15065 West Palm Bch, FL 33416-5056	4a. Article Number P339 251151
4b. Service Type <ul style="list-style-type: none"><input type="checkbox"/> Registered<input checked="" type="checkbox"/> Certified<input type="checkbox"/> Express Mail	<input type="checkbox"/> Insured <input type="checkbox"/> COD <input type="checkbox"/> Return Receipt for Merchandise	
5. Signature (Addressee) <i>[Signature]</i>	7. Date of Delivery SEP 11 1996	
6. Signature (Agent) <i>[Signature]</i>	8. Addressee's Address Only if requested and fee is paid	

PS Form 3811, December 1991 U.S. GPO: 1993-352-714 DOMESTIC RETURN RECEIPT

P. 339 251 151

US Postal Service
Receipt for Certified Mail
No Insurance Coverage Provided.
Do not use for International Mail (See reverse)

Postmark or Date: 9-10-96

Postage	\$
Certified Fee	
Special Delivery Fee	
Restricted Delivery Fee	
Return Receipt Showing to Whom & Date Delivered	
Return Receipt Showing to Whom, Date & Addressee's Address	
TOTAL Postage & Fees	\$

Post Office, Street & ZIP Code: W.P.B., FL 33416

Signature & Number: Michael Glade

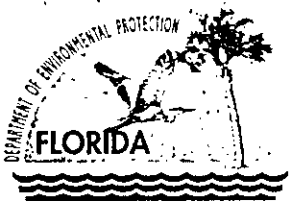

Department of Environmental Protection

Lawton Chiles
Governor

Twin Towers Office Building
2600 Blair Stone Road
Tallahassee, Florida 32399-2400

Virginia B. Wetherell
Secretary

September 9, 1996

CERTIFIED MAIL - RETURN RECEIPT REQUESTED

Mr. Michael Slade
Executive Vice President
Ranger Construction Industries, Inc.
Post Office Box 15065
West Palm Beach, Florida 33416-5056

Re: Permit Amendment No. 7770253-005-AO
Portable Recyclable Asphalt Crusher

The Department has reviewed your August 1 letter requesting the referenced air permit be amended to authorize operation of your portable recyclable asphalt crusher plant at 1200 Elboc Way, Winter Garden, Orange County, Florida. This request is acceptable and permit No. 7770253-005-AO is amended as follows:

FROM

Authorization to operate a portable Astec recyclable asphalt crusher plant (Model 45R, Serial No. 121M 5761) consisting of a 150 TPH crusher, Tyler screen, associated conveyers, 402 hp Caterpillar diesel engine, and associated equipment. Fugitive particulate matter emissions will be controlled by wetting the asphalt material being processed.

The plant is permitted to operate at:

95th Avenue, Royal Palm Beach, Palm Beach County, FL
4510 Glades Cut-Off Road, Ft. Pierce, St. Lucie County, FL
4210 Old Dixie Hwy., Grant, Brevard County, FL
2600 State Road 60 W, Bartow, Polk County, FL
18300 Northwest 122 Ave., Medley, Dade County, FL
2501 Northwest 48th Street, Pompano Beach, Broward County, FL

This plant may operate at other industrial and road/parking lot replacement sites within Florida after completing the public notice requirements for the new site(s) and obtaining an amendment for the facility's permit.

Mr. Michael Slade
Page Two
September 9, 1996

The plant shall be operated in accordance with the permit application, plans, documents, amendments and drawings, except as otherwise noted in the General and Specific Conditions.

TO

Authorization to operate a portable Astec recyclable asphalt crusher plant (Model 45R, Serial No. 121M 5761) consisting of a 150 TPH crusher, Tyler screen, associated conveyers, 402 hp Caterpillar diesel engine, and associated equipment. Fugitive particulate matter emissions will be controlled by wetting the asphalt material being processed.

The plant is permitted to operate at:

95th Avenue, Royal Palm Beach, Palm Beach County, FL
4510 Glades Cut-Off Road, Ft. Pierce, St. Lucie County, FL
4210 Old Dixie Hwy., Grant, Brevard County, FL
2600 State Road 60 W, Bartow, Polk County, FL
18300 Northwest 122 Ave., Medley, Dade County, FL
2501 Northwest 48th Street, Pompano Beach, Broward County, FL
1200 Elboc Way, Winter Garden, Orange County, FL

This plant may operate at other industrial and road/parking lot replacement sites within Florida after completing the public notice requirements for the new site(s) and obtaining an amendment for the facility's permit.

The plant shall be operated in accordance with the permit application, plans, documents, amendments and drawings, except as otherwise noted in the General and Specific Conditions.

A copy of this letter shall be filed with permit No. 7770253-004-AO and shall become a condition of that permit.

Sincerely,

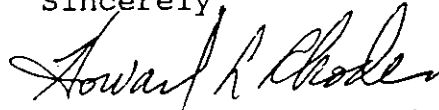

Howard L. Rhodes, Director
Division of Air Resources
Management

HLR/wh/t

Enclosure: Ranger's August 1, 1996 letter



Ranger

Construction
Industries, Inc.
WEST PALM BEACH, FLORIDA

RECEIVED

August 1, 1996

AUG 5 1996

BUREAU OF
AIR REGULATION

Mr. Willard Hanks
Florida Dept. of Environmental Protection
Twin Towers Office Building
2600 Blair Stone Road
Tallahassee, Florida 32399-2400

Re: Permit No. 7770253-004-AO
Portable Unit

Dear Mr. Hanks:

We would like to amend the above referenced permit to operate a portable Astec recyclable asphalt crusher to include the following location:

1200 Elboc Way
Winter Garden, Florida
Orange County, 34787
Latitude: 28° 33' - 10" N.
Longitude: 81° 33' - 45" W.

All general conditions and specific conditions will be adhered to as set forth in our present permit.

Enclosed is our check for \$250.00 and a location map of the new requested location.

Very truly yours,

Michael Slade
Executive Vice President

MS/ale/c:slade/crusher1

cc: Central Dist.
Orange Co.
Willard Hanks

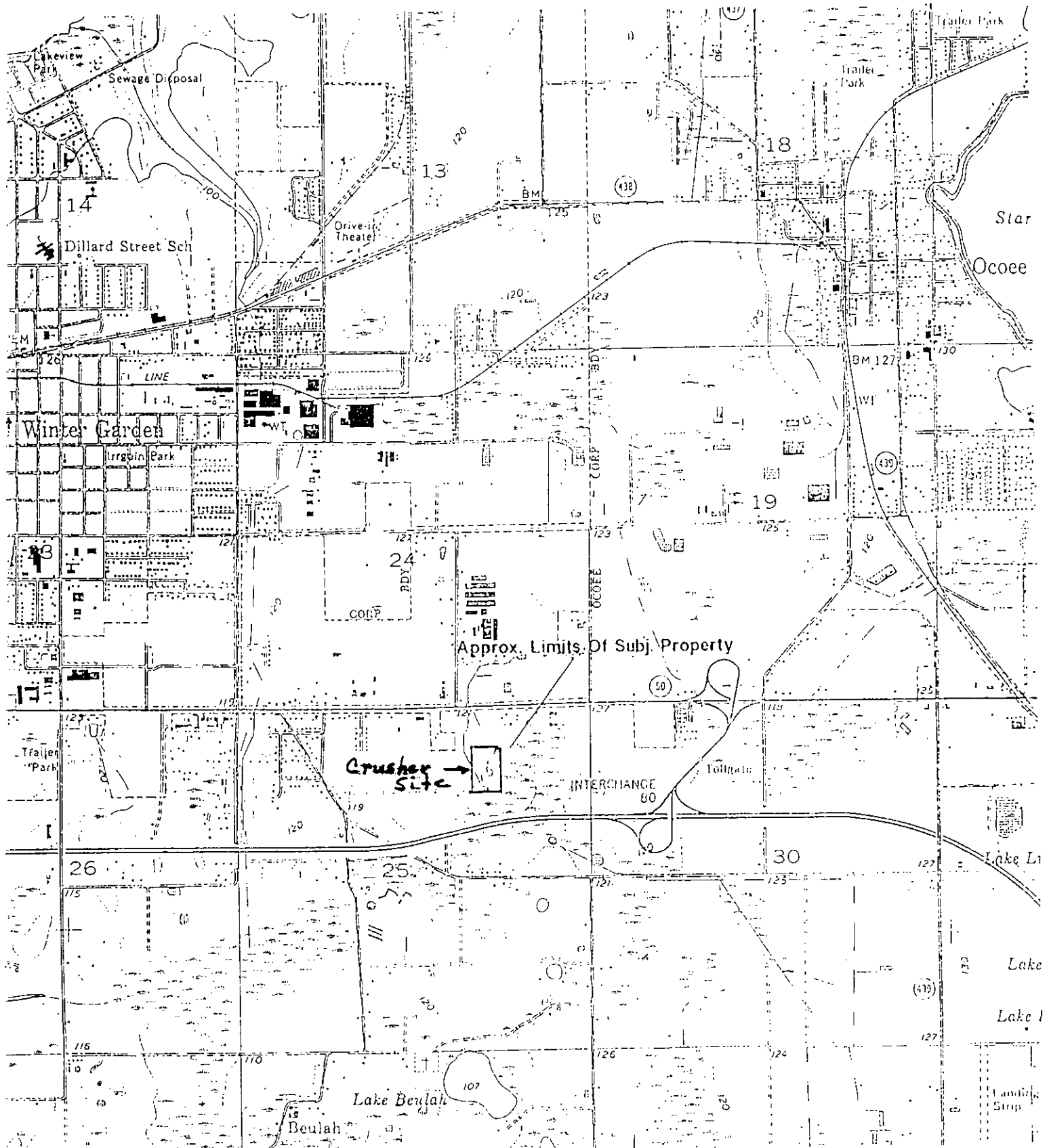

Florida Department of
Environmental Protection

Memorandum

BAR

To: Howard L. Rhodes
Thru: Clair Fancy *CHD*
Al Linero *af 9/6*
From: Willard Hanks
Date: September 5, 1996
Subject: Issuance of Permit Amendment (77702)
Ranger Construction Industries, Inc.

18

Attached for your approval and signature is a letter that will amend the permit to operate a portable recyclable asphalt crusher plant.

The plant, consisting of a crusher, screen, diesel engine, and associated conveyers, operates at existing asphalt plants. The unit is currently permitted to operate at sites in Brevard, Broward, Dade, Palm Beach, Polk, and St. Lucie Counties. This amendment will allow it to operate at a site in Orange County.

No comments were submitted in response to the public notice for this amendment.

I recommend your approval and signature of the attached permit to operate.

AAL/wh/t