



Environmental  
Sciences  
Group

---

October 10, 2008

Mr. Joseph Graham  
Florida Department of Environmental Protection  
13051 Telecom Parkway  
Temple Terrace, Florida 33637

Dept. of Environmental  
Protection

OCT 15 2008

**RE: PRIDE Enterprises  
Sumter Furniture  
9544 CR 476B  
Bushnell, Sumter County, Florida  
Facility # 1190015**

**Southwest District**

**CERTIFIED MAIL- RETURN RECEIPT REQUESTED**

**Article Number: 7007-2680 0000 1952 7839**

Dear Mr. Graham:

This letter is written in response to your letter dated August 14, 2008. The responses will assume the numerology of that letter.

1. A copy of the VOC records from September 2007 to September 2008 is attached. A copy of the daily operation times is also attached. Please note that the Spray Booth designations are not used by the facility since lacquer was removed from the process. There are currently five spray booths in the Spray Area. Since lacquer coatings were removed from the process, the configuration of the spray booths was rearranged. Spray Booth A originally handled wipe stain, Spray Booth B originally handled a toner, Spray Booth C originally handled sealer, Spray Booth D and E originally handled touch up or special processes before the lacquer, Spray Booth H originally handled lacquer, and Spray Booth F originally handled all other chemicals used in the process. There are currently five spray booths in the spray area and one spray booth in the laminating area. In the spray area, one booth is used for stain, one booth is used for sealer, one booth used to scuff sand the sealer prior to conversion varnish, one booth is used for the conversion varnish and one booth is not used. Since one of the booths is no longer used, it will be removed in the near future. The laminating booth will be relocated to the spray area in the near future. Based on the need to continually evaluate materials and methodology, PRIDE is requesting that the spray booth

---

P.O. Box 7495  
Tampa, Florida 33673-7495  
Telephone: (813) 930-9074  
FAX: (813) 935-1167

- designations (A, B, C, D, E, F, and H) be removed from the new permit and simply state that spray booths are used in the wood surfacing operation.
2. A current process flow diagram is attached. Raw materials are received in the receiving area and sent to the panel saw for cutting of the wood blanks. Some of the material may go to the laminating area for surfacing with a laminate. Some of the material will go directly to the parts processing area for assembly. Material that has been laminated would also flow to this area. Products that require finishing would go to the spray area for staining, sealing and conversion varnish top coating. These finished products go to a heat tunnel for drying and flow to the shipping department for packaging and shipping.
  3. A site plan is attached showing the current floor plan and configurations.

If you have any questions concerning this submittal, please do not hesitate to call me at (813) 930-9074.

Sincerely,

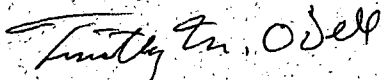

Timothy M. O'Dell  
Environmental Scientist

cc: Kip Fisher, PRIDE

Dept. of Environmental  
Protection

OCT 15 2008

Southwest District

Date  
September 2008

Sumter Furniture  
Facility 90015  
Permit # 1 5-002-AF

Emission Unit  
Wood Surface Coating 001

	Sept-07	Oct-07	Nov-07	Dec-07	Jan-08	Feb-08	Mar-08	Apr-08	May-08	June-08	July-08	Aug-08	Sep-08
<b>Material Usage</b>													
Dye Stain	0	0	0	0	0	0	3	5	10	0	0	0	0
Wiping Stain	0	0	0	0	0	0	6	5	0	0	0	0	0
Conversion Varnish	25	75	35	45	53.5	20	52.5	32.5	35	55	84	25	35
Conversion Varnish Catalyst	0.68493	2.05479	0.9589	1.2329	1.4658	0.5479	1.4384	0.8904	0.9589	1.5068	2.3017	0.6849	0.9589
Vinyl Sealer	20	65	30	35	40	20	35	25	35	55	15	15	35
Vinyl Sealer Catalyst	0.54795	1.78082	0.87192	0.9589	1.0959	0.5479	0.9589	0.6849	0.9589	1.5068	1.5068	0.41096	0.9589
Lacquer Thinner	141.5	223	112	105.5	155.5	83	81	108	114	124	73	73.25	67
Contact Cement	67	150	135	135	127	28	155	132	114	138	37	70	68
Universal Dye	0.02	0.02	0.02	0.02	0.02	0.02	0	0	0	0.02	0.02	0.02	0.02
<b>Emissions</b>													
Dye Stain, lb	0.00	0.00	0.00	0.00	0.00	0.00	0.75	1.25	2.50	0.00	0.00	0.00	0.00
Wiping Stain, lb	0.00	0.00	0.00	0.00	0.00	0.00	33.78	28.15	0.00	0.00	0.00	0.00	0.00
Conversion Varnish, lb	106.50	319.50	149.10	191.70	227.91	85.20	223.65	138.45	149.10	234.30	357.84	106.50	149.10
Conversion Varnish Catalyst, lb	3.32	9.97	4.65	5.98	7.11	2.66	6.98	4.32	4.65	7.31	11.16	3.32	4.65
Vinyl Sealer, lb	99.00	321.75	148.50	173.25	198.00	99.00	173.25	123.75	173.25	272.25	272.25	74.25	173.25
Vinyl Sealer Catalyst, lb	3.13	10.17	4.98	5.48	6.26	3.13	5.48	3.91	5.48	8.60	8.60	2.35	5.48
Lacquer Thinner, lb	932.49	1469.57	738.08	695.25	1024.75	546.97	533.79	711.72	751.26	817.16	481.07	482.72	441.53
Contact Cement, lb	359.79	805.50	724.95	724.95	681.99	150.36	832.35	708.84	612.18	741.06	198.69	375.90	365.16
Universal Dye, lb	0.12	0.12	0.12	0.12	0.12	0.12	0.00	0.00	0.00	0.12	0.12	0.12	0.12
<b>Total VOC</b>	<b>1504.35</b>	<b>2936.58</b>	<b>1770.38</b>	<b>1796.72</b>	<b>2146.13</b>	<b>887.44</b>	<b>1810.02</b>	<b>1720.39</b>	<b>1698.42</b>	<b>2080.80</b>	<b>1329.74</b>	<b>1045.16</b>	<b>1139.29</b>
<b>HAP Emissions</b>													
Ethylbenzene, lb	2.58	7.94	3.69	4.81	5.41	2.23	5.14	3.32	3.89	6.12	8.18	2.38	3.89
Xylene, lb	17.27	53.00	24.65	30.84	36.28	14.77	34.58	22.21	25.85	40.63	55.08	16.06	25.85
Methanol, lb	3.56	10.68	4.98	6.41	7.62	2.85	7.48	4.63	4.98	7.83	11.96	3.56	4.98
Toluene, lb	299.88	639.72	518.48	518.33	517.63	143.02	573.63	503.75	452.32	548.34	188.49	275.51	277.46
Hexane, lb	111.56	249.75	224.78	224.78	211.46	46.62	258.08	219.78	189.81	0.00	61.61	116.55	113.22
MIBK, lb	32.10	151.84	35.66	43.23	75.57	15.12	38.82	31.92	36.31	62.14	56.24	16.68	21.46
<b>Total HAP</b>	<b>466.94</b>	<b>1112.94</b>	<b>812.25</b>	<b>828.18</b>	<b>853.96</b>	<b>224.60</b>	<b>917.72</b>	<b>785.59</b>	<b>713.17</b>	<b>665.06</b>	<b>381.56</b>	<b>430.75</b>	<b>446.87</b>
<b>VOC Components</b>	<b>lbVOC/gal</b>	<b>Density, lb/gal</b>	<b>VOC, %</b>	<b>Ethylbenzene, %</b>	<b>Xylene, %</b>	<b>Methanol, %</b>	<b>Toluene, %</b>	<b>Hexane, %</b>	<b>MIBK, %</b>				
Dye Stain	0.25	8.4	82.1										
Wiping Stain	5.63	8.4	82.1										
Conversion Varnish	4.26	7.12	80.3	1	7	2							
Conversion Varnish Catalyst	4.85	8.06	60.6							2			
Vinyl Sealer	4.95	8.01	78.8	0.5	3		7						
Vinyl Sealer Catalyst	5.71	7.25	64.9				7			2			
Lacquer Thinner	6.59	6.59	100				7			5			
Contact Cement	5.37	6.66	84.7				25	25					
Universal dyes	6.1	8.48	72										
<b>Total lb VOC/Month</b>	<b>1504.35</b>	<b>2936.58</b>	<b>1770.38</b>	<b>1796.72</b>	<b>2146.13</b>	<b>887.44</b>	<b>1810.02</b>	<b>1720.39</b>	<b>1698.42</b>	<b>2080.80</b>	<b>1329.74</b>	<b>1045.16</b>	<b>1139.29</b>
<b>Total lb HAP/Month</b>	<b>466.94</b>	<b>1112.94</b>	<b>812.25</b>	<b>828.18</b>	<b>853.96</b>	<b>224.60</b>	<b>917.72</b>	<b>785.59</b>	<b>713.17</b>	<b>665.06</b>	<b>381.56</b>	<b>430.75</b>	<b>446.87</b>
<b>Cummulative 12-month VOC, lb</b>												<b>20726.13</b>	<b>20361.07</b>
<b>Cummulative 12-month HAP, lb</b>												<b>8192.71</b>	<b>8172.64</b>
<b>Cummulative 12-month VOC, Ton</b>												<b>10.36</b>	<b>10.18</b>
<b>Cummulative 12-month HAP, Ton</b>												<b>4.10</b>	<b>4.09</b>
<b>Percent of Permit, VOC</b>												<b>45.0</b>	<b>44.2</b>
<b>Percent of Permit, HAP</b>												<b>81.9</b>	<b>81.7</b>
<b>Surface Coating Operating, hours</b>	123.5	149.5	123.5	102.5	141.5	141.5	141.5	141.5	141.5	141.5	148	141.5	141.5
<b>Cummulative 12-month Hours</b>												<b>1637.50</b>	<b>1655.50</b>

2008 Daily Operating Hours

	1	2	3	4	5	6	7	8	9	10	11	12	13	14	15	16	17	18	19	20	21	22	23	24	25	26	27	28	29	30	31	
January start		7:38	7:47	7:50			8:14	8:23	7:19	7:45	7:48			7:31	7:36	8:00	8:47	7:46				7:33	7:27	7:55	7:39			7:40	7:43	7:33	8:01	
January end		15:26	15:25	15:20			15:26	15:25	15:23	15:24	15:22			15:18	15:23	16:29	15:14	15:16				15:19	15:23	15:17	15:22			15:22	15:18	15:20	15:15	
January total		7.8	7.833	7.5			7.2	7.033	8.067	7.65	7.567			7.783	7.783	8.483	6.45	7.5				7.767	7.933	7.367	7.717			7.7	7.583	7.783	7.233	
DoC lunch	1	1	1	1	1	1	1	1	1	1	1	1	1	1	1	1	1	1	1	1	1	1	1	1	1	1	1	1	1	1	1	
2-15 min breaks	0.5	0.5	0.5	0.5	0.5	0.5	0.5	0.5	0.5	0.5	0.5	0.5	0.5	0.5	0.5	0.5	0.5	0.5	0.5	0.5	0.5	0.5	0.5	0.5	0.5	0.5	0.5	0.5	0.5	0.5	0.5	
start-up & clean-up	0.5	0.5	0.5	0.5	0.5	0.5	0.5	0.5	0.5	0.5	0.5	0.5	0.5	0.5	0.5	0.5	0.5	0.5	0.5	0.5	0.5	0.5	0.5	0.5	0.5	0.5	0.5	0.5	0.5	0.5	0.5	
daily net	5.8	5.633	5.5				5.2	5.033	6.067	5.65	5.567			5.783	5.783	6.483	4.45	5.5				5.767	5.933	5.367	5.717			5.7	5.583	5.783	5.233	
monthly total	117.5																															
4 operator total	470.1																															
February start	7:58			8:51	7:35	7:28	7:51	7:49				7:37	7:31	7:28	7:42	8:16			7:29	7:26	7:21	7:43	7:46		7:39	7:31	7:20	7:35	7:32			
February end	15:15			15:24	15:18	15:24	15:16	15:11				15:22	15:16	15:00	15:11	15:09			15:14	15:16	15:19	15:23	15:20		15:10	15:13	15:08	15:17	15:06			
February total	7.283			6.55	7.717	7.933	7.417	7.367				7.75	7.75	7.533	7.483	6.883			7.75	7.833	7.967	7.667	7.567		7.7	7.7	7.8	7.7	7.567			
DoC lunch	1	1	1	1	1	1	1	1	1	1	1	1	1	1	1	1	1	1	1	1	1	1	1	1	1	1	1	1	1	1	1	
2-15 min breaks	0.5	0.5	0.5	0.5	0.5	0.5	0.5	0.5	0.5	0.5	0.5	0.5	0.5	0.5	0.5	0.5	0.5	0.5	0.5	0.5	0.5	0.5	0.5	0.5	0.5	0.5	0.5	0.5	0.5	0.5	0.5	
start-up & clean-up	0.5	0.5	0.5	0.5	0.5	0.5	0.5	0.5	0.5	0.5	0.5	0.5	0.5	0.5	0.5	0.5	0.5	0.5	0.5	0.5	0.5	0.5	0.5	0.5	0.5	0.5	0.5	0.5	0.5	0.5	0.5	
daily net	5.283			4.55	5.717	5.933	5.417	5.367				5.75	5.75	5.533	5.483	4.883			5.75	5.833	5.967	5.667	5.567		5.7	5.7	5.8	5.7	5.567			
monthly total	116.9																															
4 operator total	467.7																															
March start			7:26	7:30	7:23	7:33	7:36				7:38	7:42	7:33	8:30	7:45				7:35	7:34	7:33	7:45	7:37		7:29	7:33	7:28	7:52	7:42		7:29	
March end			15:19	15:14	15:18	15:10	15:04				15:13	15:12	15:13	15:17	15:09				15:23	15:14	15:13	15:12	15:12		15:10	15:11	17:34	15:08	15:19		16:08	
March total			7.883	7.733	7.917	7.617	7.467				7.583	7.5	7.667	6.783	7.4				7.8	7.667	7.667	7.45	7.583		7.683	7.633	10.1	7.267	7.617		8.65	
DoC lunch	1	1	1	1	1	1	1	1	1	1	1	1	1	1	1	1	1	1	1	1	1	1	1	1	1	1	1	1	1	1	1	
2-15 min breaks	0.5	0.5	0.5	0.5	0.5	0.5	0.5	0.5	0.5	0.5	0.5	0.5	0.5	0.5	0.5	0.5	0.5	0.5	0.5	0.5	0.5	0.5	0.5	0.5	0.5	0.5	0.5	0.5	0.5	0.5	0.5	
start-up & clean-up	0.5	0.5	0.5	0.5	0.5	0.5	0.5	0.5	0.5	0.5	0.5	0.5	0.5	0.5	0.5	0.5	0.5	0.5	0.5	0.5	0.5	0.5	0.5	0.5	0.5	0.5	0.5	0.5	0.5	0.5	0.5	
daily net	5.883		5.733	5.917	5.617	5.467					5.583	5.5	5.667	4.783	5.4				5.8	5.667	5.667	5.45	5.583		5.683	5.633	8.1	5.267	5.617		6.65	
monthly total	120.7																															
4 operator total	482.7																															
April start	7:36	7:55	8:02	8:01			7:31	7:37	7:36	8:37	8:00			7:25	7:28	7:26	7:44	7:50				7:28	7:35	7:35	7:52	8:01		7:24	7:34	7:25		
April end	16:11	16:14	16:07	15:55			16:17	16:14	15:10	15:13	15:13			15:13	15:12	15:06	15:11	15:06				15:07	15:14	15:19	15:12	15:07		15:08	15:14	15:10		
April total	8.583	8.317	8.083	7.9			8.767	8.617	7.567	6.6	7.217			7.8	7.733	7.667	7.45	7.267				7.65	7.65	7.733	7.333	7.1		7.733	7.667	7.75		
DoC lunch	1	1	1	1	1	1	1	1	1	1	1	1	1	1	1	1	1	1	1	1	1	1	1	1	1	1	1	1	1	1	1	
2-15 min breaks	0.5	0.5	0.5	0.5	0.5	0.5	0.5	0.5	0.5	0.5	0.5	0.5	0.5	0.5	0.5	0.5	0.5	0.5	0.5	0.5	0.5	0.5	0.5	0.5	0.5	0.5	0.5	0.5	0.5	0.5	0.5	
start-up & clean-up	0.5	0.5	0.5	0.5	0.5	0.5	0.5	0.5	0.5	0.5	0.5	0.5	0.5	0.5	0.5	0.5	0.5	0.5	0.5	0.5	0.5	0.5	0.5	0.5	0.5	0.5	0.5	0.5	0.5	0.5	0.5	
daily net	6.583	6.317	6.083	5.9			6.767	6.617	5.567	4.6	5.217			5.8	5.733	5.667	5.45	5.267				5.65	5.65	5.733	5.333	5.1		5.733	5.667	5.75		
monthly total	126.2																															
4 operator total	504.7																															
May start	7:39	7:42		7:34	7:35	8:29	7:57	8:49				7:30	7:20	7:40	7:48	7:44			7:27	7:31	7:25	7:46	7:42		7:35	7:29	7:34	7:38				
May end	15:10	15:10		15:10	15:08	15:07	11:15	15:07				15:16	15:10	15:11	15:10	15:03			15:11	15:11	15:05	15:06	15:05		16:09	16:10	16:11	16:02				
May total	7.517	7.467		7.6	7.55	6.633	3.3	6.3				7.767	7.833	7.517	7.367	7.317			7.733	7.667	7.667	7.333	7.383		8.567	8.683	8.617	8.4				
DoC lunch	1	1	1	1	1	1	1	1	1	1	1	1	1	1	1	1	1	1	1	1	1	1	1	1	1	1	1	1	1	1	1	
2-15 min breaks	0.5	0.5	0.5	0.5	0.5	0.5	0.5	0.5	0.5	0.5	0.5	0.5	0.5	0.5	0.5	0.5	0.5	0.5	0.5	0.5	0.5	0.5	0.5	0.5	0.5	0.5	0.5	0.5	0.5	0.5	0.5	
start-up & clean-up	0.5	0.5	0.5	0.5	0.5	0.5	0.5	0.5	0.5	0.5	0.5	0.5	0.5	0.5	0.5	0.5	0.5	0.5	0.5	0.5	0.5	0.5	0.5	0.5	0.5	0.5	0.5	0.5	0.5	0.5	0.5	
daily net	5.517	5.467		5.6	5.55	4.633	1.3	4.3				5.767	5.833	5.517	5.367	5.317			5.733	5.667	5.667	5.333	5.383		6.567	6.683	6.617	6.4				
monthly total	114.2																															
4 operator total	456.9																															
June start		7:26	7:31	7:34	7:43	7:28			7:37	7:31	7:35	7:44	7:33			7:20	7:28	7:35	7:50	7:34			7:23	7:39	7:18	7:40	7:36			7:31		
June end		16:04	16:08	16:09	16:07	16:11			15:08	15:06	15:10	15:09	15:05			15:08	15:05	15:04	15:11	15:06			15:10	15:07	15:09	15:08	15:08			15:08		
June total		8.633	8.617	8.583	8.4	8.717			7.517	7.583	7.583	7.417	7.533			7.8	7.617	7.483	7.35	7.533			7.783	7.467	7.85	7.467	7.533			7.617		
DoC lunch	1	1	1	1	1	1	1	1	1	1	1	1	1	1	1	1	1	1	1	1	1	1	1	1	1	1	1	1	1	1	1	
2-15 min breaks	0.5	0.5	0.5	0.5	0.5	0.5	0.5	0.5	0.5	0.5	0.5	0.5	0.5	0.5	0.5	0.5	0.5	0.5	0.5	0.5	0.5	0.5	0.5	0.5	0.5	0.5	0.5	0.5	0.5	0.5	0.5	
start-up & clean-up	0.5	0.5	0.5	0.5	0.5	0.5	0.5	0.5	0.5	0.5	0.5	0.5	0.5	0.5	0.5	0.5	0.5	0.5	0.5	0.5	0.5	0.5	0.5	0.5	0.5	0.5	0.5	0.5	0.5	0.5	0.5	
daily net	6.633	6.617	6.583	6.4	6.717				5.517	5.583	5.583	5.417	5.533			5.8	5.617	5.483	5.35	5.533			5.783									



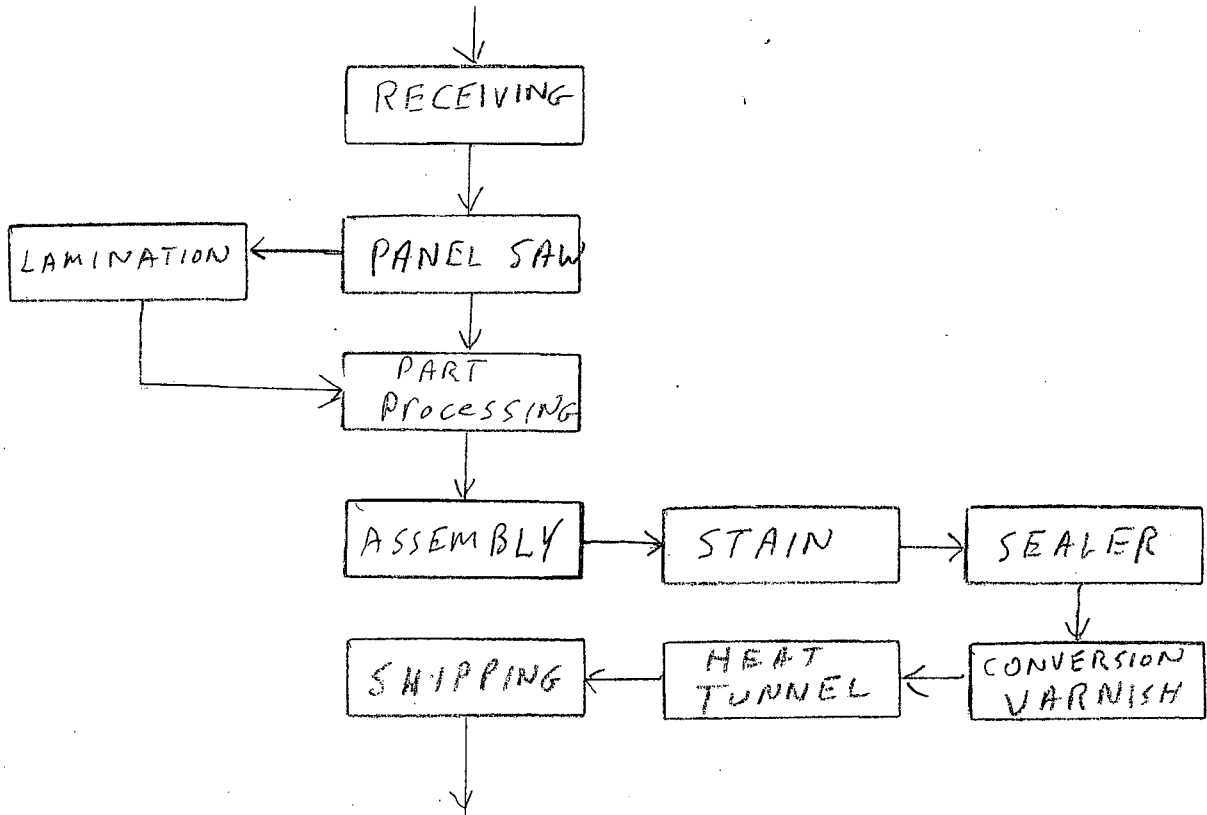

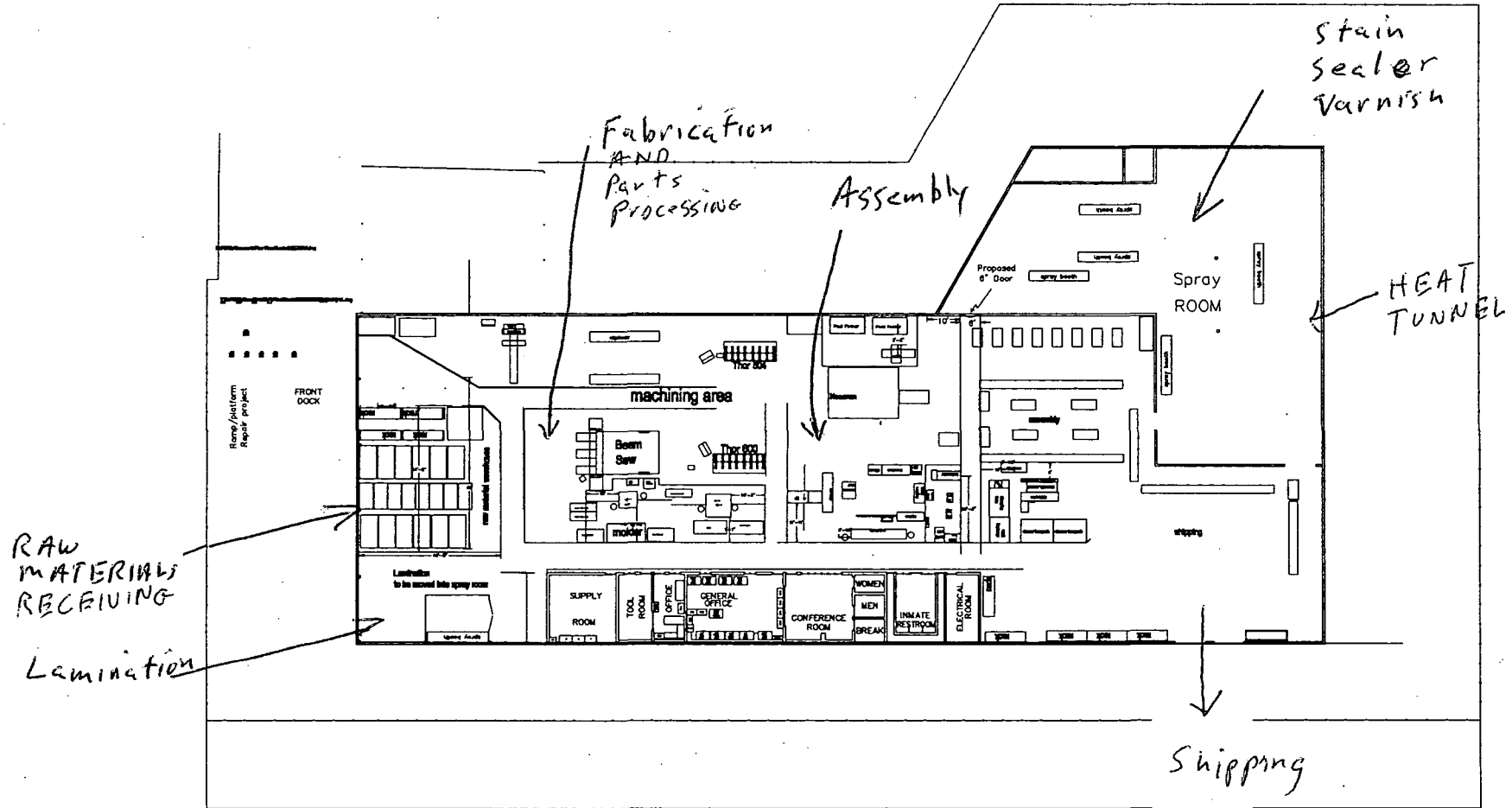

# PRIDE Enterprises Site Plan

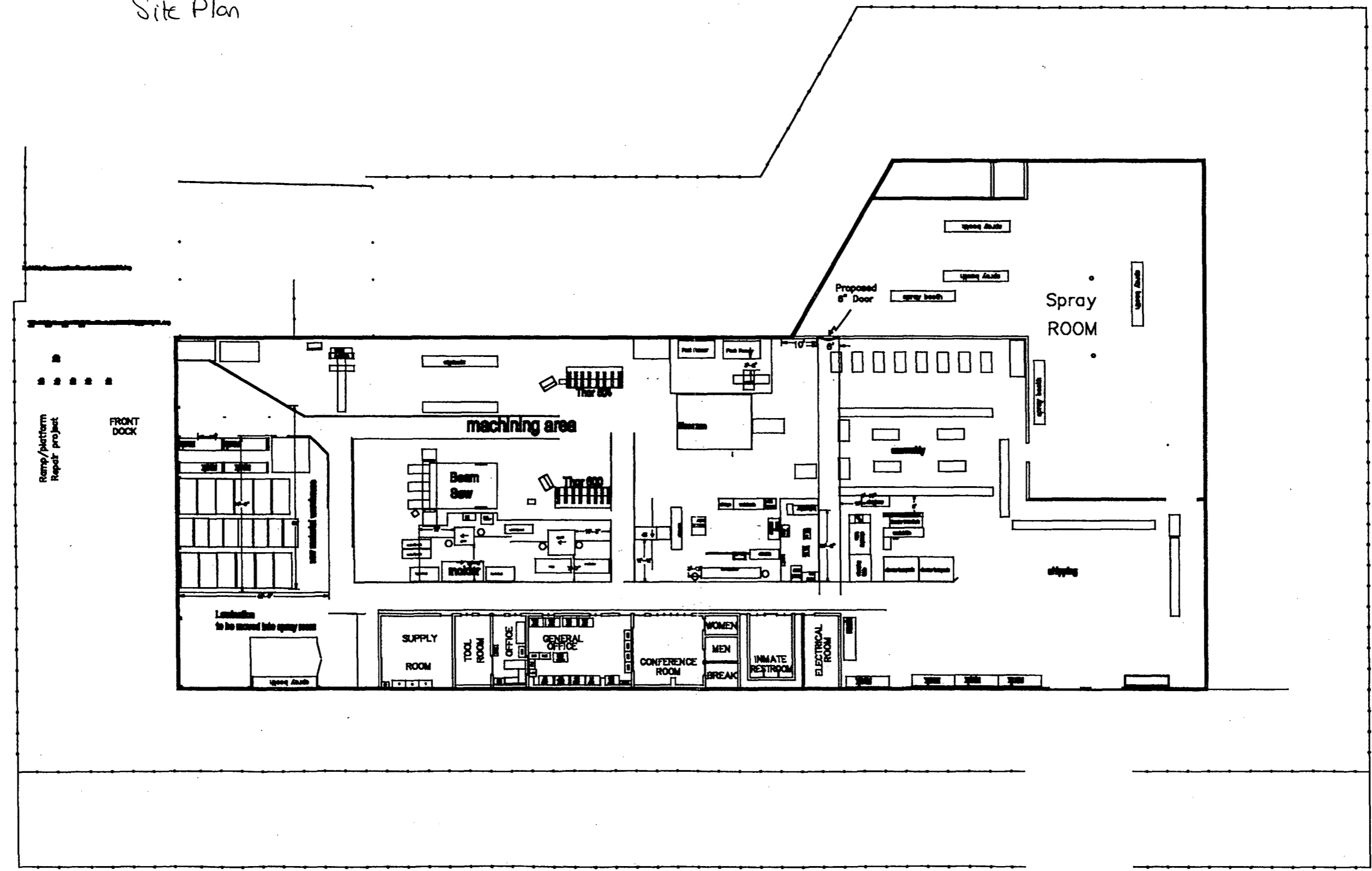





July 22, 2008

Dept. of Environmental  
Protection

Air Permitting  
Florida Department of Environmental Protection  
13051 Telecom Parkway  
Temple Terrace, Florida 33637

JUL 25 2008

Southwest District

**RE: PRIDE Enterprises  
Sumter Furniture  
Sumter County, Florida  
Facility # 1190015-002-AF Renewal**

Dear Sir/Madam:

Enclosed are two copies of the signature page for the above referenced FESOP renewal. The application and check for \$750:00 to cover the permitting fee for this project was submitted under a separate cover.

If you have any questions concerning this submittal, please do not hesitate to call me at (813) 930-9074.

Sincerely,

A handwritten signature in cursive script that reads "Timothy M. O'Dell".

Timothy M. O'Dell  
Environmental Scientist

cc: Kip Fisher, PRIDE

**Owner/Authorized Representative**

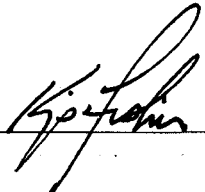
1. Name and Title of Owner/Authorized Representative: <b>Kip Fisher/ Safety and Environmental Manager</b>
2. Owner/Authorized Representative Mailing Address:  Organization/Firm: <b>PRIDE Enterprises</b> Street Address: <b>12425 28th Street North</b> City: <b>St. Petersburg</b> State: <b>Florida</b> Zip Code: <b>33716</b>
3. Owner/Authorized Representative Telephone Numbers: Telephone: <b>(727) 639-1276</b> - Fax: ( ) <b>NA</b>
4. Owner/Authorized Representative Statement:  <i>I, the undersigned, am the owner or authorized representative* of the facility addressed in this Application for Air Permit. I hereby certify, based on information and belief formed after reasonable inquiry, that the statements made in this application are true, accurate and complete and that, to the best of my knowledge, any estimates of emissions reported in this application are based upon reasonable techniques for calculating emissions. Further, I agree to operate and maintain the air pollutant emissions units and air pollution control equipment described in this application so as to comply with all applicable standards for control of air pollutant emissions found in the statutes of the State of Florida and rules of the Department of Environmental Protection and revisions thereof. I understand that a permit, if granted by the Department, cannot be transferred without authorization from the Department, and I will promptly notify the Department upon sale or legal transfer of any permitted emissions unit.</i>   _____ Signature  _____ Date <b>7/14/08</b>

Dept. of Environmental  
Protection

JUL 25 2008

Southwest District

**Owner/Authorized Representative**

1. Name and Title of Owner/Authorized Representative: **Kip Fisher/ Safety and Environmental Manager**

2. Owner/Authorized Representative Mailing Address:

Organization/Firm: **PRIDE Enterprises**  
Street Address: **12425 28th Street North**  
City: **St. Petersburg** State: **Florida** Zip Code: **33716**

3. Owner/Authorized Representative Telephone Numbers:

Telephone: **(727) 639-1276** - Fax: ( ) **NA**

4. Owner/Authorized Representative Statement:

*I, the undersigned, am the owner or authorized representative\* of the facility addressed in this Application for Air Permit. I hereby certify, based on information and belief formed after reasonable inquiry, that the statements made in this application are true, accurate and complete and that, to the best of my knowledge, any estimates of emissions reported in this application are based upon reasonable techniques for calculating emissions. Further, I agree to operate and maintain the air pollutant emissions units and air pollution control equipment described in this application so as to comply with all applicable standards for control of air pollutant emissions found in the statutes of the State of Florida and rules of the Department of Environmental Protection and revisions thereof. I understand that a permit, if granted by the Department, cannot be transferred without authorization from the Department, and I will promptly notify the Department upon sale or legal transfer of any permitted emissions unit.*

Signature



Date

7/14/08

Dept. of Environmental  
Protection

JUL 25 2008

Southwest District



July 14, 2008

Air Permitting  
Florida Department of Environmental Protection  
13051 Telecom Parkway  
Temple Terrace, Florida 33637

**RE: PRIDE Enterprises  
Sumter Furniture  
Sumter County, Florida  
Facility # 1190015-002-AF Renewal**

Dear Sir/Madam:

Enclosed are two copies of an air permit renewal of the above referenced FESOP Permit. Also enclosed is a check for \$750.00 to cover the permitting fee for this project. The signature page will be sent under a separate cover letter.

If you have any questions concerning this submittal, please do not hesitate to call me at (813) 930-9074.

Sincerely,

A handwritten signature in black ink that reads 'Timothy M. O'Dell'.

Timothy M. O'Dell  
Environmental Scientist

cc: Kip Fisher, PRIDE

Dept. of Environmental  
Protection

JUL 16 2008

Southwest District

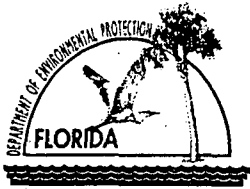

# Department of Environmental Protection

## Division of Air Resources Management

### APPLICATION FOR NON-TITLE V AIR PERMIT RENEWAL

See Instructions for Form No. 62-210.900(4)

#### I. APPLICATION INFORMATION

##### Identification of Facility

1. Facility Owner/Company Name: <b>PRIDE Enterprises</b>	
2. Site Name: <b>Sumter Furniture</b>	
3. Facility Identification Number: <b>1190015</b>	4. Facility Status Code: <b>Active</b>

##### Application Contact

1. Name and Title of Application Contact: <b>Timothy M. O'Dell / Environmental Scientist</b>
2. Application Contact Mailing Address:  Organization/Firm: <b>Environmental Sciences Group, Inc.</b> Street Address: <b>P.O. Box 7495</b> City: <b>Tampa</b> State: <b>Florida</b> Zip Code: <b>33673</b>
3. Application Contact Telephone Numbers: Telephone: <b>(813) 930-9074</b> Fax: <b>(813) 935-1167</b>

##### Application Processing Information (DEP Use)

1. Date of Receipt of Application:	<b>July 16, 2008</b>
2. Permit Number:	<b>1190015-003-07</b>

Dept. of Environmental  
Protection

JUL 16 2008

Southwest District

**Owner/Authorized Representative**

1. Name and Title of Owner/Authorized Representative: **Kip Fisher/ Safety and Environmental Manager**

2. Owner/Authorized Representative Mailing Address:

Organization/Firm: **PRIDE Enterprises**  
Street Address: **12425 28th Street North**  
City: **St. Petersburg** State: **Florida** Zip Code: **33716**

3. Owner/Authorized Representative Telephone Numbers:

Telephone: **(727) 639-1276** - Fax: ( ) **NA**

4. Owner/Authorized Representative Statement:

*I, the undersigned, am the owner or authorized representative\* of the facility addressed in this Application for Air Permit. I hereby certify, based on information and belief formed after reasonable inquiry, that the statements made in this application are true, accurate and complete and that, to the best of my knowledge, any estimates of emissions reported in this application are based upon reasonable techniques for calculating emissions. Further, I agree to operate and maintain the air pollutant emissions units and air pollution control equipment described in this application so as to comply with all applicable standards for control of air pollutant emissions found in the statutes of the State of Florida and rules of the Department of Environmental Protection and revisions thereof. I understand that a permit, if granted by the Department, cannot be transferred without authorization from the Department, and I will promptly notify the Department upon sale or legal transfer of any permitted emissions unit.*

\_\_\_\_\_  
Signature

7/14/08  
Date

**Dept. of Environmental  
Protection**

**JUL 16 2008**

**Southwest District**

**Scope of Application**

<b>Emissions Unit ID</b>	<b>Description of Emissions Unit</b>	<b>Permit Type</b>	<b>Processing Fee</b>
001	Furniture Manufacturing	AF2C	\$750.00

**Application Processing Fee**

Check one:  Attached - Amount: \$ 750.00  Not Applicable

**Application Comment**

**Renewal of Permit Number 1190015-002-AF**

Dept. of Environmental  
Protection  
JUL 16 2008  
Southwest District

## II. FACILITY INFORMATION

### Facility Contact

1. Name and Title of Facility Contact: <b>Lance Craft / Industry Manager</b>
2. Facility Contact Mailing Address: Organization/Firm: <b>PRIDE Sumter Furniture</b> Street Address: <b>P.O. Box 667</b> City: <b>Bushnell</b> State: <b>FL</b> Zip Code: <b>33513</b>
3. Facility Contact Telephone Numbers: Telephone: (813) 890-6610 - Fax: (813) 890-2112

### Facility Supplemental Requirements

1. Area Map Showing Facility Location: <input type="checkbox"/> Attached, Document ID: _____ <input type="checkbox"/> Not Applicable <input checked="" type="checkbox"/> Waiver Requested
2. Facility Plot Plan: <input type="checkbox"/> Attached, Document ID: _____ <input type="checkbox"/> Not Applicable <input checked="" type="checkbox"/> Waiver Requested
3. Process Flow Diagram(s): <input type="checkbox"/> Attached, Document ID: _____ <input type="checkbox"/> Not Applicable <input checked="" type="checkbox"/> Waiver Requested
4. Precautions to Prevent Emissions of Unconfined Particulate Matter: <input type="checkbox"/> Attached, Document ID: _____ <input checked="" type="checkbox"/> Not Applicable <input type="checkbox"/> Waiver Requested

### Facility Comment

Facility-wide emission rate of 23.04 Tons/yr of VOC and < 5.0 Tons per Year HAP's
---



Emissions Unit ID \_\_\_\_\_

### III. EMISSIONS UNIT INFORMATION

A separate Emissions Unit Information Section must be completed for each emissions unit addressed in this Application for Non-Title V Air Permit Renewal. If submitting the form in hard copy, indicate, in the space provided at the top of each page, the Emissions Unit ID of the emissions unit addressed on the page, as given in the unit's most current air operation permit.

#### Emissions Unit Description and Status

1. Description of Emissions Unit Addressed in This Section (limit to 60 characters): Furniture Manufacturing	
2. Emissions Unit Status Code: Active	3. Long-Term Reserve Shutdown Date: NA
4. Control Equipment Method/Description (limit to 200 characters per device or method): No control equipment other than general operating procedures to keep solvent containers tightly sealed, material balance and recordkeeping.	

#### Emissions Unit Operating Capacity and Schedule

1. Maximum Heat Input Rate:		mmBtu/hr
2. Maximum Incineration Rate:	lb/hr	tons/day
3. Maximum Process or Throughput Rate:		
4. Maximum Production Rate:	23.04 Ton VOC per year	
5. Requested Maximum Operating Schedule:		
	hours/day	days/week
	weeks/year	3120 hours/year

Dept. of Environmental  
Protection

JUL 16 2008

Southwest District

Emissions Unit ID \_\_\_\_\_

**Emissions Unit Supplemental Requirements**

1. Fuel Analysis or Specification <input type="checkbox"/> Attached, Document ID: _____ <input checked="" type="checkbox"/> Not Applicable <input type="checkbox"/> Waiver Requested
2. Compliance Test Report <input type="checkbox"/> Attached, Document ID: _____ <input checked="" type="checkbox"/> Not Applicable <input type="checkbox"/> Previously submitted, Date: _____
3. Procedures for Startup and Shutdown <input type="checkbox"/> Attached, Document ID: _____ <input checked="" type="checkbox"/> Not Applicable <input type="checkbox"/> Waiver Requested
4. Operation and Maintenance Plan <input type="checkbox"/> Attached, Document ID: _____ <input checked="" type="checkbox"/> Not Applicable <input type="checkbox"/> Waiver Requested
5. Other Information Required by Rule or Statute <input type="checkbox"/> Attached, Document ID: _____ <input checked="" type="checkbox"/> Not Applicable

**Emissions Unit Comment**