

AIR PERMIT RENEWAL

**SPX DEHYDRATION &
PROCESS FILTRATION**

**4647 S.W. 40TH AVENUE
OCALA, FLORIDA 34474
Delta Project No. 5E0708492**

**Dept. of Environmental
Protection**

NOV 07 2007

Southwest District

Prepared by:

DELTA

8008 Corporate Center Drive
Charlotte, North Carolina 28226

November 2007

Table of Contents

Permit Renewal Application

Figures

- Figure 1: Site Location Map
- Figure 2: Facility Plot Plan
- Figure 3: Process Flow Diagram

Appendices

- Appendix A: Visible Emissions Test Report
- Appendix B: Most Recent Two (2) Months VOC log

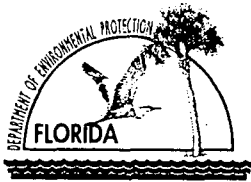

Department of Environmental Protection

Division of Air Resources Management

APPLICATION FOR NON-TITLE V AIR PERMIT RENEWAL

See Instructions for Form No. 62-210.900(4)

I. APPLICATION INFORMATION

Identification of Facility

1. Facility Owner/Company Name: <i>SPX Dehydration and Process Filtration</i>	
2. Site Name: <i>SPX Dehydration and Process Filtration</i>	
3. Facility Identification Number: <i>0830084</i>	4. Facility Status Code: <i>A</i>

Application Contact

1. Name and Title of Application Contact: <i>Carl Ruder</i> <i>Vice President Operations</i>	Dept. of Environmental Protection NOV 07 2007
2. Application Contact Mailing Address: Organization/Firm: <i>SPX Dehydration and Process Filtration</i> Street Address: <i>4647 S. W. 40th Avenue</i> City: <i>Ocala</i> State: <i>Florida</i> Zip Code: <i>34474-5722</i>	Southwest District
3. Application Contact Telephone Numbers: Telephone: <i>(352) 873 - 5758</i> Fax: <i>(352) 873 - 5755</i>	

Application Processing Information (DEP Use)

1. Date of Receipt of Application:	
2. Permit Number:	

Owner/Authorized Representative

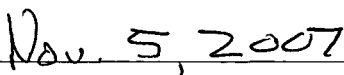
1. Name and Title of Owner/Authorized Representative: <i>Carl Ruder</i> <i>Vice President Operations</i>
2. Owner/Authorized Representative Mailing Address: Organization/Firm: <i>SPX Dehydration and Process Filtration</i> Street Address: <i>4647 S. W. 40th Avenue</i> City: <i>Ocala</i> State: <i>Florida</i> Zip Code: <i>34474-5722</i>
3. Owner/Authorized Representative Telephone Numbers: Telephone: <i>(352) 873 - 5758</i> Fax: <i>(352) 873 - 5755</i>
4. Owner/Authorized Representative Statement: <i>I, the undersigned, am the owner or authorized representative* of the facility addressed in this Application for Air Permit. I hereby certify, based on information and belief formed after reasonable inquiry, that the statements made in this application are true, accurate and complete and that, to the best of my knowledge, any estimates of emissions reported in this application are based upon reasonable techniques for calculating emissions. Further, I agree to operate and maintain the air pollutant emissions units and air pollution control equipment described in this application so as to comply with all applicable standards for control of air pollutant emissions found in the statutes of the State of Florida and rules of the Department of Environmental Protection and revisions thereof. I understand that a permit, if granted by the Department, cannot be transferred without authorization from the Department, and I will promptly notify the Department upon sale or legal transfer of any permitted emissions unit.</i>  _____ Signature  _____ Date

* Attach letter of authorization if not currently on file. (See Appendix B)

Scope of Application

Emissions Unit ID	Description of Emissions Unit	Permit Type	Processing Fee
001	Spray Paint Booths	AF2C	\$ 750
002	Sandblasting Operations	AF2B	\$ 1000

Application Processing Fee

Check one: [] Attached - Amount: \$ 1750 [] Not Applicable

Application Comment

II. FACILITY INFORMATION

Facility Contact

1. Name and Title of Facility Contact: <i>Carl Ruder, Vice President Operations</i>
2. Facility Contact Mailing Address: Organization/Firm: <i>SPX Dehydration and Process Filtration</i> Street Address: <i>4647 S. W. 40th Avenue</i> City: <i>Ocala</i> State: <i>Florida</i> Zip Code: <i>34474-5722</i>
3. Facility Contact Telephone Numbers: Telephone: <i>(352) 873 - 5758</i> Fax: <i>(352) 873 - 5755</i>

Facility Supplemental Requirements

1. Area Map Showing Facility Location: <input checked="checked" type="checkbox"/> Attached, Document ID: <i>Figure 1</i> [] Not Applicable [] Waiver Requested
2. Facility Plot Plan: <input checked="checked" type="checkbox"/> Attached, Document ID: <i>Figure 2</i> [] Not Applicable [] Waiver Requested
3. Process Flow Diagram(s): <input checked="checked" type="checkbox"/> Attached, Document ID: <i>Figure 3</i> [] Not Applicable [] Waiver Requested
4. Precautions to Prevent Emissions of Unconfined Particulate Matter: [] Attached, Document ID: _____ [x] Not Applicable [] Waiver Requested

Facility Comment

III. EMISSIONS UNIT INFORMATION

A separate Emissions Unit Information Section must be completed for each emissions unit addressed in this Application for Non-Title V Air Permit Renewal. If submitting the form in hard copy, indicate, in the space provided at the top of each page, the Emissions Unit ID of the emissions unit addressed on the page, as given in the unit's most current air operation permit.

Emissions Unit Description and Status

1. Description of Emissions Unit Addressed in This Section (limit to 60 characters): <i>Large Spray Paint Booth Area and Small Paint Booth Area</i>	
2. Emissions Unit Status Code: <i>A</i>	3. Long-Term Reserve Shutdown Date: <i>NA</i>
4. Control Equipment Method/Description (limit to 200 characters per device or method): <i>These booths are equipped with filter arrestors to collect overspray and fans to exhaust fumes through a 45' tall exhaust stack. This emissions unit also has associated spray gun cleaning stations, a free standing Large Spray Paint Mixing Booth, a Small Spray Paint Mixing Booth, and a paint "touch up" area.</i>	

Emissions Unit Operating Capacity and Schedule

1. Maximum Heat Input Rate:	<i>NA</i>	mmBtu/hr
2. Maximum Incineration Rate:	<i>NA</i>	tons/day
3. Maximum Process or Throughput Rate:	<i>See Comment</i>	
4. Maximum Production Rate:	<i>See Comment</i>	
5. Requested Maximum Operating Schedule:		
	<i>24 hours/day</i>	<i>7 days/week</i>
	<i>52 weeks/year</i>	<i>8760 hours/year</i>

Emissions Unit ID 001

Emissions Unit Supplemental Requirements

1. Fuel Analysis or Specification <input type="checkbox"/> Attached, Document ID: _____ <input checked="" type="checkbox"/> Not Applicable <input type="checkbox"/> Waiver Requested
2. Compliance Test Report <input type="checkbox"/> Attached, Document ID: _____ <input checked="" type="checkbox"/> Not Applicable <input type="checkbox"/> Previously submitted, Date: _____
3. Procedures for Startup and Shutdown <input type="checkbox"/> Attached, Document ID: _____ <input checked="" type="checkbox"/> Not Applicable <input type="checkbox"/> Waiver Requested
4. Operation and Maintenance Plan <input type="checkbox"/> Attached, Document ID: _____ <input checked="" type="checkbox"/> Not Applicable <input type="checkbox"/> Waiver Requested
5. Other Information Required by Rule or Statute <input type="checkbox"/> Attached, Document ID: _____ <input checked="" type="checkbox"/> Not Applicable

Emissions Unit Comment

This Emissions Unit is currently permitted to operate 8,760 hrs per year. There have been no changes to process throughput or operating hours. The facility is considered by FL-DEP to be a natural minor non-Title V source.

III. EMISSIONS UNIT INFORMATION

A separate Emissions Unit Information Section must be completed for each emissions unit addressed in this Application for Non-Title V Air Permit Renewal. If submitting the form in hard copy, indicate, in the space provided at the top of each page, the Emissions Unit ID of the emissions unit addressed on the page, as given in the unit's most current air operation permit.

Emissions Unit Description and Status

1. Description of Emissions Unit Addressed in This Section (limit to 60 characters): <i>Large Empire Sandblast Room</i>	
2. Emissions Unit Status Code: <i>A</i>	3. Long-Term Reserve Shutdown Date: <i>NA</i>
4. Control Equipment Method/Description (limit to 200 characters per device or method): <i>Empire Abrasive Equipment Corporation, Model 1320-10 sandblaster equipped with a CP Environmental Filters, Inc. Model 84NF042 pulse jet dust collector to control PM emissions.</i>	

Emissions Unit Operating Capacity and Schedule

1. Maximum Heat Input Rate:	<i>NA</i>	mmBtu/hr
2. Maximum Incineration Rate:	<i>NA</i>	tons/day
3. Maximum Process or Throughput Rate:	<i>See Comment</i>	
4. Maximum Production Rate:	<i>See Comment</i>	
5. Requested Maximum Operating Schedule:	<i>24 hours/day</i>	<i>7 days/week</i>
	<i>52 weeks/year</i>	<i>8760 hours/year</i>

Emissions Unit ID 002

Emissions Unit Supplemental Requirements

1. Fuel Analysis or Specification <input type="checkbox"/> Attached, Document ID: _____ <input checked="" type="checkbox"/> Not Applicable <input type="checkbox"/> Waiver Requested
2. Compliance Test Report <input checked="" type="checkbox"/> Attached, Document ID: <u>Appendix A</u> <input type="checkbox"/> Not Applicable <input checked="" type="checkbox"/> Previously submitted, Date: <u>October 15, 2002</u>
3. Procedures for Startup and Shutdown <input type="checkbox"/> Attached, Document ID: _____ <input checked="" type="checkbox"/> Not Applicable <input type="checkbox"/> Waiver Requested
4. Operation and Maintenance Plan <input type="checkbox"/> Attached, Document ID: _____ <input checked="" type="checkbox"/> Not Applicable <input type="checkbox"/> Waiver Requested
5. Other Information Required by Rule or Statute <input type="checkbox"/> Attached, Document ID: _____ <input checked="" type="checkbox"/> Not Applicable

Emissions Unit Comment

This Emissions Unit is currently permitted to operate 8,760 hrs per year. There have been no changes to process throughput or operating hours. The facility is considered by FL-DEP to be a natural minor non-Title V source.

III. EMISSIONS UNIT INFORMATION

A separate Emissions Unit Information Section must be completed for each emissions unit addressed in this Application for Non-Title V Air Permit Renewal. If submitting the form in hard copy, indicate, in the space provided at the top of each page, the Emissions Unit ID of the emissions unit addressed on the page, as given in the unit's most current air operation permit.

Emissions Unit Description and Status

1. Description of Emissions Unit Addressed in This Section (limit to 60 characters): <i>Teflon Sandblaster</i>	
2. Emissions Unit Status Code: <i>A</i>	3. Long-Term Reserve Shutdown Date: <i>NA</i>
4. Control Equipment Method/Description (limit to 200 characters per device or method): <i>Delong Model SB-2 sandblaster equipped with a Dollinger Dust Collector- Zero Air Cartridge Fabric Filter to control particulate matter emissions.</i>	

Emissions Unit Operating Capacity and Schedule

1. Maximum Heat Input Rate:	<i>NA</i>	mmBtu/hr
2. Maximum Incineration Rate:	<i>NA</i>	tons/day
3. Maximum Process or Throughput Rate:	<i>See Comment</i>	
4. Maximum Production Rate:	<i>See Comment</i>	
5. Requested Maximum Operating Schedule:	<i>24 hours/day</i>	<i>7 days/week</i>
	<i>52 weeks/year</i>	<i>8760 hours/year</i>

Emissions Unit Supplemental Requirements

1. Fuel Analysis or Specification <input type="checkbox"/> Attached, Document ID: _____ <input checked="" type="checkbox"/> Not Applicable <input type="checkbox"/> Waiver Requested
2. Compliance Test Report <input checked="" type="checkbox"/> Attached, Document ID: <u>Appendix A</u> <input type="checkbox"/> Not Applicable <input checked="" type="checkbox"/> Previously submitted, Date: <u>October 15, 2002</u>
3. Procedures for Startup and Shutdown <input type="checkbox"/> Attached, Document ID: _____ <input checked="" type="checkbox"/> Not Applicable <input type="checkbox"/> Waiver Requested
4. Operation and Maintenance Plan <input type="checkbox"/> Attached, Document ID: _____ <input checked="" type="checkbox"/> Not Applicable <input type="checkbox"/> Waiver Requested
5. Other Information Required by Rule or Statute <input type="checkbox"/> Attached, Document ID: _____ <input checked="" type="checkbox"/> Not Applicable

Emissions Unit Comment

This Emissions Unit is currently permitted to operate 8,760 hrs per year. There have been no changes to process throughput or operating hours. The facility is considered by FL-DEP to be a natural minor non-Title V source.

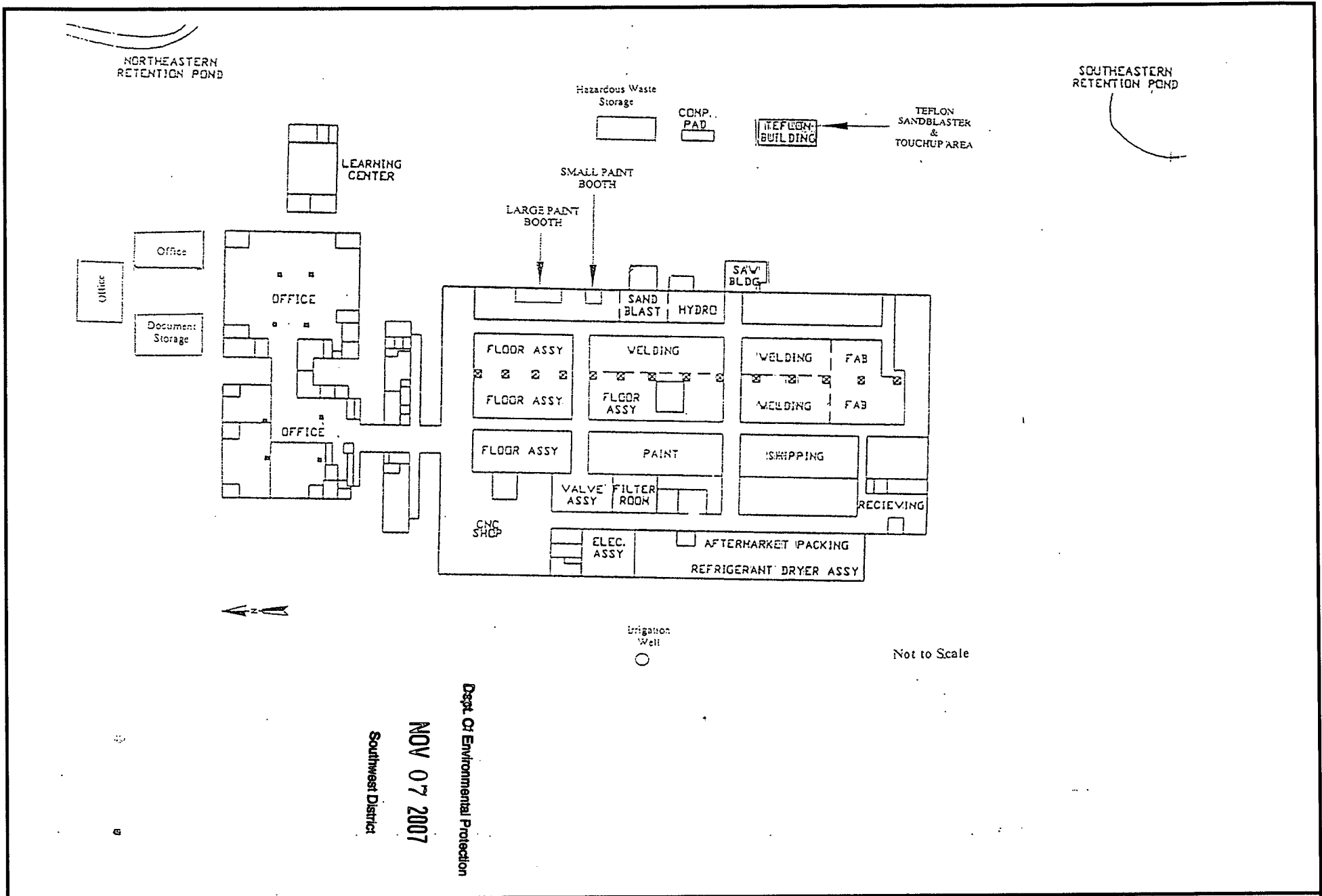

FIGURE 2 - FACILITY PLOT PLAN

SPX Dehydration and Process Filtration
 4647 40th Ave
 Ocala, FL

PROJECT NO: 5E0708492
DATE: 11/1/2007
SCALE: NTS
DRAWN BY: AU



DELTA
 8008 Corporate Center Drive, Suite 100
 Charlotte, North Carolina 28226

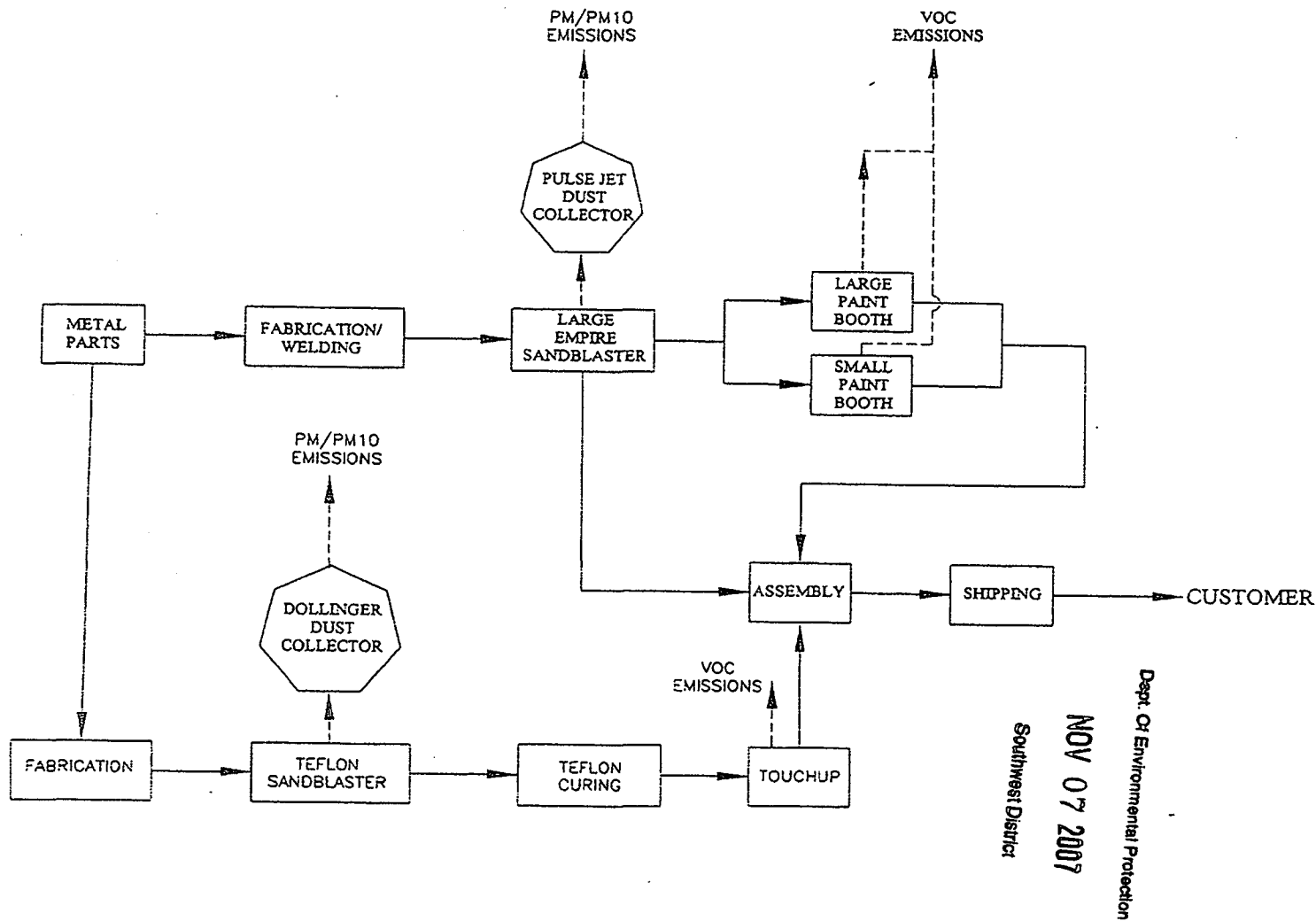

FIGURE 3 - SITE MAP

SPX Dehydration and Process Filtration
 4647 40th Ave
 Ocala, FL

PROJECT NO: 5E0708492

DATE: 11/1/2007

SCALE: NTS

DRAWN BY: AU



8008 Corporate Center Drive, Suite 100
 Charlotte, North Carolina 28226

Air
OBSERVATIONS, Inc.

September 17, 2007

Mr. Chris Bradley
State Of Florida
Dept. Of Environmental Protection
13051 Telecom Parkway
Tampa, Florida 33637

Dear Chris,

As his letter is to notify you that, Method 9 compliance testing has been rescheduled at the following facility(s) in your district:

SPX Dehydration & Process Filtration
Brian Shannon – 352/873-5749
Facility I.D. No. 083-0084
September 25, 2007
To begin at 11:00 A.M.

I trust the above is satisfactory. Please call if you have any further questions. If there is any change in this schedule, we will notify you.

Sincerely,

Pamela

Pamela LeBoss

Copy To: Ms. Rhonda Hughes/FDEP Tampa District
Tony Rossano/Delta Engineering, Inc.

SPX Dehydration and Filtration
 Facility ID: 0830084
 Emission Unit Number: EU002

Catalog #	VOC's	QTY Ozs	VOC's	QTY Ozs
Description	Flat Black 143-0116	Flat Black 143-0117	Teflon 421	Teflon 422
VOC content factor	4.6	4.6	2.6	2.6
HAP content factor				
08/01/07	32	2	24	2
08/02/07	0	0	16	2
08/03/07	0	0	0	0
08/04/07				
08/05/07				
08/06/07	40	2	24	2
08/07/07	0	0	24	2
08/08/07	0	0	0	0
08/09/07	24	2	32	2
08/10/07	24	2	0	0
08/11/07				
08/12/07				
08/13/07	16	2	0	0
08/14/07	0	0	32	0
08/15/07	24	2	24	2
08/16/07	16	2	24	2
08/17/07	32	2	32	2
08/18/07				
08/19/07				
08/20/07	32	2	16	2
08/21/07	0	0	0	0
08/22/07	0	0	0	0
08/23/07	24	2	24	2
08/24/07	24	2	16	2
08/25/07				
08/26/07				
08/27/07	24	2	32	2
08/28/07	32	2	16	2
08/29/07	40	2	16	2
08/30/07	0	0	0	0
08/31/07	0	0	0	0
09/01/07				
09/02/07				
09/03/07	0	0	0	0
09/04/07	0	0	0	0
09/05/07	16	2	16	2
09/06/07	32	2	0	0
09/07/07	0	0	32	2
09/08/07				
09/09/07				

SPX Dehydration and Filtration
 Facility ID: 0830084
 Emission Unit Number: EU002

Catalog #	VOC's	QTY Ozs	VOC's	QTY Ozs
Description	Flat Black 143-0116	Flat Black 143-0117	Teflon 421	Teflon 422
VOC content factor	4.6	4.6	2.6	2.6
HAP content factor				
09/10/07	16	2	24	2
09/11/07	24	2	24	2
09/12/07	16	2	16	2
09/13/07	0	0	0	0
09/14/07	0	0	0	0
09/15/07				
09/16/07				
09/17/07	0	0	0	0
09/18/07	16	2	32	2
09/19/07	24	2	24	2
09/20/07	32	2	0	0
09/21/07	0	0	0	0
09/22/07				
09/23/07				
09/24/07	16	2	16	2
09/25/07	0	0	16	2
09/26/07	0	0	0	0
09/27/07	24	2	16	2
09/28/07	16	2	16	2
09/29/07				
09/30/07				
10/01/07	24	2	32	2
10/02/07	32	2	16	2
10/03/07	40	2	16	2
10/04/07	0	0	0	0
10/05/07	0	0	0	0
10/06/07				
10/07/07				
10/08/07	0	0	16	2
10/09/07	24	2	24	2
10/10/07	0	0	32	2
10/11/07	16	2	0	0
10/12/07	24	2	24	2

12 month total usage: 232 263
 12 month tot emission: 1067.2 683.8

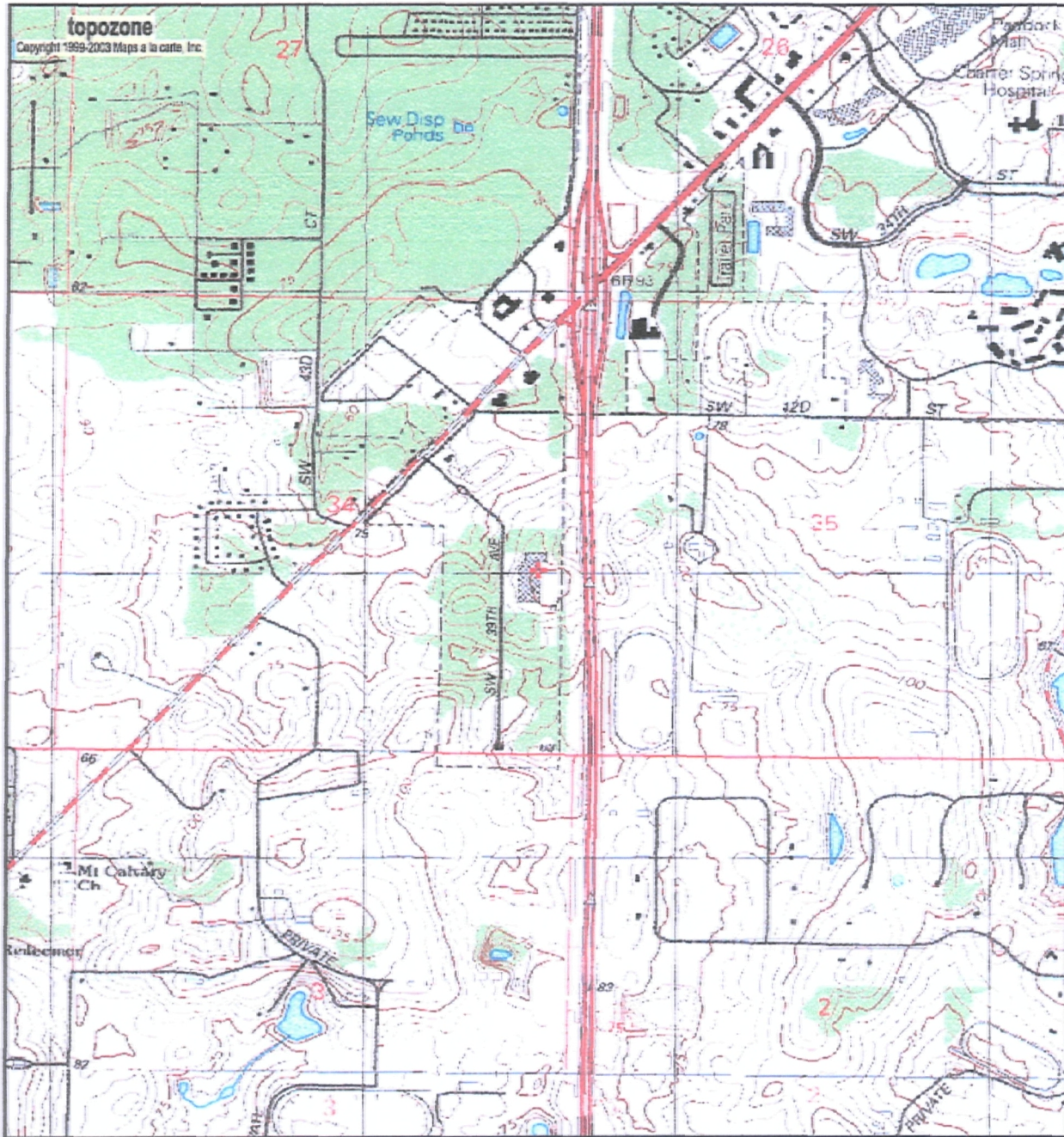

Dept. Of Environmental Protection

NOV 07 2007

Southwest District

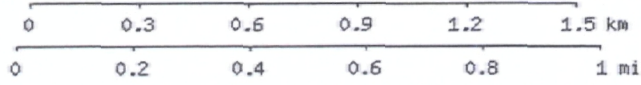

29° 08' 28"N, 82° 11' 12"W (NAD83/WGS84)
USGS Ocala West (FL) Quadrangle
 Projection is UTM Zone 17 NAD83 Datum

M=-4.943
 G=-0.578

Dept. Of Environmental Protection

NOV 07 2007

Southwest District

FIGURE 1 - SITE LOCATION MAP

SPX Dehydration and Process Filtration
 4647 S.W. 40th Ave.
 Ocala, FL

PROJECT NO: 5E0708492
 DATE: 11/1/2007
 SCALE: NTS
 DRAWN BY: AU

DELTA
 8008 Corporate Center Drive, Suite 100
 Charlotte, North Carolina 28226