

BEST AVAILABLE COPY

STATE OF FLORIDA
DEPARTMENT OF
ENVIRONMENTAL
PROTECTION

2004 APR 28 A 10:34

NORTHEAST DISTRICT
JACKSONVILLE, FL

**APPLICATION FOR RENEWAL
OF
TITLE V AIR OPERATING PERMIT APPLICATION
PERPETUAL ENERGY CORPORATION OF FLORIDA
MADISON FACILITY**

RECEIVED

MAY 03 2004

BUREAU OF AIR REGULATION

Prepared For:

Perpetual Energy Corporation of Florida
Route 3, 1.5 miles N of Madison on Co. Rd. 591
Madison, Florida 32340

Prepared By:

Golder Associates Inc.
6241 NW 23rd Street, Suite 500
Gainesville, Florida 32653-1500

April 2004
0437572

DISTRIBUTION:

4 Copies – FDEP
1 Copy – Perpetual Energy Corp.
1 Copy – Golder Associates Inc.

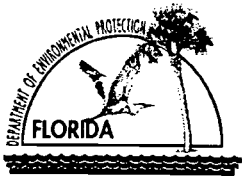

Department of Environmental Protection

Division of Air Resource Management

APPLICATION FOR AIR PERMIT - LONG FORM

I. APPLICATION INFORMATION

Air Construction Permit – Use this form to apply for an air construction permit for a proposed project:

- subject to prevention of significant deterioration (PSD) review, nonattainment area (NAA) new source review, or maximum achievable control technology (MACT) review; or
- where the applicant proposes to assume a restriction on the potential emissions of one or more pollutants to escape a federal program requirement such as PSD review, NAA new source review, Title V, or MACT; or
- at an existing federally enforceable state air operation permit (FESOP) or Title V permitted facility.

Air Operation Permit – Use this form to apply for:

- an initial federally enforceable state air operation permit (FESOP); or
- an initial/revised/renewal Title V air operation permit.

Air Construction Permit & Revised/Renewal Title V Air Operation Permit (Concurrent Processing Option)

– Use this form to apply for both an air construction permit and a revised or renewal Title V air operation permit incorporating the proposed project.

To ensure accuracy, please see form instructions.

Identification of Facility

1. Facility Owner/Company Name: Perpetual Energy Corporation of Florida	
2. Site Name: Madison Facility	
3. Facility Identification Number: 0790011	
4. Facility Location...: Street Address or Other Locator: Route 3, 1.5 miles N of Madison on Co. Rd. 591 City: Madison County: Madison Zip Code: 32340	
5. Relocatable Facility? <input type="checkbox"/> Yes <input checked="" type="checkbox"/> No	6. Existing Title V Permitted Facility? <input checked="" type="checkbox"/> Yes <input type="checkbox"/> No

Application Contact

1. Application Contact Name: Ashley Wright	
2. Application Contact Mailing Address... Organization/Firm: Perpetual Energy Corporation of Florida Street Address: 122 Appleyard Drive City: Tallahassee State: FL Zip Code: 32304	
3. Application Contact Telephone Numbers... Telephone: (850) 576-1221 ext.230 Fax: (850) 574-2351	
4. Application Contact Email Address: ashleyw@mckenzie-tank.com	

Application Processing Information (DEP Use)

1. Date of Receipt of Application:	
2. Project Number(s):	
3. PSD Number (if applicable):	
4. Siting Number (if applicable):	

APPLICATION INFORMATION

Purpose of Application

This application for air permit is submitted to obtain: (Check one)

Air Construction Permit

Air construction permit.

Air Operation Permit

Initial Title V air operation permit.

Title V air operation permit revision.

Title V air operation permit renewal.

Initial federally enforceable state air operation permit (FESOP) where professional engineer (PE) certification is required.

Initial federally enforceable state air operation permit (FESOP) where professional engineer (PE) certification is not required.

Air Construction Permit and Revised/Renewal Title V Air Operation Permit (Concurrent Processing)

Air construction permit and Title V permit revision, incorporating the proposed project.

Air construction permit and Title V permit renewal, incorporating the proposed project.

Note: By checking one of the above two boxes, you, the applicant, are requesting concurrent processing pursuant to Rule 62-213.405, F.A.C. In such case, you must also check the following box:

I hereby request that the department waive the processing time requirements of the air construction permit to accommodate the processing time frames of the Title V air operation permit.

Application Comment

This application is to renew Permit No. 0790011-001-AV.

APPLICATION INFORMATION

Owner/Authorized Representative Statement

Complete if applying for an air construction permit or an initial FESOP.

1. Owner/Authorized Representative Name :
2. Owner/Authorized Representative Mailing Address... Organization/Firm: Street Address: City: State: Zip Code:
3. Owner/Authorized Representative Telephone Numbers... Telephone: () - ext. Fax: () -
4. Owner/Authorized Representative Email Address:
5. Owner/Authorized Representative Statement: <i>I, the undersigned, am the owner or authorized representative of the facility addressed in this air permit application. I hereby certify, based on information and belief formed after reasonable inquiry, that the statements made in this application are true, accurate and complete and that, to the best of my knowledge, any estimates of emissions reported in this application are based upon reasonable techniques for calculating emissions. The air pollutant emissions units and air pollution control equipment described in this application will be operated and maintained so as to comply with all applicable standards for control of air pollutant emissions found in the statutes of the State of Florida and rules of the Department of Environmental Protection and revisions thereof and all other requirements identified in this application to which the facility is subject. I understand that a permit, if granted by the department, cannot be transferred without authorization from the department, and I will promptly notify the department upon sale or legal transfer of the facility or any permitted emissions unit.</i> _____ Signature _____ Date

APPLICATION INFORMATION

Application Responsible Official Certification

Complete if applying for an initial/revise/renewal Title V permit or concurrent processing of an air construction permit and a revised/renewal Title V permit. If there are multiple responsible officials, the "application responsible official" need not be the "primary responsible official."

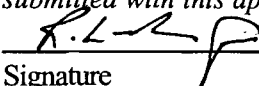
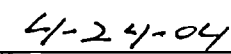
1. Application Responsible Official Name: Robert G. Landrum, Jr., President
2. Application Responsible Official Qualification (Check one or more of the following options, as applicable): <input checked="" type="checkbox"/> For a corporation, the president, secretary, treasurer, or vice-president of the corporation in charge of a principal business function, or any other person who performs similar policy or decision-making functions for the corporation, or a duly authorized representative of such person if the representative is responsible for the overall operation of one or more manufacturing, production, or operating facilities applying for or subject to a permit under Chapter 62-213, F.A.C. <input type="checkbox"/> For a partnership or sole proprietorship, a general partner or the proprietor, respectively. <input type="checkbox"/> For a municipality, county, state, federal, or other public agency, either a principal executive officer or ranking elected official. <input type="checkbox"/> The designated representative at an Acid Rain source.
3. Application Responsible Official Mailing Address... Organization/Firm: Perpetual Energy Corporation of Florida Street Address: 122 Appleyard Drive City: Tallahassee State: FL Zip Code: 32304
4. Application Responsible Official Telephone Numbers... Telephone: (850) 576-1221 ext. Fax: (850) 574-2351
5. Application Responsible Official Email Address: boblandrum@mckenzieatank.com
6. Application Responsible Official Certification: <i>I, the undersigned, am a responsible official of the Title V source addressed in this air permit application. I hereby certify, based on information and belief formed after reasonable inquiry, that the statements made in this application are true, accurate and complete and that, to the best of my knowledge, any estimates of emissions reported in this application are based upon reasonable techniques for calculating emissions. The air pollutant emissions units and air pollution control equipment described in this application will be operated and maintained so as to comply with all applicable standards for control of air pollutant emissions found in the statutes of the State of Florida and rules of the Department of Environmental Protection and revisions thereof and all other applicable requirements identified in this application to which the Title V source is subject. I understand that a permit, if granted by the department, cannot be transferred without authorization from the department, and I will promptly notify the department upon sale or legal transfer of the facility or any permitted emissions unit. Finally, I certify that the facility and each emissions unit are in compliance with all applicable requirements to which they are subject, except as identified in compliance plan(s) submitted with this application.</i>  Signature  Date

APPLICATION INFORMATION

Professional Engineer Certification

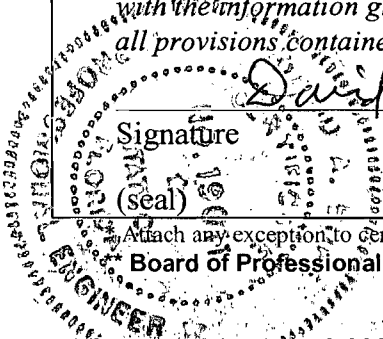
1. Professional Engineer Name: David A. Buff Registration Number: 19011
2. Professional Engineer Mailing Address... Organization/Firm: Golder Associates Inc.** Street Address: 6241 NW 23rd Street, Suite 500 City: Gainesville State: FL Zip Code: 32653
3. Professional Engineer Telephone Numbers... Telephone: (352) 336-5600 ext. 545 Fax: (352) 336-6603
4. Professional Engineer Email Address: dbuff@golder.com
5. Professional Engineer Statement: <i>I, the undersigned, hereby certify, except as particularly noted herein*, that:</i> <i>(1) To the best of my knowledge, there is reasonable assurance that the air pollutant emissions unit(s) and the air pollution control equipment described in this application for air permit, when properly operated and maintained, will comply with all applicable standards for control of air pollutant emissions found in the Florida Statutes and rules of the Department of Environmental Protection; and</i> <i>(2) To the best of my knowledge, any emission estimates reported or relied on in this application are true, accurate, and complete and are either based upon reasonable techniques available for calculating emissions or, for emission estimates of hazardous air pollutants not regulated for an emissions unit addressed in this application, based solely upon the materials, information and calculations submitted with this application.</i> <i>(3) If the purpose of this application is to obtain a Title V air operation permit (check here <input type="checkbox"/>, if so), I further certify that each emissions unit described in this application for air permit, when properly operated and maintained, will comply with the applicable requirements identified in this application to which the unit is subject, except those emissions units for which a compliance plan and schedule is submitted with this application.</i> <i>(4) If the purpose of this application is to obtain an air construction permit (check here <input type="checkbox"/>, if so) or concurrently process and obtain an air construction permit and a Title V air operation permit revision or renewal for one or more proposed new or modified emissions units (check here <input type="checkbox"/>, if so), I further certify that the engineering features of each such emissions unit described in this application have been designed or examined by me or individuals under my direct supervision and found to be in conformity with sound engineering principles applicable to the control of emissions of the air pollutants characterized in this application.</i> <i>(5) If the purpose of this application is to obtain an initial air operation permit or operation permit revision or renewal for one or more newly constructed or modified emissions units (check here <input checked="" type="checkbox"/>, if so), I further certify that, with the exception of any changes detailed as part of this application, each such emissions unit has been constructed or modified in substantial accordance with the information given in the corresponding application for air construction permit and with all provisions contained in such permit.</i>  Signature: <u>David A. Buff</u> Date: <u>4/27/04</u>

Attach any exception to certification statement.

Board of Professional Engineers Certificate of Authorization #00001670

FACILITY INFORMATION

Facility Regulatory Classifications

Check all that would apply *following* completion of all projects and implementation of all other changes proposed in this application for air permit. Refer to instructions to distinguish between a “major source” and a “synthetic minor source.”

1. <input type="checkbox"/> Small Business Stationary Source	<input type="checkbox"/> Unknown
2. <input type="checkbox"/> Synthetic Non-Title V Source	
3. <input checked="" type="checkbox"/> Title V Source	
4. <input checked="" type="checkbox"/> Major Source of Air Pollutants, Other than Hazardous Air Pollutants (HAPs)	
5. <input type="checkbox"/> Synthetic Minor Source of Air Pollutants, Other than HAPs	
6. <input checked="" type="checkbox"/> Major Source of Hazardous Air Pollutants (HAPs)	
7. <input type="checkbox"/> Synthetic Minor Source of HAPs	
8. <input type="checkbox"/> One or More Emissions Units Subject to NSPS (40 CFR Part 60)	
9. <input type="checkbox"/> One or More Emissions Units Subject to Emission Guidelines (40 CFR Part 60)	
10. <input checked="" type="checkbox"/> One or More Emissions Units Subject to NESHAP (40 CFR Part 61 or Part 63)	
11. <input type="checkbox"/> Title V Source Solely by EPA Designation (40 CFR 70.3(a)(5))	
12. Facility Regulatory Classifications Comment:	

FACILITY INFORMATION

List of Pollutants Emitted by Facility

1. Pollutant Emitted	2. Pollutant Classification	3. Emissions Cap [Y or N]?
Particulate Matter (PM)	A	N
Nitrous Oxides (NO _x)	A	N
Sulfur Dioxide (SO ₂)	A	N
Carbon Monoxide (CO)	A	N
Lead (Pb)	A	N
Hydrochloric Acid (H106)	A	N

FACILITY INFORMATION

C. FACILITY ADDITIONAL INFORMATION

Additional Requirements for All Applications, Except as Otherwise Stated

1. Facility Plot Plan: (Required for all permit applications, except Title V air operation permit revision applications if this information was submitted to the department within the previous five years and would not be altered as a result of the revision being sought) <input checked="" type="checkbox"/> Attached, Document ID: PEC-FI-C1 <input type="checkbox"/> Previously Submitted, Date:_____
2. Process Flow Diagram(s): (Required for all permit applications, except Title V air operation permit revision applications if this information was submitted to the department within the previous five years and would not be altered as a result of the revision being sought) <input checked="" type="checkbox"/> Attached, Document ID: PEC-FI-C2 <input type="checkbox"/> Previously Submitted, Date:_____
3. Precautions to Prevent Emissions of Unconfined Particulate Matter: (Required for all permit applications, except Title V air operation permit revision applications if this information was submitted to the department within the previous five years and would not be altered as a result of the revision being sought) <input checked="" type="checkbox"/> Attached, Document ID: PEC-FI-C3 <input type="checkbox"/> Previously Submitted, Date:_____

Additional Requirements for Air Construction Permit Applications

1. Area Map Showing Facility Location: <input type="checkbox"/> Attached, Document ID:_____ <input checked="" type="checkbox"/> Not Applicable (existing permitted facility)
2. Description of Proposed Construction or Modification: <input type="checkbox"/> Attached, Document ID:_____
3. Rule Applicability Analysis: <input type="checkbox"/> Attached, Document ID:_____
4. List of Exempt Emissions Units (Rule 62-210.300(3)(a) or (b)1., F.A.C.): <input type="checkbox"/> Attached, Document ID:_____ <input checked="" type="checkbox"/> Not Applicable (no exempt units at facility)
5. Fugitive Emissions Identification (Rule 62-212.400(2), F.A.C.): <input type="checkbox"/> Attached, Document ID:_____ <input checked="" type="checkbox"/> Not Applicable
6. Preconstruction Air Quality Monitoring and Analysis (Rule 62-212.400(5)(f), F.A.C.): <input type="checkbox"/> Attached, Document ID:_____ <input checked="" type="checkbox"/> Not Applicable
7. Ambient Impact Analysis (Rule 62-212.400(5)(d), F.A.C.): <input type="checkbox"/> Attached, Document ID:_____ <input checked="" type="checkbox"/> Not Applicable
8. Air Quality Impact since 1977 (Rule 62-212.400(5)(h)5., F.A.C.): <input type="checkbox"/> Attached, Document ID:_____ <input checked="" type="checkbox"/> Not Applicable
9. Additional Impact Analyses (Rules 62-212.400(5)(e)1. and 62-212.500(4)(e), F.A.C.): <input type="checkbox"/> Attached, Document ID:_____ <input checked="" type="checkbox"/> Not Applicable
10. Alternative Analysis Requirement (Rule 62-212.500(4)(g), F.A.C.): <input type="checkbox"/> Attached, Document ID:_____ <input checked="" type="checkbox"/> Not Applicable

FACILITY INFORMATION

Additional Requirements for FESOP Applications

1. List of Exempt Emissions Units (Rule 62-210.300(3)(a) or (b)1., F.A.C.):
 Attached, Document ID: _____ Not Applicable (no exempt units at facility)

Additional Requirements for Title V Air Operation Permit Applications

1. List of Insignificant Activities (Required for initial/renewal applications only):
 Attached, Document ID: **PEC-FI-CV1** Not Applicable (revision application)
2. Identification of Applicable Requirements (Required for initial/renewal applications, and for revision applications if this information would be changed as a result of the revision being sought):
 Attached, Document ID: **PEC-FI-CV2**
 Not Applicable (revision application with no change in applicable requirements)
3. Compliance Report and Plan (Required for all initial/revision/renewal applications):
 Attached, Document ID: **PEC-FI-CV3**
Note: A compliance plan must be submitted for each emissions unit that is not in compliance with all applicable requirements at the time of application and/or at any time during application processing. The department must be notified of any changes in compliance status during application processing.
4. List of Equipment/Activities Regulated under Title VI (If applicable, required for initial/renewal applications only):
 Attached, Document ID: _____
 Equipment/Activities On site but Not Required to be Individually Listed
 Not Applicable
5. Verification of Risk Management Plan Submission to EPA (If applicable, required for initial/renewal applications only) :
 Attached, Document ID: _____ Not Applicable
6. Requested Changes to Current Title V Air Operation Permit:
 Attached, Document ID: _____ Not Applicable

Additional Requirements Comment

--

ATTACHMENT PEC-FI-C1

FACILITY PLOT PLANS

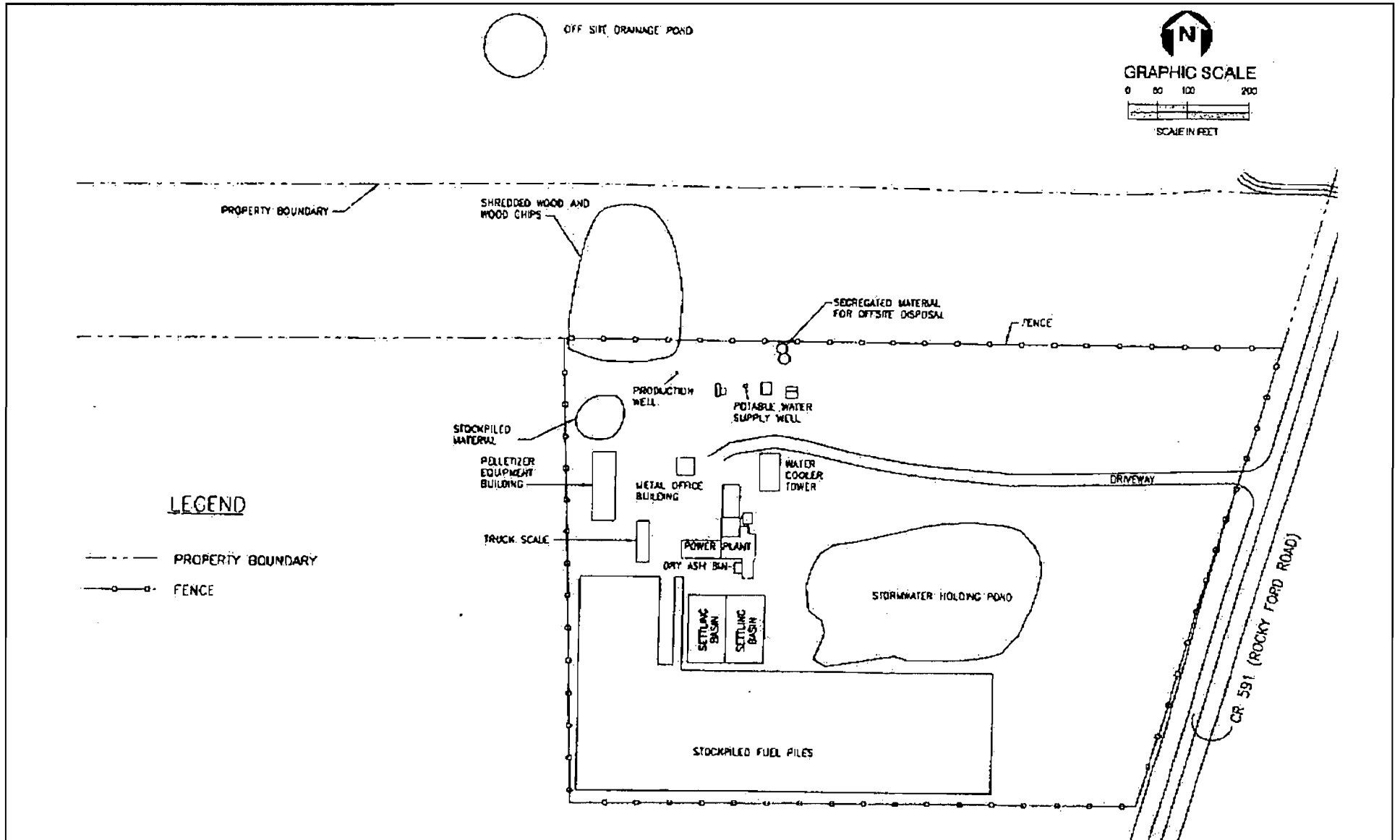

Attachment PEC-FI-C1a
 Facility Plot Plan
 Perpetual Energy Corporation of Florida, Madison Facility

Source: Baker, 2000; Golder, 2004.



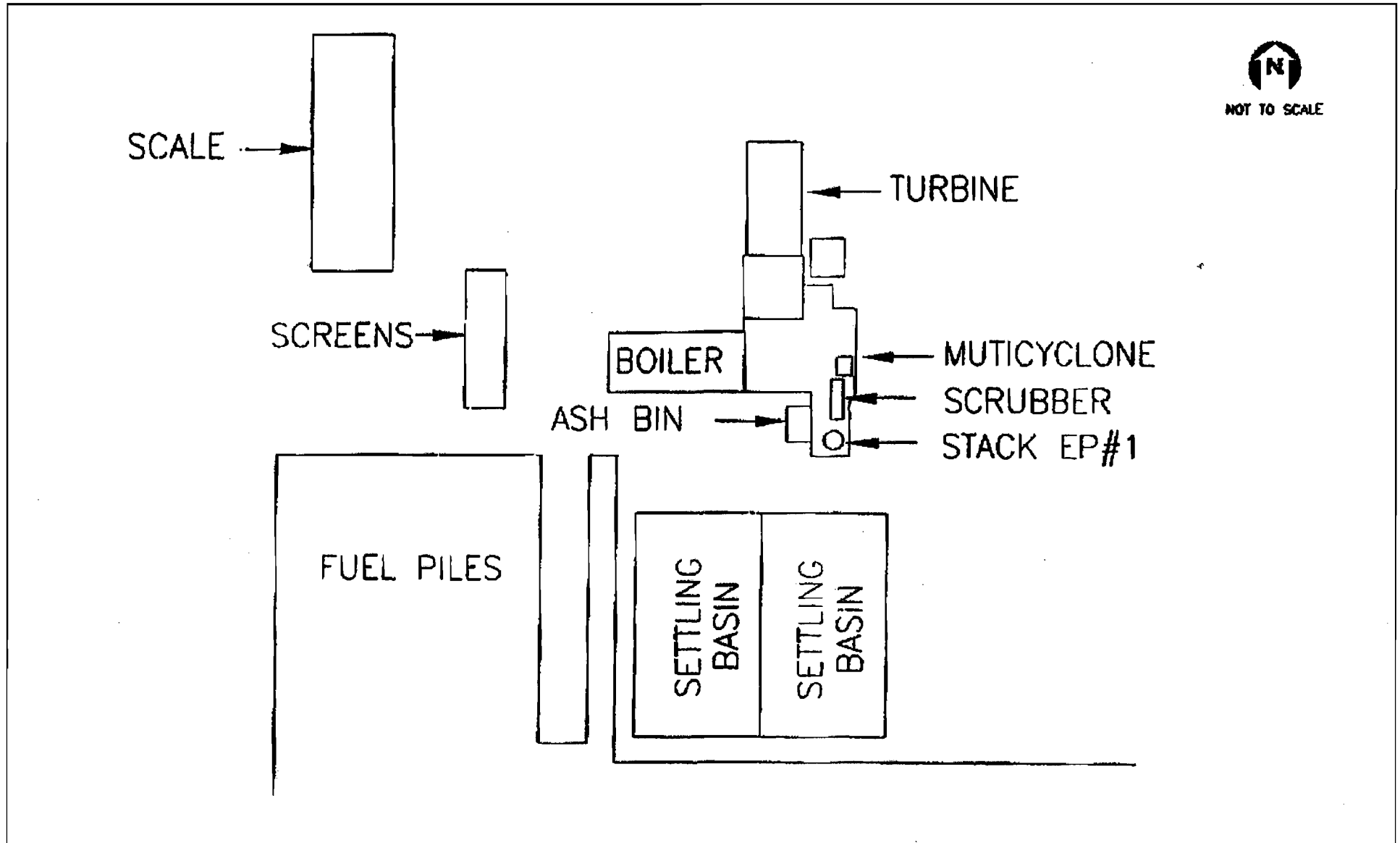

Attachment PEC-FI-C1b
Facility Plot Plan
Perpetual Energy Corporation of Florida, Madison Facility

Source: Baker, 2000; Golder, 2004.



ATTACHMENT PEC-FI-C2

PROCESS FLOW DIAGRAM

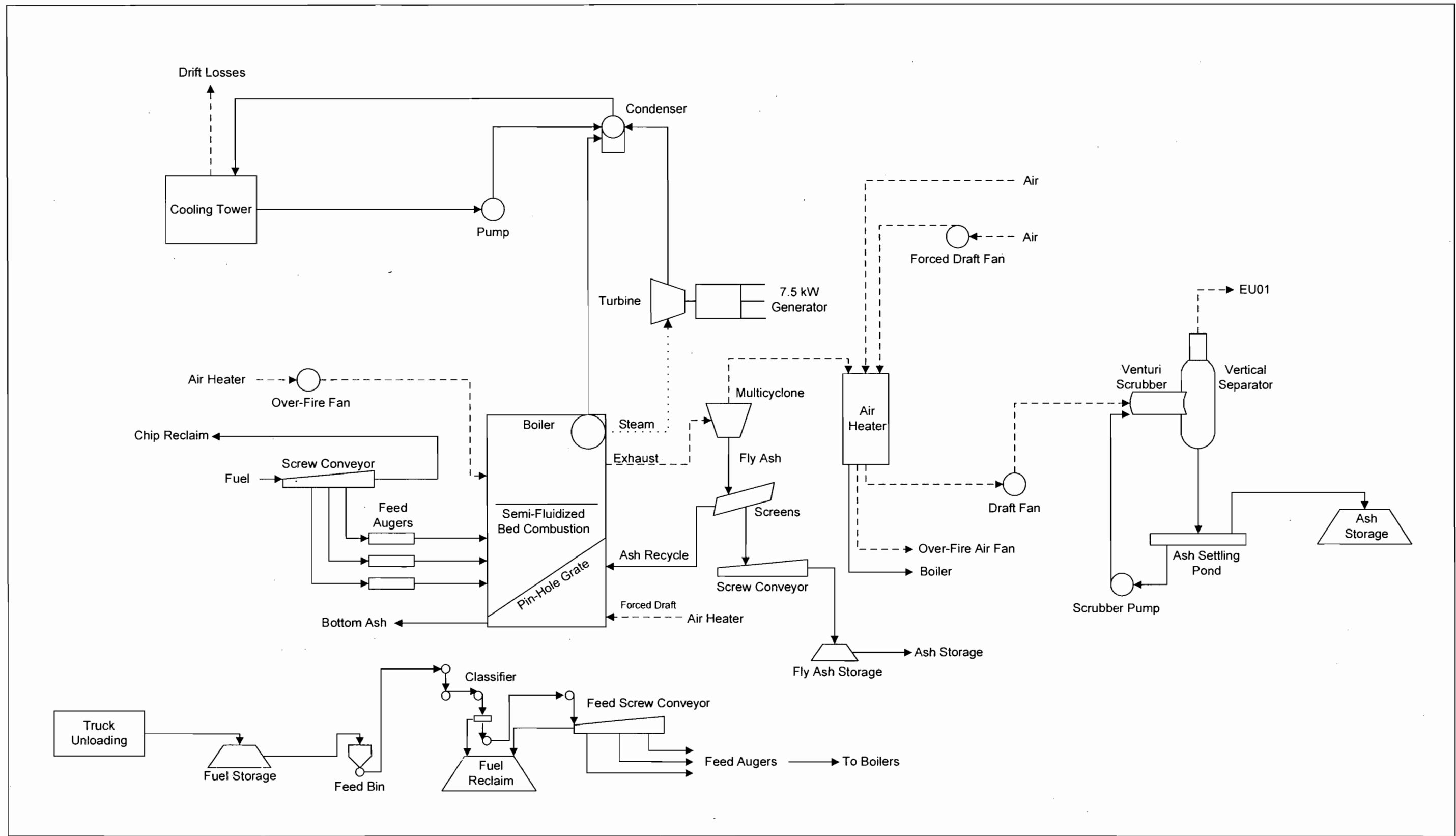

Attachment PEC-FI-C2
 Facility Process Flow Diagram
 Perpetual Energy Corporation of Florida
 Madison Facility

Process Flow Legend	
Solid/Liquid	—————▶
Gas	- - - - -▶
Steam▶

Filename: 0437572/4/4.4/PEC-FI-C2.VSD
 Date: 04/27/04



ATTACHMENT PEC-FI-C3

**PRECAUTIONS TO PREVENT EMISSIONS
OF UNCONFINED PARTICULATE MATTER**

ATTACHMENT PEC-FI-C3**PRECAUTIONS TO PREVENT EMISSIONS
OF UNCONFINED PARTICULATE MATTER**

Reasonable precautions to prevent emissions of unconfined particulate matter at this facility include:

1. Fuel unloading and transfer operations:

Water will be kept available during fuel unloading and transfer operations to suppress any fugitive emissions generated by these operations. Application of the water will be on an as needed basis (manual operation).

2. Ash transfer points/storage:

Ash transfer points will be protected by the wind. Ash storage containers will be kept closed when not in use.

3. Other sources:

Dust suppressants will be applied to all areas necessary to reasonably control such emissions.

ATTACHMENT PEC-FI-CV1

LIST OF INSIGNIFICANT ACTIVITIES

ATTACHMENT PEC-FI-CV1**LIST OF ACTIVITIES THAT MAY BE TREATED AS "TRIVIAL"**

The following types of activities and emissions units may be presumptively omitted from part 70 permit applications. Certain of these listed activities include qualifying statements intended to exclude many similar activities.

Combustion emissions from propulsion of mobile sources, except for vessel emissions from Outer Continental Shelf sources.

Air-conditioning units used for human comfort that do not have applicable requirements under title VI of the Act.

Ventilating units used for human comfort that do not exhaust air pollutants into the ambient air from any manufacturing/industrial or commercial process.

Non-commercial food preparation.

Consumer use of office equipment and products, not including printers or businesses primarily involved in photographic reproduction.

Janitorial services and consumer use of janitorial products.

Internal combustion engines used for landscaping purposes.

~~Laundry activities, except for dry-cleaning and steam boilers.~~

Bathroom/toilet vent emissions.

~~Emergency (backup) electrical generators at residential locations.~~

Tobacco smoking rooms and areas.

~~Blacksmith forges.~~

Plant maintenance and upkeep activities (e.g., groundskeeping, general repairs, cleaning, painting, welding, plumbing, re-tarring roofs, installing insulation, and paving parking lots) provided these activities are not conducted as part of a manufacturing process, are not related to the source's primary business activity, and not otherwise triggering a permit modification.¹

Repair or maintenance shop activities not related to the source's primary business activity, not including emissions from surface coating or de-greasing (solvent metal cleaning) activities, and not otherwise triggering a permit modification.

Portable electrical generators that can be moved by hand from one location to another².

Hand-held equipment for buffing, polishing, cutting, drilling, sawing, grinding, turning or machining wood, metal or plastic.

Brazing, soldering and welding equipment, and cutting torches related to manufacturing and construction activities that do not result in emission of HAP metals.³

Air compressors and pneumatically operated equipment, including hand tools.

Batteries and battery charging stations, except at battery manufacturing plants.

Storage tanks, vessels, and containers holding or storing liquid substances that will not emit any VOC or HAP.⁴

¹ Cleaning and painting activities qualify if they are not subject to VOC or HAP control requirements. Asphalt batch plant owners/operators must still get a permit if otherwise required.

² "Moved by hand" means that it can be moved without the assistance of any motorized or non-motorized vehicle, conveyance, or device.

³ Brazing, soldering and welding equipment, and cutting torches related to manufacturing and construction activities that emit HAP metals are more appropriate for treatment as insignificant activities based on size or production level thresholds. Brazing, soldering, welding and cutting torches directly related to plant maintenance and upkeep and repair or maintenance shop activities that emit HAP metals are treated as trivial and listed separately in this appendix.

⁴ Exemptions for storage tanks containing petroleum liquids or other volatile organic liquids should be based on size limits such as storage tank capacity and vapor pressure of liquids stored and are not appropriate for this list.

Storage tanks, reservoirs, and pumping and handling equipment of any size containing soaps, vegetable oil, grease, animal fat, and nonvolatile aqueous salt solutions, provided appropriate lids and covers are utilized.

Equipment used to mix and package, soaps, vegetable oil, grease, animal fat, and nonvolatile aqueous salt solutions, provided appropriate lids and covers are utilized.

~~Drop hammers or hydraulic presses for forging or metalworking.~~

~~Equipment used exclusively to slaughter animals, but not including other equipment at slaughterhouses, such as rendering cookers, boilers, heating plants, incinerators, and electrical power generating equipment.~~

Vents from continuous emissions monitors and other analyzers.

~~Natural gas pressure regulator vents, excluding venting at oil and gas production facilities.~~

Hand-held applicator equipment for hot melt adhesives with no VOC in the adhesive formulation.

Equipment used for surface coating, painting, dipping or spraying operations, except those that will emit VOC or HAP.

~~CO2 lasers, used only on metals and other materials which do not emit HAP in the process.~~

Consumer use of paper trimmers/binders.

~~Electric or steam heated drying ovens and autoclaves, but not the emissions from the articles or substances being processed in the ovens or autoclaves or the boilers delivering the steam.~~

Salt baths using nonvolatile salts that do not result in emissions of any regulated air pollutants.

~~Laser trimmers using dust collection to prevent fugitive emissions.~~

Bench-scale laboratory equipment used for physical or chemical analysis, but not lab fume hoods or vents.

Routine calibration and maintenance of laboratory equipment or other analytical instruments.

Equipment used for quality control/assurance or inspection purposes, including sampling equipment used to withdraw materials for analysis.

Hydraulic and hydrostatic testing equipment.

Environmental chambers not using hazardous air pollutant (HAP) gasses.

~~Shock chambers.~~

~~Humidity chambers.~~

~~Solar simulators.~~

Fugitive emission related to movement of passenger vehicles, provided the emissions are not counted for applicability purposes and any required fugitive dust control plan or its equivalent is submitted.

Process water filtration systems and demineralizes.

Demineralized water tanks and demineralizer vents.

Boiler water treatment operations, not including cooling towers.

~~Oxygen scavenging (de-aeration) of water.~~

~~Ozone generators.~~

Fire suppression systems.

~~Emergency road flares.~~

Steam vents and safety relief valves.

Steam leaks.

Steam cleaning operations.

~~Steam sterilizers.~~

ATTACHMENT PEC-FI-CV2

IDENTIFICATION OF APPLICABLE REQUIREMENTS

ATTACHMENT PEC-FI-CV2
EMISSIONS UNIT REGULATIONS

Carbonaceous Fuel Fired Boiler

List of Applicable Regulations

62-4.040(1)(b)	62-297.310
62-4.130	62-297.310(1)
62-4.160(2)	62-297.310(2)
62-204.800(7)	62-297.310(2)(b)
62-210.200	62-297.310(3)
62-210.300(2)(a)3.b	62-297.310(4)(a)2
62-210.300(2)(a)3.c	62-297.310(4)(a)2.c.
62-210.300(2)(a)3.d	62-297.310(5)
62-210.300(2)(a)4	62-297.310(7)
62-210.300(3)(a)	62-297.310(7)(a)1
62-210.300(4)	62-297.310(7)(a)4.b.
62-210.700(1)	62-297.310(7)(b)
62-210.700(4)	62-297.310(8)
62-210.700(6)	62-297.401
62-213.410	62-297.620
62-213.430(6)	40 CFR 60.7
62-213.440	40 CFR 60.15(a)
62-213.440(1)	40 CFR 60.15(b)
62-213.440(2)	40 CFR 60.15(b)1
62-296.320(2)	40 CFR 60.15(d)(1)
62-296.320(4)(b)1	40 CFR 60.15(d)(2)
62-296.320(4)(b)4	40 CFR 60.15(d)(3)
62-296.320(4)(c)2	40 CFR 60.15(d)(4)
62-296.405(2)(a)	40 CFR 60.15(d)(5)
62-296.410	40 CFR 60.15(d)(6)
62-296.410(2)(b)1	40 CFR 60.15(d)(7)
62-296.410(2)(b)2	40 CFR 68
62-297	

ATTACHMENT PEC-FI-CV3

COMPLIANCE REPORT AND PLAN

ATTACHMENT PEC-FI-CV3**COMPLIANCE REPORT AND PLAN**

Perpetual Energy Corporation of Florida certifies that the Madison facility, as of the date of this application, is in compliance with each applicable requirement addressed in this Title V air permit application.

I, the undersigned, am the responsible official as defined in Chapter 62-213, F.A.C., of the Title V source for which this report is being submitted. I hereby certify, based on information and belief formed after reasonable inquiry, that the statements made and data contained in this report are true, accurate, and complete.

Compliance statements for this facility will be submitted on an annual basis to FDEP, before March 1st of each year.

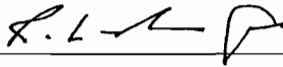

Signature, Responsible Official

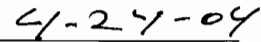

Date

EMISSIONS UNIT INFORMATION

Section [1] of [2]
Carbonaceous Fuel-Fired Boiler

III. EMISSIONS UNIT INFORMATION

Title V Air Operation Permit Application - For Title V air operation permitting only, emissions units are classified as regulated, unregulated, or insignificant. If this is an application for Title V air operation permit, a separate Emissions Unit Information Section (including subsections A through I as required) must be completed for each regulated and unregulated emissions unit addressed in this application for air permit. Some of the subsections comprising the Emissions Unit Information Section of the form are optional for unregulated emissions units. Each such subsection is appropriately marked. Insignificant emissions units are required to be listed at Section II, Subsection C.

Air Construction Permit or FESOP Application - For air construction permitting or federally enforceable state air operation permitting, emissions units are classified as either subject to air permitting or exempt from air permitting. The concept of an "unregulated emissions unit" does not apply. If this is an application for air construction permit or FESOP, a separate Emissions Unit Information Section (including subsections A through I as required) must be completed for each emissions unit subject to air permitting addressed in this application for air permit. Emissions units exempt from air permitting are required to be listed at Section II, Subsection C.

Air Construction Permit and Revised/Renewal Title V Air Operation Permit Application - Where this application is used to apply for both an air construction permit and a revised/renewal Title V air operation permit, each emissions unit is classified as either subject to air permitting or exempt from air permitting for air construction permitting purposes and as regulated, unregulated, or insignificant for Title V air operation permitting purposes. **The air construction permitting classification must be used to complete the Emissions Unit Information Section of this application for air permit.** A separate Emissions Unit Information Section (including subsections A through I as required) must be completed for each emissions unit subject to air permitting addressed in this application for air permit. Emissions units exempt from air construction permitting and insignificant emissions units are required to be listed at Section II, Subsection C.

If submitting the application form in hard copy, the number of this Emissions Unit Information Section and the total number of Emissions Unit Information Sections submitted as part of this application must be indicated in the space provided at the top of each page.

EMISSIONS UNIT INFORMATION

Section [1] of [2]
Carbonaceous Fuel-Fired Boiler

A. GENERAL EMISSIONS UNIT INFORMATION

Title V Air Operation Permit Emissions Unit Classification

1. Regulated or Unregulated Emissions Unit? (Check one, if applying for an initial, revised or renewal Title V air operation permit. Skip this item if applying for an air construction permit or FESOP only.)
- The emissions unit addressed in this Emissions Unit Information Section is a regulated emissions unit.
 - The emissions unit addressed in this Emissions Unit Information Section is an unregulated emissions unit.

Emissions Unit Description and Status

1. Type of Emissions Unit Addressed in this Section: (Check one)
- This Emissions Unit Information Section addresses, as a single emissions unit, a single process or production unit, or activity, which produces one or more air pollutants and which has at least one definable emission point (stack or vent).
 - This Emissions Unit Information Section addresses, as a single emissions unit, a group of process or production units and activities which has at least one definable emission point (stack or vent) but may also produce fugitive emissions.
 - This Emissions Unit Information Section addresses, as a single emissions unit, one or more process or production units and activities which produce fugitive emissions only.

2. Description of Emissions Unit Addressed in this Section:
Carbonaceous Fuel-Fired Boiler

3. Emissions Unit Identification Number: **001**

4. Emissions Unit Status Code: A	5. Commence Construction Date:	6. Initial Startup Date:	7. Emissions Unit Major Group SIC Code: 49	8. Acid Rain Unit? <input type="checkbox"/> Yes <input checked="" type="checkbox"/> No
--	--------------------------------	--------------------------	--	--

9. Package Unit:
Manufacturer: _____ Model Number: _____

10. Generator Nameplate Rating: _____ MW

11. Emissions Unit Comment:

EMISSIONS UNIT INFORMATION

Section [1] of [2]
Carbonaceous Fuel-Fired Boiler

Emissions Unit Control Equipment

1. Control Equipment/Method(s) Description:

Multicyclone

Wet venturi scrubber

2. Control Device or Method Code(s): **076, 053**

EMISSIONS UNIT INFORMATION

Section [1] of [2]
 Carbonaceous Fuel-Fired Boiler

C. EMISSION POINT (STACK/VENT) INFORMATION
 (Optional for unregulated emissions units.)

Emission Point Description and Type

1. Identification of Point on Plot Plan or Flow Diagram: EP#1		2. Emission Point Type Code: 1	
3. Descriptions of Emission Points Comprising this Emissions Unit for VE Tracking:			
4. ID Numbers or Descriptions of Emission Units with this Emission Point in Common:			
5. Discharge Type Code: V	6. Stack Height: 69 feet	7. Exit Diameter: 5.8 feet	
8. Exit Temperature: 180°F	9. Actual Volumetric Flow Rate: 60,400 acfm	10. Water Vapor: 22.6 %	
11. Maximum Dry Standard Flow Rate: 38,700 dscfm		12. Nonstack Emission Point Height: feet	
13. Emission Point UTM Coordinates... Zone: East (km): North (km):		14. Emission Point Latitude/Longitude... Latitude (DD/MM/SS) Longitude (DD/MM/SS)	
15. Emission Point Comment:			

EMISSIONS UNIT INFORMATION

Section [1] of [2]
 Carbonaceous Fuel-Fired Boiler

D. SEGMENT (PROCESS/FUEL) INFORMATION**Segment Description and Rate:** Segment 1 of 2

1. Segment Description (Process/Fuel Type): External Combustion Boiler Firing 100% Wood / Wood Waste		
2. Source Classification Code (SCC): 1-02-009-03		3. SCC Units: Tons (burned)
4. Maximum Hourly Rate: 20.55	5. Maximum Annual Rate: 172,620	6. Estimated Annual Activity Factor:
7. Maximum % Sulfur:	8. Maximum % Ash:	9. Million Btu per SCC Unit: 9.0
10. Segment Comment: The maximum hourly and annual rates are based on 8,400 hr/yr operation. The heat content is based on 4,500 Btu/lb for wood.		

Segment Description and Rate: Segment 2 of 2

1. Segment Description (Process/Fuel Type): External Combustion Boiler Firing 65% Paper (maximum) and 35% Wood (minimum)		
2. Source Classification Code (SCC): 1-02-009-03		3. SCC Units: Tons (burned)
4. Maximum Hourly Rate: 16.97	5. Maximum Annual Rate: 142,548	6. Estimated Annual Activity Factor:
7. Maximum % Sulfur:	8. Maximum % Ash:	9. Million Btu per SCC Unit: 11.9
10. Segment Comment: The maximum hourly and annual rates are based on 8,400 hr/yr operation. The heat content is based on 5,962 Btu/lb for paper and 4,500 Btu/lb for wood.		

EMISSIONS UNIT INFORMATION

POLLUTANT DETAIL INFORMATION

Section [1] of [2]
Carbonaceous Fuel-Fired Boiler

Page [1] of [1]
Particulate Matter

**F1. EMISSIONS UNIT POLLUTANT DETAIL INFORMATION –
POTENTIAL/ESTIMATED FUGITIVE EMISSIONS**

(Optional for unregulated emissions units.)

Potential/Estimated Fugitive Emissions

Complete for each pollutant identified in Subsection E if applying for an air construction permit or concurrent processing of an air construction permit and a revised or renewal Title V permit. Complete for each emissions-limited pollutant identified in Subsection E if applying for an air operation permit.

1. Pollutant Emitted: PM	2. Total Percent Efficiency of Control:	
3. Potential Emissions: 37 lb/hour 155.4 tons/year		4. Synthetically Limited? <input checked="" type="checkbox"/> Yes <input type="checkbox"/> No
5. Range of Estimated Fugitive Emissions (as applicable): to tons/year		
6. Emission Factor: 0.2 lb/MMBtu Reference: Permit Limit		7. Emissions Method Code: 0
8. Calculation of Emissions: Hourly: 0.2 lb/MMBtu x 185 MMBtu/hr = 37 lb/hr Annual: 37 lb/hr x 8,400 hr/yr ÷ 2,000 lb/ton = 155.4 TPY		
9. Pollutant Potential/Estimated Fugitive Emissions Comment:		

EMISSIONS UNIT INFORMATION

Section [1] of [2]
Carbonaceous Fuel-Fired Boiler

POLLUTANT DETAIL INFORMATION

Page [1] of [1]
Particulate Matter

**F2. EMISSIONS UNIT POLLUTANT DETAIL INFORMATION -
ALLOWABLE EMISSIONS**

Complete if the pollutant identified in Subsection F1 is or would be subject to a numerical emissions limitation.

Allowable Emissions Allowable Emissions 1 of 1

1. Basis for Allowable Emissions Code: RULE	2. Future Effective Date of Allowable Emissions:
3. Allowable Emissions and Units: 0.2 lb/MMBtu	4. Equivalent Allowable Emissions: 37 lb/hour 155.4 tons/year
5. Method of Compliance: Annual compliance test following DEP Method 5.	
6. Allowable Emissions Comment (Description of Operating Method): Permit No. 0790011-001-AV and Rule 62.296.410(2)(b)2., F.A.C.	

Allowable Emissions Allowable Emissions _____ of _____

1. Basis for Allowable Emissions Code:	2. Future Effective Date of Allowable Emissions:
3. Allowable Emissions and Units:	4. Equivalent Allowable Emissions: lb/hour tons/year
5. Method of Compliance:	
6. Allowable Emissions Comment (Description of Operating Method):	

Allowable Emissions Allowable Emissions _____ of _____

1. Basis for Allowable Emissions Code:	2. Future Effective Date of Allowable Emissions:
3. Allowable Emissions and Units:	4. Equivalent Allowable Emissions: lb/hour tons/year
5. Method of Compliance:	
6. Allowable Emissions Comment (Description of Operating Method):	

EMISSIONS UNIT INFORMATION

Section [1] of [2]
Carbonaceous Fuel-Fired Boiler

H. CONTINUOUS MONITOR INFORMATION

Complete if this emissions unit is or would be subject to continuous monitoring.

Continuous Monitoring System: Continuous Monitor ____ of ____

1. Parameter Code:	2. Pollutant(s):
3. CMS Requirement:	<input type="checkbox"/> Rule <input type="checkbox"/> Other
4. Monitor Information... Manufacturer: Model Number: Serial Number:	
5. Installation Date:	6. Performance Specification Test Date:
7. Continuous Monitor Comment:	

Continuous Monitoring System: Continuous Monitor ____ of ____

1. Parameter Code:	2. Pollutant(s):
3. CMS Requirement:	<input type="checkbox"/> Rule <input type="checkbox"/> Other
4. Monitor Information... Manufacturer: Model Number: Serial Number:	
5. Installation Date:	6. Performance Specification Test Date:
7. Continuous Monitor Comment:	

EMISSIONS UNIT INFORMATION

Section [1] of [2]
Carbonaceous Fuel-Fired Boiler

I. EMISSIONS UNIT ADDITIONAL INFORMATION

Additional Requirements for All Applications, Except as Otherwise Stated

1. Process Flow Diagram (Required for all permit applications, except Title V air operation permit revision applications if this information was submitted to the department within the previous five years and would not be altered as a result of the revision being sought) <input checked="" type="checkbox"/> Attached, Document ID: PEC-FI-C2 <input type="checkbox"/> Previously Submitted, Date _____
2. Fuel Analysis or Specification (Required for all permit applications, except Title V air operation permit revision applications if this information was submitted to the department within the previous five years and would not be altered as a result of the revision being sought) <input checked="" type="checkbox"/> Attached, Document ID: PEC-EU1-I2 <input type="checkbox"/> Previously Submitted, Date _____
3. Detailed Description of Control Equipment (Required for all permit applications, except Title V air operation permit revision applications if this information was submitted to the department within the previous five years and would not be altered as a result of the revision being sought) <input checked="" type="checkbox"/> Attached, Document ID: PEC-EU1-I3 <input type="checkbox"/> Previously Submitted, Date _____
4. Procedures for Startup and Shutdown (Required for all operation permit applications, except Title V air operation permit revision applications if this information was submitted to the department within the previous five years and would not be altered as a result of the revision being sought) <input type="checkbox"/> Attached, Document ID: _____ <input type="checkbox"/> Previously Submitted, Date _____ <input type="checkbox"/> Not Applicable (construction application)
5. Operation and Maintenance Plan (Required for all permit applications, except Title V air operation permit revision applications if this information was submitted to the department within the previous five years and would not be altered as a result of the revision being sought) <input type="checkbox"/> Attached, Document ID: _____ <input type="checkbox"/> Previously Submitted, Date _____ <input checked="" type="checkbox"/> Not Applicable
6. Compliance Demonstration Reports/Records <input type="checkbox"/> Attached, Document ID: _____ Test Date(s)/Pollutant(s) Tested: _____ <input type="checkbox"/> Previously Submitted, Date: _____ Test Date(s)/Pollutant(s) Tested: _____ <input type="checkbox"/> To be Submitted, Date (if known): _____ Test Date(s)/Pollutant(s) Tested: _____ <input checked="" type="checkbox"/> Not Applicable Note: For FESOP applications, all required compliance demonstration records/reports must be submitted at the time of application. For Title V air operation permit applications, all required compliance demonstration reports/records must be submitted at the time of application, or a compliance plan must be submitted at the time of application.
7. Other Information Required by Rule or Statute <input type="checkbox"/> Attached, Document ID: _____ <input checked="" type="checkbox"/> Not Applicable

EMISSIONS UNIT INFORMATION

Section [1] of [2]
Carbonaceous Fuel-Fired Boiler

Additional Requirements for Air Construction Permit Applications

1. Control Technology Review and Analysis (Rules 62-212.400(6) and 62-212.500(7), F.A.C.; 40 CFR 63.43(d) and (e)) <input type="checkbox"/> Attached, Document ID: _____ <input type="checkbox"/> Not Applicable
2. Good Engineering Practice Stack Height Analysis (Rule 62-212.400(5)(h)6., F.A.C., and Rule 62-212.500(4)(f), F.A.C.) <input type="checkbox"/> Attached, Document ID: _____ <input type="checkbox"/> Not Applicable
3. Description of Stack Sampling Facilities (Required for proposed new stack sampling facilities only) <input type="checkbox"/> Attached, Document ID: _____ <input type="checkbox"/> Not Applicable

Additional Requirements for Title V Air Operation Permit Applications

1. Identification of Applicable Requirements <input checked="" type="checkbox"/> Attached, Document ID: PEC-FI-CV2 <input type="checkbox"/> Not Applicable
2. Compliance Assurance Monitoring <input checked="" type="checkbox"/> Attached, Document ID: PEC-EU1-IV2 <input type="checkbox"/> Not Applicable
3. Alternative Methods of Operation <input checked="" type="checkbox"/> Attached, Document ID: PEC-EU1-IV3 <input type="checkbox"/> Not Applicable
4. Alternative Modes of Operation (Emissions Trading) <input type="checkbox"/> Attached, Document ID: _____ <input checked="" type="checkbox"/> Not Applicable
5. Acid Rain Part Application <input type="checkbox"/> Certificate of Representation (EPA Form No. 7610-1) <input type="checkbox"/> Copy Attached, Document ID: _____ <input type="checkbox"/> Acid Rain Part (Form No. 62-210.900(1)(a)) <input type="checkbox"/> Attached, Document ID: _____ <input type="checkbox"/> Previously Submitted, Date: _____ <input type="checkbox"/> Repowering Extension Plan (Form No. 62-210.900(1)(a)1.) <input type="checkbox"/> Attached, Document ID: _____ <input type="checkbox"/> Previously Submitted, Date: _____ <input type="checkbox"/> New Unit Exemption (Form No. 62-210.900(1)(a)2.) <input type="checkbox"/> Attached, Document ID: _____ <input type="checkbox"/> Previously Submitted, Date: _____ <input type="checkbox"/> Retired Unit Exemption (Form No. 62-210.900(1)(a)3.) <input type="checkbox"/> Attached, Document ID: _____ <input type="checkbox"/> Previously Submitted, Date: _____ <input type="checkbox"/> Phase II NOx Compliance Plan (Form No. 62-210.900(1)(a)4.) <input type="checkbox"/> Attached, Document ID: _____ <input type="checkbox"/> Previously Submitted, Date: _____ <input type="checkbox"/> Phase II NOx Averaging Plan (Form No. 62-210.900(1)(a)5.) <input type="checkbox"/> Attached, Document ID: _____ <input type="checkbox"/> Previously Submitted, Date: _____ <input checked="" type="checkbox"/> Not Applicable

EMISSIONS UNIT INFORMATION

Section [1] of [2]
Carbonaceous Fuel-Fired Boiler

Additional Requirements Comment

ATTACHMENT PEC-EU1-I2

**CARBONACEOUS FUEL-FIRED BOILER
FUEL ANALYSIS**

ATTACHMENT PEC-EU1-I2**CARBONACEOUS FUEL-FIRED BOILER****FUEL ANALYSIS**

Fuel	Density (lb/gal)	Moisture (%)	Weight % Sulfur	Weight % Ash	Heat Capacity (Btu/lb)
Paper	----	17.07	0.15	12.17	5,962
Wood	----	50	0	0.27	4,500

ATTACHMENT PEC-EU1-I3

CONTROL EQUIPMENT DESCRIPTION

Attachment PEC-EU1-I3. Control Equipment Description for the Venturi Scrubber

Manufacturer	Perry Smith Company	
Model No.	SOM	
Outlet Gas Temperature	350	°F
Outlet Gas Flow Rate	64,600	acfm
Pressure Drop Across Device - Minimum	6	inches of H ₂ O
Liquid Flow-Rate - Maximum	600	GPM
Control Efficiency	>90	%

NOTE: All data based on design data from original Title V permit application.

ATTACHMENT PEC-EU1-IV2

COMPLIANCE ASSURANCE MONITORING PLAN

ATTACHMENT PEC-EU1-IV2**COMPLIANCE ASSURANCE MONITORING PLAN:
PM EMISSIONS FROM THE BOILER****I. Background****A. Emissions Unit**

Description: Carbonaceous Fuel-Fired Boiler
EU ID: 001
Facility: Perpetual Energy Corporation of Florida
Madison, FL

B. Applicable Regulation, Emission Limits, and Monitoring Requirements

Regulations: Permit No. 0790011-001-AV

Emissions Limits:
Particulate Matter: 0.2 lb/MMBtu, 37 lb/hr, and 155.4 TPY [Rule 62-296.410(2)(b)2., Perpetual Energy Corporation Letter dated September 10, 1999; Air Construction Permit AC40-248258]

C. Control Technology

Particulate matter emissions from the boiler are controlled by a multicyclone and wet venturi scrubber in series. The multicyclone is considered inherent process equipment and not control equipment since it recovers ash and recycles it back to the boiler to enhance the combustion efficiency and promotes complete carbon burnout.

II. Monitoring Approach

	Indicator No. 1
I. Indicator	Pressure drop across the scrubber.
A. Measurement Approach	The pressure drop is monitored with a differential pressure transmitter.
II. Indicator Range	An excursion is defined as operation at a daily average pressure drop below 110% of the value determined from initial compliance testing. Excursions trigger an inspection, corrective action, and a reporting requirement.
III. Performance Criteria	
A. Data Representativeness	The minimum accuracy of the device is $\pm 5\%$.
B. Verification of Operation Status	NA
C. QA/QC Practices and Criteria	The differential pressure transmitter is calibrated at least annually.
D. Monitoring Frequency	The pressure drop is monitored continuously.
E. Data Collection Procedures	Scrubber pressure drop is recorded every 15-minutes. 3-hour averages are computed.
F. Averaging Period	3-hour average based on 15-minute readings.

III. Monitoring Rationale

A. Background

Perpetual Energy operates a carbonaceous fuel-fired boiler. The boiler has a federally enforceable emissions limit for PM and uses control devices to comply with this emissions limit. Uncontrolled PM emissions are greater than the major source threshold (since controlled emissions are greater than major source threshold), thus a CAM plan is required for this source for PM.

B. Rationale for Selection of Performance Indicators

The performance indicator selected is total gas pressure drop. Pressure drop was selected as a performance indicator because it indicates the level of impaction energy in the throat of the venturi scrubber. The energy in the throat is an indication of pollutant removal efficiency. If pressure drop is too low, proper pollutant removal will not occur.

C. Rationale for Selection of Indicator Ranges

The indicator range for pressure drop for the scrubber will be determined during initial compliance testing. Perpetual Energy has not operated in the past three years and therefore at this time does not have representative compliance test data to support numerical indicator ranges. Upon startup of the facility, compliance testing will be performed, and proposed numerical indicator ranges will be submitted to the Department.

An excursion is defined as operation of a 3-hour average pressure drop outside of the indicator range (determined during compliance testing). When an excursion occurs, corrective action will be initiated, beginning with an evaluation of the occurrence to determine the action required to correct the situation. All excursions will be documented and reported.

ATTACHMENT PEC-EU1-IV3

ALTERNATIVE METHODS OF OPERATION

ATTACHMENT PEC-EU1-IV3**ALTERNATIVE METHODS OF OPERATION**

The boiler operates by combusting only carbonaceous fuels defined as wood, bark, paper, and waste wood with a capacity of 8,400 hr/yr. The two alternative modes of operation used are described here.

1. Combustion of 100-percent wood and/or wood waste, not to exceed 20.55 TPH or 172,620 TPY of fuel combusted, which is equivalent to the maximum heat input of 185 MMBtu/hr, based on 4,500 Btu/lb of wood.
2. Combustion of a combination of paper (65%, maximum) and wood (35%, minimum), not to exceed 16.97 TPH or 142,548 TPY of fuel combusted, which is equivalent to the maximum heat input rate of 185 MMBtu/hr, based on 4,500 Btu/lb of wood and 5,962 Btu/lb of paper.

EMISSIONS UNIT INFORMATION

Section [2] of [2]
Facility-wide Unregulated Emissions

III. EMISSIONS UNIT INFORMATION

Title V Air Operation Permit Application - For Title V air operation permitting only, emissions units are classified as regulated, unregulated, or insignificant. If this is an application for Title V air operation permit, a separate Emissions Unit Information Section (including subsections A through I as required) must be completed for each regulated and unregulated emissions unit addressed in this application for air permit. Some of the subsections comprising the Emissions Unit Information Section of the form are optional for unregulated emissions units. Each such subsection is appropriately marked. Insignificant emissions units are required to be listed at Section II, Subsection C.

Air Construction Permit or FESOP Application - For air construction permitting or federally enforceable state air operation permitting, emissions units are classified as either subject to air permitting or exempt from air permitting. The concept of an "unregulated emissions unit" does not apply. If this is an application for air construction permit or FESOP, a separate Emissions Unit Information Section (including subsections A through I as required) must be completed for each emissions unit subject to air permitting addressed in this application for air permit. Emissions units exempt from air permitting are required to be listed at Section II, Subsection C.

Air Construction Permit and Revised/Renewal Title V Air Operation Permit Application - Where this application is used to apply for both an air construction permit and a revised/renewal Title V air operation permit, each emissions unit is classified as either subject to air permitting or exempt from air permitting for air construction permitting purposes and as regulated, unregulated, or insignificant for Title V air operation permitting purposes. **The air construction permitting classification must be used to complete the Emissions Unit Information Section of this application for air permit.** A separate Emissions Unit Information Section (including subsections A through I as required) must be completed for each emissions unit subject to air permitting addressed in this application for air permit. Emissions units exempt from air construction permitting and insignificant emissions units are required to be listed at Section II, Subsection C.

If submitting the application form in hard copy, the number of this Emissions Unit Information Section and the total number of Emissions Unit Information Sections submitted as part of this application must be indicated in the space provided at the top of each page.

EMISSIONS UNIT INFORMATION

Section [2] of [2]
Facility-wide Unregulated Emissions

A. GENERAL EMISSIONS UNIT INFORMATION

Title V Air Operation Permit Emissions Unit Classification

1. Regulated or Unregulated Emissions Unit? (Check one, if applying for an initial, revised or renewal Title V air operation permit. Skip this item if applying for an air construction permit or FESOP only.)

The emissions unit addressed in this Emissions Unit Information Section is a regulated emissions unit.

The emissions unit addressed in this Emissions Unit Information Section is an unregulated emissions unit.

Emissions Unit Description and Status

1. Type of Emissions Unit Addressed in this Section: (Check one)

This Emissions Unit Information Section addresses, as a single emissions unit, a single process or production unit, or activity, which produces one or more air pollutants and which has at least one definable emission point (stack or vent).

This Emissions Unit Information Section addresses, as a single emissions unit, a group of process or production units and activities which has at least one definable emission point (stack or vent) but may also produce fugitive emissions.

This Emissions Unit Information Section addresses, as a single emissions unit, one or more process or production units and activities which produce fugitive emissions only.

2. Description of Emissions Unit Addressed in this Section:
Facility-wide Unregulated Emissions

3. Emissions Unit Identification Number: **N/A**

4. Emissions Unit Status Code: A	5. Commence Construction Date:	6. Initial Startup Date:	7. Emissions Unit Major Group SIC Code: 49	8. Acid Rain Unit? <input type="checkbox"/> Yes <input checked="" type="checkbox"/> No
--	--------------------------------	--------------------------	--	--

9. Package Unit:
Manufacturer: _____ Model Number: _____

10. Generator Nameplate Rating: _____ MW

11. Emissions Unit Comment:
See Attachment PEC-EU2-A11.

EMISSIONS UNIT INFORMATION

Section [2] of [2]
Facility-wide Unregulated Emissions

Emissions Unit Control Equipment

1. Control Equipment/Method(s) Description:

2. Control Device or Method Code(s):

EMISSIONS UNIT INFORMATION

Section [2] of [2]
Facility-wide Unregulated Emissions

B. EMISSIONS UNIT CAPACITY INFORMATION

(Optional for unregulated emissions units.)

Emissions Unit Operating Capacity and Schedule

1. Maximum Process or Throughput Rate:			
2. Maximum Production Rate:			
3. Maximum Heat Input Rate:	million Btu/hr		
4. Maximum Incineration Rate:	pounds/hr tons/day		
5. Requested Maximum Operating Schedule:	hours/day weeks/year	days/week hours/year	
6. Operating Capacity/Schedule Comment:			

EMISSIONS UNIT INFORMATION

Section [2] of [2]
Facility-wide Unregulated Emissions

C. EMISSION POINT (STACK/VENT) INFORMATION
(Optional for unregulated emissions units.)

Emission Point Description and Type

1. Identification of Point on Plot Plan or Flow Diagram:		2. Emission Point Type Code:	
3. Descriptions of Emission Points Comprising this Emissions Unit for VE Tracking:			
4. ID Numbers or Descriptions of Emission Units with this Emission Point in Common:			
5. Discharge Type Code:	6. Stack Height: feet		7. Exit Diameter: feet
8. Exit Temperature: °F	9. Actual Volumetric Flow Rate: acfm	10. Water Vapor: %	
11. Maximum Dry Standard Flow Rate: dscfm		12. Nonstack Emission Point Height: feet	
13. Emission Point UTM Coordinates... Zone: East (km): North (km):		14. Emission Point Latitude/Longitude... Latitude (DD/MM/SS) Longitude (DD/MM/SS)	
15. Emission Point Comment:			

EMISSIONS UNIT INFORMATION

Section [2] of [2]
 Facility-wide Unregulated Emissions

D. SEGMENT (PROCESS/FUEL) INFORMATION

Segment Description and Rate: Segment 1 of 1

1. Segment Description (Process/Fuel Type): Industrial Processes; Pulp and Paper and Wood Products; Bulk Handling and Storage – Wood/Bark; Conveyors		
2. Source Classification Code (SCC): 3-07-040-05	3. SCC Units: Tons Processed	
4. Maximum Hourly Rate: 20.56	5. Maximum Annual Rate: 180,066	6. Estimated Annual Activity Factor:
7. Maximum % Sulfur:	8. Maximum % Ash:	9. Million Btu per SCC Unit:
10. Segment Comment: The maximum hourly and annual rates are based on a maximum of 41,111 lb/hr of fuel that can be burned in the boiler.		

Segment Description and Rate: Segment ____ of ____

1. Segment Description (Process/Fuel Type):		
2. Source Classification Code (SCC):	3. SCC Units:	
4. Maximum Hourly Rate:	5. Maximum Annual Rate:	6. Estimated Annual Activity Factor:
7. Maximum % Sulfur:	8. Maximum % Ash:	9. Million Btu per SCC Unit:
10. Segment Comment:		

EMISSIONS UNIT INFORMATION

POLLUTANT DETAIL INFORMATION

Section [2] of [2]
Facility-wide Unregulated Emissions

Page [0] of [0]

**F2. EMISSIONS UNIT POLLUTANT DETAIL INFORMATION -
ALLOWABLE EMISSIONS**

Complete if the pollutant identified in Subsection F1 is or would be subject to a numerical emissions limitation.

Allowable Emissions Allowable Emissions ____ of ____

1. Basis for Allowable Emissions Code:	2. Future Effective Date of Allowable Emissions:
3. Allowable Emissions and Units:	4. Equivalent Allowable Emissions: lb/hour tons/year
5. Method of Compliance:	
6. Allowable Emissions Comment (Description of Operating Method):	

Allowable Emissions Allowable Emissions ____ of ____

1. Basis for Allowable Emissions Code:	2. Future Effective Date of Allowable Emissions:
3. Allowable Emissions and Units:	4. Equivalent Allowable Emissions: lb/hour tons/year
5. Method of Compliance:	
6. Allowable Emissions Comment (Description of Operating Method):	

Allowable Emissions Allowable Emissions ____ of ____

1. Basis for Allowable Emissions Code:	2. Future Effective Date of Allowable Emissions:
3. Allowable Emissions and Units:	4. Equivalent Allowable Emissions: lb/hour tons/year
5. Method of Compliance:	
6. Allowable Emissions Comment (Description of Operating Method):	

EMISSIONS UNIT INFORMATION

Section [2] of [2]
Facility-wide Unregulated Emissions

H. CONTINUOUS MONITOR INFORMATION

Complete if this emissions unit is or would be subject to continuous monitoring.

Continuous Monitoring System: Continuous Monitor ____ of ____

1. Parameter Code:	2. Pollutant(s):
3. CMS Requirement:	<input type="checkbox"/> Rule <input type="checkbox"/> Other
4. Monitor Information... Manufacturer: Model Number:	Serial Number:
5. Installation Date:	6. Performance Specification Test Date:
7. Continuous Monitor Comment:	

Continuous Monitoring System: Continuous Monitor ____ of ____

1. Parameter Code:	2. Pollutant(s):
3. CMS Requirement:	<input type="checkbox"/> Rule <input type="checkbox"/> Other
4. Monitor Information... Manufacturer: Model Number:	Serial Number:
5. Installation Date:	6. Performance Specification Test Date:
7. Continuous Monitor Comment:	

EMISSIONS UNIT INFORMATION

Section [2] of [2]
Facility-wide Unregulated Emissions

I. EMISSIONS UNIT ADDITIONAL INFORMATION

Additional Requirements for All Applications, Except as Otherwise Stated

1. Process Flow Diagram (Required for all permit applications, except Title V air operation permit revision applications if this information was submitted to the department within the previous five years and would not be altered as a result of the revision being sought) <input type="checkbox"/> Attached, Document ID: _____ <input type="checkbox"/> Previously Submitted, Date _____
2. Fuel Analysis or Specification (Required for all permit applications, except Title V air operation permit revision applications if this information was submitted to the department within the previous five years and would not be altered as a result of the revision being sought) <input type="checkbox"/> Attached, Document ID: _____ <input type="checkbox"/> Previously Submitted, Date _____
3. Detailed Description of Control Equipment (Required for all permit applications, except Title V air operation permit revision applications if this information was submitted to the department within the previous five years and would not be altered as a result of the revision being sought) <input type="checkbox"/> Attached, Document ID: _____ <input type="checkbox"/> Previously Submitted, Date _____
4. Procedures for Startup and Shutdown (Required for all operation permit applications, except Title V air operation permit revision applications if this information was submitted to the department within the previous five years and would not be altered as a result of the revision being sought) <input type="checkbox"/> Attached, Document ID: _____ <input type="checkbox"/> Previously Submitted, Date _____ <input type="checkbox"/> Not Applicable (construction application)
5. Operation and Maintenance Plan (Required for all permit applications, except Title V air operation permit revision applications if this information was submitted to the department within the previous five years and would not be altered as a result of the revision being sought) <input type="checkbox"/> Attached, Document ID: _____ <input type="checkbox"/> Previously Submitted, Date _____ <input checked="" type="checkbox"/> Not Applicable
6. Compliance Demonstration Reports/Records <input type="checkbox"/> Attached, Document ID: _____ Test Date(s)/Pollutant(s) Tested: _____ <input type="checkbox"/> Previously Submitted, Date: _____ Test Date(s)/Pollutant(s) Tested: _____ <input type="checkbox"/> To be Submitted, Date (if known): _____ Test Date(s)/Pollutant(s) Tested: _____ <input checked="" type="checkbox"/> Not Applicable Note: For FESOP applications, all required compliance demonstration records/reports must be submitted at the time of application. For Title V air operation permit applications, all required compliance demonstration reports/records must be submitted at the time of application, or a compliance plan must be submitted at the time of application.
7. Other Information Required by Rule or Statute <input type="checkbox"/> Attached, Document ID: _____ <input checked="" type="checkbox"/> Not Applicable

EMISSIONS UNIT INFORMATION

**Section [2] of [2]
Facility-wide Unregulated Emissions**

Additional Requirements for Air Construction Permit Applications

1. Control Technology Review and Analysis (Rules 62-212.400(6) and 62-212.500(7), F.A.C.; 40 CFR 63.43(d) and (e)) <input type="checkbox"/> Attached, Document ID: _____ <input checked="" type="checkbox"/> Not Applicable
2. Good Engineering Practice Stack Height Analysis (Rule 62-212.400(5)(h)6., F.A.C., and Rule 62-212.500(4)(f), F.A.C.) <input type="checkbox"/> Attached, Document ID: _____ <input checked="" type="checkbox"/> Not Applicable
3. Description of Stack Sampling Facilities (Required for proposed new stack sampling facilities only) <input type="checkbox"/> Attached, Document ID: _____ <input checked="" type="checkbox"/> Not Applicable

Additional Requirements for Title V Air Operation Permit Applications

1. Identification of Applicable Requirements <input type="checkbox"/> Attached, Document ID: _____ <input checked="" type="checkbox"/> Not Applicable
2. Compliance Assurance Monitoring <input type="checkbox"/> Attached, Document ID: _____ <input checked="" type="checkbox"/> Not Applicable
3. Alternative Methods of Operation <input type="checkbox"/> Attached, Document ID: _____ <input checked="" type="checkbox"/> Not Applicable
4. Alternative Modes of Operation (Emissions Trading) <input type="checkbox"/> Attached, Document ID: _____ <input checked="" type="checkbox"/> Not Applicable
5. Acid Rain Part Application <input type="checkbox"/> Certificate of Representation (EPA Form No. 7610-1) <input type="checkbox"/> Copy Attached, Document ID: _____ <input type="checkbox"/> Acid Rain Part (Form No. 62-210.900(1)(a)) <input type="checkbox"/> Attached, Document ID: _____ <input type="checkbox"/> Previously Submitted, Date: _____ <input type="checkbox"/> Repowering Extension Plan (Form No. 62-210.900(1)(a)1.) <input type="checkbox"/> Attached, Document ID: _____ <input type="checkbox"/> Previously Submitted, Date: _____ <input type="checkbox"/> New Unit Exemption (Form No. 62-210.900(1)(a)2.) <input type="checkbox"/> Attached, Document ID: _____ <input type="checkbox"/> Previously Submitted, Date: _____ <input type="checkbox"/> Retired Unit Exemption (Form No. 62-210.900(1)(a)3.) <input type="checkbox"/> Attached, Document ID: _____ <input type="checkbox"/> Previously Submitted, Date: _____ <input type="checkbox"/> Phase II NOx Compliance Plan (Form No. 62-210.900(1)(a)4.) <input type="checkbox"/> Attached, Document ID: _____ <input type="checkbox"/> Previously Submitted, Date: _____ <input type="checkbox"/> Phase II NOx Averaging Plan (Form No. 62-210.900(1)(a)5.) <input type="checkbox"/> Attached, Document ID: _____ <input type="checkbox"/> Previously Submitted, Date: _____ <input checked="" type="checkbox"/> Not Applicable

EMISSIONS UNIT INFORMATION

Section [2] of [2]
Facility-wide Unregulated Emissions

Additional Requirements Comment

--

ATTACHMENT PEC-EU2-A11

EMISSIONS UNIT COMMENT

ATTACHMENT PEC-EU2-A11**LIST OF UNREGULATED SOURCES AND/OR ACTIVITIES**

Lube Oil Tank Storage including Lube/Fuel Oil Drip Pans.

No. 2 Diesel Storage Tank including dispensing operations.

Fresh Water Cooling Tower and Water Treatment System (water chlorinations with sodium hypochlorite and pH control with sulfuring acid). *No chromium-based water treatment chemicals are used.*

Chlorine storage.

Oil/water separator.

Surface coating/solvent usage maintenance activities [pursuant to 62-210.300(3)(a)(16)].

Brazing/soldering/welding maintenance activities [pursuant to 62-210.300(3)(a)(16)].

Small parts washer.

Wood/metal working activities: sawing and grinding.

Laboratory equipment, chemical storage and usage, and vacuum pumps [pursuant to 62-210.300(3)(a)(9)].

Portable generator (approx. 3,000 W).

Generator (7.5 kW).

Fuel handling system including feed bin, feed screw conveyor, conveyors, fuel reclaim, and storage pile.

Ash storage bins (2).

Pelletizing unit (i.e., shredder, conveyor belts, pelletizer).