

ANIMAL CREMATORY  
AIR GENERAL PERMIT REGISTRATION FORM

RECEIVED

MAY 29 2013

Part II. Notification to Permitting Office

(Detach and submit to appropriate permitting office; keep copy onsite)

DIVISION OF AIR  
RESOURCE MANAGEMENT

**Instructions:** To give notice to the Department of an eligible facility's intent to use this air general permit, the owner or operator of the facility must detach and complete this part of the Air General Permit Registration Form and submit it to the appropriate Department of Environmental Protection or local air pollution control program office which has permitting authority. Please type or print clearly all information, and enclose the appropriate air general permit registration processing fee pursuant to Rule 62-4.050, F.A.C. (\$100 as of the effective date of this form)

Registration Type

0110207-009-AG

Check one:

**INITIAL REGISTRATION** - Notification of intent to:

- Construct and operate a proposed new facility.
- Operate an existing facility not currently using an air general permit (e.g., a facility proposing to go from an air operation permit to an air general permit).

**RE-REGISTRATION** (for facilities currently using an air general permit) - Notification of intent to:

- Continue operating the facility after expiration of the current term of air general permit use.
- Continue operating the facility after a change of ownership.
- Make an equipment change requiring re-registration pursuant to Rule 62-210.310(2)(e), F.A.C., or any other change not considered an administrative correction under Rule 62-210.310(2)(d), F.A.C.

**Surrender of Existing Air Operation Permit(s) - For Initial Registrations Only**

If the facility currently holds one or more air operation permits, such permit(s) must be surrendered by the owner or operator upon the effective date of this air general permit. In such case, check the first box, and indicate the operation permits being surrendered. If no air operation permits are held by the facility, check the second box.

- All existing air operation permits for this facility are hereby surrendered upon the effective date of this air general permit; specifically permit number(s): \_\_\_\_\_
- No air operation permits currently exist for this facility.

**General Facility Information**

Facility Owner/Company Name (Name of corporation, agency, or individual owner who or which owns, leases, operates, controls, or supervises the facility.)

Pet Angel World Services (Florida) LLC

Site Name (Name, if any, of the facility site; e.g., Plant A, Metropolis Plant, etc. If more than one facility is owned, a registration form must be completed for each.)

Facility Location (Provide the physical location of the facility, not necessarily the mailing address.)

Street Address: 1941 Park Meadows Drive Suite 8

City: FT. Myers

County: Pinellas

Zip Code: 33907

Facility Start-Up Date (Estimated start-up date of proposed new facility.) (N/A for existing facilities)

**Owner/Authorized Representative**

Name and Position Title: (Person who, by signing this form below, certifies that the facility is eligible to use this air general permit.)

Print Name and Title: Sharon Martinache, Regional Manager

Owner/Authorized Representative Mailing Address

Organization/Firm: Pet Angel World Services (Florida) LLC

Street Address: 6225 72nd Ave

City: Pinellas Park County: Pinellas Zip Code: 33781

Owner/Authorized Representative Telephone Numbers

Telephone: 727-548-1456

Fax:

Cell phone (optional):

**Facility Contact (If different from Owner/Authorized Representative)**

Name and Position Title (Plant manager or person to be contacted regarding day-to-day operations at the facility.)

Print Name and Title:

Facility Contact Mailing Address

Organization/Firm:

Street Address:

City: County: Zip Code:

Facility Contact Telephone Numbers

Telephone:

Fax:

Cell phone (optional):

**Owner/Authorized Representative Statement**

This statement must be signed and dated by the person named above as owner or authorized representative

*I, the undersigned, am the owner or authorized representative of the owner or operator of the facility addressed in this Air General Permit Registration Form. I hereby certify, based on information and belief formed after reasonable inquiry, that the facility addressed in this registration form is eligible for use of this air general permit and that the statements made in this registration form are true, accurate and complete. Further, I agree to operate and maintain the facility described in this registration form so as to comply with all applicable standards for control of air pollutant emissions found in the statutes of the State of Florida and rules of the Department of Environmental Protection and revisions thereof.*

*I will promptly notify the Department of any changes to the information contained in this registration form.*

*Sharon Martinache*

Signature

*5/15/2013*

Date

**Design Calculations**

If this is an initial registration for a proposed new animal crematory unit, provide design calculations to confirm a sufficient volume in the secondary chamber combustion zone to provide for at least a 1.0 second gas residence time at 1800 degrees F.

- Manufacturer's' design calculations attached.
- Registration is not for proposed new animal crematory unit(s).

**Description of Facility**

Below, or as an attachment to this form, provide a description of all crematory operations at the facility in sufficient detail to demonstrate the facility's eligibility for use of this air general permit and to provide a basis for tracking any future equipment or process changes at the facility. Describe all air pollutant-emitting processes and equipment at the facility, and identify any air pollution control measures or equipment used.

**CALCULATIONS FOR PRODUCTS OF COMBUSTION  
AND RESIDENCE TIME FOR 75 LB/hr  
TYPE IV WASTE, B&L SERIES CREMATORY**

**NATURAL GAS**

**A. BASIS: 1 LB WASTE**

1.  $\frac{1 \text{ lb waste} \times 1000 \text{ Btu/lb waste} \times 15 \text{ lbs air}}{10,000 \text{ Btu}} = 1.5 \text{ lbs air}$
2.  $\frac{1 \text{ lb waste} \times 0.10 \text{ lb combustible}}{1 \text{ lb waste}} = 0.10 \text{ lbs of combustibles}$
3.  $\frac{1 \text{ lb waste} \times 0.85 \text{ lb H}_2\text{O} \times 1.6^*}{1 \text{ lb waste}} = 1.36 \text{ lbs of water}$
4.  $\frac{6,500 \text{ Btu aux fuel}^{**} \times 10.0 \text{ cu ft air/cu ft fuel}}{1,050 \text{ Btu/cu ft fuel} \times 13.35 \text{ cu ft air/lb air @ } 70\text{f}} = 4.64 \text{ lbs of air for aux fuel}$
5.  $\frac{6,500 \text{ Btu aux fuel} \times 0.044 \text{ lb fuel/cu ft fuel}}{1,050 \text{ Btu/cu ft fuel}} = 0.27 \text{ lb of aux fuel}$
6. Sum = PRODUCTS OF COMBUSTION (POC) = 7.86 lbs POC per lb waste @ 70f

**B. RESIDENCE TIME @ 1600 F**

1.  $\frac{7.86 \text{ lbs POC/lbs waste} \times 51.89 \text{ cu ft / lb POC @ } 1600\text{f} \times 75 \text{ lbs waste / hr}}{3600 \text{ sec/hr}}$   
 $= 8.49 \text{ cu ft / sec @ } 1600 \text{ f} = 9.0 \text{ cu ft for 1 second residence time}$

**RESIDENCE TIME @ 1800 F**

2.  $\frac{7.86 \text{ lbs POC/lbs waste} \times 56.93 \text{ cu ft /lb POC @ } 1800\text{f} \times 75 \text{ lbs waste / hr}}{3600 \text{ sec/hr}}$   
 $= 9.32 \text{ cu ft / sec @ } 1800\text{f} = 10.00 \text{ cu ft for 1 second residence time}$

\* Correction multiplier for dry air and water vapor

\*\* Fuel is Natural Gas

Referances: Incinerator institute of America.  
 North American Combustion Handbook  
 Eclipse Combustion Engineering guide

**C. THERMOCOUPLE PLACEMENT.**

Secondary chamber operating temperature at > or = to 1600f = 9.00 cu ft from flame tip.  
 1800f = 10.00 cu ft from flame tip.

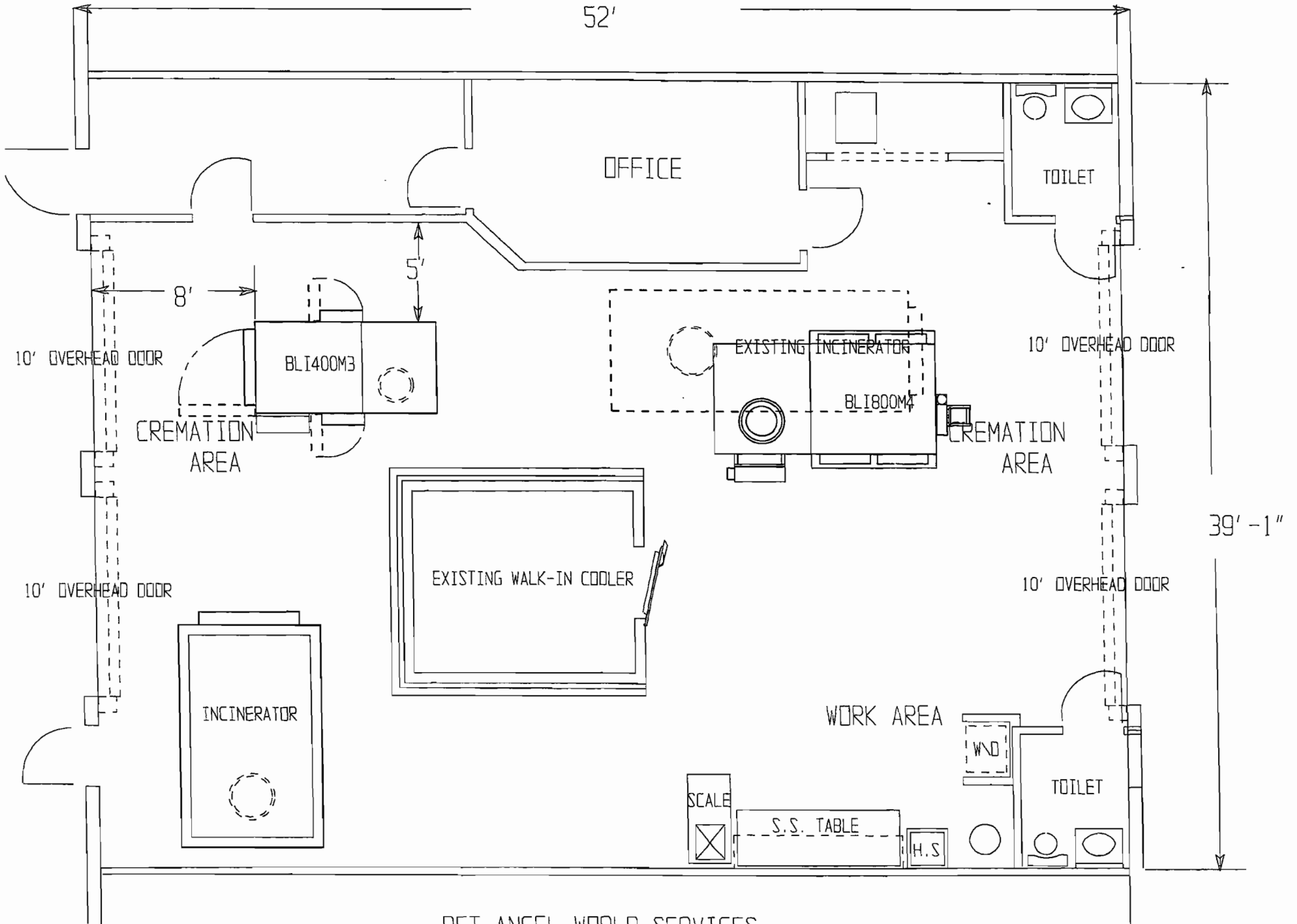

PET ANGEL WORLD SERVICES



6225 72ND AVE. NORTH  
PINELLAS PARK, FL 33781

**Dept. of Environmental Protection  
Receipts  
P.O. Box 3070  
Tallahassee, FL 32399**

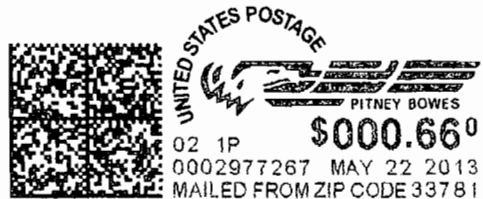

32315307070

