



HUMAN CREMATORY



COMPLIANCE INSPECTION CHECKLIST

INSPECTION TYPE: ANNUAL (INS1, INS2) COMPLAINT/DISCOVERY (CI)
 RE-INSPECTION (FUI) ARMS COMPLAINT NO. _____

AIRS ID#: 1050272 **DATE:** 09142009 **ARRIVE:** 0748 **DEPART:** 1118
FACILITY NAME: LAKELAND CREMATORY
FACILITY LOCATION: 2196 K-VILLE AVENUE
 AUBURNDALE 33823
OWNER/AUTHORIZED REPRESENTATIVE: SCOTT CONNOR **PHONE:** (863)967-8558
CONTACT NAME: Scott Conner **PHONE:** 863-551-9717
ENTITLEMENT PERIOD: 1/19/2009 / 1/19/2014
 (effective date) (end date)

PART I: INSPECTION COMPLIANCE STATUS (check only one box)
 IN COMPLIANCE MINOR Non-COMPLIANCE SIGNIFICANT Non-COMPLIANCE

PART II: TESTING/RECORDKEEPING REQUIREMENTS – Rule 62-296.401, F.A.C.
 (check appropriate box(es))

- Were there any objectionable odor(s) detected?----- Yes No
- Was a visible emissions test conducted during this site visit according to EPA Method 9 (Ref.: Chapter 62-297, F.A.C.)?----- Yes No
- In order to demonstrate individual source compliance, was an annual visible emissions test conducted within 30 days after the unit has commenced operation and annually thereafter (Rule 62-296.401(5)(h), F.A.C.)?----- Yes No
- Was all visible emissions testing conducted with the source operating at the manufacturers recommended capacity?----- Yes No
- Was the Department notified at least 15 days prior to the date of the last formal compliance test?----- Yes No
- Was the required test report filed with the Department as soon as practical, but no longer than 45 days after the test was completed?----- Yes No

PART III: OPERATING/RECORDKEEPING REQUIREMENTS – Rule 62-296.401, F.A.C.
 (check appropriate box(es))

- Is there **Continuous Emissions Monitoring System (CEMS)** equipment installed on each unit to record temperatures in the primary and secondary chambers where there is a 1.0 second gas residence time in the secondary chamber combustion zone in accordance with the manufacturer's instructions?----- Yes No
 - Do temperature probes seem to be properly placed? ----- Yes No
 - Are the following records kept on file, available for inspection for at least two years following the recording of such measurements, maintenance, reports and records?
 - All measurements (including CEMS)----- Yes No

PART III: OPERATING/RECORDKEEPING REQUIREMENTS – Rule 62-296.401, F.A.C. Cont.

(check appropriate box(es))

- 2) Monitoring device----- Yes No
 - 3) Performance Testing Measurements----- Yes No
 - 4) CEMS Performance Evaluation----- Yes No
 - 5) All CEMS or monitoring device calibration checks----- Yes No
 - 6) Adjustments----- Yes No
 - 7) Preventive maintenance performed on systems/devices----- Yes No
 - 8) Corrective maintenance performed on systems/devices----- Yes No
2. Was this crematory unit constructed: (check only one box)
- a) **BEFORE** August 30, 1989? (If this box checked, continue on to #3 and skip #4)
 - b) **ON** or **AFTER** August 30, 1989? (If this box checked, skip #3 and continue on to #4)
3. If constructed **BEFORE** August 30, 1989 is the:
- a) secondary chamber combustion zone providing at least a 1.0 second gas residence time @ 1600°F?---- Yes No
 - b) actual operating temperature of the secondary chamber combustion zone no less than 1400°F throughout the combustion process in the primary chamber?----- Yes No
 - c) cremation in the primary chamber begun after the secondary chamber combustion zone temperature is equal to or greater than 1400°F?----- Yes No
 - d) required monitoring equipment installed and operational, and providing continuous monitoring to record the temperature at the point or beyond where 1.0 second gas residence time is obtained in the secondary chamber combustion zone according to the manufacturer's instructions?----- Yes No
4. If constructed **ON** or **AFTER** August 30, 1989 is the:
- a) volume in the secondary combustion zone sufficient to provide at least a 1.0 second gas residence time @ 1800° F?----- Yes No
 - b) the actual operating temperature of the secondary chamber combustion zone no less than 1600°F throughout the combustion process in the primary chamber?----- Yes No
 - c) secondary chamber combustion zone temperature equal to or greater than 1600°F before the cremation process begins in the primary chamber?----- Yes No
5. Are appropriate cremation containers containing no more than 0.5 % (percent) by weight chlorinated plastics used during the cremation of dead human bodies?----- Yes No
- a) If the answer to question 4 above is YES, is certifying documentation from the manufacturer that they are composed of 0.5% or less by weight chlorinated plastics kept on file at the site for the duration of their use and for at least two years after their use?----- Yes No
 - b) Are there any other materials, including biomedical wastes (Rule 62-210.200, FAC) incinerated at this location?----- Yes No

PART IV: EQUIPMENT MAINTENANCE – Rule 62-296.401, F.A.C.

- 1. Is the crematory unit maintained in proper working order?----- Yes No
- 2. Are there maintenance record kept onsite?----- Yes No
- 3. Is there a written plan onsite which addresses the operating procedures during startup, shutdown and malfunction?----- Yes No

PART V: SPECIAL CONDITIONS AND PROCEDURES – Rule 62-210.310(2), F.A.C.

A. New or Modified Process Equipment

1. Since the last inspection has there been

- a) installation of any new process equipment?----- Yes No
- b) alterations to existing process equipment without replacement?----- Yes No
- c) replacement of existing equipment substantially different than that noted on the most recent notification form?----- Yes No
- d) If you answered **YES** to any of the above, did the owner submit a new and complete notification form and appropriate fee (Rule 62-4.050, F.A.C.) to the appropriate DEP or local program office?----- Yes No

COMMENTS: This inspection was prompted by a 15 day notice for a VE test to be performed this day. Attending this VE allowed the Department to complete a full inspection to include a second checklist (attached) to gather further information about the facility and the equipment. This inspection was a training exercise in determining the location of the thermocouple in a crematory unit. This training session included Joe Panetta, assigned as compliance inspector for this facility; James Burkholder, Engineering Specialist and lead in determining how to measure for the location of the thermocouple; Wendy Simmons and Malik Pickering, compliance inspectors.

The VE test was conducted by Arlington Environmental Services (1 hour test) and audited by Wendy Simmons for approximately 45 minutes. The Inspection was conducted by Joe Panetta and Malik Pickering. Mr. Connor had two years of records available for inspection. A 3 month review of EU002 (west stack) chart records were check by Joe Panetta. The chart dates that were checked included the beginning date 04/22/2009 and ended with the date 07/31/2009. A 3 month review of EU003 (east stack) chart records were check by Malik Pickering. The chart dates that were checked included the beginning date 05/01/2009 and ended with the date 08/18/2009. The inspection included all questions in this checklist. According to this checklist the facility seems to be in compliance. When James Burkholder completes the calculations for the location of the thermocouple we will address any issues that may arise from these calculations. A field Inspection notice was left as a reminder for Mr. Conner to fax a work order from Matthews Cremation Corporation for worked performed in May 2009 on EU002 (West Unit) and worked performed in April 2009 on EU003 (East Unit). That fax was received before we returned to the office 12:33 P.M.

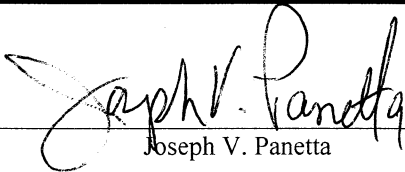
Joseph V. Panetta

Malik Pickering

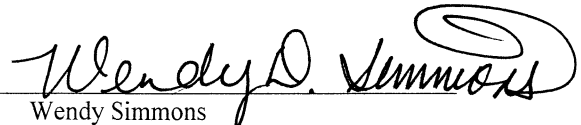
Wendy Simmons

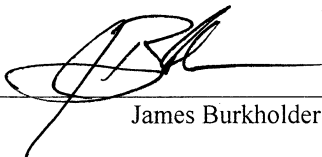
James Burkholder

09/22/2009

Date of Inspection

EPA

VISIBLE EMISSION OBSERVATION FORM 1

Method used: Method 9 203A 203B Other:

Company Name: SCI Crematory
 Facility Name:
 Street Address: 2196 K-Ville Avenue
 City: Auburndale State: FL Zip:

Process: 160 lbs approx. Unit#: 3 Operating Mode:
 Control Equipment: afterburner Operating Mode:

Describe Emission Point: Western most stack EU03

Height of Emission Point Start: 35ft End: 35ft Height of Emiss. Point Rel. to Obser. Start: 30.5 ft End: 30.5ft
 Distance to Emission Point Start: 46 yards End: 46 yards Direction to Emission Point (Degrees) Start: 304 End: 304

Vertical Angle to Obs. Point Start: 13 deg. End: 13 deg. Direction to Obs. Point (Degrees) Start: End:
 Distance and Direction to Observation Point from Emission Point Start: west End: west

Describe Emissions Start: None End: none
 Emission Color Start: none End: none Water Droplet Plume Attached Detached None

Describe Plume Background Start: none End: none
 Background Color Start: Blue sky End: same Sky Conditions Start: clear End: clear
 Wind Speed Start: 0-5 End: 0-5 Wind Direction Start: various End: various
 Ambient Temperature Start: 81 End: 82 Wet Bulb Temp.: 80 °F RH Percent: 100 %

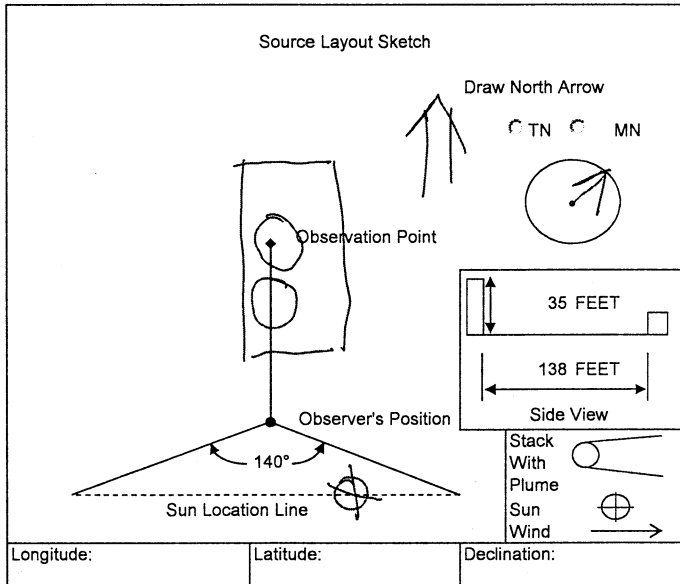

ADDITIONAL OBSERVATIONS:
 AIRS ID / Permit #: 1E+06
 Audit Type:
 District:
 County:
 Is Plume continual?
 Is Plume attached or detached?
 Does plume have any color? If so, readings should show at least 5%
 Test Pass or Fail:
 Is this set of test data complete? Yes No

Form Number: Page 1 Of 1
 Continued on VEO Form Number:

Observation Date:		Time Zone:				Start Time:	End Time:
9/14/2009						8:24	8:54
Min	Sec	0	15	30	45	AVG	Comments
1		0	0	0	0	0.0	
2		0	0	0	0	0.0	
3		0	0	0	0	0.0	
4		0	0	0	0	0.0	
5		0	0	0	0	0.0	
6		0	0	0	0	0.0	
7		0	0	0	0	0.0	
8		0	0	0	0	0.0	
9		0	0	0	0	0.0	
10		0	0	0	0	0.0	
11		0	0	0	0	0.0	
12		0	0	0	0	0.0	
13		0	0	0	0	0.0	
14		0	0	0	0	0.0	
15		0	0	0	0	0.0	
16		0	0	0	0	0.0	
17		0	0	0	0	0.0	
18		0	0	0	0	0.0	
19		0	0	0	0	0.0	
20		0	0	0	0	0.0	
21		0	0	0	0	0.0	
22		0	0	0	0	0.0	
23		0	0	0	0	0.0	
24		0	0	0	0	0.0	
25		0	0	0	0	0.0	
26		0	0	0	0	0.0	
27		0	0	0	0	0.0	
28		0	0	0	0	0.0	
29		0	0	0	0	0.0	
30		0	0	0	0	0.0	

MINOR SOURCE 30 MIN. AVG: 0.0 (ONLY VALID FOR ALL 120 READINGS)

Observer's Name (Print): Wendy D. Simmons
 Observer's Signature: *Wendy D. Simmons* Date:
 Organization: FL DEP SWD Air Program
 Certified By: Eastern Technical Associates Date:

Additional Information:

WORST 6 MINUTES: ### %
 AVERAGE OPACITY: 0.0 %

Data for WebMICA
 Year: 2009
 Month: 9
 Start Date:
 # of Days:
 Celestial Object: Sun
 Longitude W: Degrees
 Minutes
 Latitude N: Degrees
 Minutes
 Time Zone Hrs: W. of Greenwich

Sun's Path

EPA

VISIBLE EMISSION OBSERVATION FORM 1

Method used: Method 9 203A 203B Other:

Company Name: SCI Crematory
 Facility Name: Lakeland Crematory
 Street Address: 2196 K-Ville Avenue
 City: Auburndale State: FL Zip: 33823

Process: 160 lb human cr Unit#: 2 Operating Mode: 1600 degrees
 Control Equipment: after burner Operating Mode: normal

Describe Emission Point: Stack opening for Eastern most stack.

Height of Emission Point Start: 35 End: same
 Height of Emiss. Point Rel. to Obser. Start: 30 End: 30
 Distance to Emission Point Start: 132 ft End: same
 Direction to Emission Point (Degrees) Start: 300 End: same

Vertical Angle to Obs. Point Start: 13 End: 13
 Direction to Obs. Point (Degrees) Start: End:
 Distance and Direction to Observation Point from Emission Point Start: End:

Describe Emissions Start: none End: none
 Emission Color Start: none End: none
 Water Droplet Plume Attached Detached None

Describe Plume Background Start: none End: none
 Background Color Start: blue sky End: same
 Sky Conditions Start: clear End: clear
 Wind Speed Start: 0-5 End: same
 Wind Direction Start: various End: various
 Ambient Temperature Start: 81 End: 82
 Wet Bulb Temp.: 80 °F RH Percent: 100 %

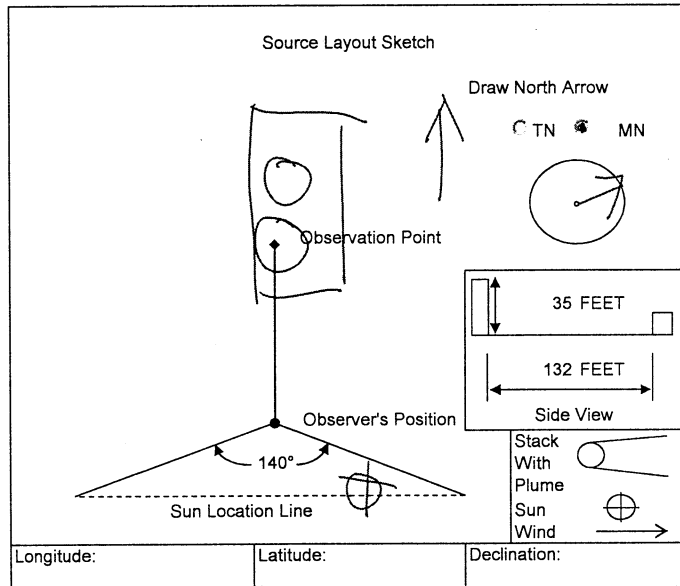

ADDITIONAL OBSERVATIONS:

AIRS ID / Permit #: _____
 Audit Type: _____
 District: _____
 County: _____
 Is Plume continual? _____
 Is Plume attached or detached? _____
 Does plume have any color? _____ If so, readings should show at least 5%
 Test Pass or Fail: _____
 Is this set of test data complete? Yes No

Form Number: _____ Page 1 Of 1
 Continued on VEO Form Number: _____

Observation Date:	Time Zone:	Start Time:	End Time:			
09/14/09		8:25	8:55			
Sec	0	15	30	45	AVG	Comments
1	0	0	0	0	0.0	
2	0	0	0	0	0.0	
3	0	0	0	0	0.0	
4	0	0	0	0	0.0	
5	0	0	0	0	0.0	
6	0	0	0	0	0.0	
7	0	0	0	0	0.0	
8	0	0	0	0	0.0	
9	0	0	0	0	0.0	
10	0	0	0	0	0.0	
11	0	0	0	0	0.0	
12	0	0	0	0	0.0	
13	0	0	0	0	0.0	
14	0	0	0	0	0.0	
15	0	0	0	0	0.0	
16	0	0	0	0	0.0	
17	0	0	0	0	0.0	
18	0	0	0	0	0.0	
19	0	0	0	0	0.0	
20	0	0	0	0	0.0	
21	0	0	0	0	0.0	
22	0	0	0	0	0.0	
23	0	0	0	0	0.0	
24	0	0	0	0	0.0	
25	0	0	0	0	0.0	
26	0	0	0	0	0.0	
27	0	0	0	0	0.0	
28	0	0	0	0	0.0	
29	0	0	0	0	0.0	
30	0	0	0	0	0.0	

MINOR SOURCE 30 MIN. AVG: 0.0 (ONLY VALID FOR ALL 120 READINGS)

Observer's Name (Print): Wendy D. Simmons
 Observer's Signature: *Wendy D. Simmons*
 Organization: FL DEP SWD Air Program
 Certified By: Eastern Technical Associates Date:

Additional Information:

WORST 6 MINUTES: 0.0 %
 AVERAGE OPACITY: 0.0 %

Data for WebMICA
 Year: _____
 Month: _____
 Start Date: _____
 # of Days: _____
 Celestial Object: Sun
 Longitude W: _____ Degrees
 _____ Minutes
 Latitude N: _____ Degrees
 _____ Minutes
 Time Zone Hrs: _____ W. of Greenwich

Sun's Path

2200 K-Ville Ave.
Auburndale, Fl. 33823
Phone: 863-967-8558
Fax: 863-967-7284

**Glen Abbey
Memorial Gardens**

Lakeland Crematory
863 551-9717

Fax

To: Joe Panetta From: Scott Connor

Fax: 863 967 7284 Pages: 4

Phone: 863 551-9717 Date: October 2, 2009

Re: CC:

- Urgent
- For Review
- Please Comment
- Please Reply
- Please Recycle

• Comments:

3 PAGE FAX

To: Scott Connor

From: Bill Snyder

Re: Matthews Cremation Invoice

Hi Scott,

Attached is the invoice for the repairs on unit #1 that you and I discussed. If you have any questions, call me at 317-223-9848.

Thanks,

Bill Snyder

Matthews Cremation

5250 Terminal Screen

10/01/09

Itemized Entries & Charges

Order No: 1366567
Bus. Unit: C

Ord	Shp	Ctg/Part#	Desc/Comments	V	Price Ea	Ext\$	TX
1	1	REPAIR	LOADING DOOR CHAIN KITS		510.00	510.00	
1	1	FREIGHT	SERVICE & REPAIR CREMATION SY SHIPPING		137.50	137.50	

=====

2 2

Pre-Need date: 2009-03
Pricing date : 2009-03
Qty used . . . :

Itemized Subtotal \$: 26023.20
Shipping \$: 137.50

Non-Taxable \$: 137.50
Taxable \$: 26023.20

A/R Posting Info

Credit Cleared: + (*=Yes)
Payment Status: OPEN
Posting Number:
Check Number :
Check Received:
Amount Posted :

Taxes, if applicable: N
1 FLORIDA
10 POLK
105 AUBURNDALE
4

.06000 1561.39
.01000 50.00

Tax totals \$: .07000 1611.39
Amt Paid\$: .00
Bal Due \$: \$27,772.09

F3-Exit F12-Cancel F16=Tracking F18=Notes F24=Print

5250 Terminal Screen

10/01/09

Itemized Entries & Charges

Order No: 1366567

Bus.Unit: C

Ord	Shp	Ctg/Part#	Desc/Comments	V	Price Ea	Ext\$	Tx
1	1	PPII-CR	PPII COMPLETE REBUILD BOTH PPII INSTALLED IN 1999 COMPLETE REBUILD OF UNIT #1 PMJ OF UNIT #2 SITE & NOISE LEVEL EVALUATION		25513.20	* 25513.20	

2 2

Pre-Need date: 2009-03
Pricing date : 2009-03
Qty used . . . :

Itemized Subtotal \$: 26023.20
Shipping \$: 137.50

Non-Taxable \$: 137.50
Taxable \$: 26023.20

A/R Posting Info

Credit Cleared: * (*=Yes)
Payment Status: OPEN
Posting Number:
Check Number :
Check Received:
Amount Posted :

Taxes, if applicable: N

1 FLORIDA .06000 1561.39
10 POLK .01000 50.00
105 AUBURNDALE
4

Tax totals \$: .07000 1611.39
Amt Paid \$: 5.00
Bal Due \$: \$27,772.09

F3=Exit F12=Cancel F16=Tracking F18=Notes F24=Print

SCI Lakeland Crematory

Fac. ID: 1050272

Drawn & Measured by:
James Burkholder

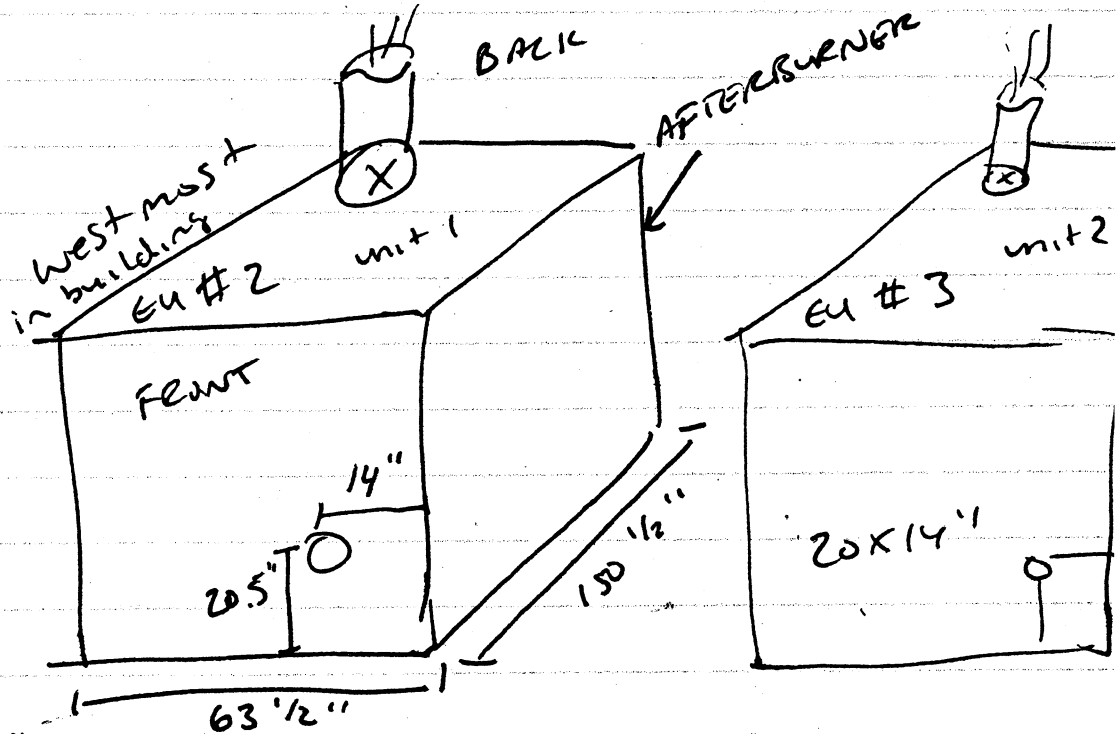

5 1/2" from charge door to front
12" from wall/secondary chamber to front

Air controls

Throat control 1hr delay - shuts off after 1hr
Hearth air 1hr delay - turns on after 1hr

can adjust depending on cremation status.
manual check ~45 mins into

Inspection list for Crematories

Facility Name:

SCI Lakeland Crematory

Joseph V. Pandella

Facility ID No:

105 0272

Joseph Pandella

Crematory Unit Number

02 West

9/22/09

Crematory Unit Information:

Emission Unit No.

02 West

Specifications:

~~10~~ LEPT 100 lbs Hr

Thermocouple Location:

Diagram/Description:

Front Right

Digital Read out
SN: 984548389606

00003

17148 of

Afterburner Location:

Diagram/Description:

BACK Right

1.2 million BTU Capacity

Inspection list for Crematories

Facility Name:

Sci Lakes Crematory

Facility ID No:

1050272 unit # 2 west

Chart and Digital Logic Controller:	
Chart Make & Model:	Honeywell DR4311
Digital Logic Controller Make & Model:	Honeywell DR4311 1715° F
Chart Specifications:	0 - 2800
Digital Logic Controller Specifications:	SN: 9845 4838 9607 00001
Check for agreement between Chart & Digital Logic Controller	Agreement: YES Agreement: NO If NO, provide comments: SN: 9845 4838 9607 00001
Chart Calibration:	Date of Last Calibration: Jan 27 ^{MAY 27} 2009 Calibration Performed by: Mathews Service Results of Calibration:
Digital Logic Controller Calibration:	Date of Last Calibration: 5/27/2009 Calibration Performed by: Mathews Service Results of Calibration:
Digital Logic Controller Bias	Details of Bias: ? Chart Recorder reading at Bias determination:

Inspection list for Crematories

Sci Lakeland Crematory

Facility Name:

Facility ID No: 1050272

Unit # 2 West

	<p>Comparison:</p> <p>If bias is found, request information of previous calibrations to determine when it was put in and by whom.</p> <p>Obtain copies of the recorder charts, during and after the check.</p>
Chart Recorder	Scan in 2 years of temperature charts N/A
Unit Maintenance	
Date of Last Service	5/27/2009
Name of Company Servicing Unit:	Name/Address/Phone #/email and/or fax # Mathews
Description of repairs/adjustments:	
Maintenance Log:	<input checked="" type="radio"/> YES <input type="radio"/> NO
Maintained Routinely:	<input checked="" type="radio"/> YES <input type="radio"/> NO If NO, provide comments.

Inspection list for Crematories

Facility Name:

Sci Lakeland Crematory

Facility ID No:

1050272 Unit # 2 West

Repair Records 62-296.401(5&6)(e), FAC:	2 years of records on-site: YES NO If NO, provide comments.
62-210.310 (3), FAC - General Conditions:	
Permit	Issuance Date: 1/19/2009 Expiration Date: 1/19/2014
Owner:	Same as permit: YES NO If NO, provide current owner information:
62-296.401(5&6), FAC - Specific Conditions Human and Animal Crematories	
Visible Emissions	9/14/09
Particulate Matter Emissions	N/A
Carbon Monoxide (CO) Emissions	N/A

Inspection list for Crematories

Facility Name: Sci Lakeland Crematory

Facility ID No: 1050272 Unit # 2 West

Operating Temperatures	1720°F
Allowed Material	MSDS Sheets provided
Operating Procedures for start-up, shutdown and malfunction	Yes, contained in Manual located onsite
Air-to-Fuel Ratio	

Retention Time Calculations and Thermocouple Location:

NOTE If the temperatures cannot be met at the point or beyond where 1.0 second gas residence time is obtained in the secondary chamber combustion zone, then both the closer thermocouple location and bias would compensate for it.

Inspection list for Crematories

Joseph V. Panetta
[Signature]

Facility Name:

SCI Lakeland Crematory

Facility ID No:

1050272

Crematory Unit Number

03 EAST

9/22/09

Crematory Unit Information:	
Emission Unit No.	03 EAST
Specifications:	TE PPT 100LBS Hr
Thermocouple Location:	Diagram/Description: Front Right Digital Read out SN: 98454838 1749°F 960600012
Afterburner Location:	Diagram/Description: Right Rear

Inspection list for Crematories

Facility Name: Sci Lakeland Crematory

Facility ID No: 1050272 Unit 03 East

Chart and Digital Logic Controller:	
Chart Make & Model:	<u>Honeywell DR 4311</u>
Digital Logic Controller Make & Model:	<u>Honeywell DR 4311</u> <u>1749°F</u> <u>UDC 2000-mini Pro SN: 9845 1838960700002</u>
Chart Specifications:	<u>0 - 2800</u>
Digital Logic Controller Specifications:	<u>operating Temp 0-55°C</u> <u>120v AC 50-60 Hz 10v Amps</u>
Check for agreement between Chart & Digital Logic Controller	Agreement: <input checked="" type="radio"/> YES Agreement: NO If NO, provide comments: <u>9845 1838960700002</u>
Chart Calibration:	Date of Last Calibration: <u>MARCH 2009</u> <u>April 2009</u> Calibration Performed by: <u>MATTHEWS</u> Results of Calibration:
Digital Logic Controller Calibration:	Date of Last Calibration: <u>MARCH 2009</u> <u>April 2009</u> Calibration Performed by: <u>MATTHEWS</u> Results of Calibration:
Digital Logic Controller Bias	Details of Bias: Chart Recorder reading at Bias determination:

Inspection list for Crematories

Facility Name: *Sci. Lakeland Crematory*

Facility ID No: *1050272* *Unit 03 East*

	<p>Comparison:</p> <p>If bias is found, request information of previous calibrations to determine when it was put in and by whom.</p> <p>Obtain copies of the recorder charts, during and after the check.</p>
Chart Recorder	Scan in 2 years of temperature charts
Unit Maintenance	
Date of Last Service	
Name of Company Servicing Unit:	<p>Name/ Address/Phone #/ email and/or fax #</p> <p><i>P.O. Box 547796</i> <i>1-800-327-2831</i></p> <p><i>Orlando</i> <i>32854-7796</i></p>
Description of repairs/adjustments:	
Maintenance Log:	<p align="center"><input checked="" type="radio"/> YES NO</p>
Maintained Routinely:	<p align="center"><input checked="" type="radio"/> YES NO</p> <p>If NO, provide comments.</p>

Inspection list for Crematories

Facility Name:

Sci Lakeland Crematory

Facility ID No:

1050272

Unit 03 East

Repair Records 62-296.401(5&6)(e), FAC:	2 years of records on-site: <input checked="" type="radio"/> YES <input type="radio"/> NO If NO, provide comments.
62-210.310 (3), FAC - General Conditions:	
Permit	Issuance Date: <i>1-19-2009</i> Expiration Date: <i>1-19-2014</i>
Owner:	Same as permit: <input checked="" type="radio"/> YES <input type="radio"/> NO If NO, provide current owner information:
62-296.401(5&6), FAC - Specific Conditions Human and Animal Crematories	
Visible Emissions	<i>9-14-2009</i>
Particulate Matter Emissions	<i>n/A</i>
Carbon Monoxide (CO) Emissions	<i>n/A</i>

Inspection list for Crematories

Facility Name: Sci Lakeland Crematory

Facility ID No: 1050272 Unit 03 295A

Operating Temperatures	1751
Allowed Material	MSDS provided
Operating Procedures for start-up, shutdown and malfunction	In Manual provided During Inspect
Air-to-Fuel Ration	

Retention Time Calculations and Thermocouple Location:

NOTE If the temperatures cannot be met at the point or beyond where 1.0 second gas residence time is obtained in the secondary chamber combustion zone, then both the closer thermocouple location and bias would compensate for it.

Bill-to#: 7589727

Ship-to#: 7260140

ORDER#: 1347463

PAGE: 1

Start: 5-27-2008

SCI ACCOUNTS PAYABLE
PO BOX 30064

LAKELAND CREMATORY-GLEN ABBEY
2200 K-VILLE AVENUE
AUBURNDALE FL 33823-0000

TECHNICIAN(S)
BHEW
BLENNER

COLLEGE STATION TX 77842-0000

Contact#1: Mr. Eddie Allen

Contact#2:

Phone#: 863-551-9717

Phone #:

Last Visit....:

Fax #: 863-965-1918

Fax #:

Written by...: BILL SNYDER

S C I (IEE SPECIAL)

Machine Model: PPIU#1 5/27/2008

WORK DESCRIPTION

West Just 24002

Completed 5/28/08

R&R JAMB AREA BRICKS
R&R FACEBRICK
R&R T/A ROOF

SPECIAL INSTRUCTIONS-CUSTOMER

*LOC. RESPONSIBLE FOR RECEIVING, OFF LOADING & DISPOSAL OF MATERIALS & FREIGHT.

SPECIAL INSTRUCTIONS-SERV/TECH

** MATW RESPONSIBLE FOR ALL MATERIALS, RENTALS, EXPENSES, 1 TECH, 1 HELPER. **

LOC# 2763



Bill-to#: 7589727

Ship-to#: 7260140

ORDER#: 1347212

PAGE: 1

SCI ACCOUNTS PAYABLE

LAKELAND CREMATORY-GLEN ABBEY

Start: 5-27-2008

PO BOX 30064

2200 K-VILLE AVENUE

Technician(s)

COLLEGE STATION TX 77842-0000

AUBURNDALE FL 33823-0000

BBM
JNORTON

Contact#1: Mr. Scott Connor

Contact#2:

Phone#: 863-551-9717

Phone #:

Last Visit....:

Fax #: 863-965-1918

Fax #:

Written by...: BILL SNYDER

S C I (IEE SPECIAL)

Machine Model: PPIIU #2

5/20/2008

WORK DESCRIPTION

R&R C/C FLOOR #2

Est Unit EU003

Completed 5/27/08

SERVICE UNIT FOLLOWING REPAIR

*

*

*

*

Special Instructions-Customer

*Loc. responsible for receiving, off loading & disposal of materials & freight.

Special Instructions-Serv/Tech

** MATW responsible for all materials, rentals, expenses, 1 tech, 1 helper. **

LOC# 2763

5-9

JoAnn M. 1-22-07

MON.

Matthews CREMATION GROUP P.O. Box 547796 • Orlando, Florida 32854-7796 • Tel. (407) 886-5533 • (800) 327-2831 • FAX (407) 886-5990

OK SCOTT

WORK ORDER 1312694

7589987

B I L L T O

S H I P T O

7260140
Lakeland, Ceann Glen Abbey
2996 Kville Ave
Hudsonville, FL 33823
Phone: 863-967-7228
Fax: 863-965-1918

Date
Cust. Name
Cust. Name
Make/Model
Last Visit
Request Date
Written By

17 Nov 06
Scott

APR 25 - 99

PK

WORK DESCRIPTION

DATE COMPLETED 1-22-07

TECHNICIAN JOHN MITCHELL

44002 E 64003

Remove & Replace Pull Chain
Each unit

Remove & Replace Ram to chain Lug & MASTER links

Lot # 2763

TO Replace # 1310588

INSTRUCTIONS
↑
SERIAL

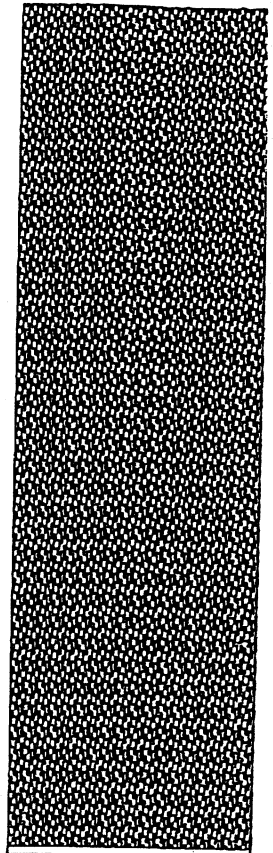

Att. Joe Panetta

4 PAGE FAX

To: Scott Connors

From: Matthews Cremation

Lakeland Crematory
863 551 9715



SERVICE CALL CHECKLIST

POWER-PAK II

The Standard of Excellence in Cremation Solutions

Job Name Lakeland Crematory-Glen Abbey unit#2

Job Number 1366567

Operators' Names

Installation Date 99

Serial # 20199

Cremation Chamber Refractories the entire left corner of the roof is missing front plate is exposed. I suggest either replace entire roof or at least the front 2 feet, walls and floor look ok.

Afterchamber Refractories looks good

C/C cast mc-

Venturi Condition ok Type EE

Stack Condition ok Length 12 ft Type S.S.

Stack Cap Condition N/A Type N/A

Clearance on Stack to Opening 6" m yes

Material Surrounding it metal

Insulation Condition needs replaced insulation falling out at bottom of stack Length 8 ft

Storm Collar has a 3" Clearance yes

Spark Plugs Cleaned yes A.B. Type & Length eclipse C.B. Type & Length eclipse

A.B. Scanner Cleaned yes C.B. Scanner Cleaned yes

A.B. Micro Amps at 1.5 Min. N/A C.B. Micro Amps at 1.5 Min. N/A

A.B. DC Volts 9.8 C.B. DC Volts 9.8

Blower Typ new york Blower Wheel Cleaned N/A MTR Manuf. baldor H.P. 5 Volt 230 0 1

Air Settings - North American A.B. Req 5" n/a A.B. Super 8" n/a C.B. Low 1.0 n/a C.B. High 2.75 n/a Air Settings - Eclipse A.B. Low Δ fixed 2.3 inches w.c. A.B. High Δ C.B. Low Δ fixed .35 inches w.c. C.B. High Δ

Throat Air Set at 3" Min. yes

Hearth Air Set at 4" Min. yes

Draft Set at 0.3 yes

4/16/2009

Gas Pressure Correct 7" Nat n/a Before RV81 n/a After RV81 n/a
 Gas Pressure Correct 11" L.P. yes Before RV81 12 inches w.c. After RV81 12 inches w.c.
 Gas Correction Factor on Meter _____

Burning Firing Rates (Seconds per Revolution)

North American or Eclipse
 A.B. at 850,000 BTU _____ 1,000,000 _____ 1,200,000 yes Other _____

North American		Eclipse	
A.B. Low 300,000 <u>n/a</u>	Other _____	A.B. Low 300,000 <u>yes</u>	Other _____
C.B. Low 300,000 <u>n/a</u>	Other _____	C.B. Low 150,000 <u>yes</u>	Other _____
C.B. High 700,000 <u>n/a</u>	Other _____	C.B. High 450,000 <u>yes</u>	Other _____

Temperature Recorder: One Pen yes Two Pen n/a Type honeywell

Temperature Control Works yes
 UD Choneywell Burling n/a

Alarm Settings: A.B. 1750 C.B. 1825 Hi Limit 2075

(Continued on Reverse)

Facility Name Lakeland crematory Glen Abbey **SERVICE CALL CHECKLIST - POWER-PAK II**

Temperature Well/Thermocouple T/C Length 24 inches

Pollution Control Working yes

Does it Effect Cremation Burner, Hearth & Throat Air yes

Opacity set at 15 % yes

Pollution Control Timer Works yes Set at 3.5 min yes

10 Screws on A.B. 4795 Tight n/a 10 Screws on C.B. 4795 Tight n/a

Zenith Timers Work at Proper Settin yes

Door Limit Switch works at 6" open yes

Door Stop Switch Works Property yes

Door Safety Locks Operate Properly yes

Safety Circuit Check: yes

High Limit good Air Switch good Motor Starter good

Fluid Level In Door Pump Ok yes

High Gas Switch Set at 1.5 times Running Pressure n/a

Set Screw on Air Proving and Low Gas Switch Set at 3" only air proving switch on this unit and yes set at 3"

Check Condition and Wear on Master Links new pull chain kit installed on 4/3/09

Damper Motor or Balimo Linkages Tight yes

4/16/2009

Check Linkage Drive Position Vs. Top Skin n/a

Front Panels and Sides Clean and Free of Debris yes

Lube Chains on Door System yes Grease Door Pillow Blocks yes

Annunciator Lights Worki yes All Wiring Tight yes All Lights Tight yes

Left Facility Cleaner Than You Found It yes

Total Number of Cases Performed : Each Month _____ A Year _____

Customer Comments or Concerns: _____

SERVICE CALL CHECKLIST - PROCESSOR ECP-200

Set Screw Tight	<u>yes</u>
Belts Tight	<u>yes</u>
Conditions of Bearings	<u>ok</u>
Condition of Blades	<u>ok</u>
Timer Operative	<u>no</u> timer does not operate
Thermal Switch Operative	<u>yes</u>

Technician: Robert Bew

Date: 4/3/2009

Customer: _____

Date: _____

4/16/2009



SERVICE CALL CHECKLIST

POWER-PAK II

2763

The Standard of Excellence in Cremation Solutions

Job Name Lakeland Crematory

Job Number 1334647

Operators' Names Scott Connor

Installation Date 99 #2

Serial # 0020199

Cremation Chamber Refractories Recommend Floor Replacement + Facebrick

Afterchamber Refractories needs T/A Roof Both Access Doors Rebricked and Hot pass Access Door steel replaced

C/C Floor Type CAST MC-25

Venturi Condition Good Type ICE

Stack Condition Good Length Approx 15' Type 20" Rotted s/c

Stack Cap Condition N/A Type NONE

Clearance on Stack to Opening 6" min yes

Material Surrounding it Wood Roof metal Flashing

Insulation Condition Good Length 8'

Storm Collar has a 3" Clearance 10"

Spark Plugs Cleaned yes A.B. Type & Length Thermax 2 started C.B. Type & Length Thermax set electric

A.B. Scanner Cleaned yes C.B. Scanner Cleaned yes

A.B. Micro Amps at 1.5 Min. _____ C.B. Micro Amps at 1.5 Min. _____

A.B. DC Volts 8.6 VDC C.B. DC Volts 9.8 VDC

Blower Type New York G-116 Blower Wheel Cleaned Inlet Clean MTR Manuf. Baldor
H.P. 5 Volt 230 0 1

Air Settings - North American		Air Settings - Eclipse	
A.B. Req 5"	<u>/</u>	A.B. Low Δ	<u>Fixed</u>
A.B. Super 8"	<u>/</u>	A.B. High Δ	<u>2.2" Δ Wr</u>
C.B. Low 1.0	<u>/</u>	C.B. Low Δ	<u>Fixed</u>
C.B. High 2.75	<u>/</u>	C.B. High Δ	<u>0.35</u>

Throat Air Set at 3" Min. 4.2" WC

Feather Air Set at 4" Min. 4.3" WC

Draft Set at 0.3 0.16

Gas Pressure Correct 7" Nat _____ Before RV81 _____ After RV81 _____

Gas Pressure Correct 11" L.P. yes Before RV91 yes After RV91 yes

Gas Correction Factor on Meter 8th All Gas clocked @ 2 cuft

Burning Firing Rates (Seconds per Revolution)

North American		Eclipse	
A.B. at 850,000 BTU	<u>_____</u>	1,000,000	<u>_____</u>
		1,200,000	<u>15 sec</u>
		Other	<u>_____</u>
A.B. Low 300,000	<u>/</u>	Other	<u>/</u>
C.B. Low 300,000	<u>/</u>	A.B. Low 300,000	<u>_____</u>
C.B. High 700,000	<u>/</u>	C.B. Low 150,000	<u>_____</u>
		C.B. High 450,000	<u>_____</u>
		Other	<u>438 sec</u>
		Other	<u>84 sec</u>
		Other	<u>54 sec</u>

Temperature Recorder One Pen ✓ Two Pen _____ Type DE 4300

Temperature Control Works yes

UDC UDC 2005-2 Burling _____

Air Settings: A.B. 1750 C.B. 1825 H.U. Limit 2075

Facility Name _____ Length 24"

Temperature Well/Thermocouple TC

Pollution Control Working YES

Does It Effect Cremation Burner, Hearth & Throat Air YES

Opacity set at 15 % YES

Pollution Control Timer Works YES Set at 3.5 min YES

10 Screws on A.B. 4795 Tight Verify flame 10 Screws on C.B. 4795 Tight Verify flame

Zenith Timers Work at Proper Settings AG-T/A timers have stripped gears

Door Limit Switch works at 6" open YES

Door Stop Switch Works Properly YES

Door Safety Locks Operate Properly YES

Safety Circuit Check: OK

High Limit Air Switch Motor Starter

Fluid Level In Door Pump Ok YES

High Gas Switch Set at 1.5 times Running Pressure N/A

Set Screw on Air Proving and Low Gas Switch Set at 3" YES

Check Condition and Wear on Master Links OK

Damper Motor or Belimo Linkages Tight YES

Check Linkage Drive Position Vs. Top Skin Belimo

Front Panels and Sides Clean and Free of Debris YES

Lube Chains on Door System YES Grease Door Pillow Blocks YES

Annunciator Lights Working YES All Wiring Tight YES All Lights Tight YES

Left Facility Cleaner Than You Found it YES

Total Number of Cases Performed: _____ Each Month: _____ A Year SEE UNIT #1

Customer Comments or Concerns: _____

SERVICE CALL CHECKLIST - PROCESSOR ECP-200

Set Screw Tight _____

Bells Tight _____

Conditions of Bearings _____

Condition of Blades _____

Timer Operative _____

Thermal Switch Operative _____

SEE UNIT #1

Technician: [Signature] Date: 11/20/07

Customer: R. Malley Date: 11-20-07

BEATTY ENVIRONMENTAL SERVICES
TEMPERATURE CALIBRATION DATA SHEET

DATE April 17, 2006

COMPANY
Lakeland Crematory

ADDRESS 2200 K-Ville Rd.

CITY Auburndale, FL

TELEPHONE (863)551-9717

COMPANY REPRESENTATIVE Scott Conner
FDEP ID# 1050272

EQUIPMENT TO BE TESTED Unit #2 IEE Co. Power Pak II Model IE43 Digital
Temperature and Chart Recorder

STANDARD	READINGS			
	DIGITAL	CIRCULAR	ERROR	PERCENTAGE
241	341	450	99	32%
827	927	1000	73	8%
1637	1738	1750	12	<1%
2063	2162	2200	38	2%

COMMENTS The error was calculated between the digital and circular chart readings. Note that there appears to be a 100 degree bias within the digital controller. Recommend that this bias be removed.

STATUS OF EQUIPMENT Satisfactory

INSTRUMENT USED FOR CALIBRATION: Extech Instruments Corporation Calibrator Thermometer Model # 433201, Serial # E 073282, NIST Certified 02/06, certificate of calibration provided upon request.

EQUIPMENT CHECKED BY: Ryan Peterson, BEATTY ENVIRONMENTAL SERVICES, Inc. (239) 458-2894

SIGNED

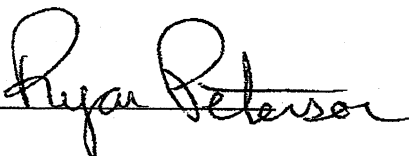



SERVICE CALL CHECKLIST

POWER-PAK II

2763

The Standard of Excellence in Cremation Solutions

Job Name Lakeland Crematory

Operators' Names Scott Cannon

Job Number 133467

Installation Date 99 # 2 Work Unit

Cremation Chamber Refractories Recommend C/C Floor Replacement

Serial # 0030199

Afterchamber Refractories Needs Throat Area Roof + Both Access Doors abraded
Replacement of Hot pass lower plate

Venturi Condition Fair C/C Floor Type LAST MC-25

Stack Condition Good Type IEE Newstyle name

Stack Cap Condition N/A Length Approx 15' Type 20' Rolled S/S

Clearance on Stack to Opening 6" min Yes Type None

Material Surrounding it Wood Roof metal collar

Insulation Condition Hot spots ON JACK at Recommended Length 8'

Form Collar has a 3" Clearance NO Needs raised 2" + sealed

Spark Plugs Cleaned Yes A.B. Type & Length Thermaxjet Electrode C.B. Type & Length Thermaxjet Electrode

A.B. Scanner Cleaned Yes C.B. Scanner Cleaned Yes

B. Micro Amps at 1.5 Min. 8.3VDC C.B. Micro Amps at 1.5 Min. 8.6VDC

B. DC Volts 8.3VDC C.B. DC Volts 8.6VDC

Blower Type New York 6146 Blower Wheel Cleaned Wet Clean MTR Manuf. Baldor

H.P. 5 Volt 230 Air Settings - Eclipse

Settings - North American
A.B. Req 5" /
A.B. Super 8" /
C.B. Low 1.0 /
C.B. High 2.75 /

A.B. Low Δ Fixed
A.B. High Δ 1.8" ΔWC
C.B. Low Δ Fixed
C.B. High Δ 0.3" ΔWC

Hot Air Set at 3" Min. 4.5" WC

Hot Air Set at 4" Min. 5.4" WC

Hot Air Set at 0.3 -0.16" WC

Pressure Correct 7" Nat Yes Before RV81 Yes After RV81 Yes

Pressure Correct 11" L.P. Yes Before RV81 Yes After RV81 Yes

Correction Factor on Meter 8#

Timing Firing Rates (Seconds per Revolution)

North American or Eclipse
A.B. at 850,000 BTU / 1,000,000 / 1,200,000 1/6 sec Other /

North American
A.B. Low 300,000 / Other /
C.B. Low 300,000 / Other 51 sec
C.B. High 700,000 / Other 88 sec
Other 54 sec

Temperature Recorder One Pen Yes Two Pen / Type DR 4300

Temperature Control Works Yes Settings: A.B. 1750 C.B. 1825 H-Limit 2075

Facility Name _____

SERVICE CALL CHECKLIST - 11/20/07

Temperature Well/Thermocouple T/C

Length 24"

Pollution Control Working NO Bad Rev

Does It Effect Cremation Burner, Hearth & Throat Air ?

Capacity set at 15 % NO

Pollution Control Timer Works ? Set at 3.5 min YES

10 Screws on A.B. 4795 Tight Verify Same 10 Screws on C.B. 4795 Tight Verify Same

Zenith Timers Work at Proper Settings YES

Door Limit Switch works at 6" open YES

Door Stop Switch Works Properly YES

Door Safety Locks Operate Properly YES

Safety Circuit Check: OK

High Limit

Air Switch

Motor Starter

Fluid Level In Door Pump Ok YES

High Gas Switch Set at 1.5 times Running Pressure N/A

Set Screw on Air Proving and Low Gas Switch Set at 3" YES

Check Condition and Wear on Master Links OK

Damper Motor or Belimo Linkages Tight YES

Check Linkage Drive Position Vs. Top Skin Belimo

Front Panels and Sides Clean and Free of Debris YES

Lube Chains on Door System YES Grease Door Pillow Blocks YES

Annunciator Lights Working YES All Wiring Tight YES All Lights Tight YES

Left Facility Cleaner Than You Found It YES

Total Number of Cassettes Performed: Each Month _____ A Year 1000+

Customer Comments or Concerns: 1- Thermit Air 3" hose needs replaced, 2 casters on lift Table need replaced, 1 Rail Bearing on Auto loader needs replaced

SERVICE CALL CHECKLIST - PROCESSOR ECP-200

Set Screw Tight No missing

Belts Tight yes

Conditions of Bearings Drum Good Machine need Replaced Old style per Feb '90

Condition of Blades Need Replaced

Timer Operative NO

Thermal Switch Operative NO Regular light switch

Technician: [Signature]

Date: 11/20/07

Customer: [Signature]

Date: 11-20-07



Florida Department of Environmental Protection
Southwest District Office

FIELD INSPECTION NOTICE

Name / Owner / Operator: Lakeland Crematory
Address: 2196 K-ville Avenue
Location / Source: Auburndale 33823
Permit Number: 1050272 Permit Exp. Date: 1/19/2014 Date and Time: 9/14/09

The purpose of this notice is to advise you of findings from a Florida Department of Environmental Protection (DEP) personnel conducted field inspection on the date listed above at the location described above.

Observations: Please provide work order from Matthews Crematory Corp from the West Unit 5/2009, East Unit April 2009

Rule or Statute Relevant to Observations

Permit Condition No.

Table with 2 columns: Rule or Statute Relevant to Observations, Permit Condition No. Rows include: No Noticeable Unconfined Particulate Matter, No Violation of Permit Condition(s) Observed, No Objectionable Odor Observed, No Excessive Visible Emissions Observed On Site, No Construction Or Modifications Of Permitted Emission Units Observed, New Operating Rate, No Open Burning Observed, Other.

The activities observed during the Department's field inspection for the above location indicate that, at this time, your facility appears to be in compliance with Florida Administrative Code and your current permit conditions.

You are requested to contact Joe Panetta at the address or telephone number below within fifteen (15) days of receipt of this Field Inspection Notice if you have any questions about the above findings.

Received by: Scott Conner Issued / Posted by: Joseph V. Panetta
Print: [Signature] Print: Joseph V. Panetta
Title: Sr. Operator 863 551 9717

MEMORY TRANSMISSION REPORT

TIME : 09-23-'09 13:24
 FAX NO.1 : 813-632-7668
 NAME :

FILE NO. : 749
 DATE : 09.23 13:23
 TO : 818639651918
 DOCUMENT PAGES : 3
 START TIME : 09.23 13:23
 END TIME : 09.23 13:24
 PAGES SENT : 3
 STATUS : OK

*** SUCCESSFUL TX NOTICE ***

STATE OF FLORIDA
 DEPARTMENT OF ENVIRONMENTAL PROTECTION
 SOUTHWEST DISTRICT AIR PROGRAM

FACSIMILE TRANSMITTAL SHEET

TO:	FROM:
Scott Conner	Joe Panetta, FI DEP SWD <i>J Panetta</i>
COMPANY:	DATE:
FL Dept of Env. Protection	9/23/2009
FAX NUMBER:	TOTAL NO. OF PAGES, INCLUDING COVER:
863-965-1918	3
PHONE NUMBER:	SENDER'S PHONE NUMBER:
863-967-8558	813-632-7600 ext 105
RE: THERMOCOUPLE CALIBRATION	SENDER'S FAX NUMBER:
Pg 398-399 of	813-632-7668
Florida Statue 62-297.310	

URGENT FOR REVIEW PLEASE COMMENT PLEASE REPLY PLEASE RECYCLE

NOTES/COMMENTS:

Hi Mr. Connor,

I would like to thank you for making time for the four of us from the Department on September 14, 2009.

During the inspection we spoke about thermocouple calibration. Attached is the section of Florida Statue 62-297.310 that is applicable to thermocouple calibration.

Sincerely,

Joe Panetta

"This staff assessment is preliminary and is designed to assist in the review of the information provided prior to final agency action. The comments provided herein are not the final position of the department and may be subject to revision pursuant to additional information and further review".